

PROPOSED SITE PLAN FOR PLOT No. P-272/1 IN PRATAP VIHAR SECTOR XII, G.M.P. Gzb.

TOTAL AREA OF PLOT = 190.465 Sqm.

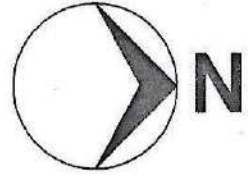
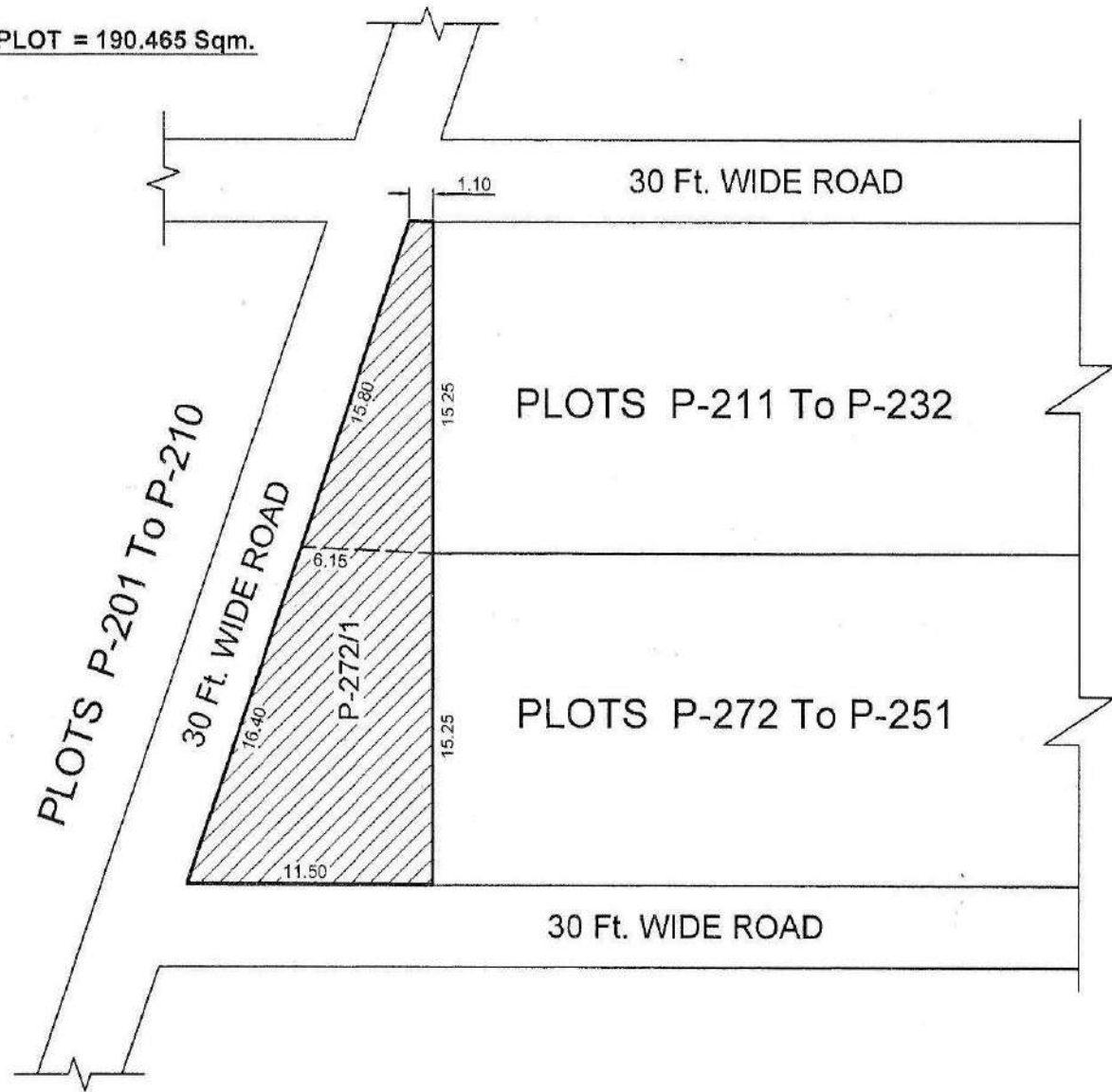

Prepared By
06/11/12

Prepared By.

Checked By
06/11/12

Compared By.

Area Meas. & Cal. By
Survesh Kumar

Area Meas. & Cal. By.

A. E.
Neeraj Gupta

A. E.

Town Planner
06/11/12

Town Planner

PART LAY OUT PLAN FOR NANDGRAM BLOCK - E. GHAZIABAD

91

PART . B

PART . B

S.NO.	PLOT NO.	AREA	S.NO.	PLOT NO.	AREA
(21)	E-21	187.55 SQM.	(34)	E-34	97.74 SQM.
(22)	E-22	90.61 SQM.	(35)	E-35	91.76 SQM.
(23)	E-23	91.87 SQM.	(36)	E-36	84.67 SQM.
(24)	E-24	113.28 SQM.	(37)	E-37	79.48 SQM.
(25)	E-25	99.15 SQM.	(38)	E-38	80.54 SQM.
(26)	E-26	90.05 SQM.	(39)	E-39	87.71 SQM.
(27)	E-27	90.05 SQM.	(40)	E-40	98.74 SQM.
(28)	E-28	133.27 SQM.	(41)	E-41	116.59 SQM.
(29)	E-29	142.53 SQM.	(42)	E-42	108.00 SQM.
(30)	E-30	88.94 SQM.	(43)	E-43	153.78 SQM.
(31)	E-31	93.50 SQM.	(44)	E-44	86.74 SQM.
(32)	E-32	103.93 SQM.	(45)	E-45	86.00 SQM.
(32)	E-32	103.93 SQM.	(46)	E-46	85.07 SQM.
(33)	E-33	98.31 SQM.			
				PARK	
			(01)	A	313.05 SQM.

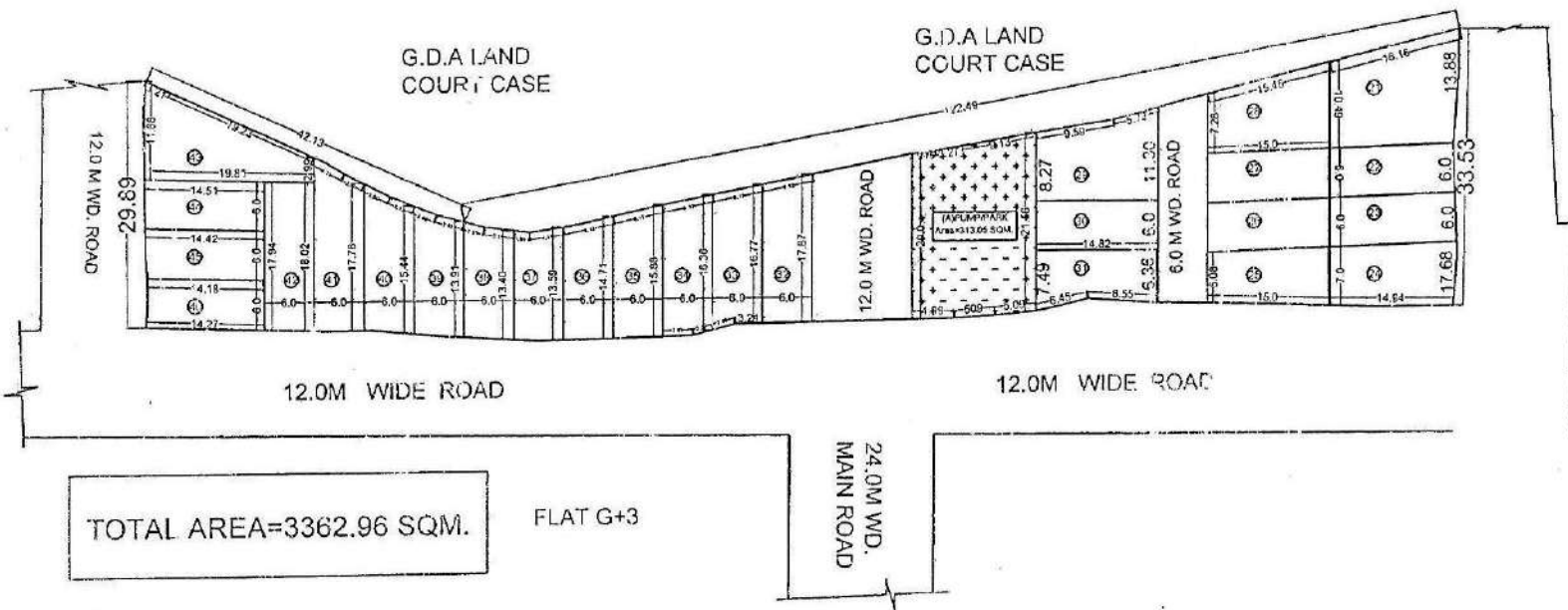

 D/MAN
  AMIN
  OSD(LA)
  J.E
  A.E
  E.E
  T.P(R)
  T.P(K)
 C.A.T.P
 SECY.
 V.C





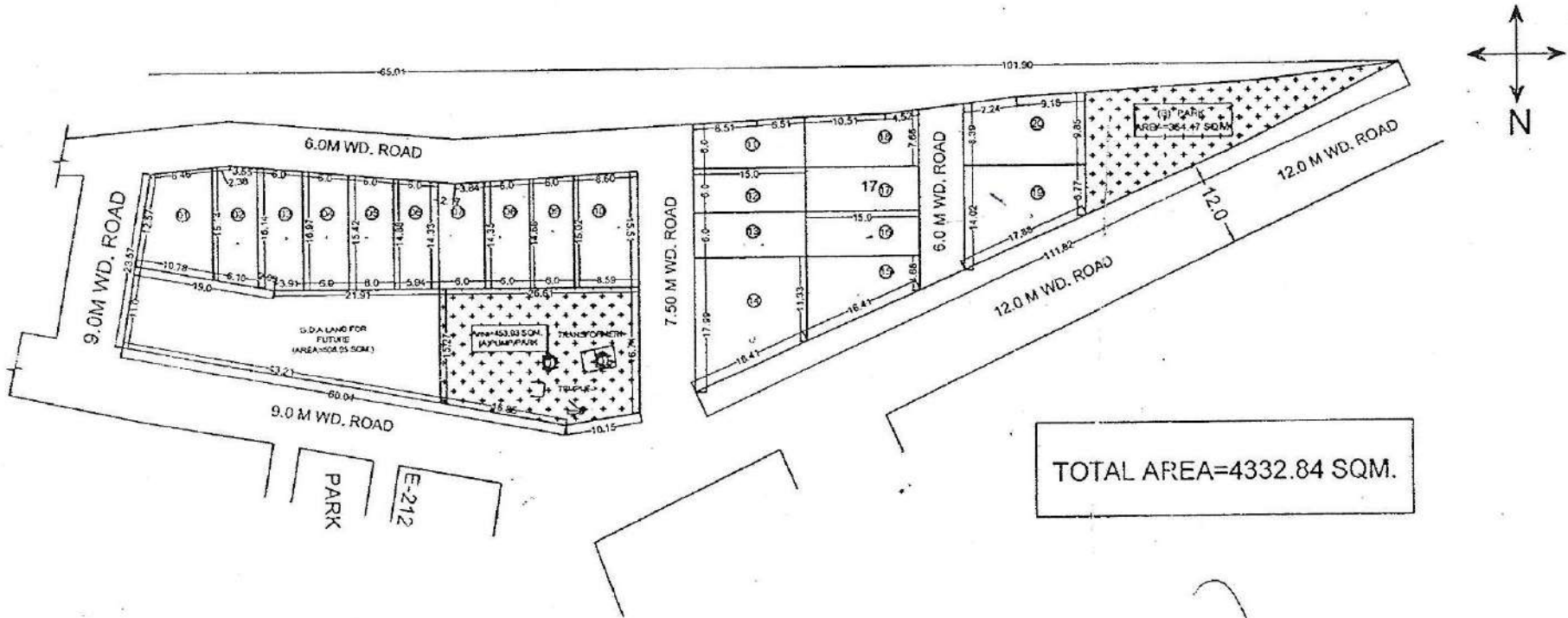

PART . A

S.NO.	PLOT NO.	AREA
(01)	E-01	131.51 SQM.
(02)	E-02	94.62 SQM.
(03)	E-03	97.09 SQM.
(04)	E-04	94.20 SQM.
(05)	E-05	90.91 SQM.
(06)	E-06	87.62 SQM.
(07)	E-07	84.81 SQM.
(08)	E-08	87.09 SQM.
(09)	E-09	89.12 SQM.
(10)	E-10	131.09 SQM.
(11)	E-11	95.94 SQM.
(12)	E-12	90.00 SQM.

PART . A

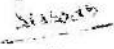
S.NO.	PLOT NO.	AREA
((13)	E-13	90.00 SQM.
(14)	E-14	219.77 SQM.
(15)	E-15	120.03 SQM.
(16)	E-16	90.00 SQM.
(17)	E-17	90.00 SQM.
(18)	E-18	106.28 SQM.
(19)	E-19	169.91 SQM.
(20)	E-20	151.00 SQM.
PARK		
(01)	A	453.03 SQM.
(02)	B	354.47 SQM.

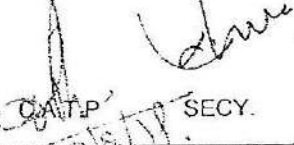
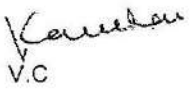

 D/MAN
  AMIN
  O.S.D. (L.A.S.)
  J.E.
  A.E.
  E.E.
  T.P.(R)
  T.P.(K)
  SECY.
  V.C.

SITE PLAN OF PLOT NO-NP- IN 1 BLOCK GOVINDPURAM GMP. GZD

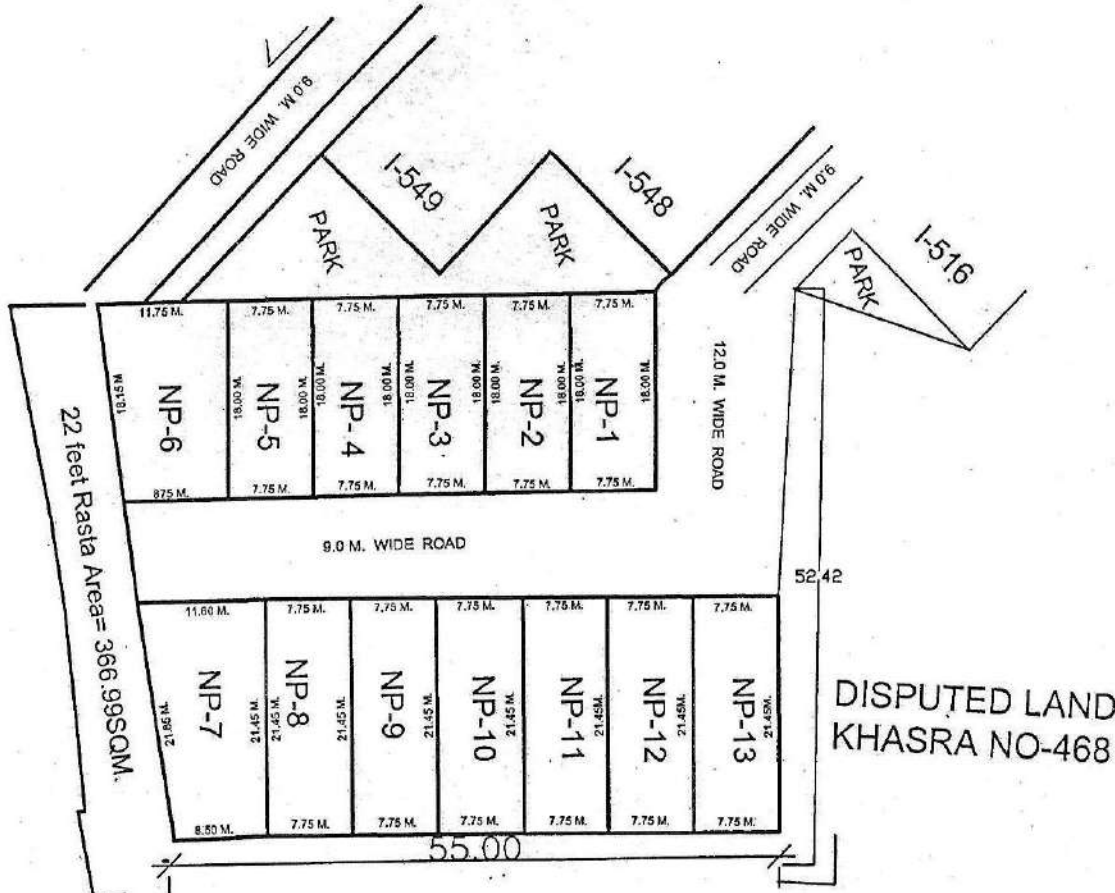

PLOT NO-	AREA
NP- 1	139.50SQM.
NP- 2	139.50SQM.
NP- 3	139.50SQM.
NP- 4	139.50SQM.
NP- 5	139.50SQM.
NP- 6	184.50 SQM.
NP- 7	215.57 SQM.
NP- 8	166.23 SQM.
NP- 9	166.23 SQM.
NP- 10	166.23 SQM.
NP- 11	166.23 SQM.
NP- 12	166.23 SQM.
NP- 13	166.23 SQM.

PREPARED BY

 21/01/19

COMPARED BY

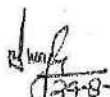
 21/01/19

J.E

 21-0-19

A.E

EE-3

 21/01/19

T.P

 21/01/19

SITE PLAN OF PLOT NO-NP- IN I BLOCK GOVINDPURAM GMP. GZB

PLOT NO.	AREA	PLOT NO.	AREA
NP-14	72.00 SQM.	NP-20	49.32 SQM.
NP-15	72.00 SQM.	NP-21	110.59 SQM.
NP-16	72.00 SQM.	NP-22	110.59 SQM.
NP-17	60.81 SQM.	NP-32	157.61 SQM.
NP-18	51.13 SQM.	NP-33	110.96 SQM.
NP-19	61.61 SQM.	NP-34	110.96 SQM.



DISPUTED LAND
KHASRA NO-468

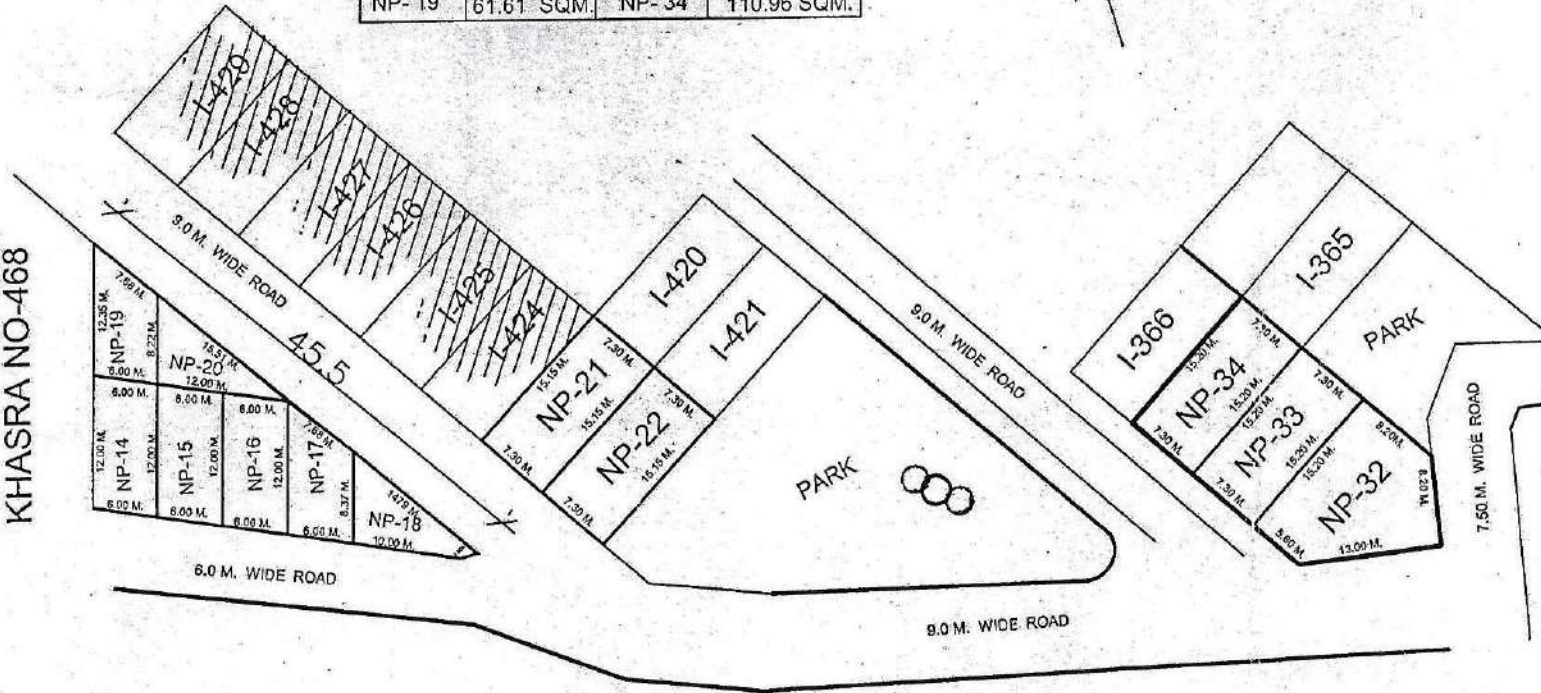

[Signature]
31/01/19
PREPARED BY

[Signature]
02/03/19
COMPARED BY

[Signature]
29/01/19
J.E

[Signature]
A.E

[Signature]
29/01/19
EE-3

[Signature]
3/19
T.P

REVISED PART LAYOUT PLAN OF COMMERCIAL LAND IN INDRAPRASTH YOZNA, POCKET - H, LONI, GZB.

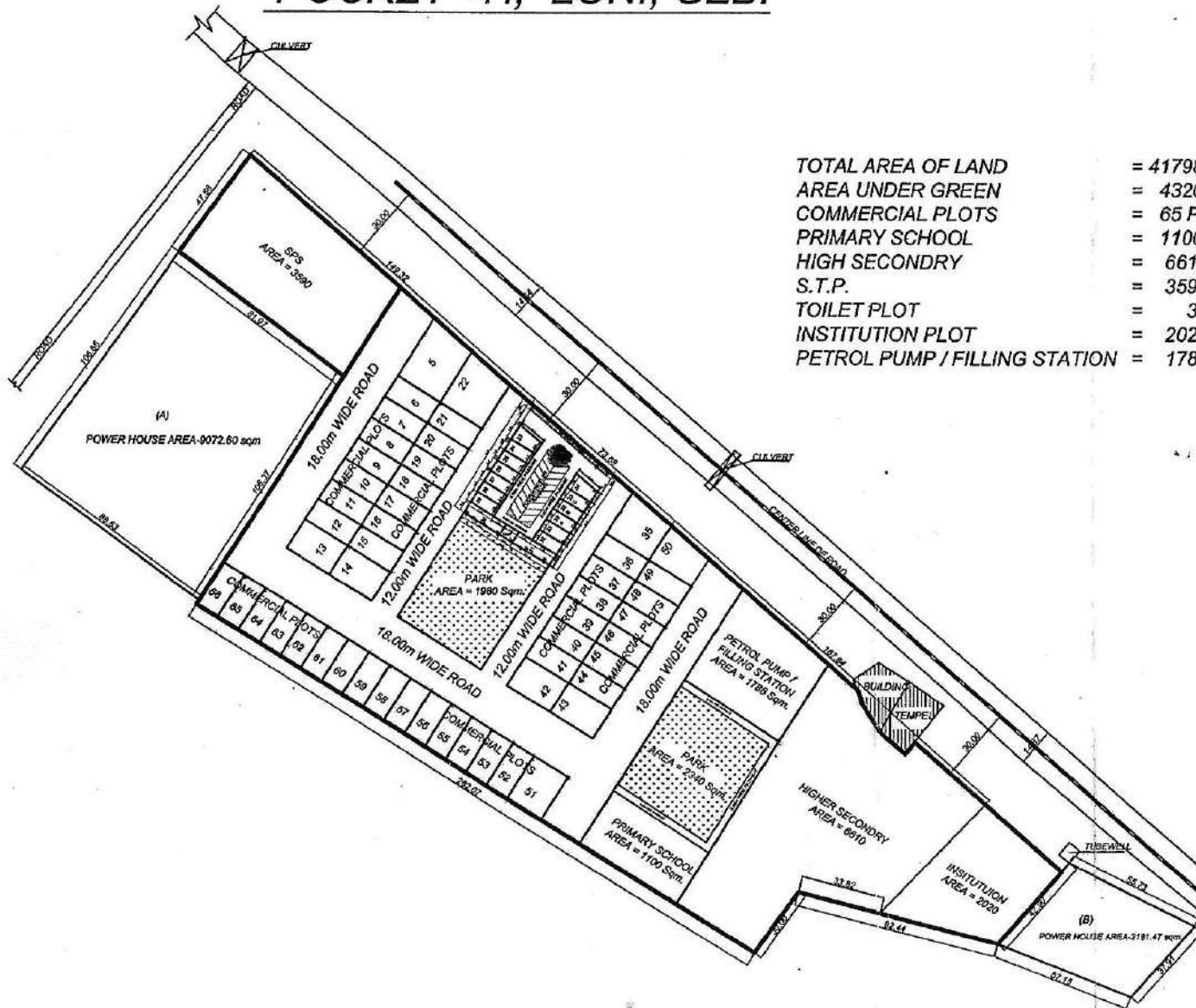
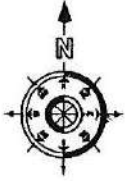

TOTAL AREA OF LAND	= 41798.00 Sqm.
AREA UNDER GREEN	= 4320.00 Sqm.
COMMERCIAL PLOTS	= 65 PLOTS
PRIMARY SCHOOL	= 1100.00 Sqm.
HIGH SECONDARY	= 6610.00 Sqm.
S.T.P.	= 3590.00 Sqm.
TOILET PLOT	= 30.00 Sqm.
INSTITUTION PLOT	= 2020.00 Sqm.
PETROL PUMP / FILLING STATION	= 1788.00 Sqm.

AREA SCHEDULE (COMM. PLOTS)

PLOT Nos.	AREA (IN Sqm.)
5	510.00
6 To 12	195.00
13 & 14	270.00
15 To 21	195.00
22	445.00
23	64.05
24 To 29	55.00
30 & 31	85.00
32 & 33	55.00
33A, 33B & 33C	55.00
34	65.20
35	380.00
36 To 41	195.00
42 & 43	270.00
44 To 49	195.00
50	292.00
51	314.00
52 To 66	195.00

SITE PLAN OF PLOT NO. CP- AT C-BLOCK GOVINDPURAM.

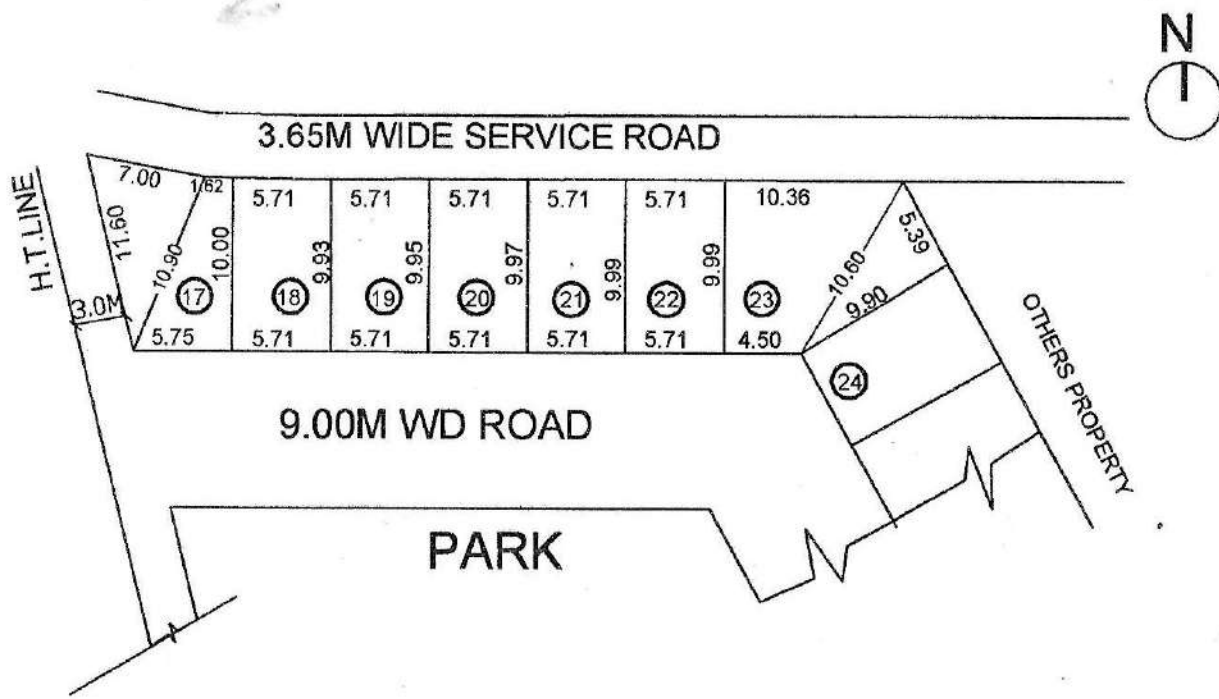

AREA CHART	
PLOT NO.	AREA
17	74.10 SQM
18	56.91 SQM
19	56.76 SQM
20	56.91 SQM
21	57.00 SQM
22	57.15 SQM
23	101.02 SQM

[Signature]
19-11-15
PREPARED BY.

[Signature]
11/12/15
COMPARED BY.

[Signature]
9/12/15
J.E.

[Signature]
9/12/15
A.E.

[Signature]
EX.EN

[Signature]
T.P

SITE PLAN OF PLOT NO- 71/ AT A - BLOCK GOVINDPURAM GZ

PLOT AREA NO OF 71/8 TO 71/10 = 127.00 SQ.MT.

PLOT AREA NO OF 71/6 = 290.35 SQ.MT.

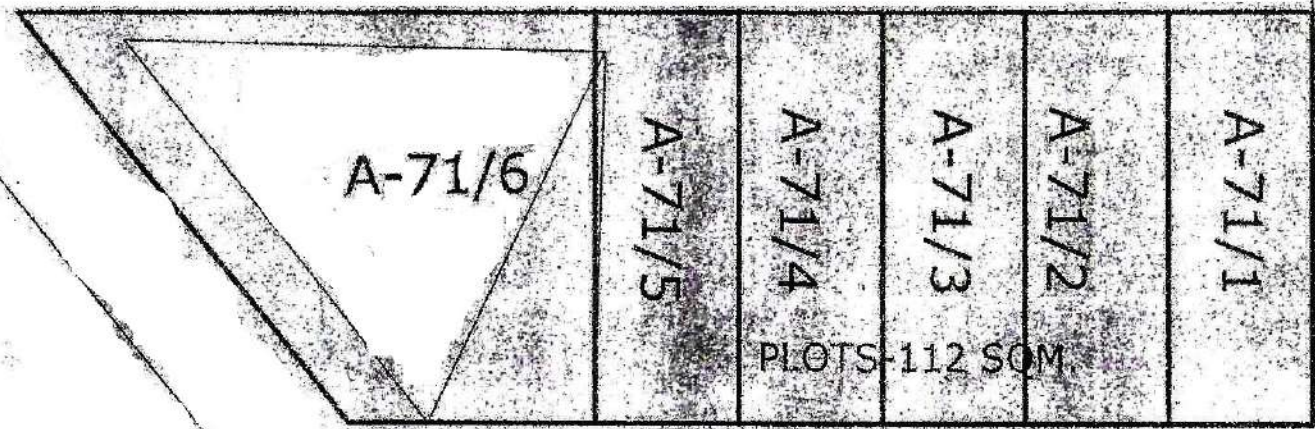

9.0M WIDE ROAD

9.0M WIDE ROAD

PREPARED BY

COMPARED BY

J.E.

A.T.

E.E.







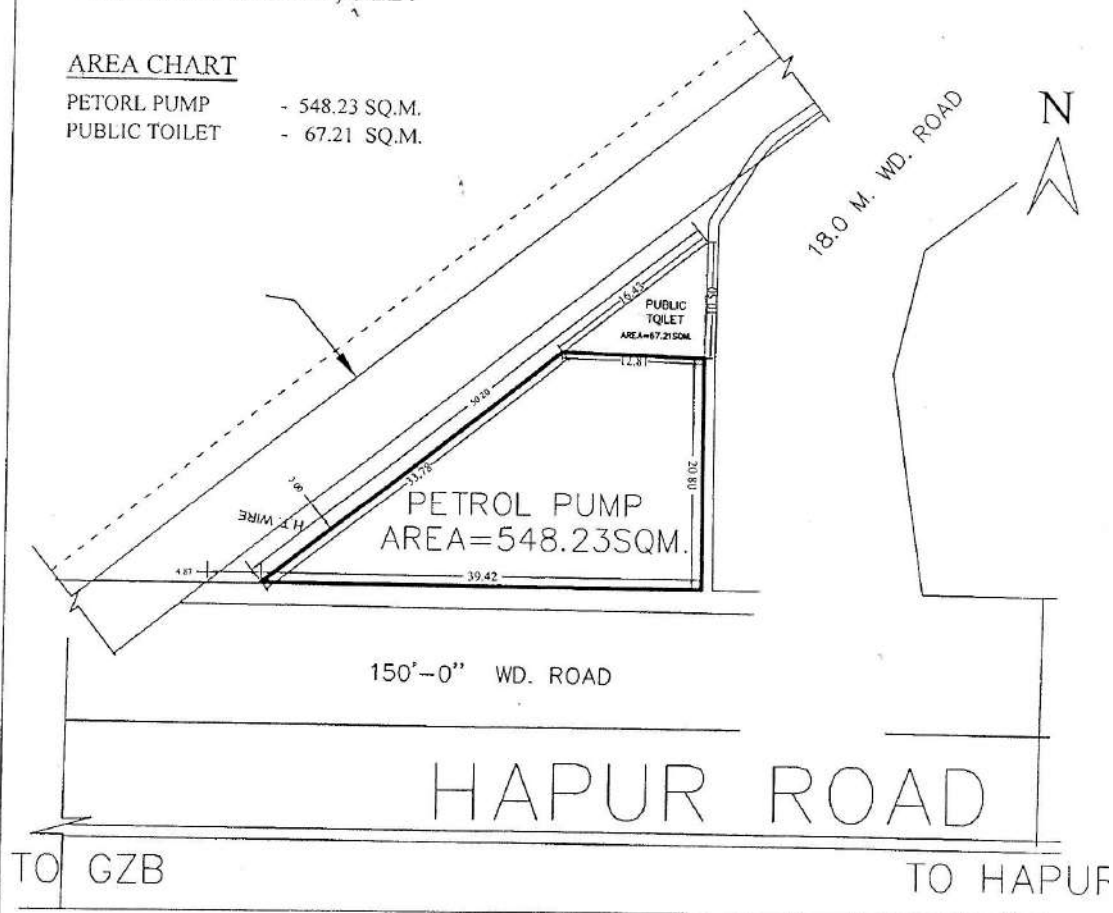

T.P.

REVISED SITE PLAN OF PETROL PUMP /PUBLIC TOILET A-BLOCK
GOVINDPURAM ,GZB.

AREA CHART

PETORL PUMP - 548.23 SQ.M.
PUBLIC TOILET - 67.21 SQ.M.





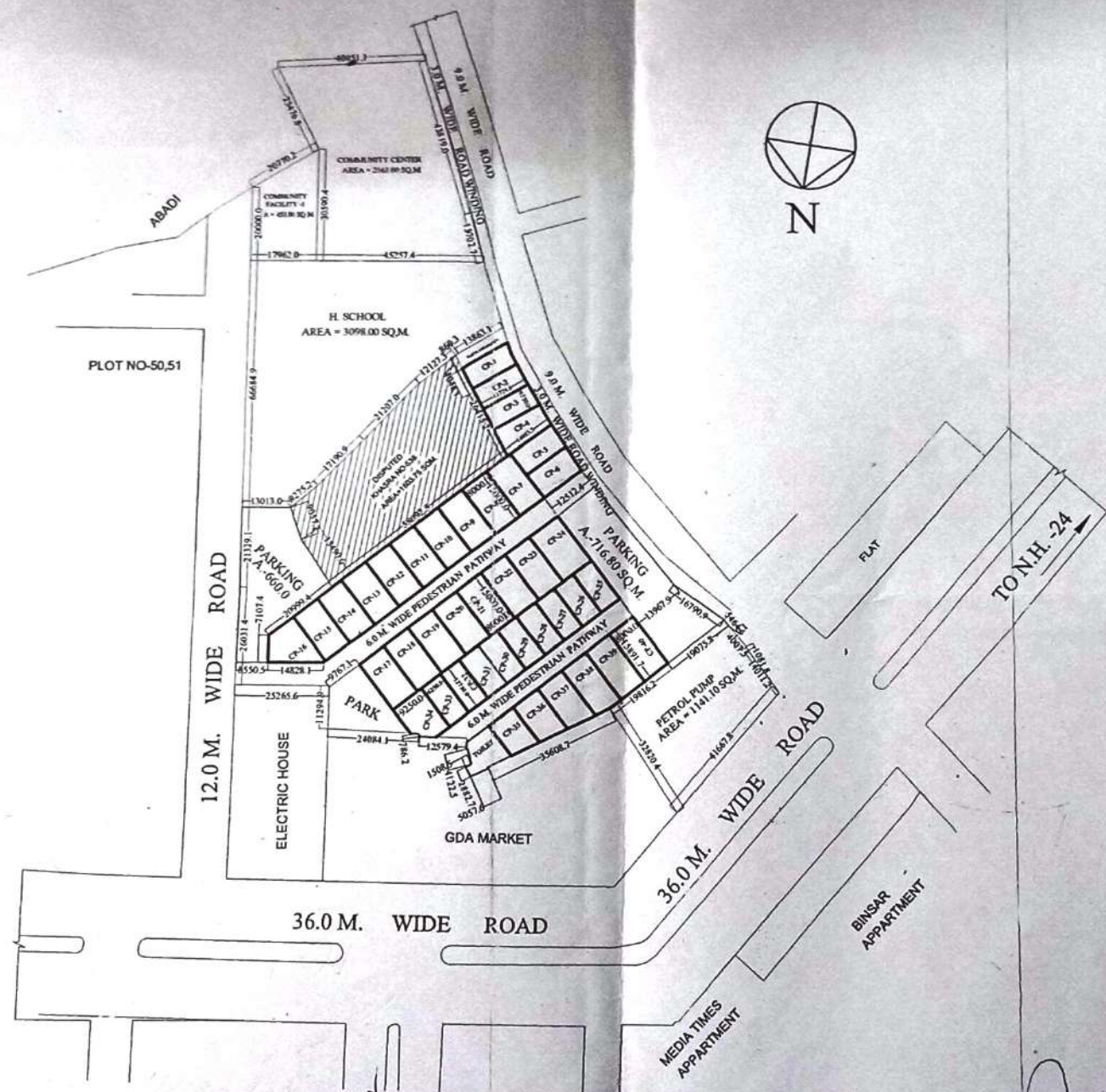

 D/Man
 J.E.
 A.E.
 E.E.
 T.P.
 C.A. (17/01/2016)
 SECRTY.
 V.C.

REV. PART LAYOUT PLAN OF COMMERCIAL PLOTS (VEHICLE FREE) AT NYAY KHAND-1 INDIRAPURAM GZB.

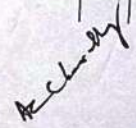

AREA-CHART

CP-1	= 87.02 Sqmt.
CP-2	= 88.07 Sqmt.
CP-3	= 88.71 Sqmt.
CP-4	= 101.05 Sqmt.
CP-5	= 94.87 Sqmt.
CP-6	= 99.13 Sqmt.
CP-7 to CP-15	= 120.00 Sqmt.
CP-16	= 116.24 Sqmt.
CP-17 to CP-23	= 120.00 Sqmt.
CP-24	= 142.25 Sqmt.
CP-25 to CP-33	= 79.68 Sqmt.
CP-34	= 107.11 Sqmt.
CP-35	= 85.84 Sqmt.
CP-36	= 99.21 Sqmt.
CP-37	= 112.59 Sqmt.
CP-38	= 124.48 Sqmt.
CP-39	= 126.61 Sqmt.
CP-40	= 126.69 Sqmt.
PARKING	= 1376.80 Sqmt.

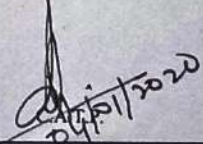
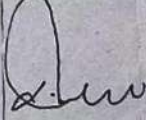
 D/MAN
  J.E.
  A.E.
  E.E.
 T.P.(R)
  T.P.(G)
 24/11/2020
  SECERATRY
  VICE CHAIRMAN

REVISED PART LAYOUT PLAN OF C.CENTER, H. SCHOOL, COMM. & PETROL PUMP AT NYAY KHAND-1 INDIRAPURAM GHAZIABAD.

NOTE - A, B, C, D AREA IS UNDER G.D.A. OWNERSHIP

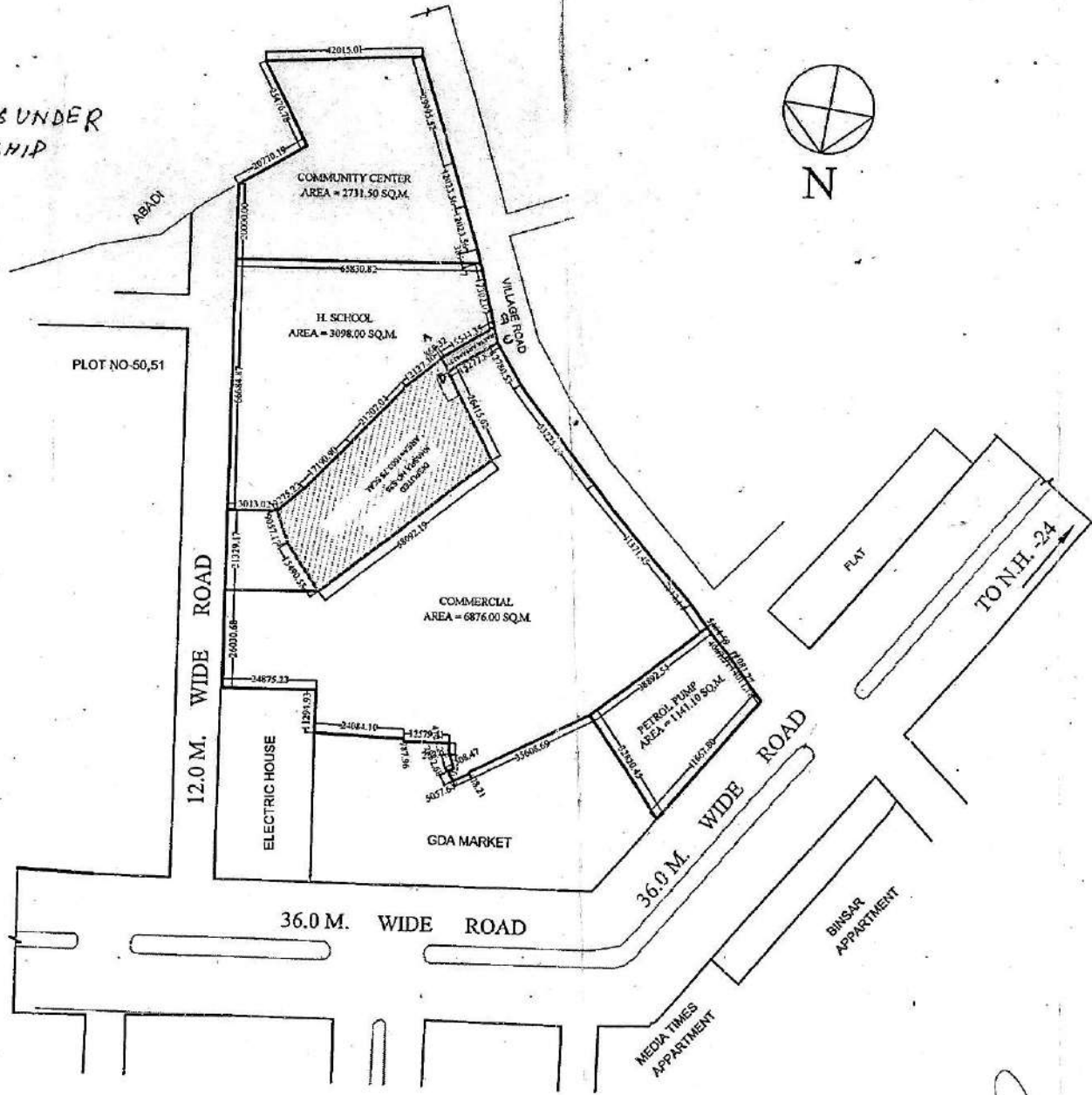

[Signature]
DMAN

[Signature]
AMIN

[Signature]
A.T.P.

[Signature]
A.E.

[Signature]
S.E.

26-3-18
E.E.

TEH.-I.A.

[Signature]
T.P.

[Signature]
C.A.T.P.





[Signature]
SECRATRY

[Signature]
VICE CHAIRMAN

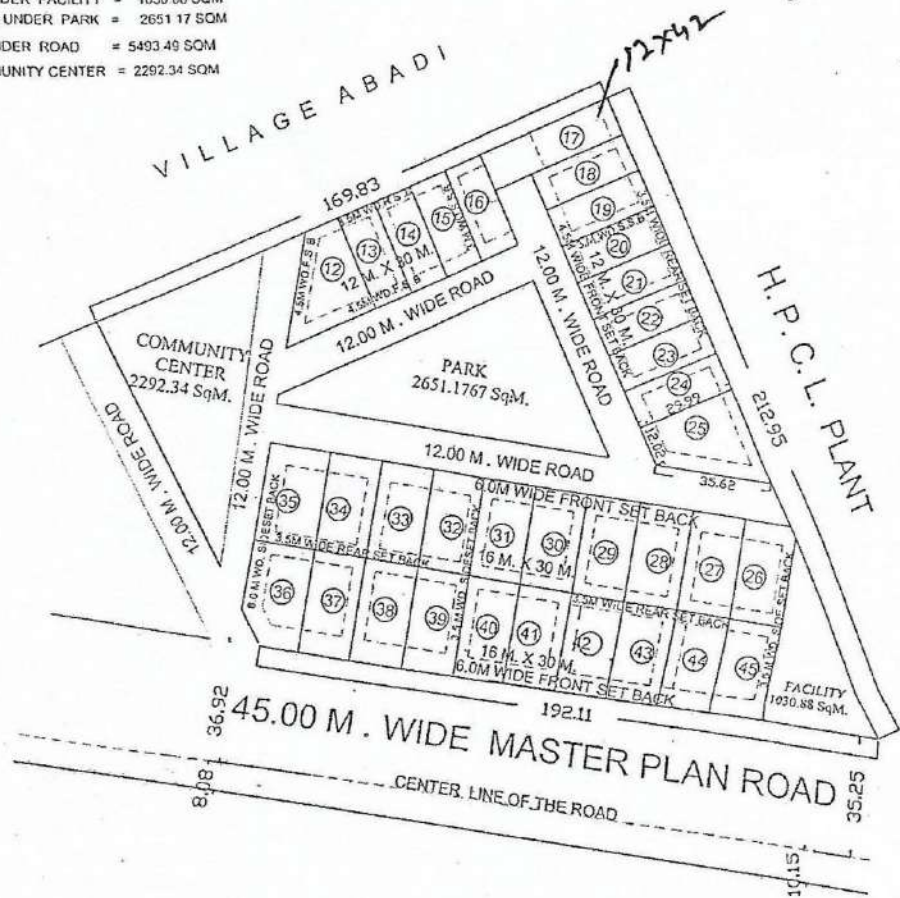
TENTATIVE INDUSTRIAL PART LAYOUT PLAN OF POCKET - B, AT INDERPRASTHA YOJNA GHAZIABAD.

TOTAL AREA OF PLOT = 27103.27 SQM
 AREA UNDER PLOT = 15321.64 SQM
 AREA UNDER FACILITY = 1030.88 SQM
 AREA UNDER PARK = 2651.17 SQM
 AREA UNDER ROAD = 5493.49 SQM
 AREA UNDER COMMUNITY CENTER = 2292.34 SQM

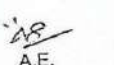
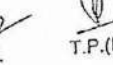
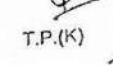
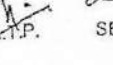
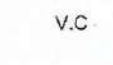

 D/MAN
  AMIN
  OSD.-L.A.
  J.E.
  A.E.
  T.P.(R)
  T.P.(K)
  C.A.T.P.
  SECY.
  V.C.

TENTATIVE INDUSTRIAL PART LAYOUT PLAN OF KHASRA NO- 698 IN POCKET- B, AT INDRAPRASTHA YOJNA GHAZIABAD.

TOTAL AREA OF PLOT = 9071.23 SQM - 100 %
 AREA UNDER PLOT = 5662.29 SQM - 62.42 %
 AREA UNDER ROAD = 2046.46 SQM - 22.55 %
 AREA UNDER OPEN SPACE = 1362.48 SQM - 15.01 %

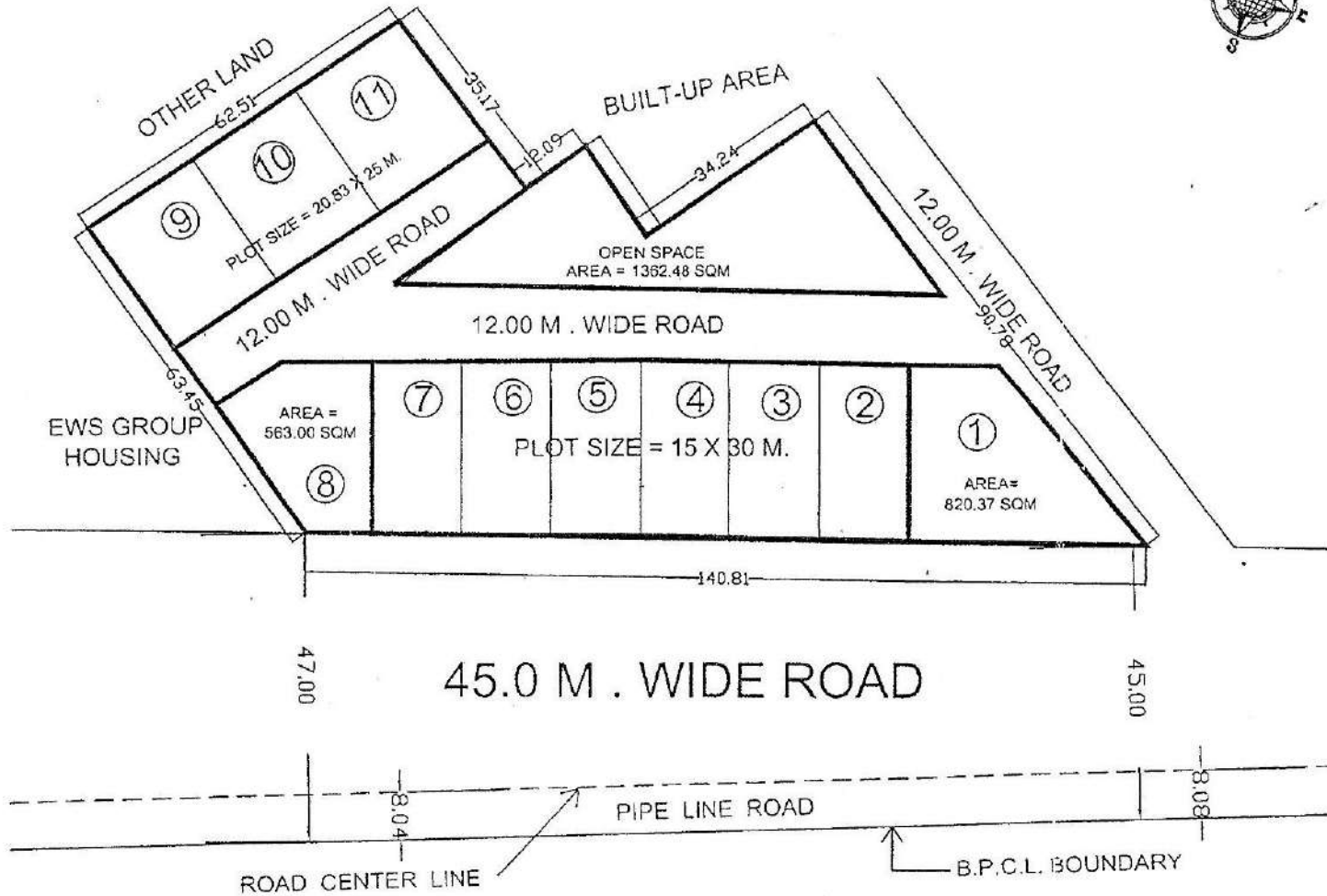

[Signature]
 12/1/2020
 D/MAN
 12/3/2020
 T/MAN

OSD-L.A.

[Signature]
 12/03/2020
 JE
 AE

[Signature]
 EE

[Signature]
 T.P.(R)

[Signature]
 T.P.(K)

[Signature]
 P.A.T.P.
 SECY

[Signature]
 VC

PART LAYOUT PLAN OF SHOPS PLOT , HOTEL, COMMERCIAL & NURSING HOME PLOT ON COMMERCIAL (COM-2) PLOT & COMMERCIAL/RESIDENTIAL (C/G.H.-1) PLOT IN POCKET C , MADHUBAN BAPUDHAM YOJNA GHAZIABAD

TOATAL AREA OF LAND	= 60938.57 SQ.M.	SHOPS PLOT - 10.00M. X 28.15M.	- 281.50 SQ.M.	- 10 (C/S.P.-06 TO C/S.P.-15)
AREA UNDER SHOPS PLOT	= 21632.30 SQ.M.	SHOPS PLOT - 10.00M. X 20.00M.	- 200.00 SQ.M.	- 38 (C/S.P.-50 TO C/S.P.-64 ,C/S.P.-89 TO C/S.P.- 111)
AREA UNDER HOTEL	= 1788.72 SQ.M.	SHOPS PLOT - 09.00M. X 18.00M.	- 162.00 SQ.M.	- 39 (C/S.P.-01 TO C/S.P.-05 ,C/S.P.-16 TO C/S.P.- 49)
AREA UNDER NURSING HOME	= 1308.58 SQ.M.	SHOPS PLOT - 08.00M. X 12.50M.	- 100.00 SQ.M.	- 47 (C/S.P.-65 TO C/S.P.-88 ,C/S.P.- 112 TO C/S.P.-134)
AREA UNDER COMMERCIAL	= 1154.00 SQ.M.	TOTAL NOS. OF SHOPS PLOT	- 134	
AREA UNDER MULTILEVEL P.	= 5468.95 SQ.M.			
AREA UNDER TOILET /D.W.	= 322.60 SQ.M.			
AREA UNDER GREEN/CENTRAL PLAZA	= 7877.60 SQ.M.			
AREA UNDER CAR PARKING	= 2824.32 SQ.M.			
AREA UNDER PAVED PATHWAY	= 18561.50 SQ.M.			
TOTAL NOS. OF CAR IN CAR PARKING	- 185			

SHOPS PLOT
 F.A.R = 3 - G.F.L.,F.F. & S.F. (AS PER CONTROL DRG.)
 (BASEMENT AREA IS FREE FORM FAR.)
 GROUND COVERAGE = 100 %



REVISED PART LAYOUT PLAN OF FILLING STATIONS (FS-1 & FS-2) COMMERCIAL PLOT AT KOYAL ENCLAVE SCHEME, LONI, GHAZIABAD

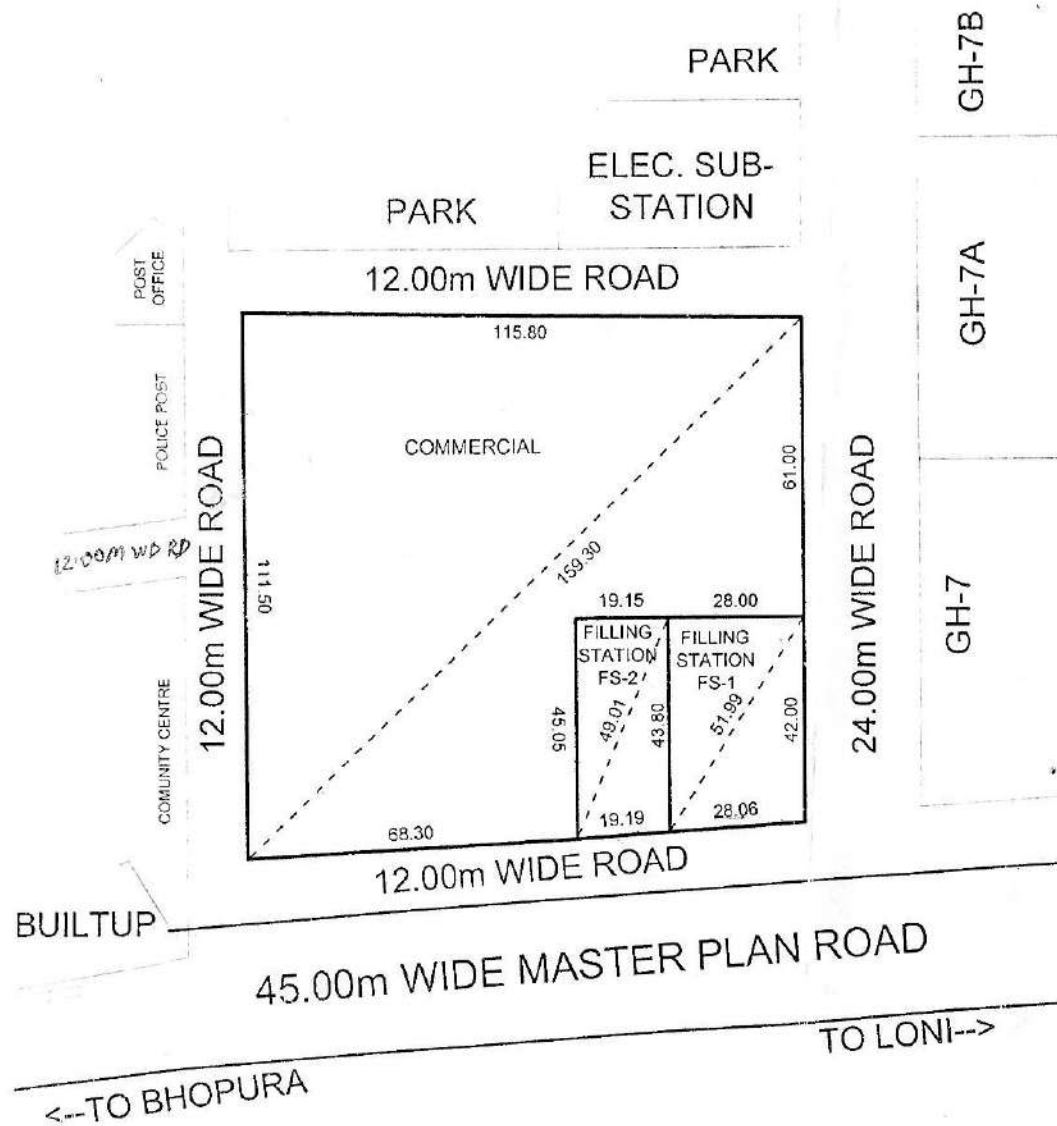

AREA SCHEDULE

FILLING STATION (FS-1)	= 1201.86 Sqmt.
FILLING STATION (FS-2)	= 850.90 Sqmt.
COMMERCIAL	= 10343.29 Sqmt.



D/Man

AMIN

J.E.

A.E.

Ex. E.

OSD. (L.A)

T. P. (R)

T. P. (K)

C.A.T.P.

SECRETARY

VICE CHAIRMAN