

SITE PLAN OF PLOT NO- 71/ AT A - BLOCK GOVINDPURAM GZ

PLOT AREA NO OF 71/8 TO 71/10 = 127.00 SQ.MT.

PLOT AREA NO OF 71/6 = 290.35 SQ.MT.

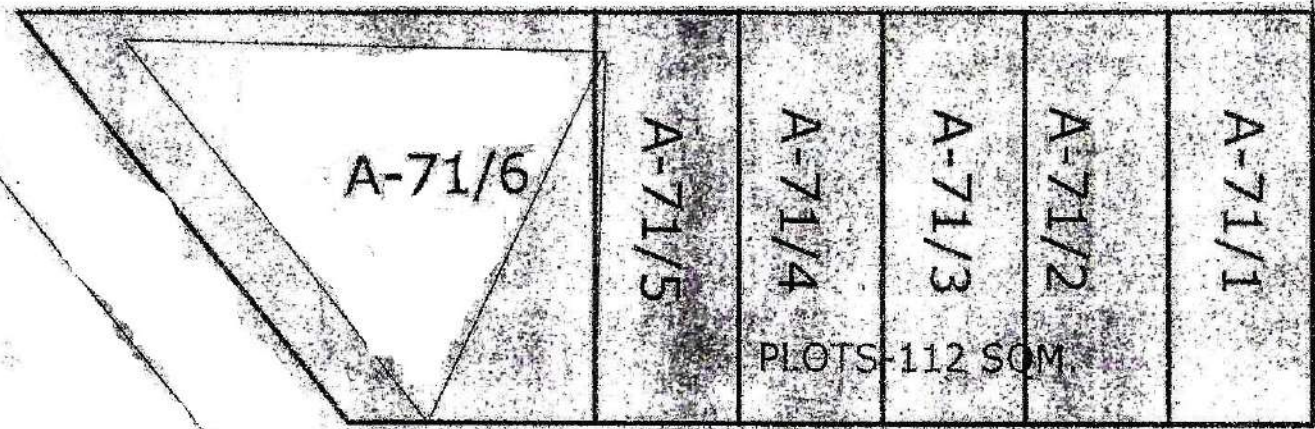

9.0M WIDE ROAD

9.0M WIDE ROAD

PREPARED BY

COMPARED BY

J.E.

A.T.

E.E.

T.P.

PROPOSED SITE PLAN OF PLOT NO. - 45/3 TO 45/10, BLOCK-C, BRIJ VIHAR
SECTOR-8, T.H.A., GHAZIABAD

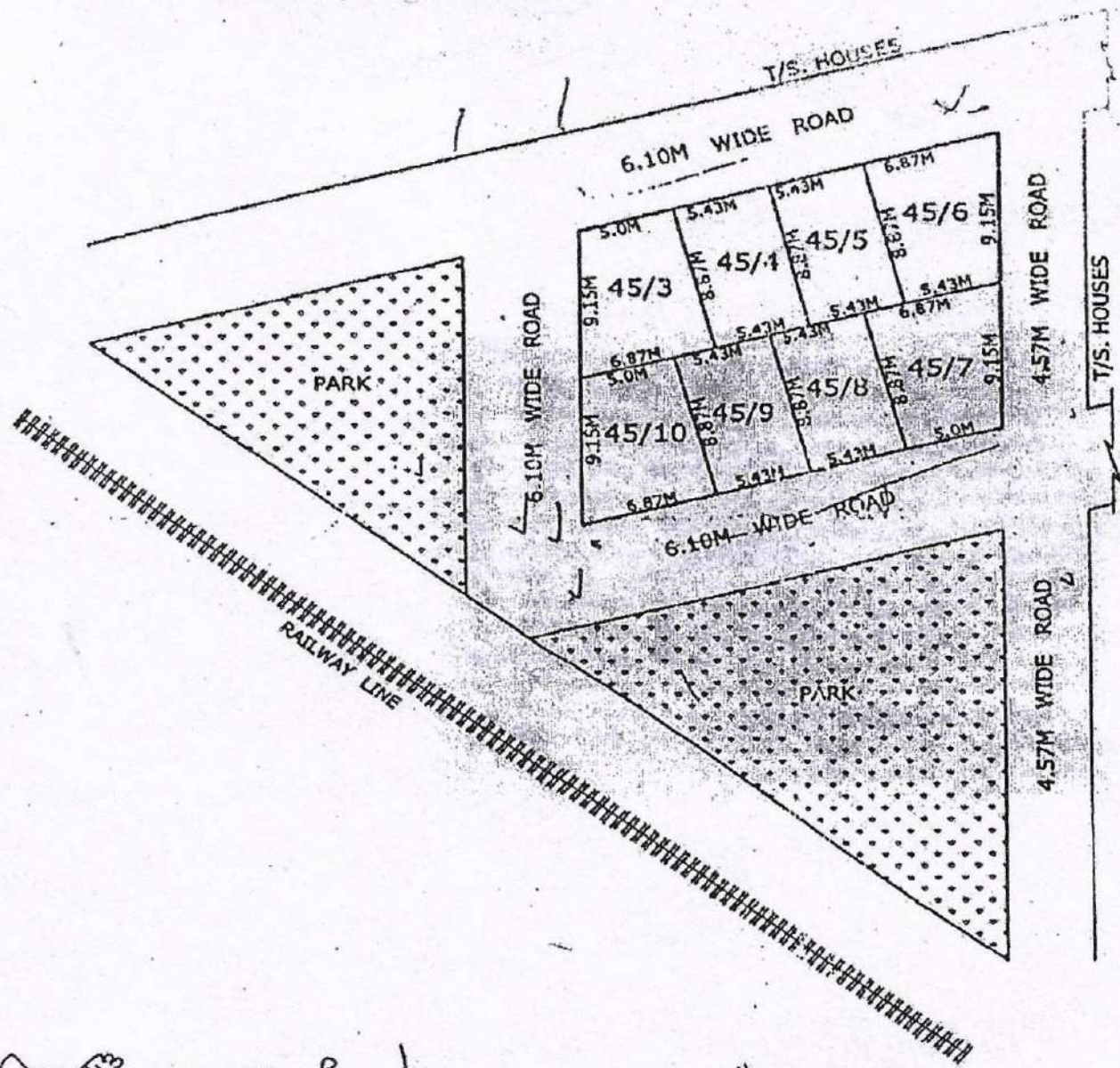

AREA CHART

P.NO. 45/3	=	55.85	SQM.
P.NO. 45/4	=	48.19	SQM.
P.NO. 45/5	=	48.19	SQM.
P.NO. 45/6	=	55.85	SQM.
P.NO. 45/7	=	56.20	SQM.
P.NO. 45/8	=	48.19	SQM.
P.NO. 45/9	=	48.19	SQM.
P.NO. 45/10	=	55.55	SQM.

[Signature]
12/03/13
D/MAN

[Signature]
J.E

[Signature]
A.E

[Signature]
E.E

[Signature]
27/3/13
TOWN PLANNER

[Signature]
27/3/13
C.A.T.P

CEGV

[Signature]

SITE PLAN OF PLOT NO. CP- AT C-BLOCK GOVINDPURAM.

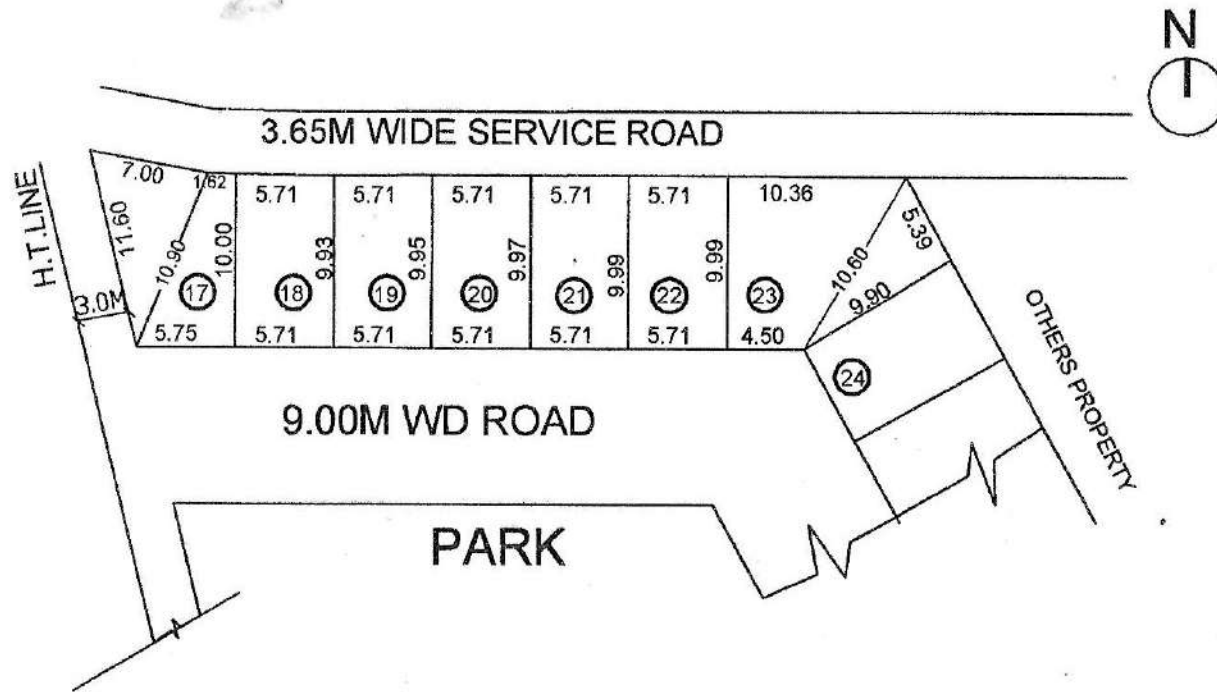

AREA CHART	
PLOT NO.	AREA
17	74.10 SQM
18	56.91 SQM
19	56.76 SQM
20	56.91 SQM
21	57.00 SQM
22	57.15 SQM
23	101.02 SQM

[Signature]
19-11-15
PREPARED BY.

[Signature]
11/12/15
COMPARED BY.

[Signature]
9/12/15
J.E.

[Signature]
9/12/15
A.E.

[Signature]
EX.EN

[Signature]
T.P

PART LAYOUT PLAN OF SHOPS PLOT , HOTEL, COMMERCIAL & NURSING HOME PLOT ON COMMERCIAL (COM-2) PLOT & COMMERCIAL/RESIDENTIAL (C/G.H.-1) PLOT IN POCKET C , MADHUBAN BAPUDHAM YOJNA GHAZIABAD

TOATAL AREA OF LAND	= 60938.57 SQ.M.	SHOPS PLOT - 10.00M. X 28.15M.	- 281.50 SQ.M.	- 10 (C/S.P.-06 TO C/S.P.-15)
AREA UNDER SHOPS PLOT	= 21632.30 SQ.M.	SHOPS PLOT - 10.00M. X 20.00M.	- 200.00 SQ.M.	- 38 (C/S.P.-50 TO C/S.P.-64 ,C/S.P.-89 TO C/S.P.- 111)
AREA UNDER HOTEL	= 1788.72 SQ.M.	SHOPS PLOT - 09.00M. X 18.00M.	- 162.00 SQ.M.	- 39 (C/S.P.-01 TO C/S.P.-05 ,C/S.P.-16 TO C/S.P.- 49)
AREA UNDER NURSING HOME	= 1308.58 SQ.M.	SHOPS PLOT - 08.00M. X 12.50M.	- 100.00 SQ.M.	- 47 (C/S.P.-65 TO C/S.P.-88 ,C/S.P.- 112 TO C/S.P.-134)
AREA UNDER COMMERCIAL	= 1154.00 SQ.M.	TOTAL NOS. OF SHOPS PLOT	- 134	
AREA UNDER MULTILEVEL P.	= 5468.95 SQ.M.			
AREA UNDER TOILET /D.W.	= 322.60 SQ.M.			
AREA UNDER GREEN/CENTRAL PLAZA	= 7877.60 SQ.M.			
AREA UNDER CAR PARKING	= 2824.32 SQ.M.			
AREA UNDER PAVED PATHWAY	= 18561.50 SQ.M.			
TOTAL NOS. OF CAR IN CAR PARKING	- 185			

SHOPS PLOT
 F.A.R = 3 - G.F.L.,F.F. & S.F. (AS PER CONTROL DRG.)
 (BASEMENT AREA IS FREE FORM FAR.)
 GROUND COVERAGE = 100 %



REVISED PART LAYOUT PLAN OF FILLING STATIONS (FS-1 & FS-2) COMMERCIAL PLOT AT KOYAL ENCLAVE SCHEME, LONI, GHAZIABAD

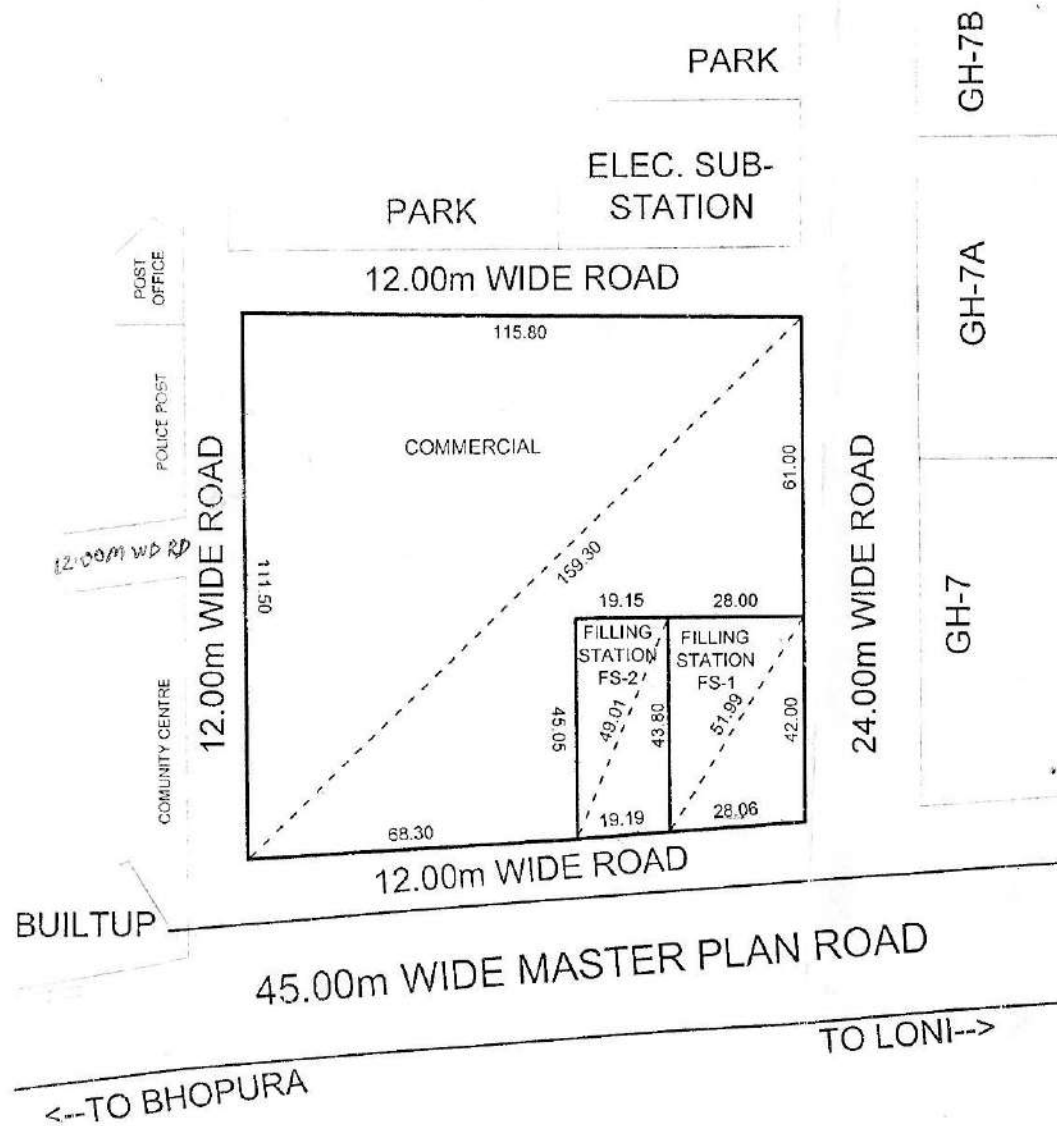

AREA SCHEDULE

FILLING STATION (FS-1)	= 1201.86 Sqmt.
FILLING STATION (FS-2)	= 850.90 Sqmt.
COMMERCIAL	= 10343.29 Sqmt.

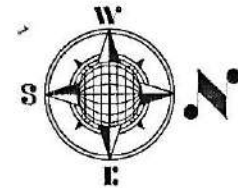

GH-7B

GH-7A

GH-7

D/Man

AMIN

J.E.

A.E.

Ex. E.

OSD. (L.A.)

T. P. (R)

T. P. (K)

C.A.T.P.

SECRETARY

VICE CHAIRMAN

REVISED PART LAYOUT PLAN OF COMMERCIAL LAND IN INDRAPRASTH YOZNA, POCKET - H, LONI, GZB.

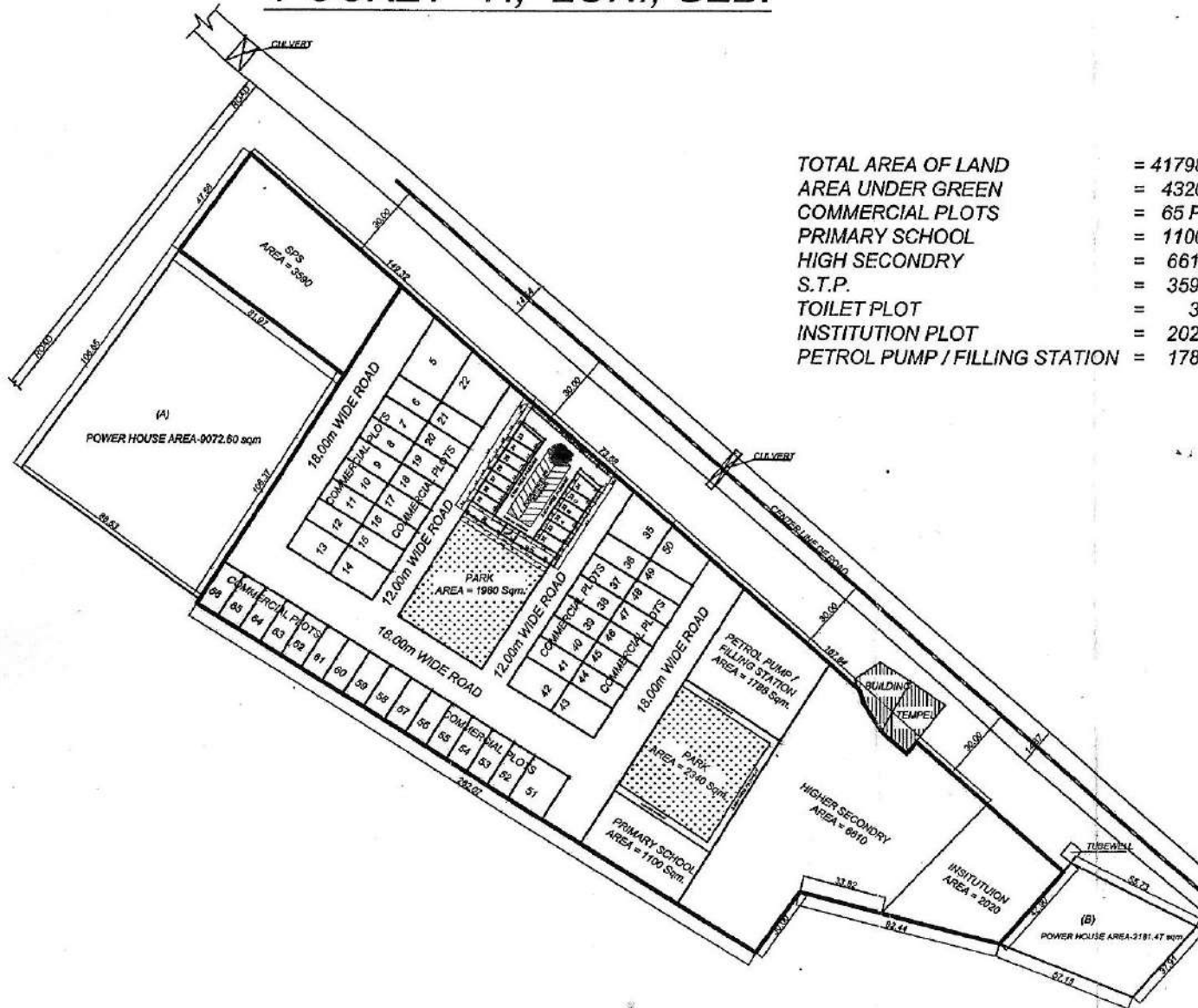
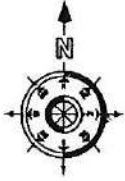

TOTAL AREA OF LAND	= 41798.00 Sqm.
AREA UNDER GREEN	= 4320.00 Sqm.
COMMERCIAL PLOTS	= 65 PLOTS
PRIMARY SCHOOL	= 1100.00 Sqm.
HIGH SECONDARY	= 6610.00 Sqm.
S.T.P.	= 3590.00 Sqm.
TOILET PLOT	= 30.00 Sqm.
INSTITUTION PLOT	= 2020.00 Sqm.
PETROL PUMP / FILLING STATION	= 1788.00 Sqm.

AREA SCHEDULE (COMM. PLOTS)

PLOT Nos.	AREA (IN Sqm.)
5	510.00
6 To 12	195.00
13 & 14	270.00
15 To 21	195.00
22	445.00
23	64.05
24 To 29	55.00
30 & 31	85.00
32 & 33	55.00
33A, 33B & 33C	55.00
34	65.20
35	380.00
36 To 41	195.00
42 & 43	270.00
44 To 49	195.00
50	292.00
51	314.00
52 To 66	195.00

SITE PLAN OF PLOT NO-NP- IN 1 BLOCK GOVINDPURAM GMP. GZD

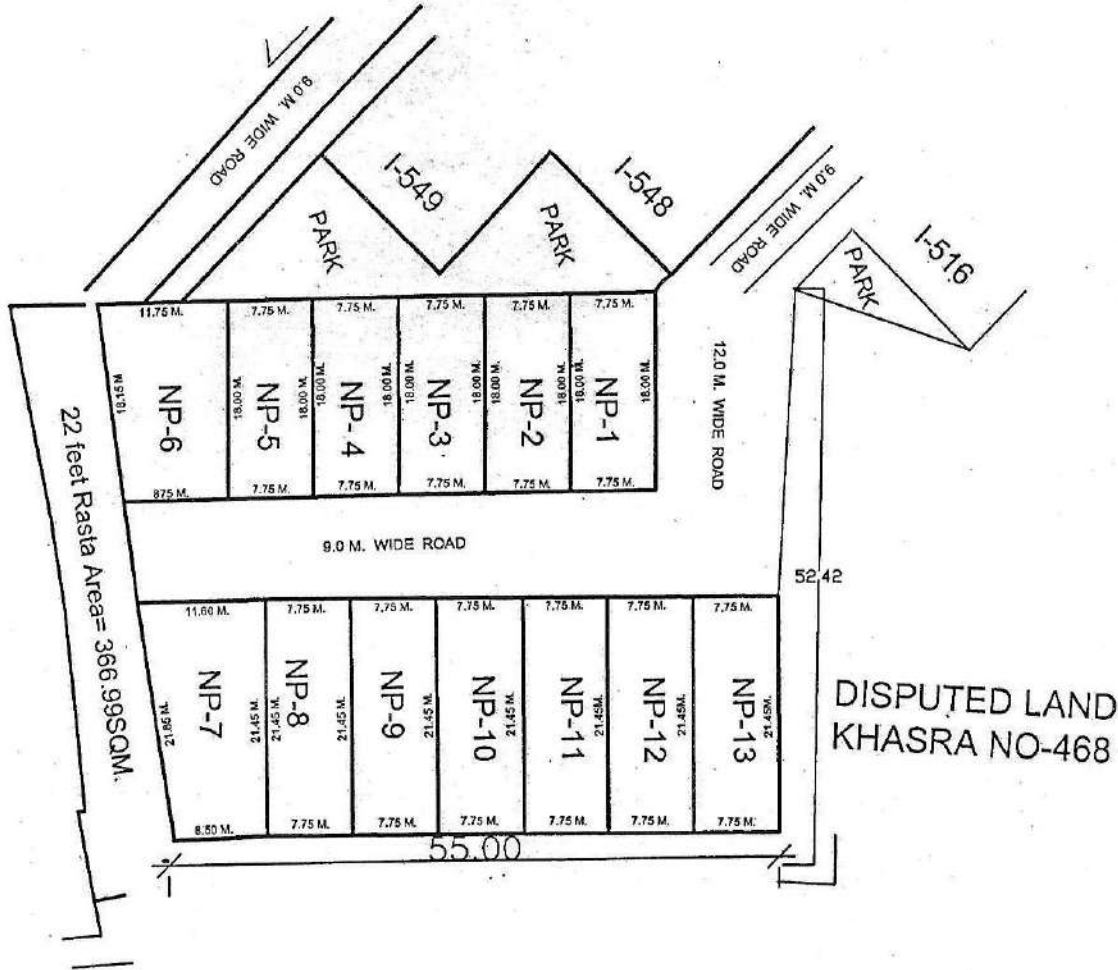

PLOT NO-	AREA
NP- 1	139.50SQM.
NP- 2	139.50SQM.
NP- 3	139.50SQM.
NP- 4	139.50SQM.
NP- 5	139.50SQM.
NP- 6	184.50 SQM.
NP- 7	215.57 SQM.
NP- 8	166.23 SQM.
NP- 9	166.23 SQM.
NP- 10	166.23 SQM.
NP- 11	166.23 SQM.
NP- 12	166.23 SQM.
NP- 13	166.23 SQM.

PREPARED BY

COMPARED BY

J.E

A.E

EE-3



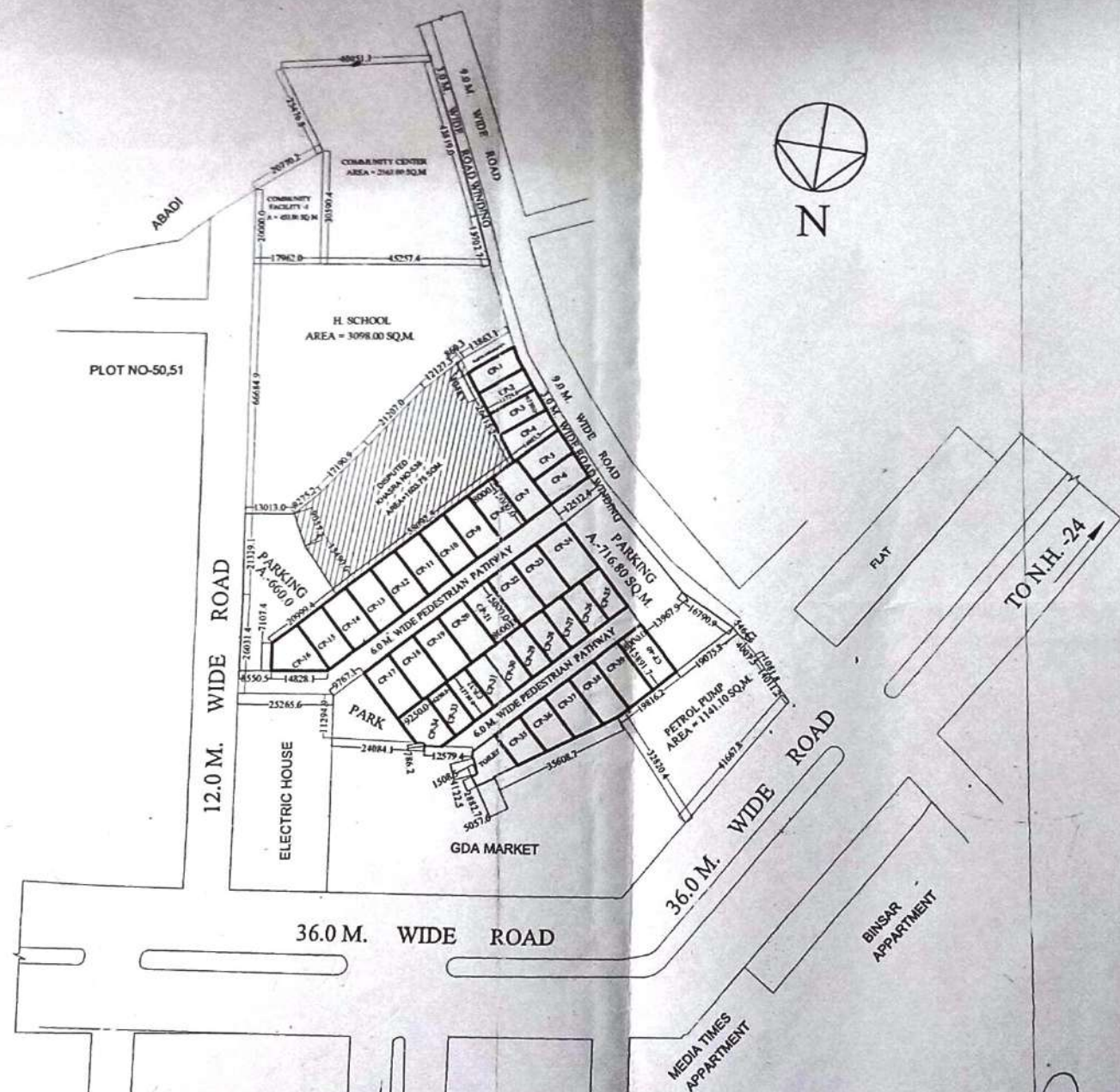

T.P

REV. PART LAYOUT PLAN OF COMMERCIAL PLOTS (VEHICLE FREE) AT NYAY KHAND-1 INDIRAPURAM GZB.

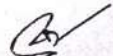
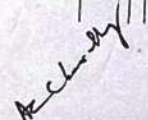

AREA-CHART

CP-1	= 87.02 Sqmt.
CP-2	= 88.07 Sqmt.
CP-3	= 88.71 Sqmt.
CP-4	= 101.05 Sqmt.
CP-5	= 94.87 Sqmt.
CP-6	= 99.13 Sqmt.
CP-7 to CP-15	= 120.00 Sqmt.
CP-16	= 116.24 Sqmt.
CP-17 to CP-23	= 120.00 Sqmt.
CP-24	= 142.25 Sqmt.
CP-25 to CP-33	= 79.68 Sqmt.
CP-34	= 107.11 Sqmt.
CP-35	= 85.84 Sqmt.
CP-36	= 99.21 Sqmt.
CP-37	= 112.59 Sqmt.
CP-38	= 124.48 Sqmt.
CP-39	= 126.61 Sqmt.
CP-40	= 126.69 Sqmt.
PARKING	= 1376.80 Sqmt.

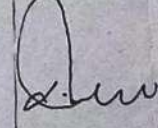
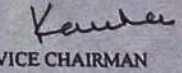
 D/MAN
  J.E.
  A.E.
  E.E.
 T.P.(R)
  T.P.(G)
 24/11/2020
  SECERATRY
  VICE CHAIRMAN

REVISED PART LAYOUT PLAN OF C.CENTER, H. SCHOOL, COMM. & PETROL PUMP AT NYAY KHAND-1 INDIRAPURAM GHAZIABAD.

NOTE - A, B, C, D AREA IS UNDER G.D.A. OWNERSHIP

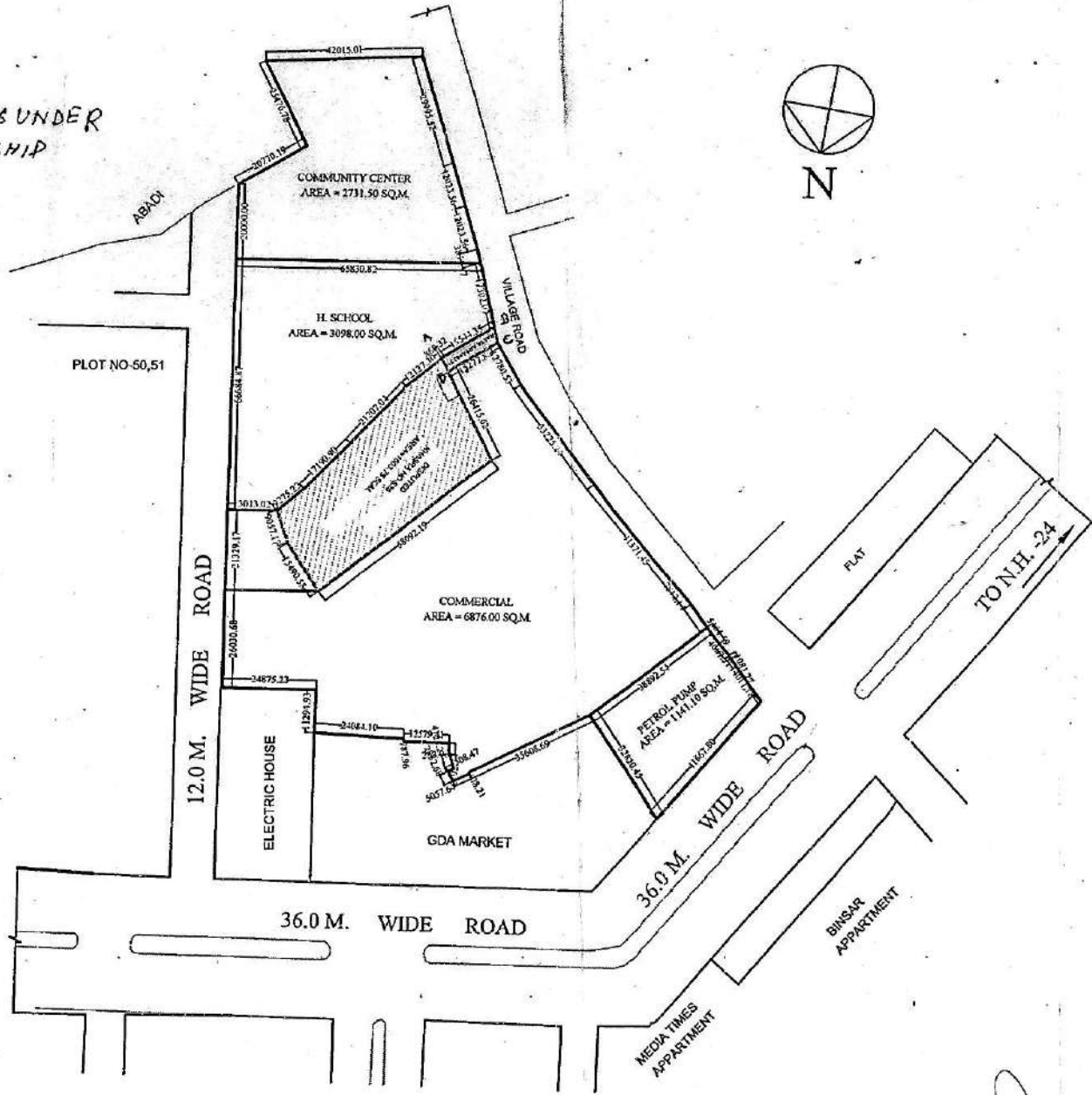

[Signature]
DMAN

[Signature]
AMIN

[Signature]
A.T.P.

[Signature]
A.E.

[Signature]
S.E.

26-3-18
E.E.

TEH.-I.A.

[Signature]
T.P.

[Signature]
C.A.T.P.

[Signature]
SECRATRY

[Signature]
VICE CHAIRMAN

REVISED LAYOUT PLAN OF INDUSTRIAL POCKET MADHUBAN-BAPUDHAM SCHEME AT NH-58 GZB.

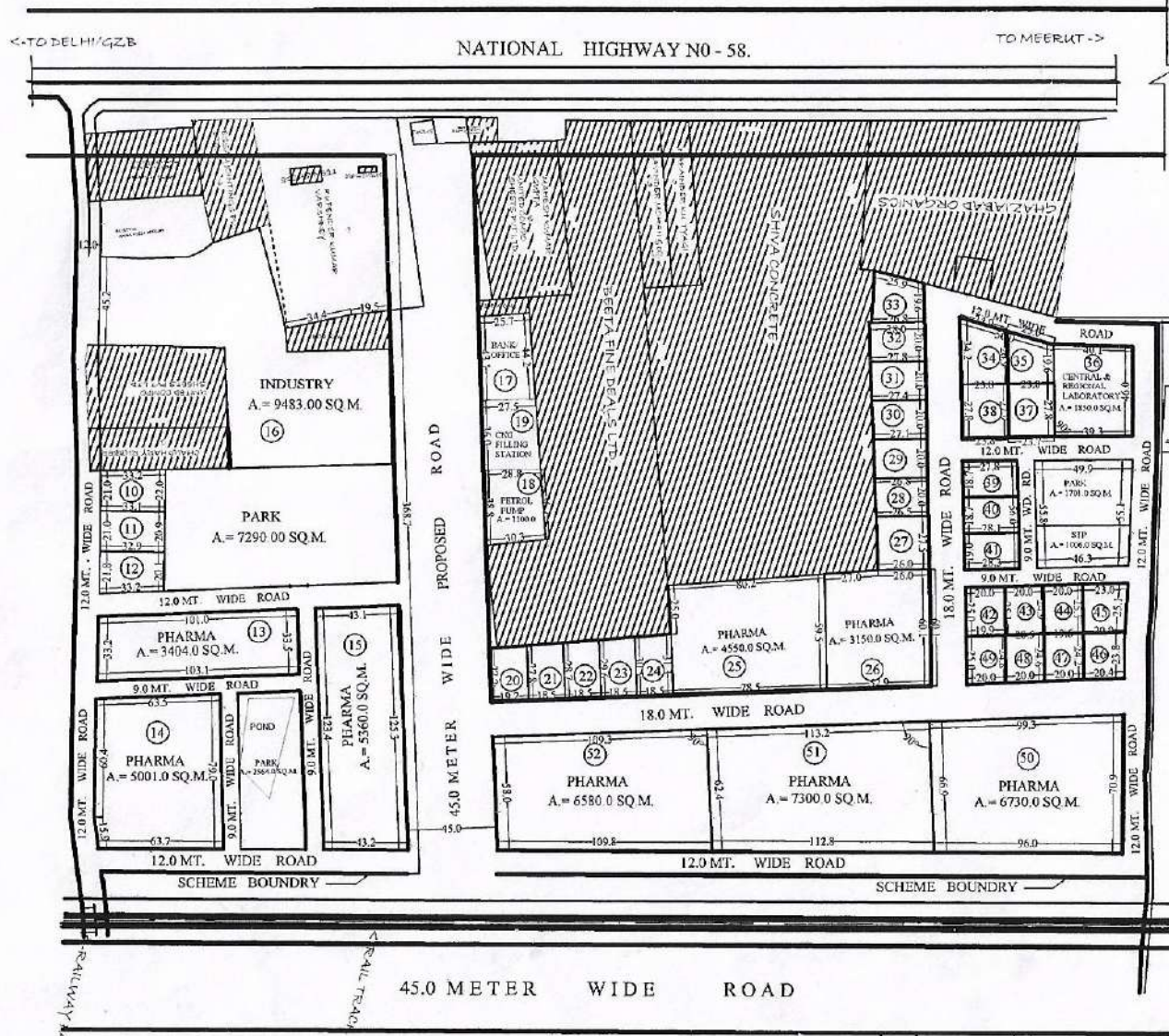

AREA DETAIL
AREA OF SCHEME = 114476.0 SQ.M.
 (EXCLUDING 45.0 MT. WIDE PROPOSED ROAD)
 AREA UNDER PLOT = 73925.0 SQ.M.
 AREA UNDER S.T.P. = 1006.0 SQ.M.
 AREA UNDER PARK = 11555.0 SQ.M.
 AREA UNDER ROAD = 27990.0 SQ.M.

PLOT NO.	USE	AREA (APROX) Sq.M.
10 to 12	INDUSTRIAL	692.00 (EACH)
13	PHARMA	3404.00
14	PHARMA	5001.00
15	PHARMA	5360.00
16	INDUSTRY	9483.00
17	BANK/OFF.	1158.00
19	C.N.G. FILL ST.	1012.00
18	PETROL PUMP	1100.00
20 to 24	INDUSTRIAL	540.00 (EACH)
25	PHARMA	4550.00
26	PHARMA	3150.00
27	INDUSTRIAL	525.00
28	INDUSTRIAL	533.00
29	INDUSTRIAL	539.00
30	INDUSTRIAL	545.00
31	INDUSTRIAL	552.00
32	INDUSTRIAL	558.00
33	INDUSTRIAL	527.00
34	INDUSTRIAL	743.90
35	INDUSTRIAL	567.70
36	CENT REG. LAB.	1850.00
37	INDUSTRIAL	661.41
38	INDUSTRIAL	662.83
39	INDUSTRIAL	519.86
40	INDUSTRIAL	525.47
41	INDUSTRIAL	535.80
42	INDUSTRIAL	498.78
43	INDUSTRIAL	500.00
44	INDUSTRIAL	500.00
45	INDUSTRIAL	550.94
46	INDUSTRIAL	495.60
47	INDUSTRIAL	483.12
48	INDUSTRIAL	506.35
49	INDUSTRIAL	496.75
50	PHARMA	6730.00
51	PHARMA	7300.00
52	PHARMA	6580.00

pocket-b

REVISIED PART LAYOUT PLAN OF COMMERCIAL PLOT C-1/1 TO C-1/16 & GROUP HOUSING PLOT GH-4 AT, KOYAL ENCLAVE SCHEME, LONI, G.D.A. GHAZIABAD



COMMERCIAL SET BACK
 BELOW 200.00 Sqmt. FRONT - 1.50 Sqmt.
 ABOVE 200.00 Sqmt. FRONT - 1.50 Sqmt.
 FRONT - 1.00 Sqmt. REAR - 1.00 Sqmt.
 REAR - 1.00 Sqmt. SIDE - 1.00 Sqmt.
 SIDE - 1.00 Sqmt.



AREA SCHEDULE	
PLOT No.	AREA (IN Sqmt.)
C-1/1 ✓	469.78
C-1/2 ✓	457.36
C-1/3 ✓	485.00
C-1/4 ✓	570.61
C-1/5 ✓	153.40
C-1/6 to C-1/11 ✓	112.50
C-1/12 ✓	120.00
C-1/13 ✓	458.71
C-1/14 & C-1/15 ✓	413.32
C-1/16	456.29
GH-04	12867.54

COMMERCIAL PLOTS
 SET BACK COVERAGE - 1.50m

 26/08/2020
 JUNIOR ENGINEER
 ASSISTANT ENGINEER
 SUPERINTENDENT ENGINEER
 TOWN PLANNER (I)
 TOWN PLANNER (II)
 SECRETARY
 VICE CHAIRMAN







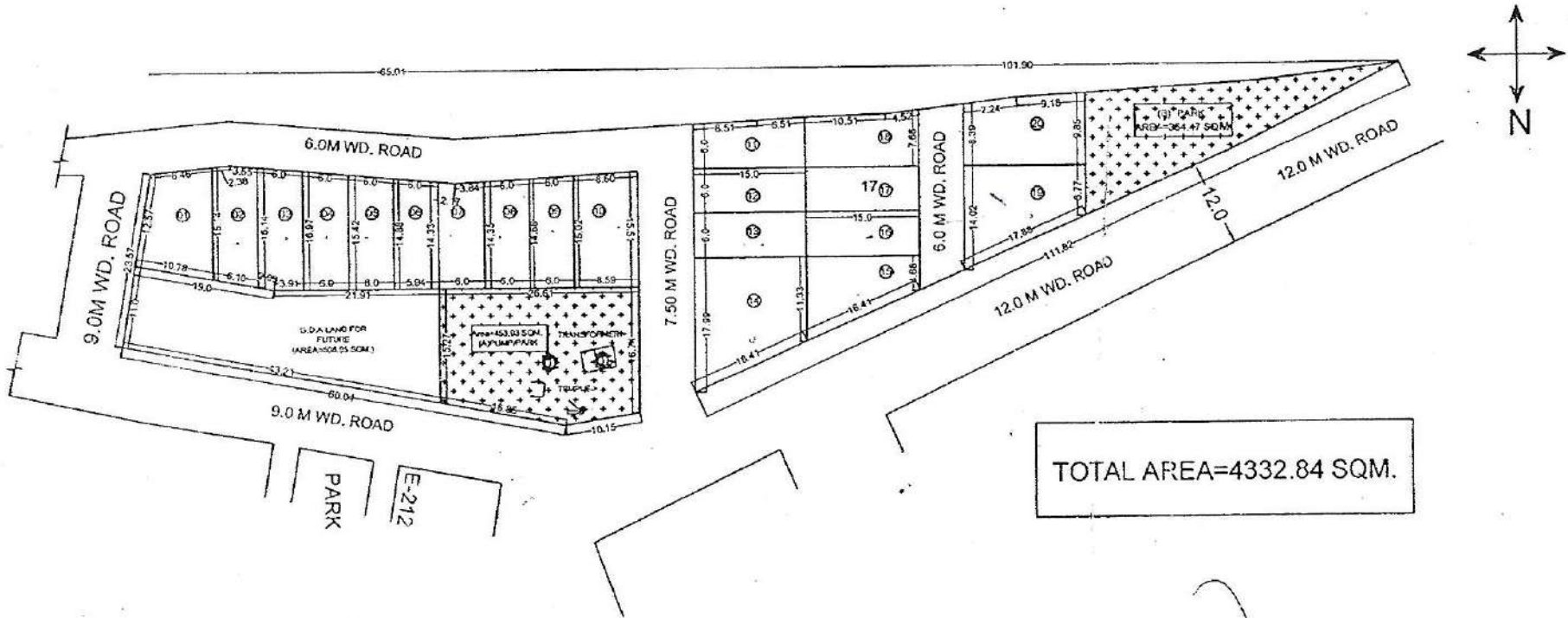

PART . A

S.NO.	PLOT NO.	AREA
(01)	E-01	131.51 SQM.
(02)	E-02	94.62 SQM.
(03)	E-03	97.09 SQM.
(04)	E-04	94.20 SQM.
(05)	E-05	90.91 SQM.
(06)	E-06	87.62 SQM.
(07)	E-07	84.81 SQM.
(08)	E-08	87.09 SQM.
(09)	E-09	89.12 SQM.
(10)	E-10	131.09 SQM.
(11)	E-11	95.94 SQM.
(12)	E-12	90.00 SQM.

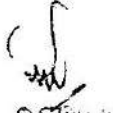
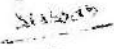
PART . A

S.NO.	PLOT NO.	AREA
((13)	E-13	90.00 SQM.
(14)	E-14	219.77 SQM.
(15)	E-15	120.03 SQM.
(16)	E-16	90.00 SQM.
(17)	E-17	90.00 SQM.
(18)	E-18	106.28 SQM.
(19)	E-19	169.91 SQM.
(20)	E-20	151.00 SQM.
PARK		
(01)	A	453.03 SQM.
(02)	B	354.47 SQM.

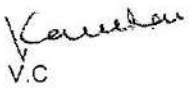

 D/MAN
  AMIN
  O.S.D. (L.A.S.)
  J.E.
  A.E.
  E.E.
  T.P.(R)
  T.P.(K)
  SECY.
  V.C.

PART LAY OUT PLAN FOR NANDGRAM BLOCK - E. GHAZIABAD

91

PART . B

PART . B

S.NO.	PLOT NO.	AREA	S.NO.	PLOT NO.	AREA
(21)	E-21	187.55 SQM.	(34)	E-34	97.74 SQM.
(22)	E-22	90.61 SQM.	(35)	E-35	91.76 SQM.
(23)	E-23	91.87 SQM.	(36)	E-36	84.67 SQM.
(24)	E-24	113.28 SQM.	(37)	E-37	79.48 SQM.
(25)	E-25	99.15 SQM.	(38)	E-38	80.54 SQM.
(26)	E-26	90.05 SQM.	(39)	E-39	87.71 SQM.
(27)	E-27	90.05 SQM.	(40)	E-40	98.74 SQM.
(28)	E-28	133.27 SQM.	(41)	E-41	116.59 SQM.
(29)	E-29	142.53 SQM.	(42)	E-42	108.00 SQM.
(30)	E-30	88.94 SQM.	(43)	E-43	153.78 SQM.
(31)	E-31	93.50 SQM.	(44)	E-44	86.74 SQM.
(32)	E-32	103.93 SQM.	(45)	E-45	86.00 SQM.
(32)	E-32	103.93 SQM.	(46)	E-46	85.07 SQM.
(33)	E-33	98.31 SQM.			
			PARK		
(01)	A	313.05 SQM.			

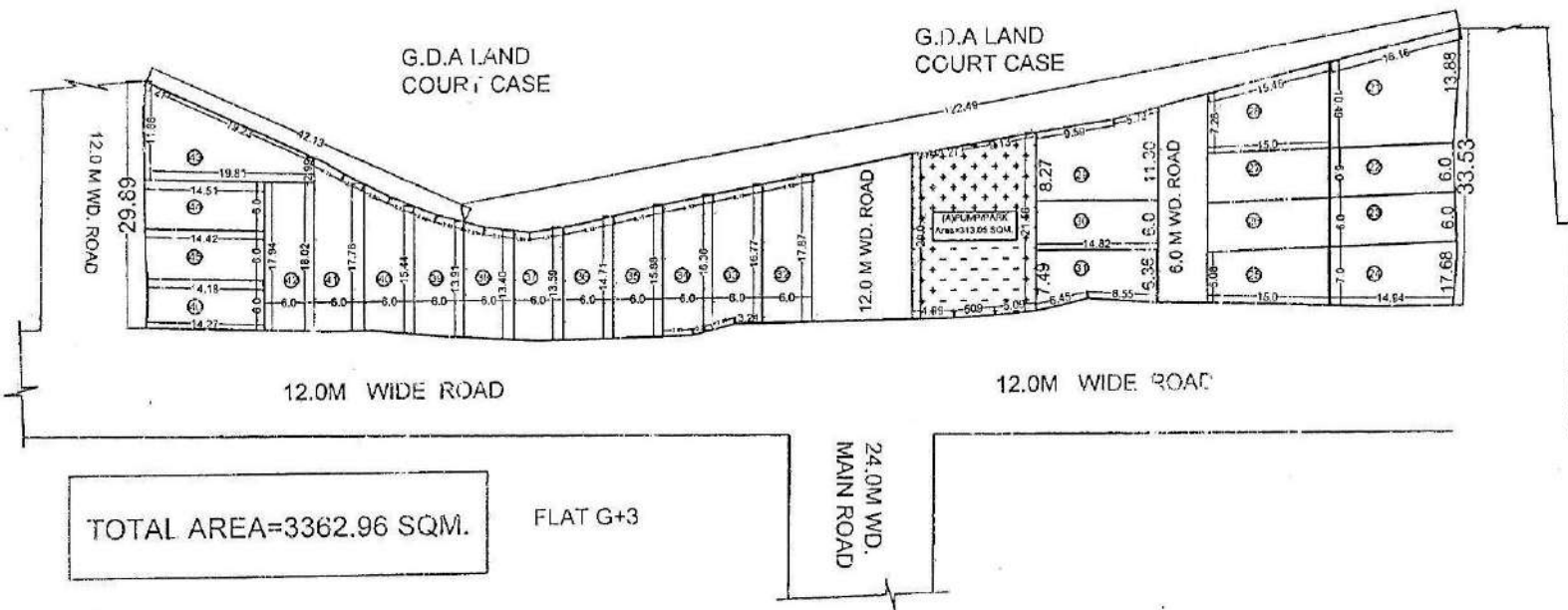

D/MAN AMIN OSD(LA) J.E A.E E.E. T.P(R) T.P(K) C.A.T.P SECY. V.C

SITE PLAN FOR KIOSK IN "D" BLOCK PATEL NAGAR, SECTOR - 7 G.M.P. GHAZIABAD

Scale -1:500

AREA OF KIOSK LAND = 116.84 Sqm.

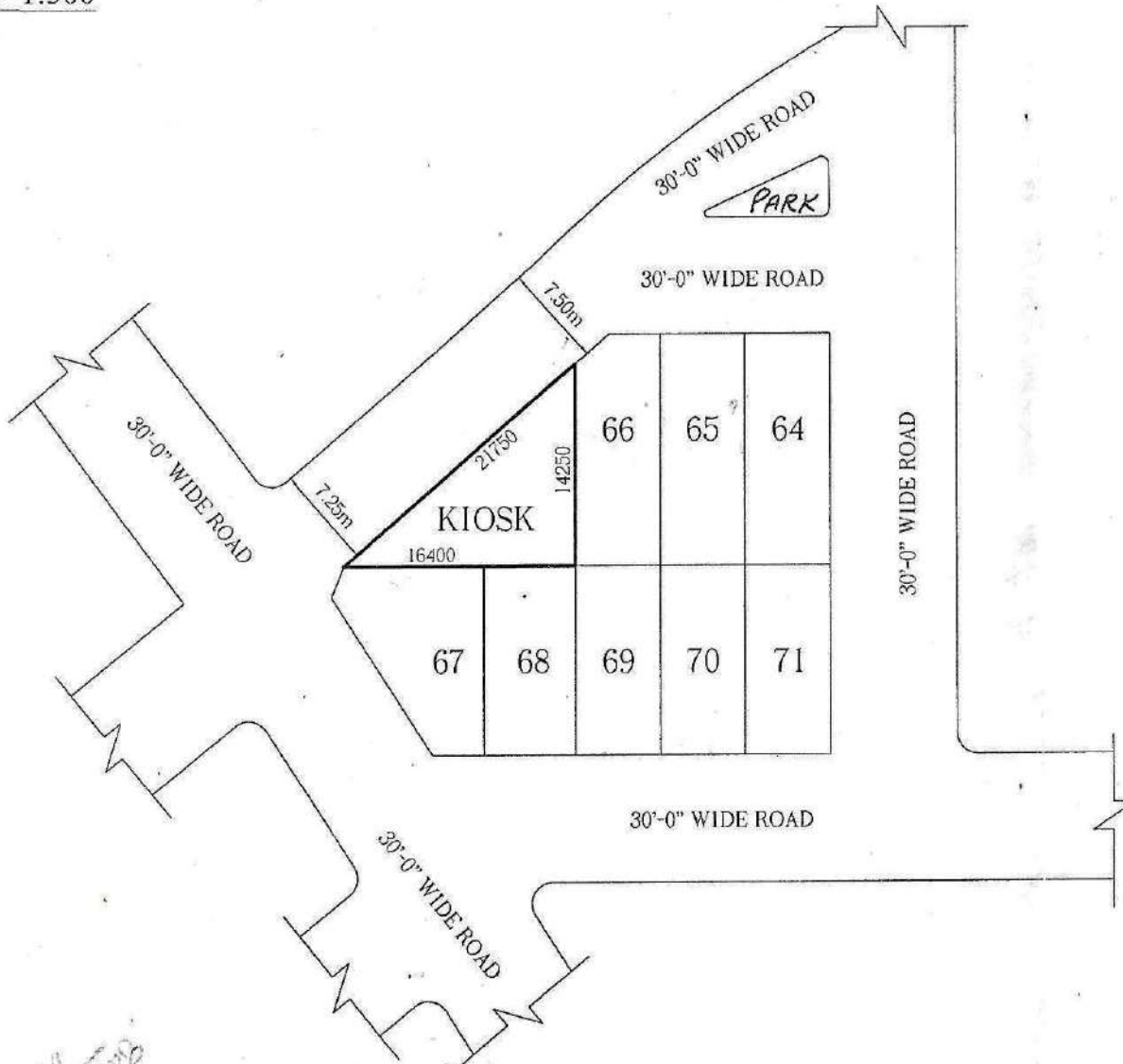

[Signature]
22.4.08

Prepared By.

[Signature]
22.4.08

Compared By.

[Signature]
22.4.08
Measured By.

[Signature]
22.4.08
Asth. Engineer

[Signature]
23/4/08
A.T.P.

[Signature]
Town Planner.

PROPOSED PART LAYOUT PLAN AT SECTOR III, BEHIND CHAAYA PUBLIC SCHOOL.VAISHALI

(POCKET - NP)

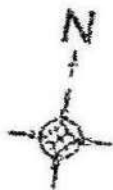

PLOTS SIZE = 16.50 X 8.50 M.
 AREA = 140.25 SQ M.
 NO. OF PLOTS = 18

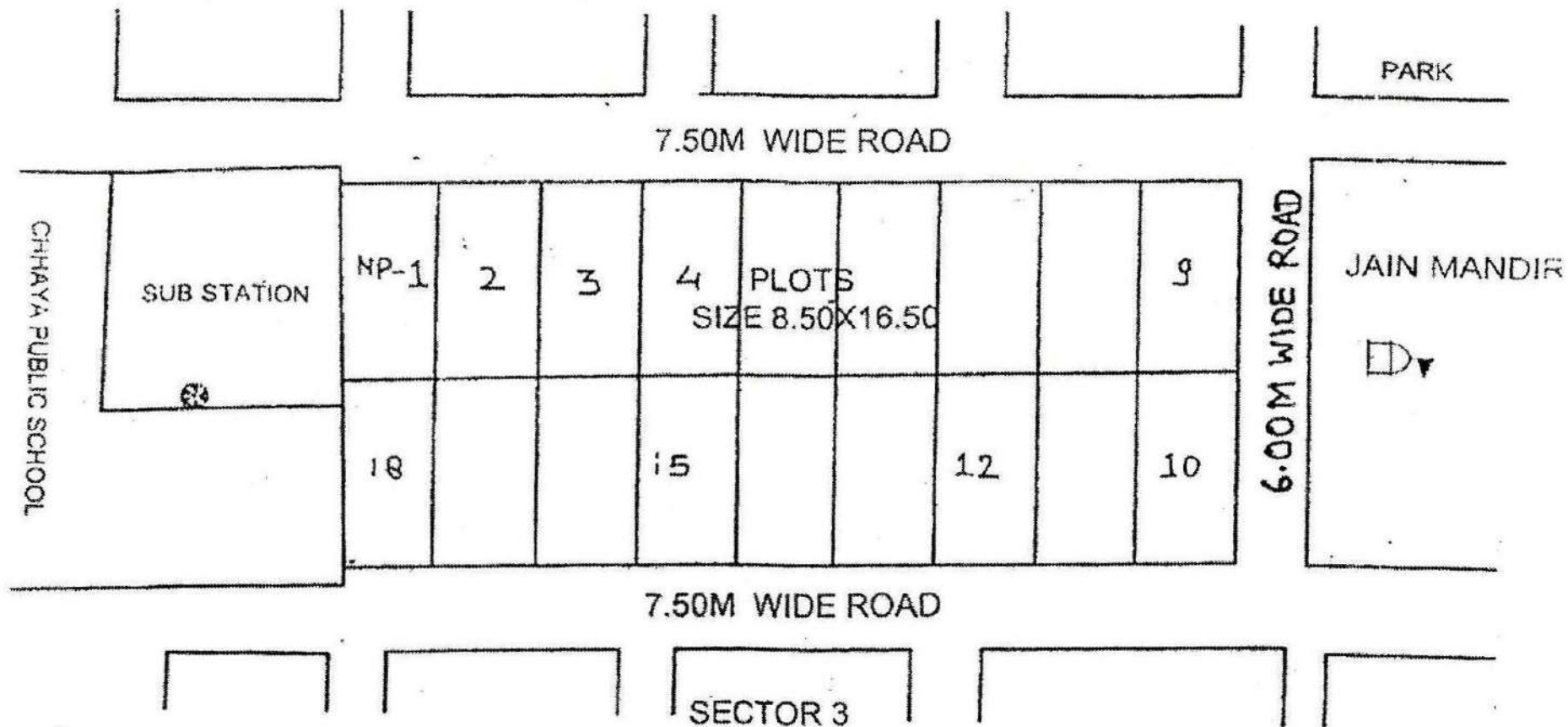

[Signature]
 D/IAN

[Signature]
 19/10/12
 TOWN PLANNER

[Signature]
 CATP

[Signature]
 SECY.

[Signature]