

SITE PLAN OF PLOT NO- 71/ AT A - BLOCK GOVINDPURAM GZ

PLOT AREA NO OF 71/8 TO 71/10 = 127.00 SQ.MT.

PLOT AREA NO OF 71/6 = 290.35 SQ.MT.

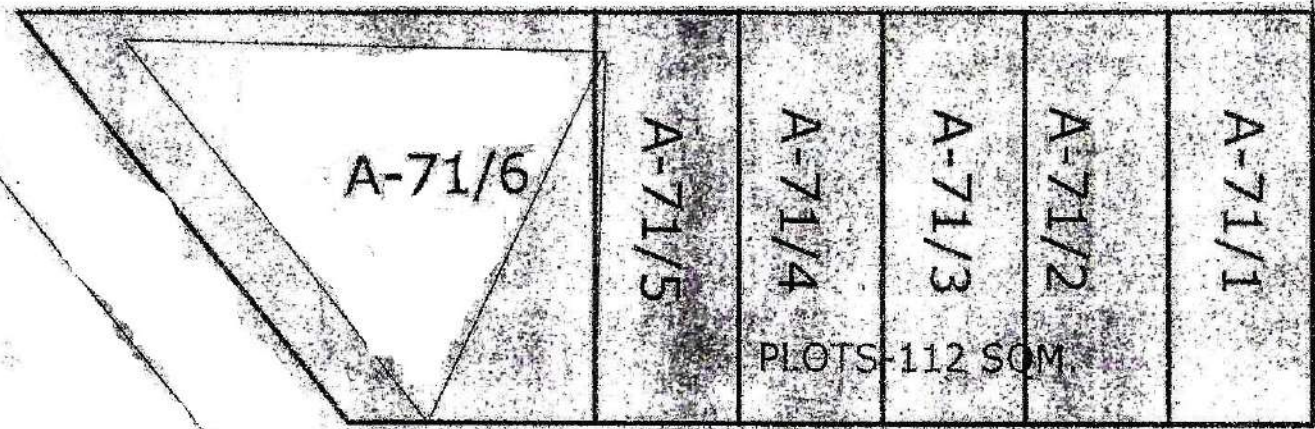

9.0M WIDE ROAD

9.0M WIDE ROAD

PREPARED BY

COMPARED BY

J.E.

A.T.

E.E.

T.P.

PROPOSED SITE PLAN OF PLOT NO. - 45/3 TO 45/10, BLOCK-C, BRIJ VIHAR
SECTOR-8, T.H.A., GHAZIABAD

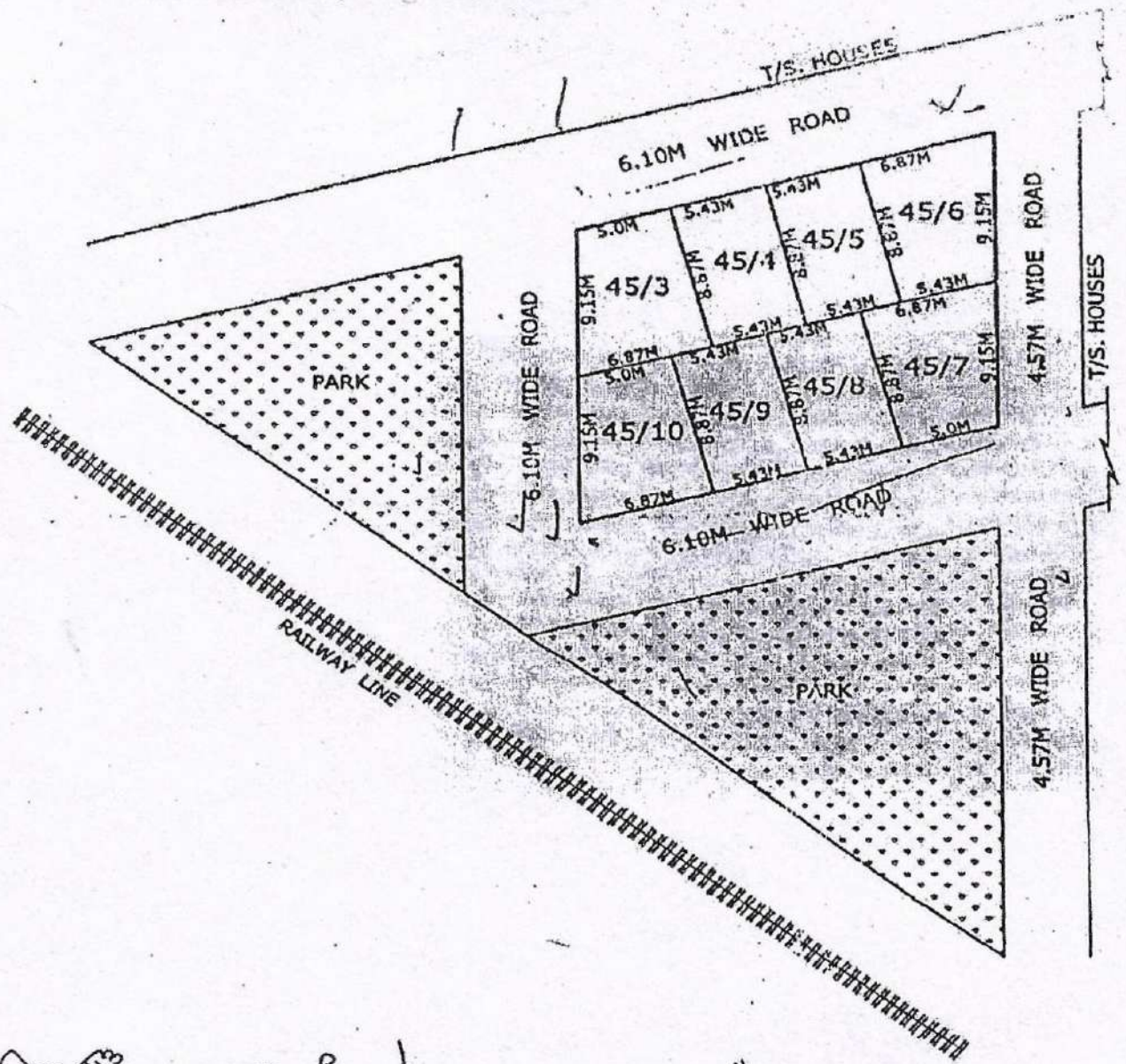

AREA CHART

- P.NO. 45/3=55.85 SQM.
- P.NO. 45/4=48.19 SQM.
- P.NO. 45/5=48.19 SQM.
- P.NO. 45/6=55.85 SQM.
- P.NO. 45/7=56.20 SQM.
- P.NO. 45/8=48.19 SQM.
- P.NO. 45/9=48.19 SQM.
- P.NO.45/10=55.55 SQM.

[Signature]
12/03/13
D/MAN

[Signature]
J.E

[Signature]
A.E

[Signature]
E.E

[Signature]
27/3/13
TOWN PLANNER

[Signature]
25/3/13
C.A.T.P

CEGV

[Signature]

SITE PLAN OF PLOT NO. CP- AT C-BLOCK GOVINDPURAM.

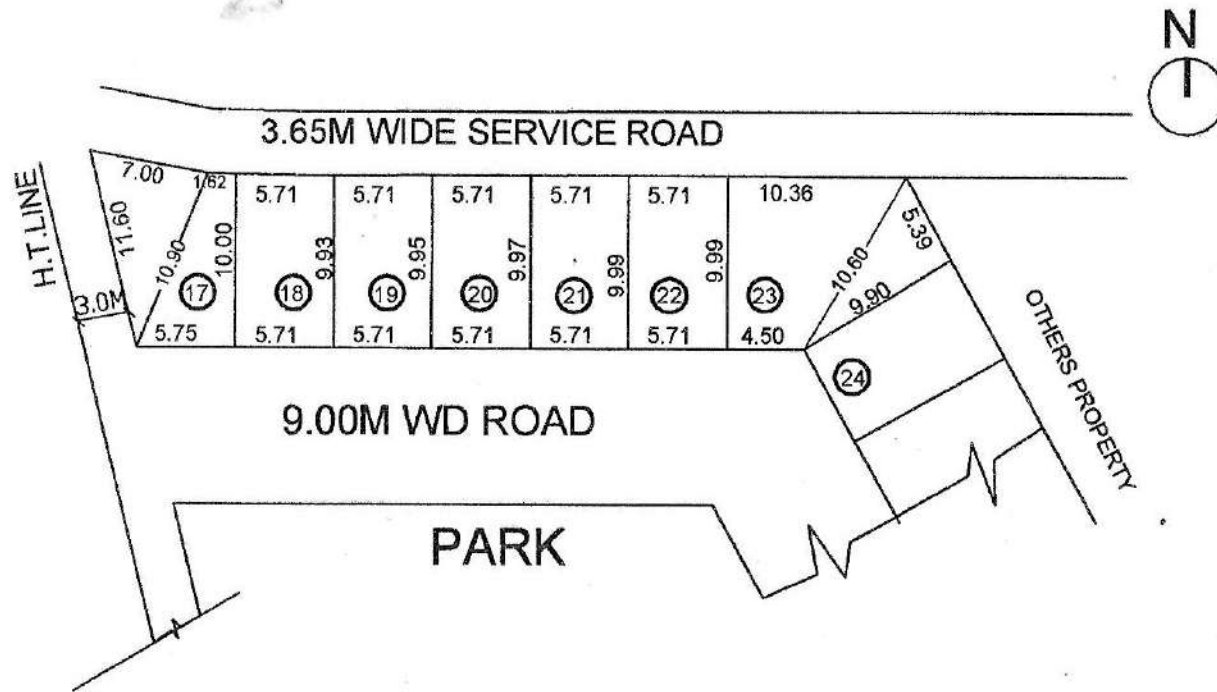

AREA CHART	
PLOT NO.	AREA
17	74.10 SQM
18	56.91 SQM
19	56.76 SQM
20	56.91 SQM
21	57.00 SQM
22	57.15 SQM
23	101.02 SQM

S/S
19-11-15
PREPARED BY.

Handwritten signature
11/12/15
COMPARED BY.

Handwritten signature
9/12/15
J.E.

Handwritten signature
9/12/15
A.E.

Handwritten signature
EX.EN

Handwritten signature
T.P

PART LAYOUT PLAN OF SHOPS PLOT , HOTEL, COMMERCIAL & NURSING HOME PLOT ON COMMERCIAL (COM-2) PLOT & COMMERCIAL/RESIDENTIAL (C/G.H.-1) PLOT IN POCKET C , MADHUBAN BAPUDHAM YOJNA GHAZIABAD

TOATAL AREA OF LAND	= 60938.57 SQ.M.	SHOPS PLOT - 10.00M. X 28.15M.	- 281.50 SQ.M.	- 10 (C/S.P.-06 TO C/S.P.-15)
AREA UNDER SHOPS PLOT	= 21632.30 SQ.M.	SHOPS PLOT - 10.00M. X 20.00M.	- 200.00 SQ.M.	- 38 (C/S.P.-50 TO C/S.P.-64 ,C/S.P.-89 TO C/S.P.- 111)
AREA UNDER HOTEL	= 1788.72 SQ.M.	SHOPS PLOT - 09.00M. X 18.00M.	- 162.00 SQ.M.	- 39 (C/S.P.-01 TO C/S.P.-05 ,C/S.P.-16 TO C/S.P.- 49)
AREA UNDER NURSING HOME	= 1308.58 SQ.M.	SHOPS PLOT - 08.00M. X 12.50M.	- 100.00 SQ.M.	- 47 (C/S.P.-65 TO C/S.P.-88 ,C/S.P.- 112 TO C/S.P.-134)
AREA UNDER COMMERCIAL	= 1154.00 SQ.M.	TOTAL NOS. OF SHOPS PLOT	- 134	
AREA UNDER MULTILEVEL P.	= 5468.95 SQ.M.			
AREA UNDER TOILET /D.W.	= 322.60 SQ.M.			
AREA UNDER GREEN/CENTRAL PLAZA	= 7877.60 SQ.M.			
AREA UNDER CAR PARKING	= 2824.32 SQ.M.			
AREA UNDER PAVED PATHWAY	= 18561.50 SQ.M.			
TOTAL NOS. OF CAR IN CAR PARKING	- 185			

SHOPS PLOT
 F.A.R = 3 - G.F.L.,F.F. & S.F. (AS PER CONTROL DRG.)
 (BASEMENT AREA IS FREE FORM FAR.)
 GROUND COVERAGE = 100 %



REVISED PART LAYOUT PLAN OF FILLING STATIONS (FS-1 & FS-2) COMMERCIAL PLOT AT KOYAL ENCLAVE SCHEME, LONI, GHAZIABAD

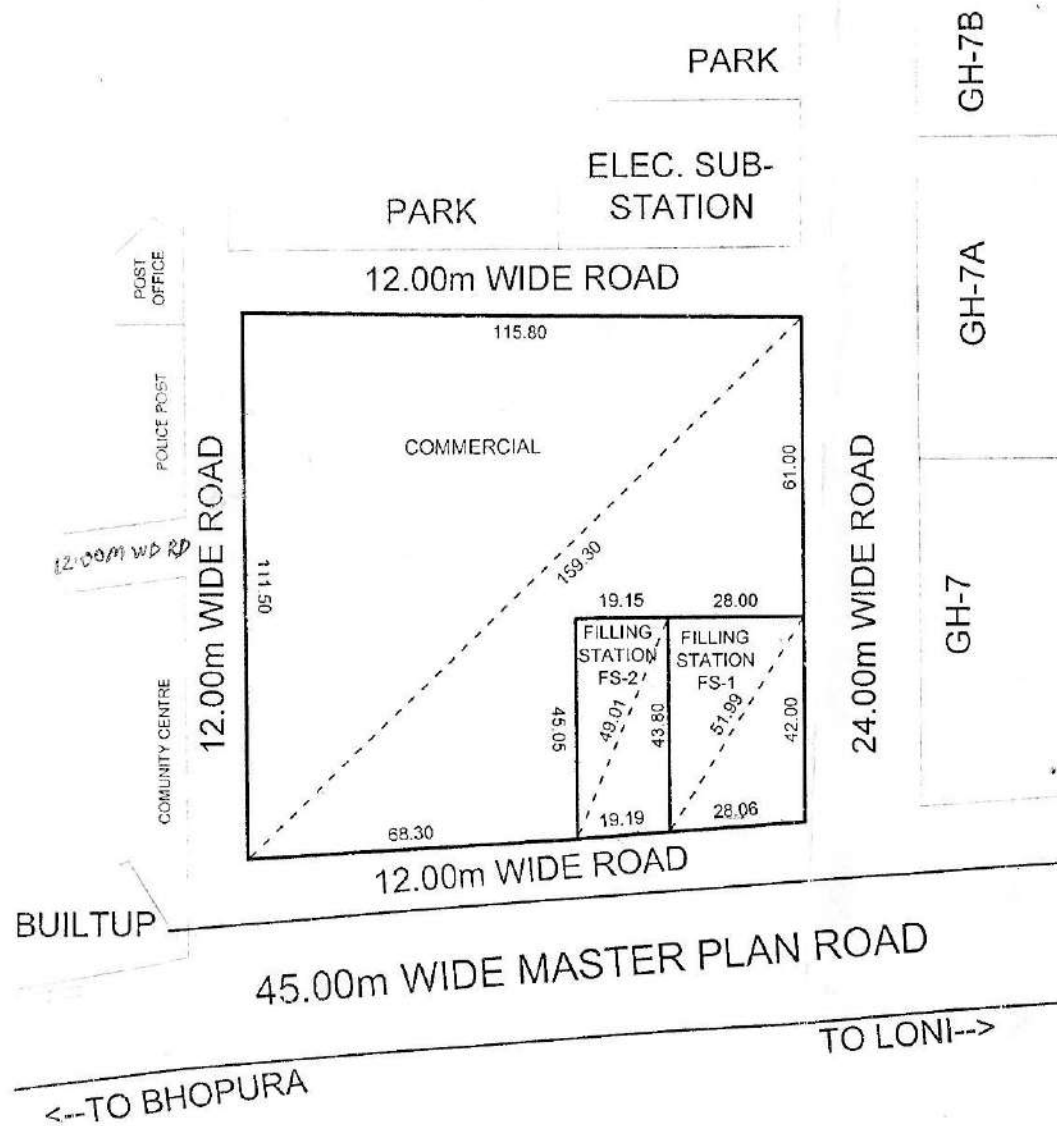

AREA SCHEDULE

FILLING STATION (FS-1)	= 1201.86 Sqmt.
FILLING STATION (FS-2)	= 850.90 Sqmt.
COMMERCIAL	= 10343.29 Sqmt.



AMIN
J.E. *[Signature]*
A.E. *[Signature]*
Ex. E. *[Signature]*
OSD. (L.A.) *[Signature]*
T. P. (R) *[Signature]*
T. P. (K) *[Signature]*
C.A.T.P. *[Signature]* SECRETARY
[Signature] VICE CHAIRMAN

REVISED PART LAYOUT PLAN OF COMMERCIAL LAND IN INDRAPRASTH YOZNA, POCKET - H, LONI, GZB.

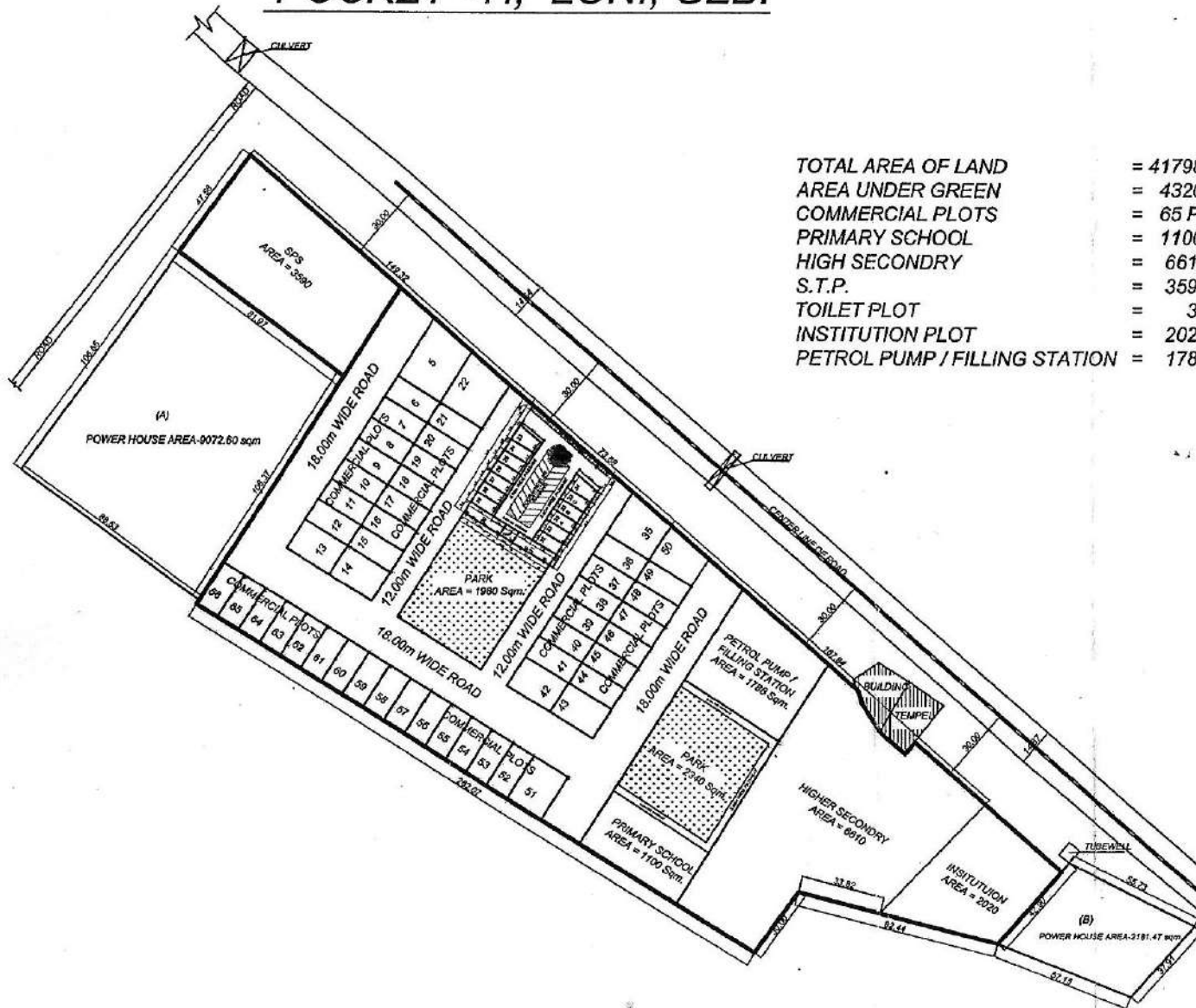
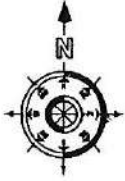

TOTAL AREA OF LAND	= 41798.00 Sqm.
AREA UNDER GREEN	= 4320.00 Sqm.
COMMERCIAL PLOTS	= 65 PLOTS
PRIMARY SCHOOL	= 1100.00 Sqm.
HIGH SECONDRY	= 6610.00 Sqm.
S.T.P.	= 3590.00 Sqm.
TOILET PLOT	= 30.00 Sqm.
INSTITUTION PLOT	= 2020.00 Sqm.
PETROL PUMP / FILLING STATION	= 1788.00 Sqm.

AREA SCHEDULE (COMM. PLOTS)

PLOT Nos.	AREA (IN Sqm.)
5	510.00
6 To 12	195.00
13 & 14	270.00
15 To 21	195.00
22	445.00
23	64.05
24 To 29	55.00
30 & 31	85.00
32 & 33	55.00
33A, 33B & 33C	55.00
34	65.20
35	380.00
36 To 41	195.00
42 & 43	270.00
44 To 49	195.00
50	292.00
51	314.00
52 To 66	195.00

SITE PLAN OF PLOT NO-NP- IN 1 BLOCK GOVINDPURAM GMP, GZD

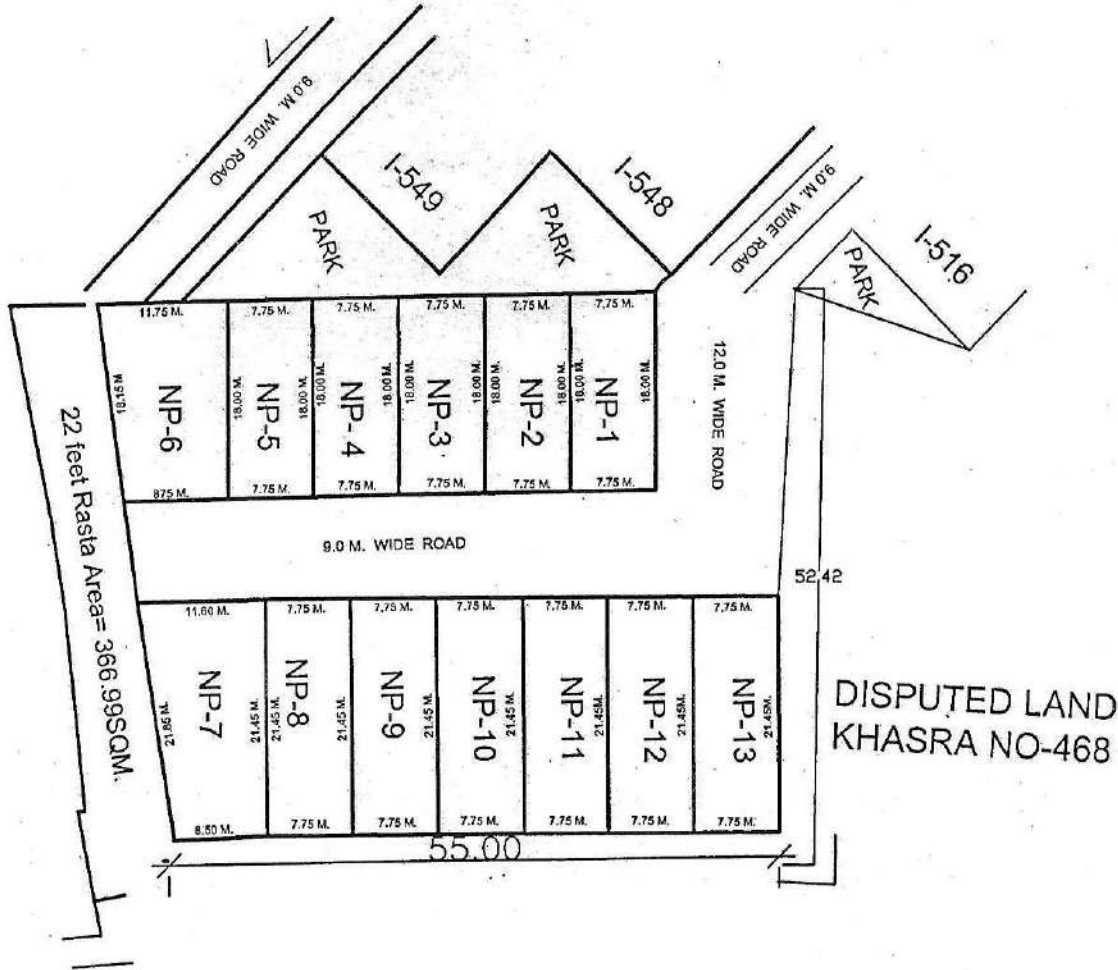

PLOT NO-	AREA
NP- 1	139.50SQM.
NP- 2	139.50SQM.
NP- 3	139.50SQM.
NP- 4	139.50SQM.
NP- 5	139.50SQM.
NP- 6	184.50 SQM.
NP- 7	215.57 SQM.
NP- 8	166.23 SQM.
NP- 9	166.23 SQM.
NP- 10	166.23 SQM.
NP- 11	166.23 SQM.
NP- 12	166.23 SQM.
NP- 13	166.23 SQM.

PREPARED BY

COMPARED BY

J.E

A.E

EE-3

T.P

REV. PART LAYOUT PLAN OF COMMERCIAL PLOTS (VEHICLE FREE) AT NYAY KHAND-1 INDIRAPURAM GZB.

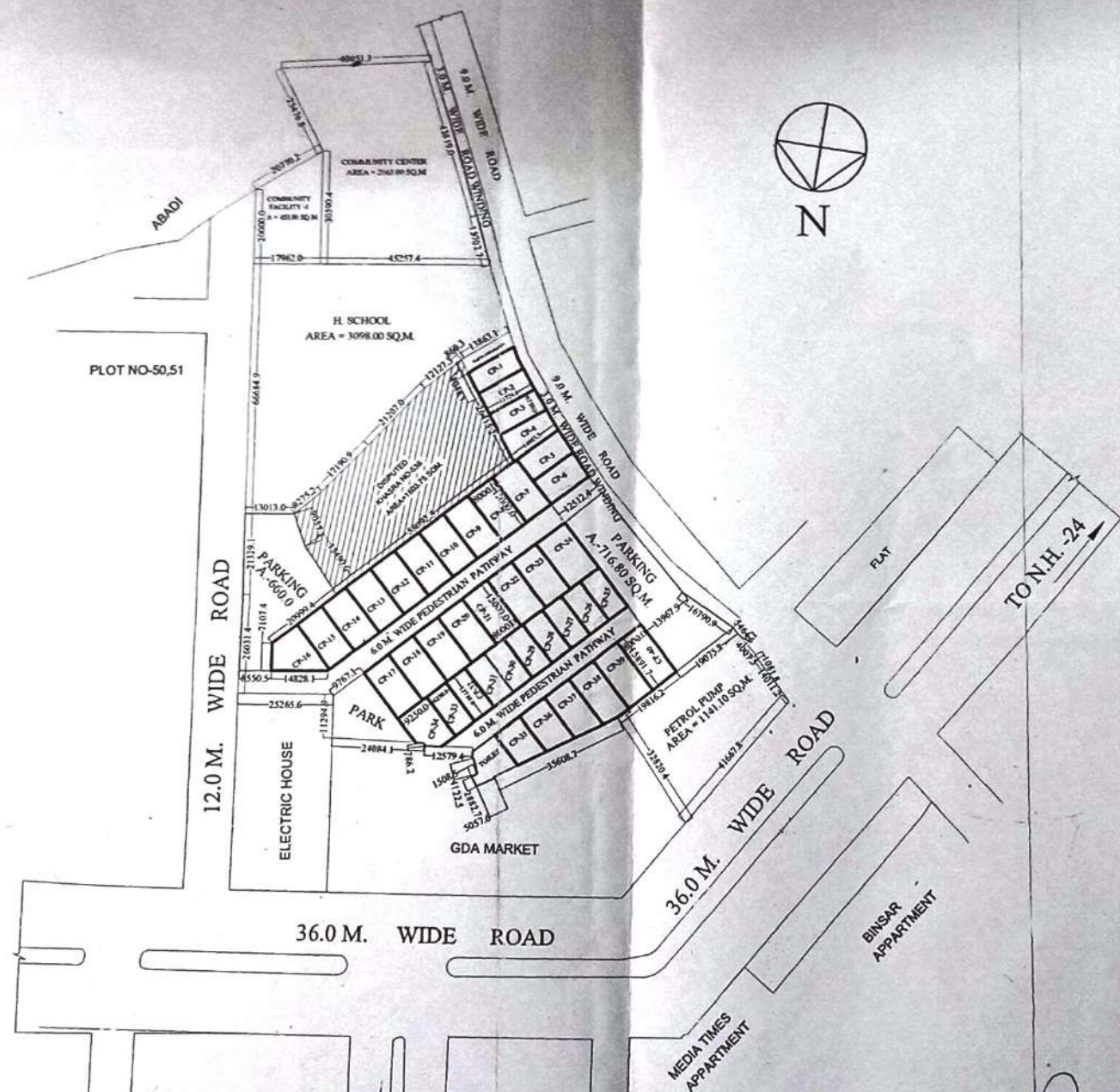

AREA-CHART

CP-1	= 87.02 Sqmt.
CP-2	= 88.07 Sqmt.
CP-3	= 88.71 Sqmt.
CP-4	= 101.05 Sqmt.
CP-5	= 94.87 Sqmt.
CP-6	= 99.13 Sqmt.
CP-7 to CP-15	= 120.00 Sqmt.
CP-16	= 116.24 Sqmt.
CP-17 to CP-23	= 120.00 Sqmt.
CP-24	= 142.25 Sqmt.
CP-25 to CP-33	= 79.68 Sqmt.
CP-34	= 107.11 Sqmt.
CP-35	= 85.84 Sqmt.
CP-36	= 99.21 Sqmt.
CP-37	= 112.59 Sqmt.
CP-38	= 124.48 Sqmt.
CP-39	= 126.61 Sqmt.
CP-40	= 126.69 Sqmt.
PARKING	= 1376.80 Sqmt.

D/MAN J.E. A.E. E.E. T.P.(R) T.P.(G) SECRETARY VICE CHAIRMAN

24/11/2020

REVISED PART LAYOUT PLAN OF C.CENTER, H. SCHOOL, COMM. & PETROL PUMP AT NYAY KHAND-1 INDIRAPURAM GHAZIABAD.

NOTE - A, B, C, D AREA IS UNDER G.D.A. OWNERSHIP

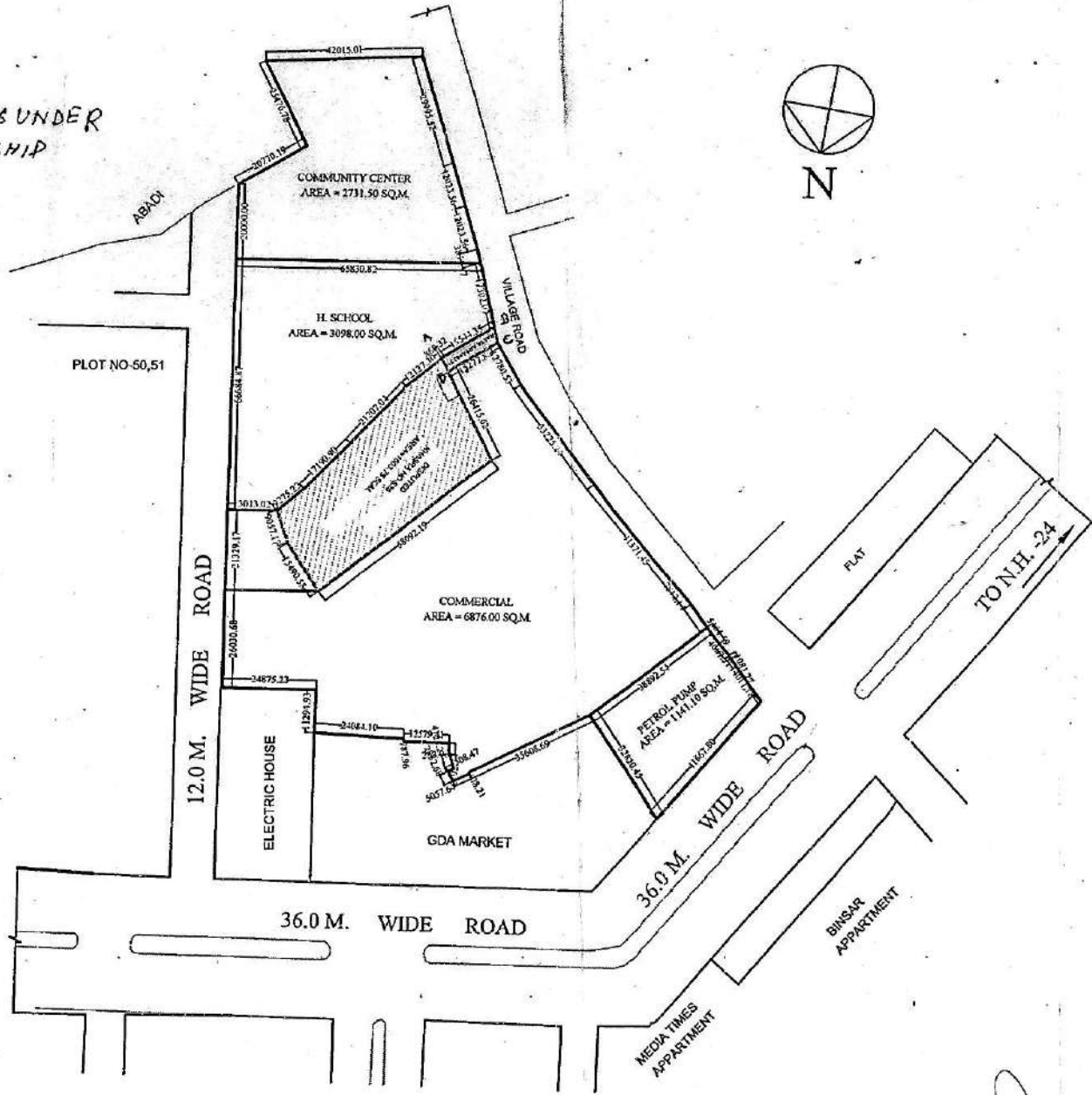

[Signature]
DMAN

[Signature]
AMIN

[Signature]
A.T.P.

[Signature]
A.E.

[Signature]
S.E.

26-3-18
E.E.

TEH.-I.A.

[Signature]
T.P.

[Signature]
C.A.T.P.

[Signature]
SECRATRY

[Signature]
VICE CHAIRMAN

REVISED LAYOUT PLAN OF INDUSTRIAL POCKET MADHUBAN-BAPUDHAM SCHEME AT NH-58 GZB.

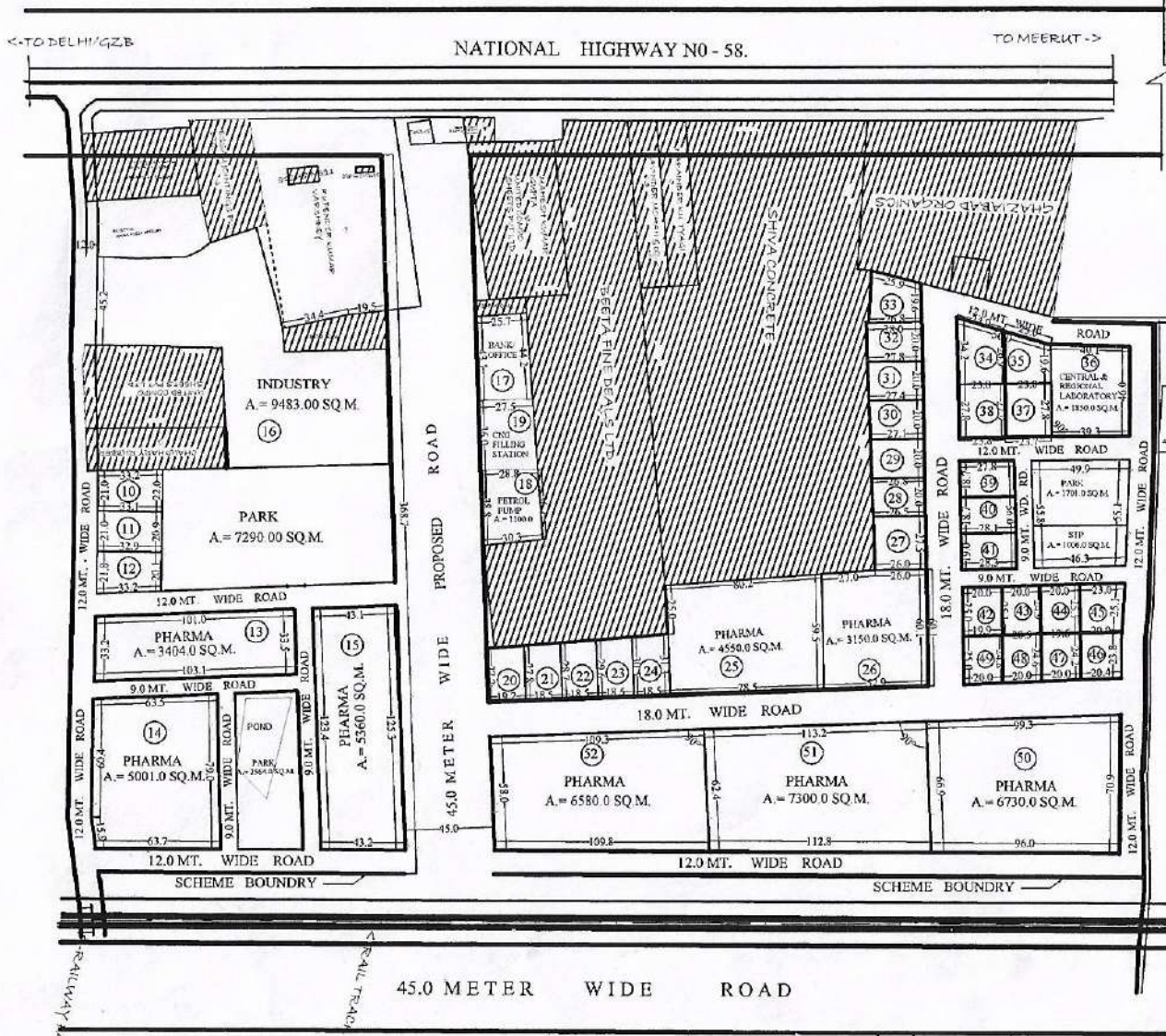

AREA DETAIL
AREA OF SCHEME = 114476.0 SQ.M.
 (EXCLUDING 45.0 MT. WIDE PROPOSED ROAD)
 AREA UNDER PLOT = 73925.0 SQ.M.
 AREA UNDER S.T.P. = 1006.0 SQ.M.
 AREA UNDER PARK = 11555.0 SQ.M.
 AREA UNDER ROAD = 27990.0 SQ.M.

PLOT NO.	USE	AREA (APROX) Sq.M.
10 to 12	INDUSTRIAL	692.00 (EACH)
13	PHARMA	3404.00
14	PHARMA	5001.00
15	PHARMA	5360.00
16	INDUSTRY	9483.00
17	BANK/OFF.	1158.00
19	C.N.G. FILL ST.	1012.00
18	PETROL PUMP	1100.00
20 to 24	INDUSTRIAL	540.00 (EACH)
25	PHARMA	4550.00
26	PHARMA	3150.00
27	INDUSTRIAL	525.00
28	INDUSTRIAL	533.00
29	INDUSTRIAL	539.00
30	INDUSTRIAL	545.00
31	INDUSTRIAL	552.00
32	INDUSTRIAL	558.00
33	INDUSTRIAL	527.00
34	INDUSTRIAL	743.90
35	INDUSTRIAL	567.70
36	CENT REG. LAB.	1850.00
37	INDUSTRIAL	661.41
38	INDUSTRIAL	662.83
39	INDUSTRIAL	519.86
40	INDUSTRIAL	525.47
41	INDUSTRIAL	535.80
42	INDUSTRIAL	498.78
43	INDUSTRIAL	500.00
44	INDUSTRIAL	500.00
45	INDUSTRIAL	550.94
46	INDUSTRIAL	495.60
47	INDUSTRIAL	483.12
48	INDUSTRIAL	506.35
49	INDUSTRIAL	496.75
50	PHARMA	6730.00
51	PHARMA	7300.00
52	PHARMA	6580.00

pocket-b

SITE PLAN OF PLOT FOR BANK, ART GALLERY, HOTEL & FILLING STATION AT KARPOORI PURAM SCHEME.



- AREA OF ART GALLERY = 540 SQM
- AREA OF BANK = 580.00 SQM
- AREA OF HOTEL = 1007.00 SQM
- AREA OF FILLING STATION = 533.00 SQM

PREPARED BY. *[Signature]* AMIN MEASURED BY. *[Signature]* J.E. A.E. E.E. *[Signature]* T.E.H.(L.A.) T.P. *[Signature]* C.A.T.P. SECY. *[Signature]*

REVISIED PART LAYOUT PLAN OF COMMERCIAL PLOT C-1/1 TO C-1/16 & GROUP HOUSING PLOT GH-4 AT, KOYAL ENCLAVE SCHEME, LONI, G.D.A. GHAZIABAD



COMMERCIAL SET BACK
 BELOW 200.00 Sqmt. FRONT - 1.00 Sqmt. REAR - 1.00 Sqmt.
 ABOVE 200.00 Sqmt. FRONT - 1.50 Sqmt. REAR - 1.00 Sqmt. SIDE - 1.00 Sqmt.



AREA SCHEDULE	
PLOT No.	AREA (IN Sqmt.)
C-1/1 ✓	469.78
C-1/2 ✓	457.36
C-1/3 ✓	485.00
C-1/4 ✓	570.61
C-1/5 ✓	153.40
C-1/6 to C-1/11 ✓	112.50
C-1/12 ✓	120.00
C-1/13 ✓	458.71
C-1/14 & C-1/15 ✓	413.32
C-1/16	456.29
GH-04	12867.54

COMMERCIAL PLOTS
 PERMITTED COVERAGE - 25%
 AS PER SECTION 13(1)

26/08/2020
 JUNIOR ENGINEER
 ASSISTANT ENGINEER
 SUPERINTENDENT ENGINEER
 TOWN PLANNER (P)
 TOWN PLANNER (D)
 SECRETARY
 VICE CHAIRMAN

PART LAYOUT PLAN OF SHOPS PLOT, HOTEL, COMMERCIAL & NURSING HOME PLOT ON COMMERCIAL (COM-2) PLOT & COMMERCIAL/RESIDENTIAL (C/G.H.-1) PLOT IN POCKET C, MADHUBAN BAPUDHAM YOJNA GHAZIABAD

TOTAL AREA OF LAND = 60938.57 SQ.M.
 AREA UNDER SHOPS PLOT = 21632.30 SQ.M.
 AREA UNDER HOTEL = 1788.72 SQ.M.
 AREA UNDER NURSING HOME = 1308.58 SQ.M.
 AREA UNDER COMMERCIAL = 1154.00 SQ.M.
 AREA UNDER MULTI LEVEL P. = 5468.95 SQ.M.
 AREA UNDER TOILET/D.W. = 322.60 SQ.M.
 AREA UNDER GREEN/PARK = 7877.60 SQ.M.
 AREA UNDER CAR PARKING = 2824.32 SQ.M.
 AREA UNDER PAVED PATHWAY = 18561.50 SQ.M.
 TOTAL NOS. OF CAR IN CAR PARKING - 185

SHOPS PLOT - 10.00M. X 28.15M. - 281.50 SQ.M. - 10
 SHOPS PLOT - 10.00M. X 20.00M. - 200.00 SQ.M. - 38
 SHOPS PLOT - 09.00M. X 18.00M. - 162.00 SQ.M. - 39
 SHOPS PLOT - 08.00M. X 12.50M. - 100.00 SQ.M. - 47
 TOTAL NOS. OF SHOPS PLOT - 134

SHOPS PLOT
 F.A.R. = 4
 GROUND COVERAGE = 100%

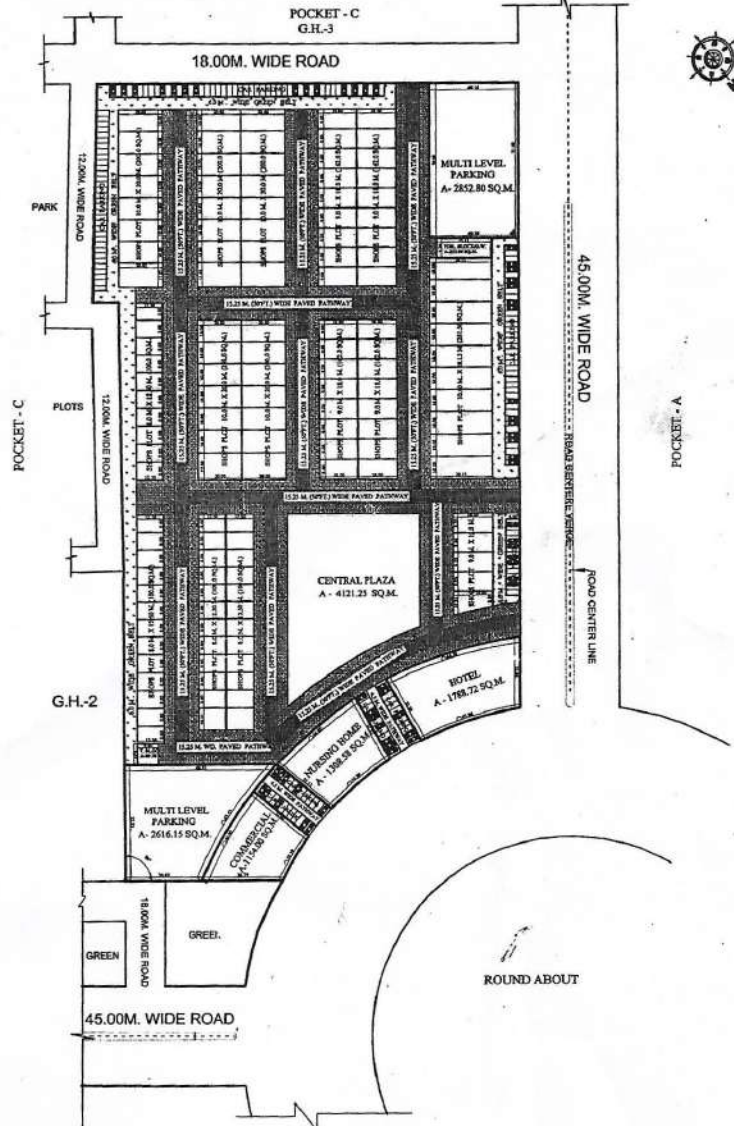







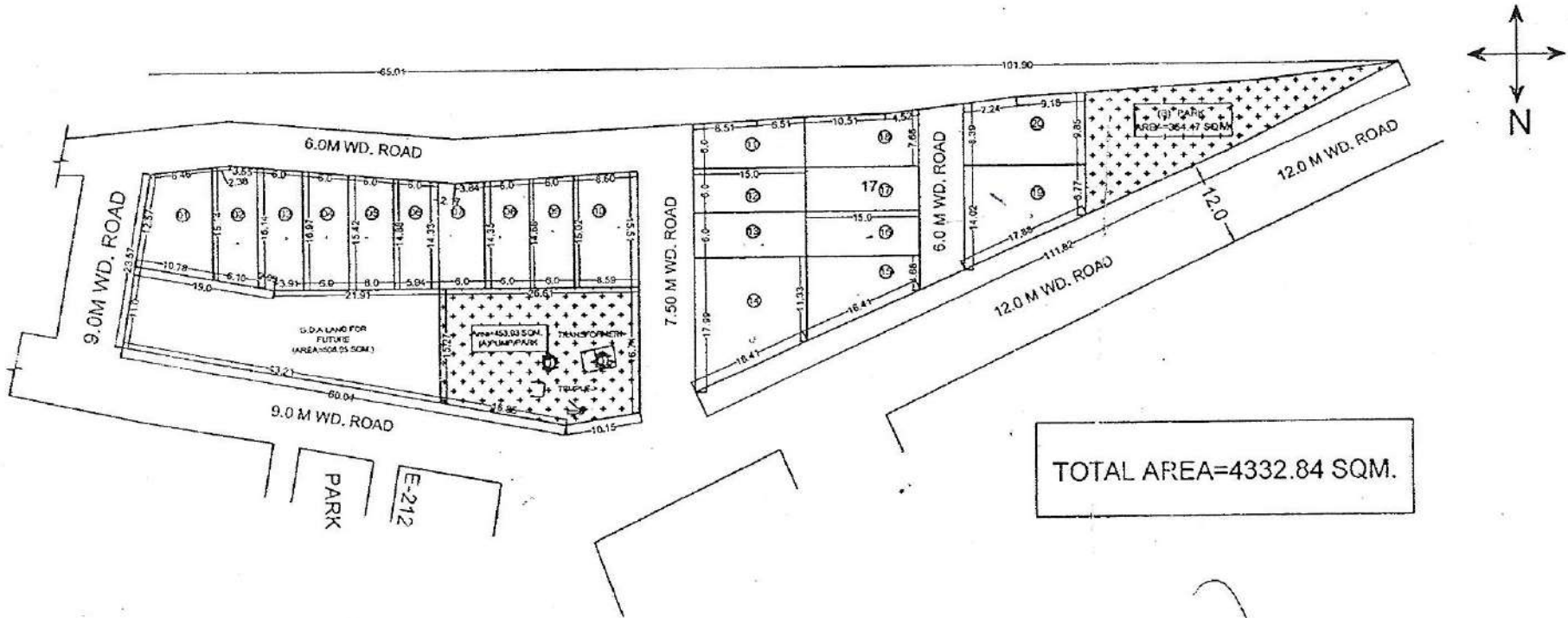

PART . A

S.NO.	PLOT NO.	AREA
(01)	E-01	131.51 SQM.
(02)	E-02	94.62 SQM.
(03)	E-03	97.09 SQM.
(04)	E-04	94.20 SQM.
(05)	E-05	90.91 SQM.
(06)	E-06	87.62 SQM.
(07)	E-07	84.81 SQM.
(08)	E-08	87.09 SQM.
(09)	E-09	89.12 SQM.
(10)	E-10	131.09 SQM.
(11)	E-11	95.94 SQM.
(12)	E-12	90.00 SQM.

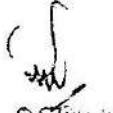
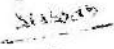
PART . A

S.NO.	PLOT NO.	AREA
((13)	E-13	90.00 SQM.
(14)	E-14	219.77 SQM.
(15)	E-15	120.03 SQM.
(16)	E-16	90.00 SQM.
(17)	E-17	90.00 SQM.
(18)	E-18	106.28 SQM.
(19)	E-19	169.91 SQM.
(20)	E-20	151.00 SQM.
PARK		
(01)	A	453.03 SQM.
(02)	B	354.47 SQM.

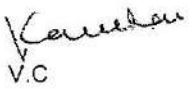

 D/MAN
  AMIN
  O.S.D. (L.A.S.)
  J.E.
  A.E.
  E.E.
  T.P.(R)
  T.P.(K)
  SECY.
  V.C.

PART LAY OUT PLAN FOR NANDGRAM BLOCK - E. GHAZIABAD

91

PART . B

PART . B

S.NO.	PLOT NO.	AREA	S.NO.	PLOT NO.	AREA
(21)	E-21	187.55 SQM.	(34)	E-34	97.74 SQM.
(22)	E-22	90.61 SQM.	(35)	E-35	91.76 SQM.
(23)	E-23	91.87 SQM.	(36)	E-36	84.67 SQM.
(24)	E-24	113.28 SQM.	(37)	E-37	79.48 SQM.
(25)	E-25	99.15 SQM.	(38)	E-38	80.54 SQM.
(26)	E-26	90.05 SQM.	(39)	E-39	87.71 SQM.
(27)	E-27	90.05 SQM.	(40)	E-40	98.74 SQM.
(28)	E-28	133.27 SQM.	(41)	E-41	116.59 SQM.
(29)	E-29	142.53 SQM.	(42)	E-42	108.00 SQM.
(30)	E-30	88.94 SQM.	(43)	E-43	153.78 SQM.
(31)	E-31	93.50 SQM.	(44)	E-44	86.74 SQM.
(32)	E-32	103.93 SQM.	(45)	E-45	86.00 SQM.
(32)	E-32	103.93 SQM.	(46)	E-46	85.07 SQM.
(33)	E-33	98.31 SQM.			
				PARK	
			(01)	A	313.05 SQM.

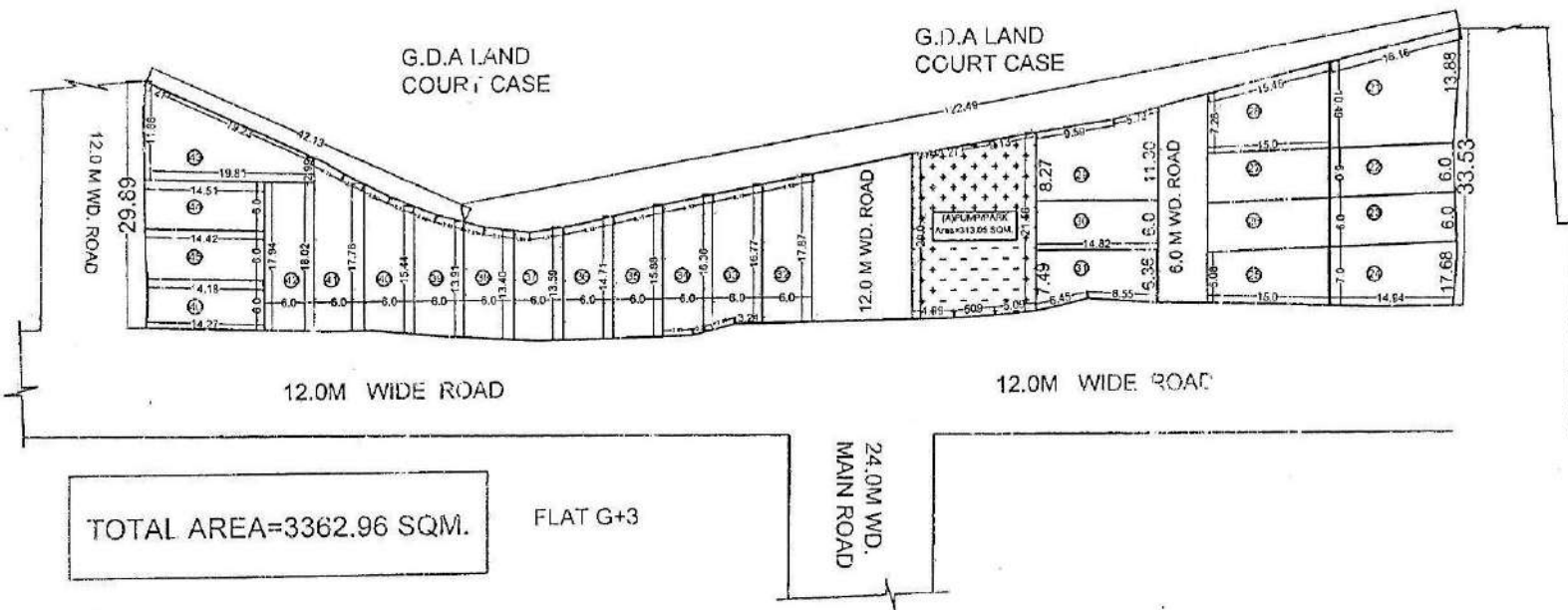

 D/MAN
  AMIN
  OSD(LA)
  J.E
  A.E
  E.E
  T.P(R)
  T.P(K)
 C.A.T.P
 SECY.
 V.C

REVISED SITE PLAN OF GROUP HOUSING PLOT, NEAR PROPOSED R.O.B. ON 75M M.P. ROAD AT PRATAP VIHAR, GHAZIABAD

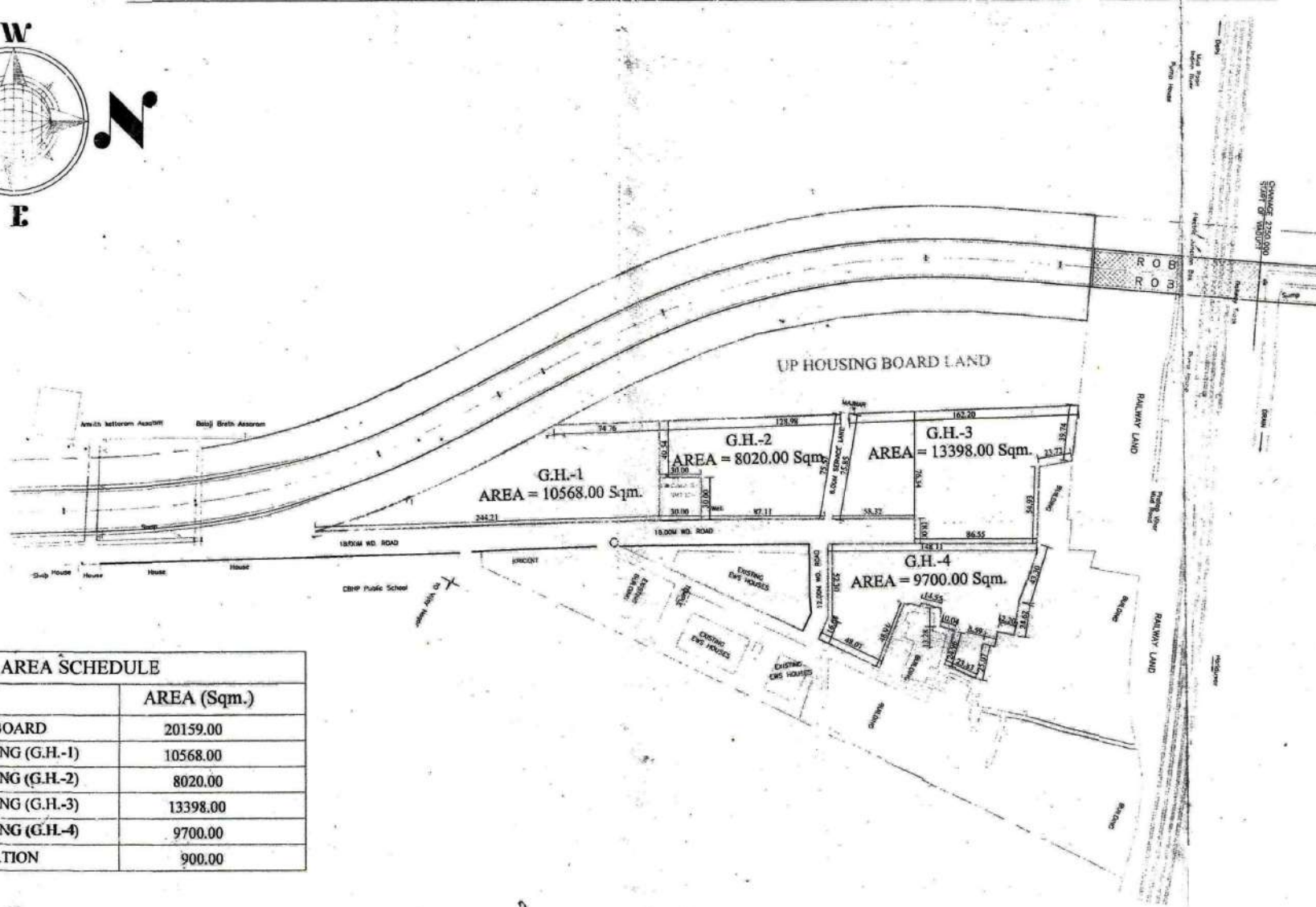
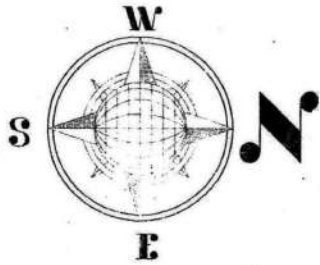

AREA SCHEDULE	
LAND	AREA (Sq.m.)
UP HOUSING BOARD	20159.00
GROUP HOUSING (G.H.-1)	10568.00
GROUP HOUSING (G.H.-2)	8020.00
GROUP HOUSING (G.H.-3)	13398.00
GROUP HOUSING (G.H.-4)	9700.00
ELEC.SUB-STATION	900.00

[Signature]
23/3/16
D/Man

[Signature]
AMIN

[Signature]
J.E.

[Signature]
A.E.

[Signature]
E.E.-ZONE 4

[Signature]
TEH-LA

[Signature]
24/3/16
T.P.

[Signature]
C.A.T.P.

[Signature]
Secy.

[Signature]
V.C.

REVISED SITE PLAN OF SHOPS/RESIDENCE PLOT NO.KA -322 TO KA-324 AT BLOCK KA, PRATAP VIHAR SECTOR XII G.M.P ,G.D.A. GHAZIABAD.

SHOP/RESI.PLOT NO. KA-322 = 914.31 SQ.M.
 SHOP/RESI.PLOT NO. KA-323 = 912.00 SQ.M.
 SHOP/RESI.PLOT NO. KA-324 = 912.00 SQ.M.

GR.COV. - 60%
 F.A.R. - 1.5

USES:

GR. FLOOR - COMMERCIAL
 FIRST FLOOR - RESIDENTIAL
 SECOND FLOOR - RESIDENTIAL

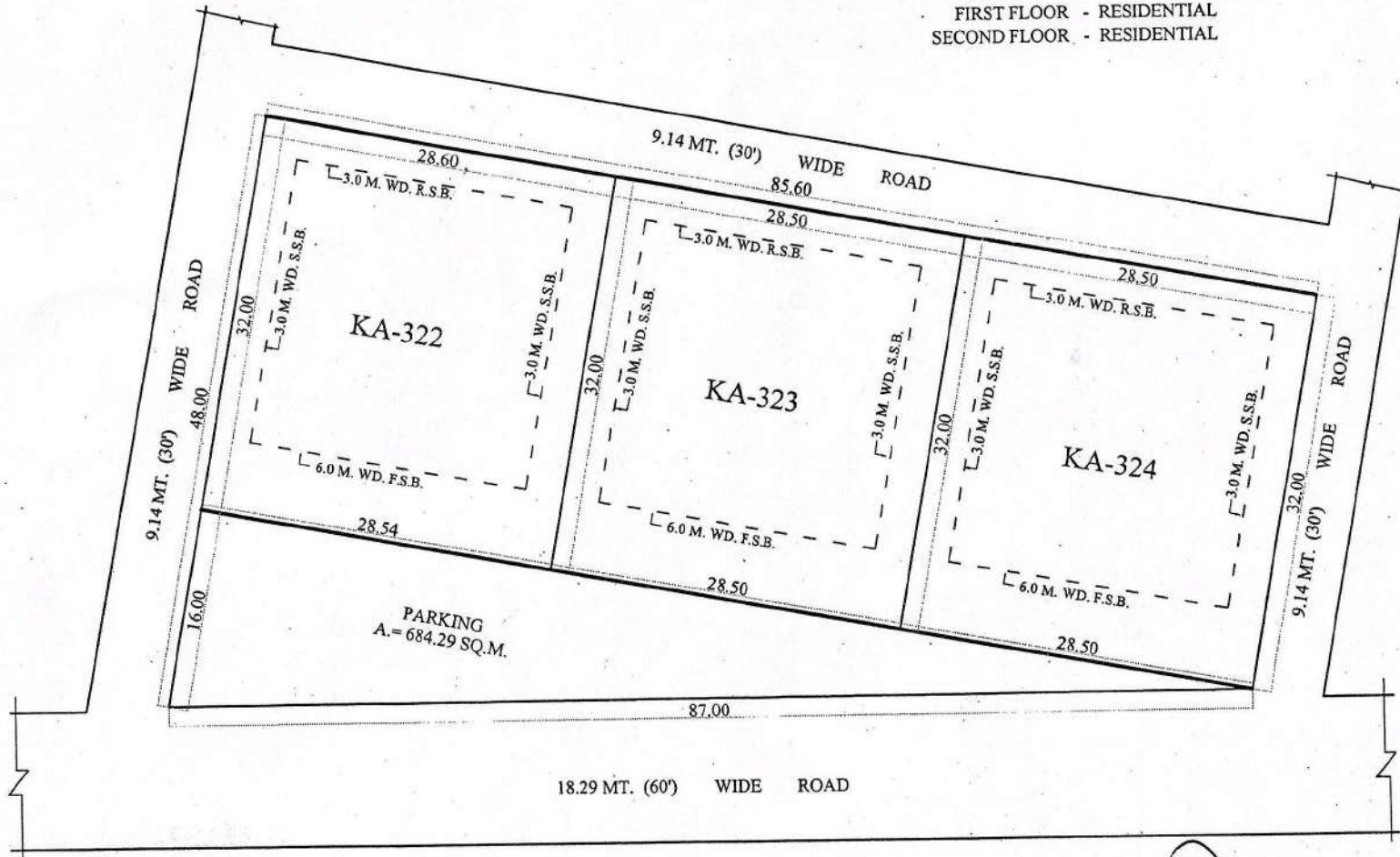
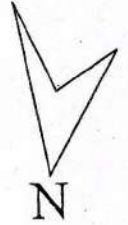

[Signature]
 09/10/2020
 D/MAN

[Signature]
 12/10/2020
 J.E.

[Signature]
 12/10
 A.E.

[Signature]
 12/10/20
 E.E.

[Signature]
 12/10/20
 T.P.(R)

T.P.(K)

C.A.T.P.

[Signature]
 SECRETARY

[Signature]
 VICE CHAIR

SITE PLAN FOR KIOSK IN "D" BLOCK PATEL NAGAR, SECTOR - 7 G.M.P. GHAZIABAD

Scale -1:500

AREA OF KIOSK LAND = 116.84 Sqm.

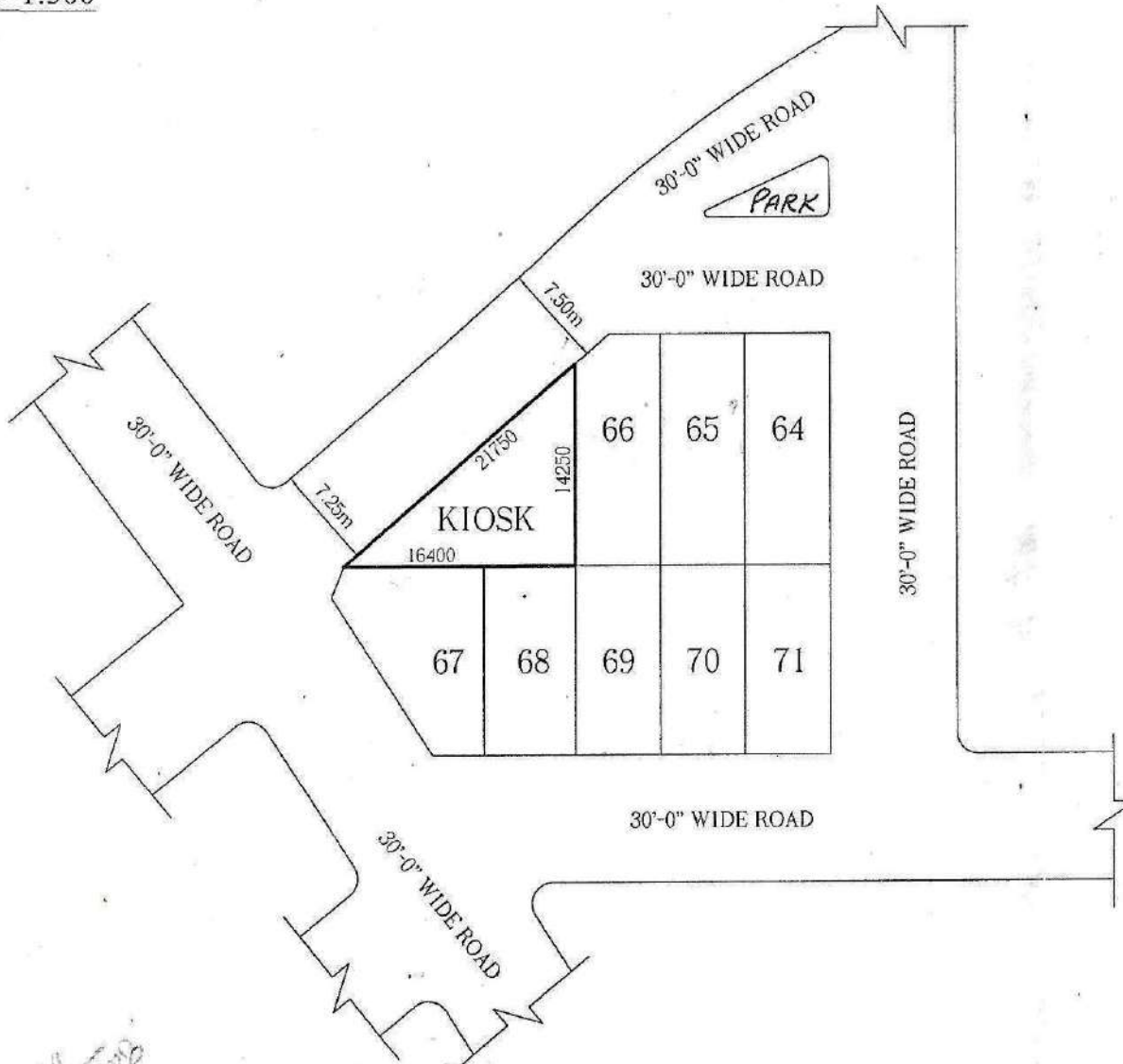

[Signature]
22.4.08

Prepared By.

[Signature]
22.4.08

Compared By.

[Signature]
22.4.08
Measured By.

[Signature]
22.4.08
Asth. Engineer

[Signature]
23/4/08
A.T.P.







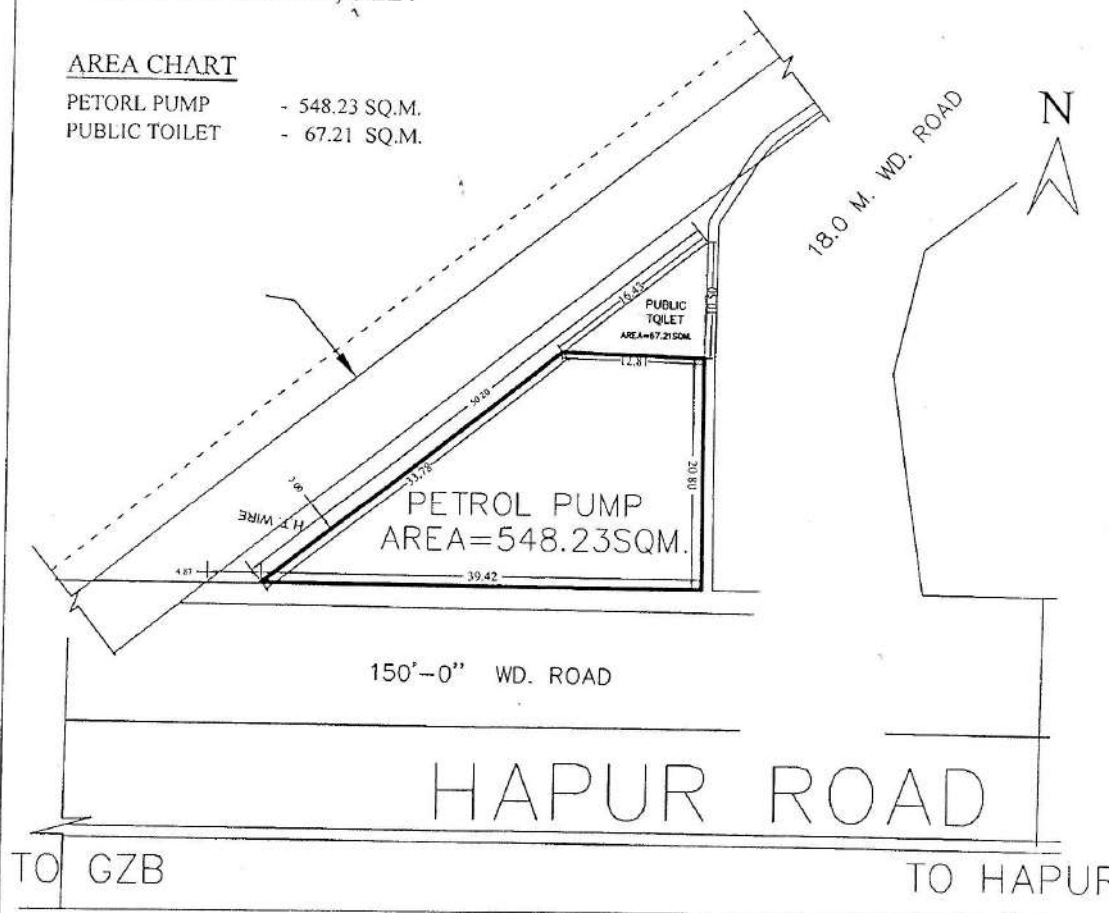

[Signature]
Town Planner.

REVISED SITE PLAN OF PETROL PUMP /PUBLIC TOILET A-BLOCK
GOVINDPURAM ,GZB.

AREA CHART

PETORL PUMP - 548.23 SQ.M.
PUBLIC TOILET - 67.21 SQ.M.



 D/Man
 J.E.
 A.E.
 E.E.
 T.P.
 C.A. (17/10/2016)
 SECRTY.
 V.C.

SITE PLAN FOR CONVENIENT SHOPPING CENTRE AT AT C-BLOCK SWARN JAYANTI PURAM

PRODUCED BY AN AUTODESK EDUCATIONAL PRODUCT

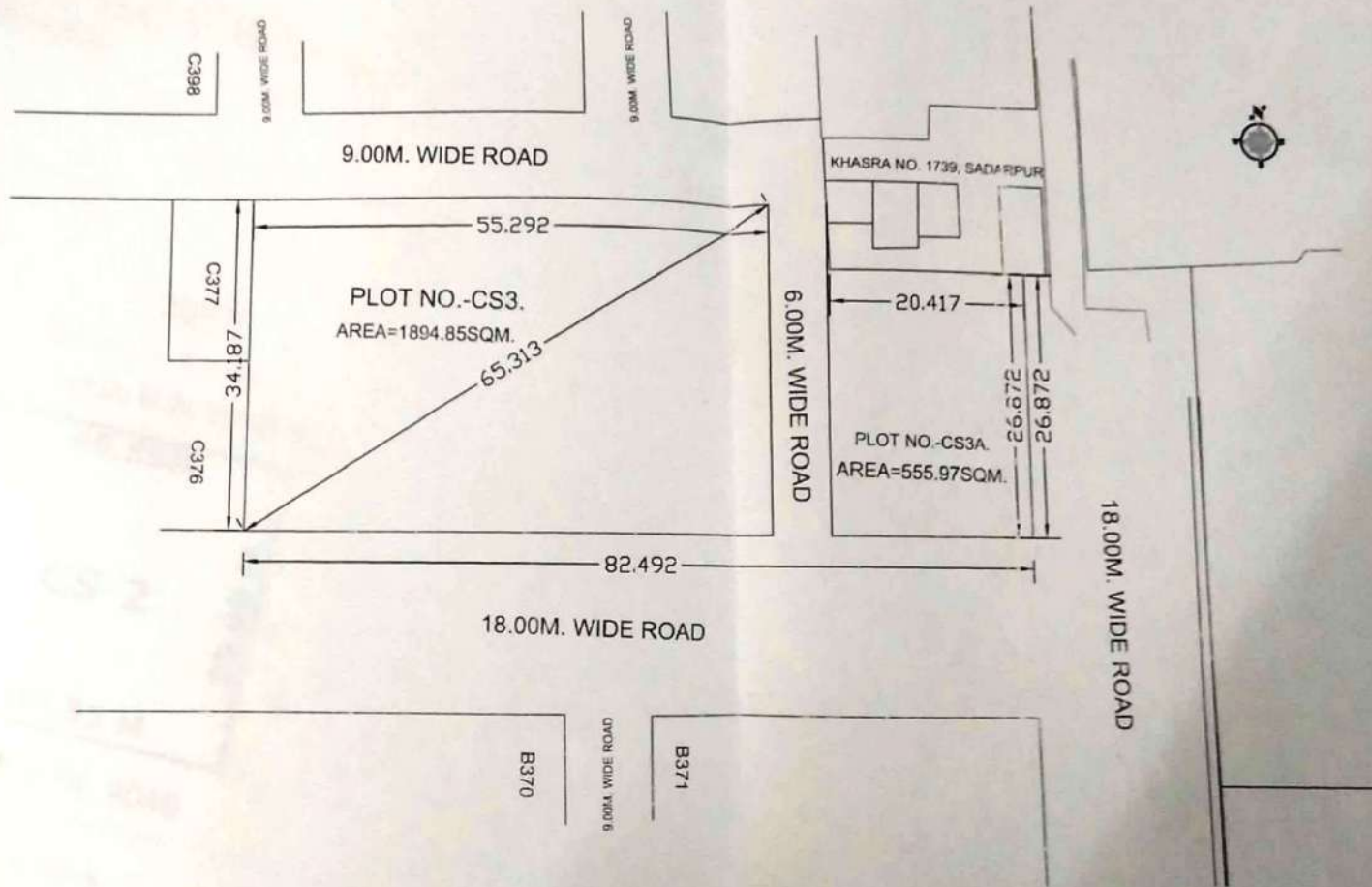

21/05/13
D./MAN
 J.E.
 21/05/13
A.E.
 EX.EN
 N.T.
 20/5/13
T.P
C.E.
 C.A.T.P
 SECY.

PRODUCED BY AN AUTODESK EDUCATIONAL PRODUCT

Scanned by CamScanner

PROPOSED PART LAYOUT PLAN AT SECTOR VI VAISHALI

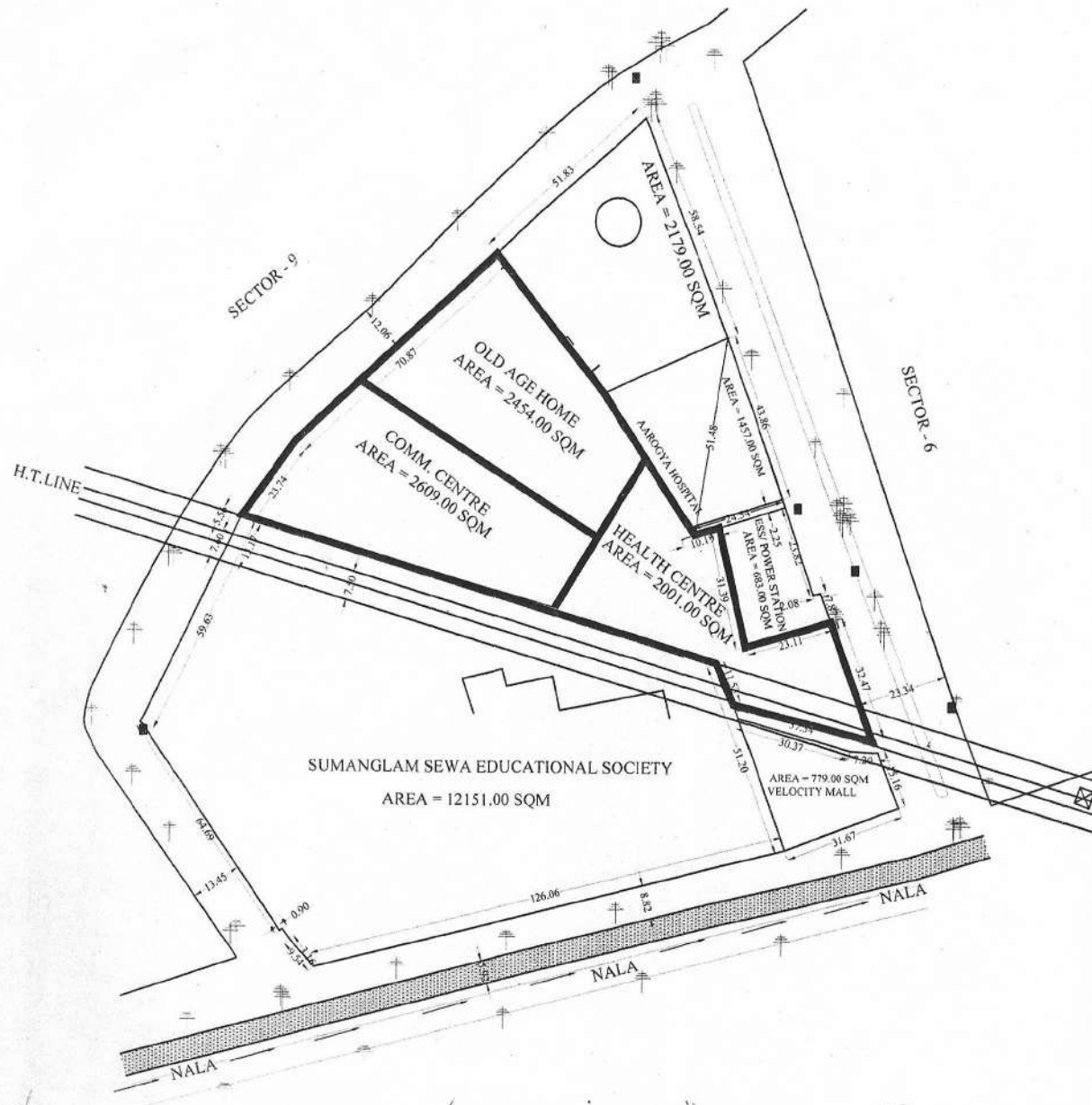

[Signature]
D/MAN

[Signature]
J.E.

[Signature]
A.E.

[Signature]
E.E.

[Signature]
T.P.

[Signature]
C.A.T.P.

S

REVISED SITE PLAN FOR COMMUNITY CENTER & NURSING HOME AT SECTER-3 VAISHALI, GHAZIABAD

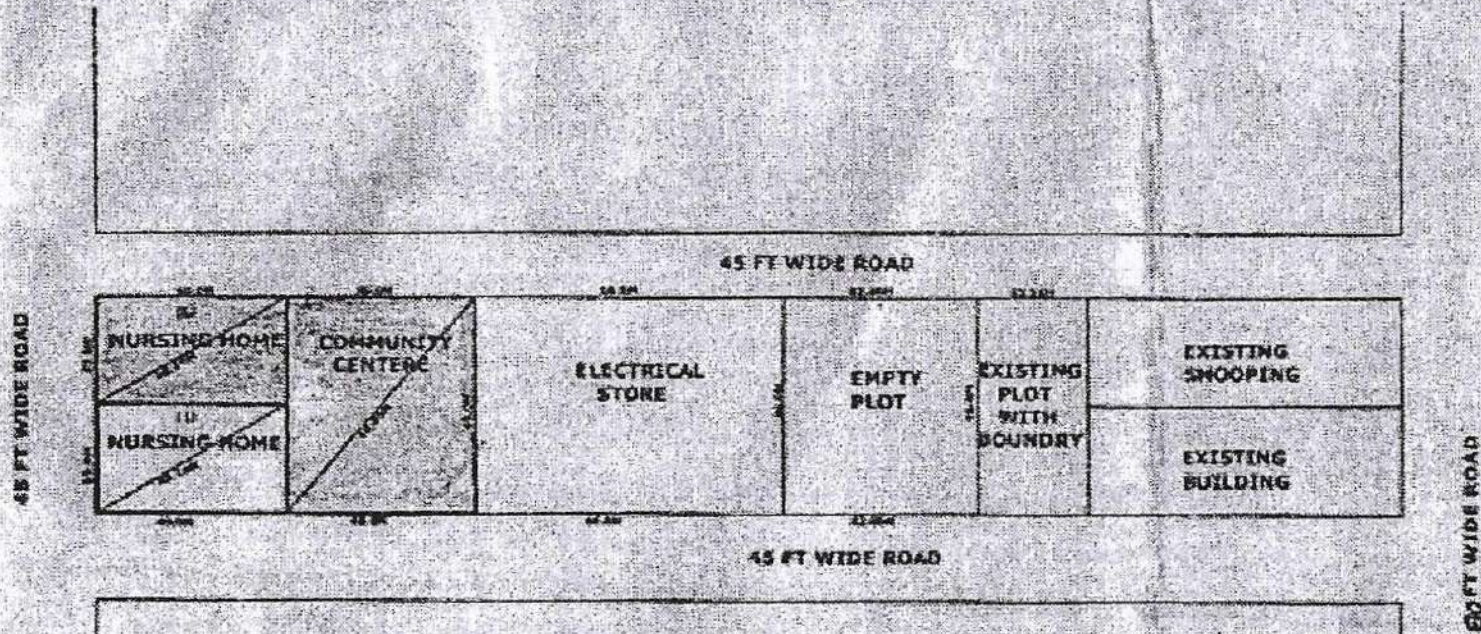

NURSING HOME NO- 1	AREA	40.0M X 23.0M	=	920 S.Q.M
NURSING HOME NO- 2	AREA	40.0M X 23.0M	=	920 S.Q.M
COMMUNITY CENTER	AREA	46.00M X 40.0M	=	1840 S.Q.M



D/M

AMIN



J.E

A.E

E.E-6



TEH (LA)

T.D

C.A.P

SECRETARY

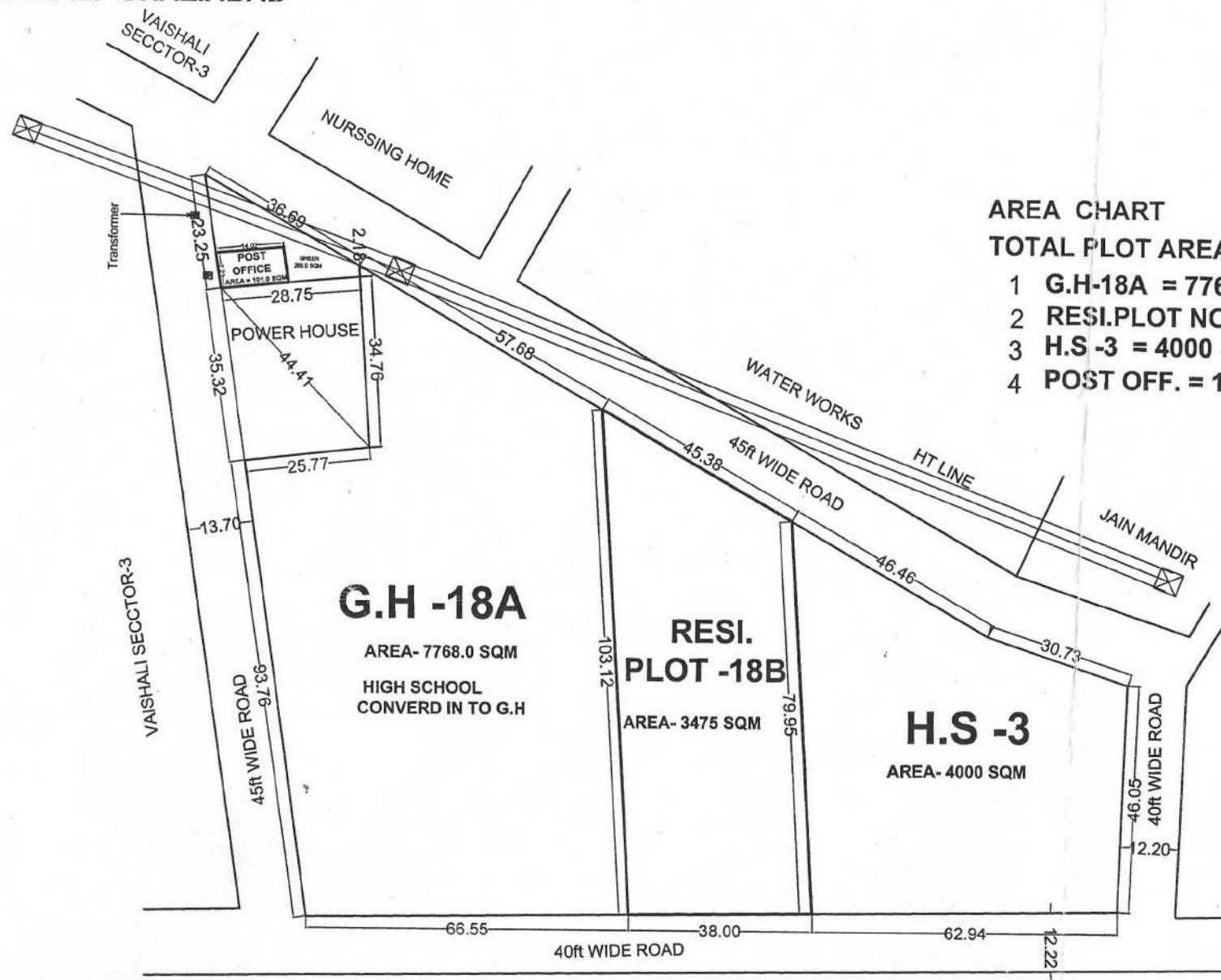
SITE PLAN OF HIGH SCHOOL PLOT CONVERD IN TO G.H / RESI.PLOT/POST OFFICE AT SECTER-3 VAISHALI GHAZIABAD



AREA CHART

TOTAL PLOT AREA-15241 SQM

- 1 **G.H-18A = 7768.0 SQM**
- 2 **RESI.PLOT NO-18B = 3475 SQM**
- 3 **H.S -3 = 4000 SQM**
- 4 **POST OFF. = 101.0 SQM**

G.H -18A

AREA- 7768.0 SQM
HIGH SCHOOL
CONVERD IN TO G.H

**RESI.
PLOT -18B**

AREA- 3475 SQM

H.S -3

AREA- 4000 SQM

[Signature]
21/10/16
D/M.

[Signature]
T.P.

[Signature]
C.A.T.P

[Signature]
21/10/16
SECY.

[Signature]
V.C

SITE PLAN OF PRIMARY SCHOOL AT SECTOR II, VAISHALI GHAZIABAD

AREA = 2568.829 SQ M.

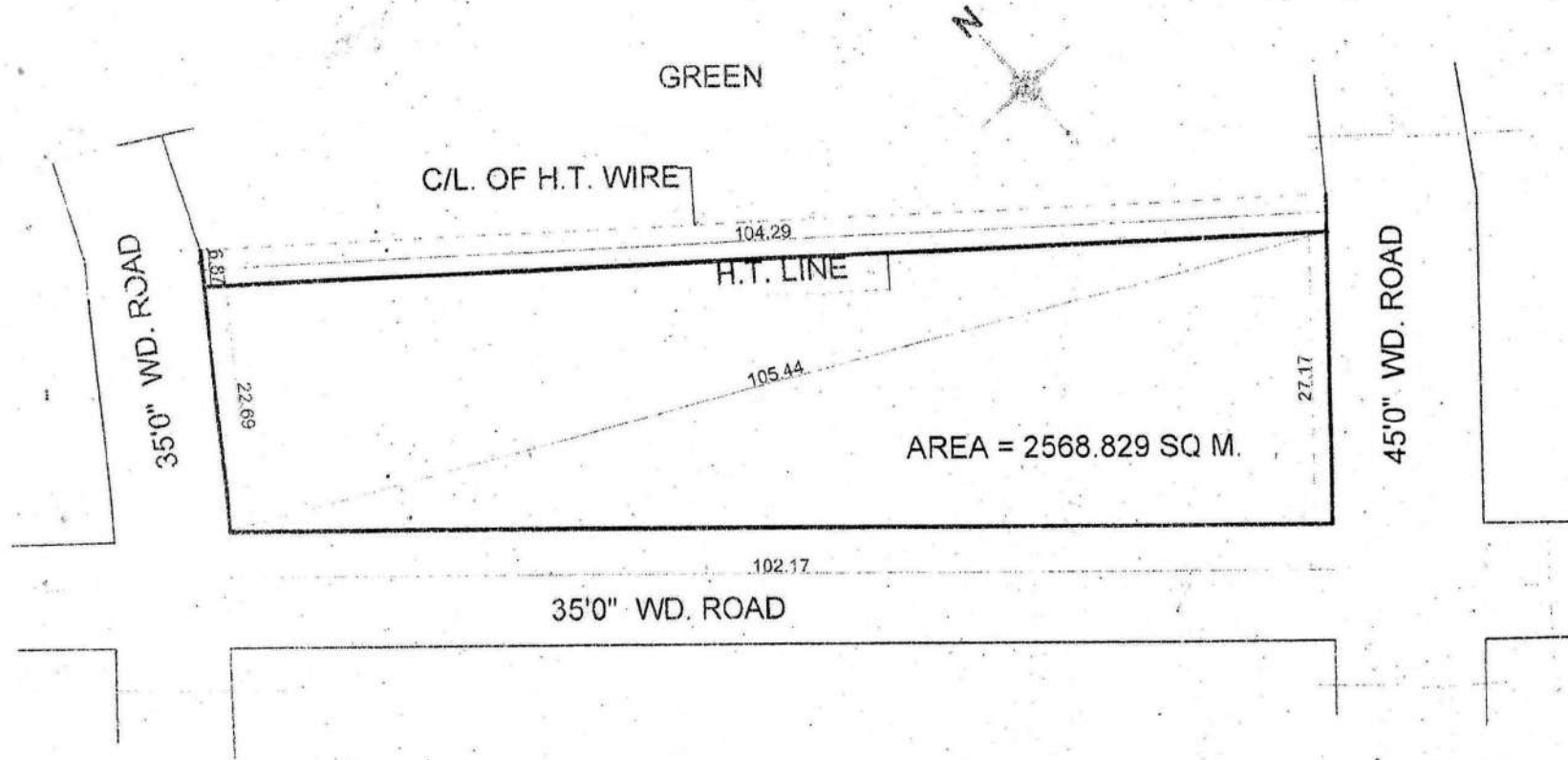

[Signature]
20/11/13

PREPARED BY

[Signature]
04/12/13

COMPARED BY

[Signature]
28/11/13

MEASURED BY

J.E

[Signature]

ASTT. ENGR

[Signature]
04/12/13

T.P

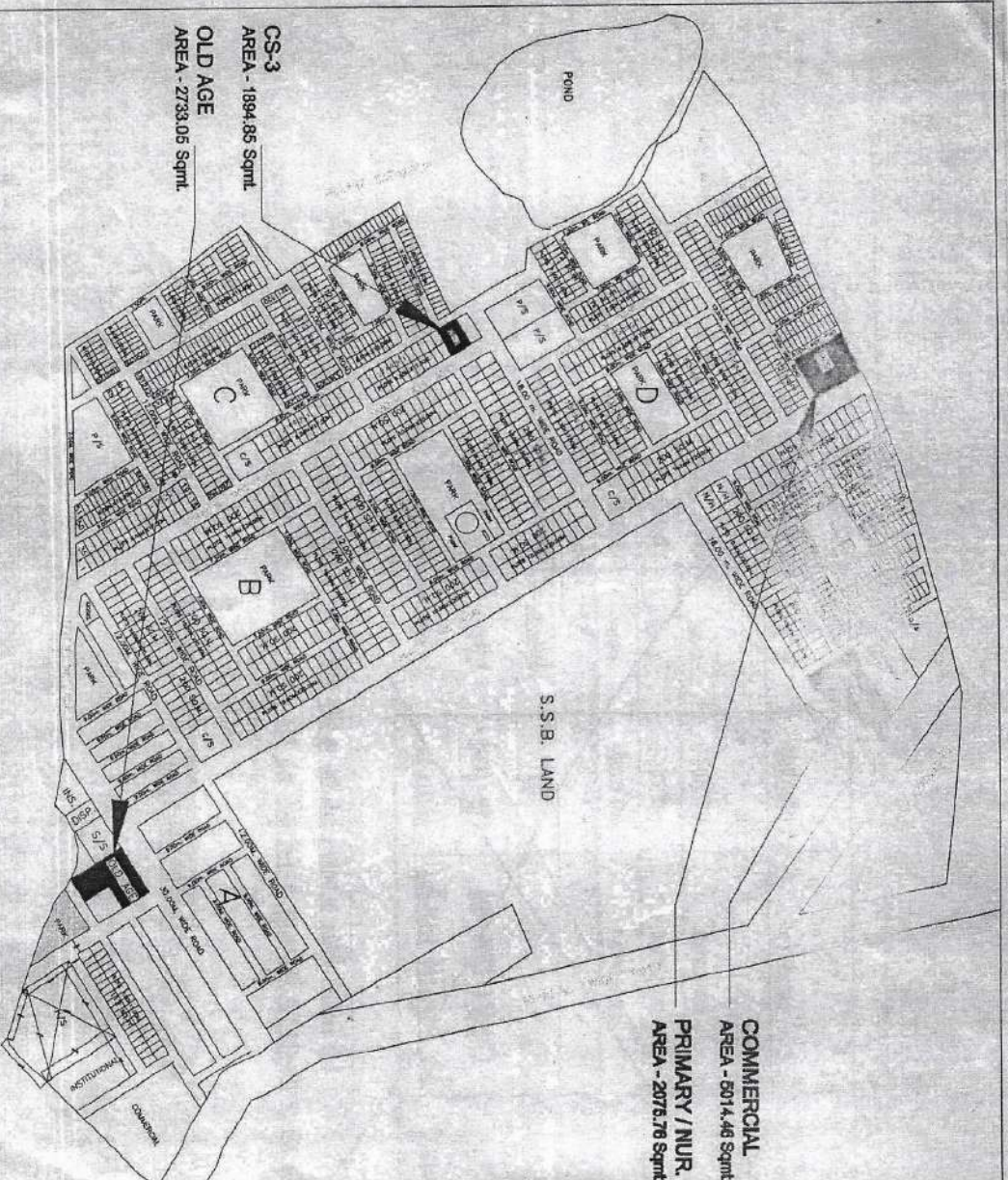

**GHAZIABAD DEVELOPMENT
AUTHORITY**

65
DATED 16-1-23
OPEN BY ENGINEERING
DIVISION I.

COMMERCIAL
AREA - 6014.46 Sqmt.
PRIMARY / NUR.
AREA - 2076.78 Sqmt.

AREA CHART:
TOTAL AREA OF SCHEME =
(As per survey plan
received from I.E. 1)
AREA UNDER S.S.B. LAND =
NET AREA UNDER SCHEME =
AREA UNDER FIELDS =
AREA UNDER FIELDS =
AREA UNDER FIELDS =
AREA UNDER SCHOOLS =
AREA UNDER SCHOOLS =
AREA UNDER SCHOOLS =
AREA UNDER N/H =
AREA UNDER COMA FACILITY =
AREA UNDER INSTITUTIONAL =

DETAIL OF PLOTS
200 SQ.M. (10.00M X 20.00M) = 442 NO.
150 SQ.M. (8.50M X 17.50M) = 248 NO.
112 SQ.M. (7.50M X 15.00M) = 248 NO.
90 SQ.M. (6.00M X 15.00M) = 248 NO.

**LAY-OUT PLAN FOR
SWARNA-JAYANTI
PURAM
GHAZIABAD**

SCALE: 1:5000
DATE: 26-7-88
DRA. NO. C/UMR/VP/106



DESIGNER: C.A.P.
CHECKER: Y.C.

LAYOUT PLAN OF PRATAP VIHAR SECTOR XI & XII G.M.P. GHAZIABAD.

SECTOR IX

150' MASTER PLAN ROAD

SCHOOL PLOT
AREA - 2411.78.00 SQ.M.

G.H.-1
AREA - 10568.00 SQ.M.

PROPOSED MASTER PLAN ROAD 250'-0" WIDE

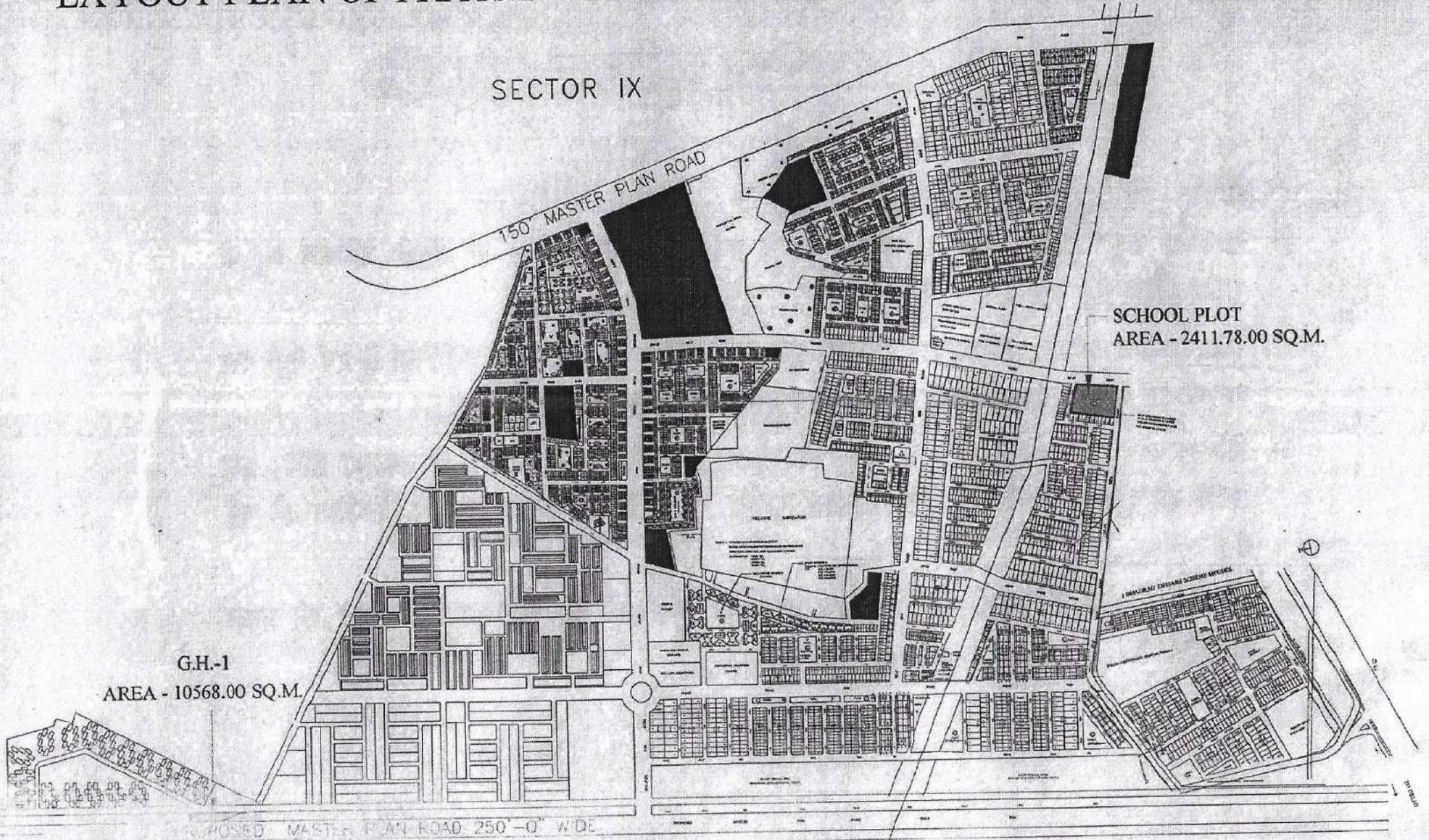

PROPOSED SITE FOR NURSING HOSTEL PLOT NO. E/N.HS.-1 IN POCKET-E, AT MADHUBAN BAPUDHAM YOJNA, G.D.A. GZB.

AREA OF NURSING HOSTEL PLOT NO. E/N.H.-1 = 10408.59 SQ.M.

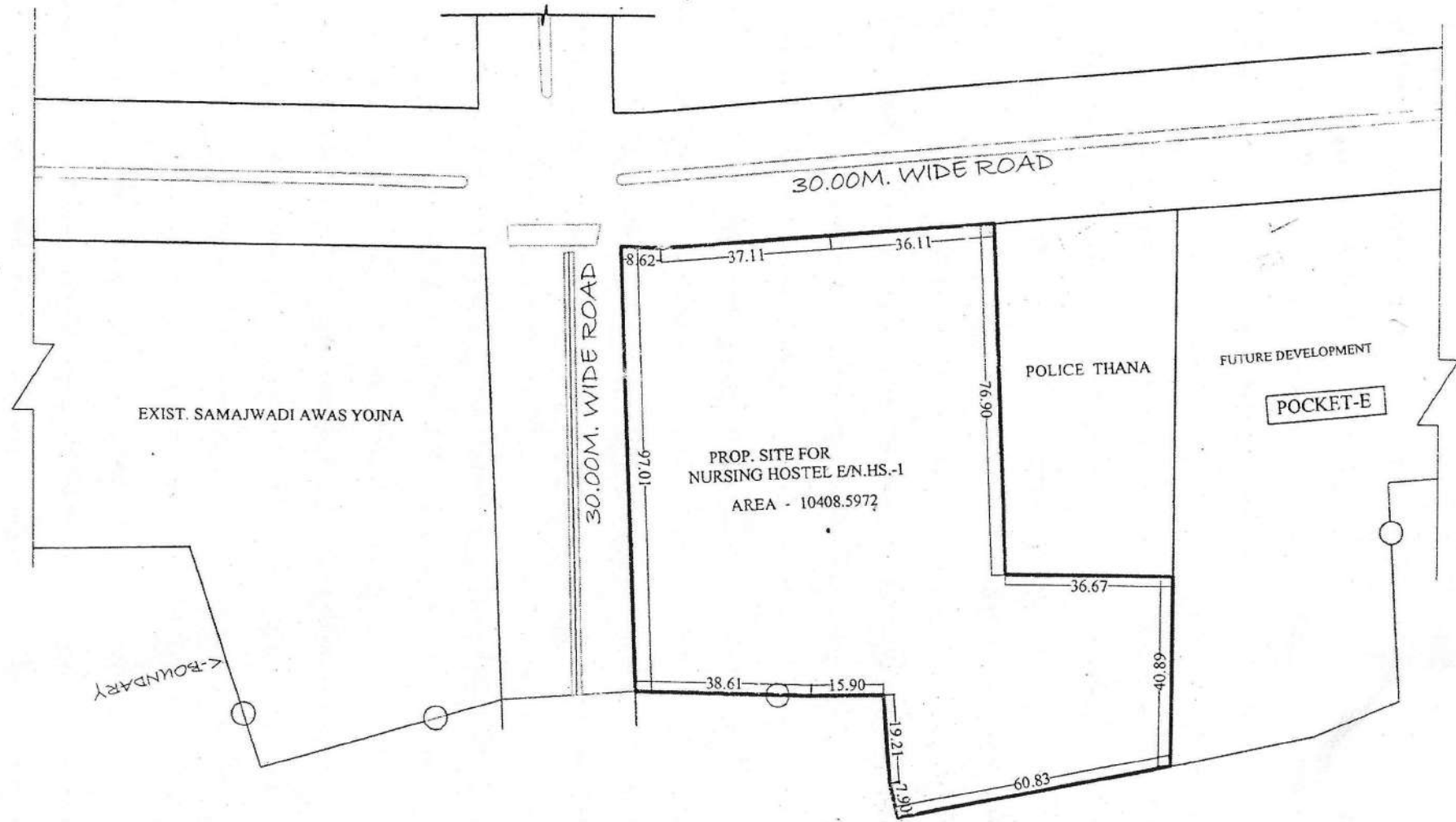

Tentative Site Plan

20/08/2020
AMIN

Handwritten signatures and initials.

Handwritten signatures and initials.







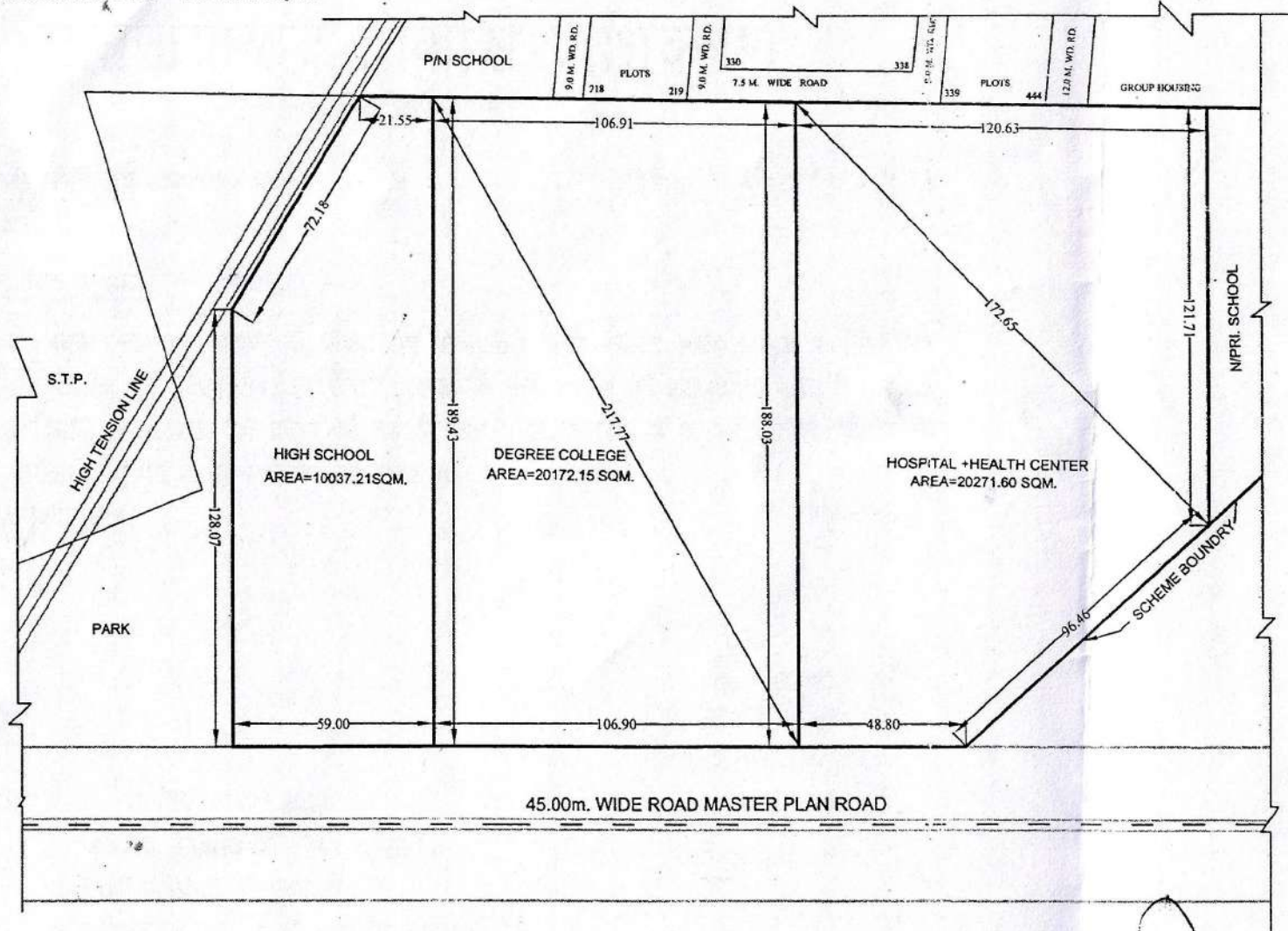

Handwritten signature.

Kancha

LAN FOR HIGH SCHOOL , DEGREE COLLEGE & HOSPITAL+HEALTH CENTER PLOT AT POCKET- F MADHUBAN BAPUDHAM YOJNA;GDA, GZB

HIGH SCHOOL PLOT = 10037.21 SQ.M.
 DEGREE COLLEGE PLOT = 20172.15 SQ.M.
 HOSPITAL+HEALTH CENTER PLOT = 20271.60 SQ.M.

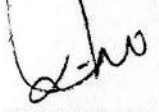
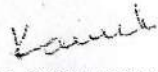

 AMIN
 J.E.
 A.E.
 E.E.
 O.S.D. (LA)
 T.P. (R)
 T.P. (K)
 C.M.T.P.
 SECRETARY
 VICE CHAIR

H.C. / C.C.

10/07/87

OPOSED SITE PLAN FOR HIGH SCHOOL PLOT AT POCKET-E (PART) MADHUBAN BAPUDHAM YOJNA; GZB.

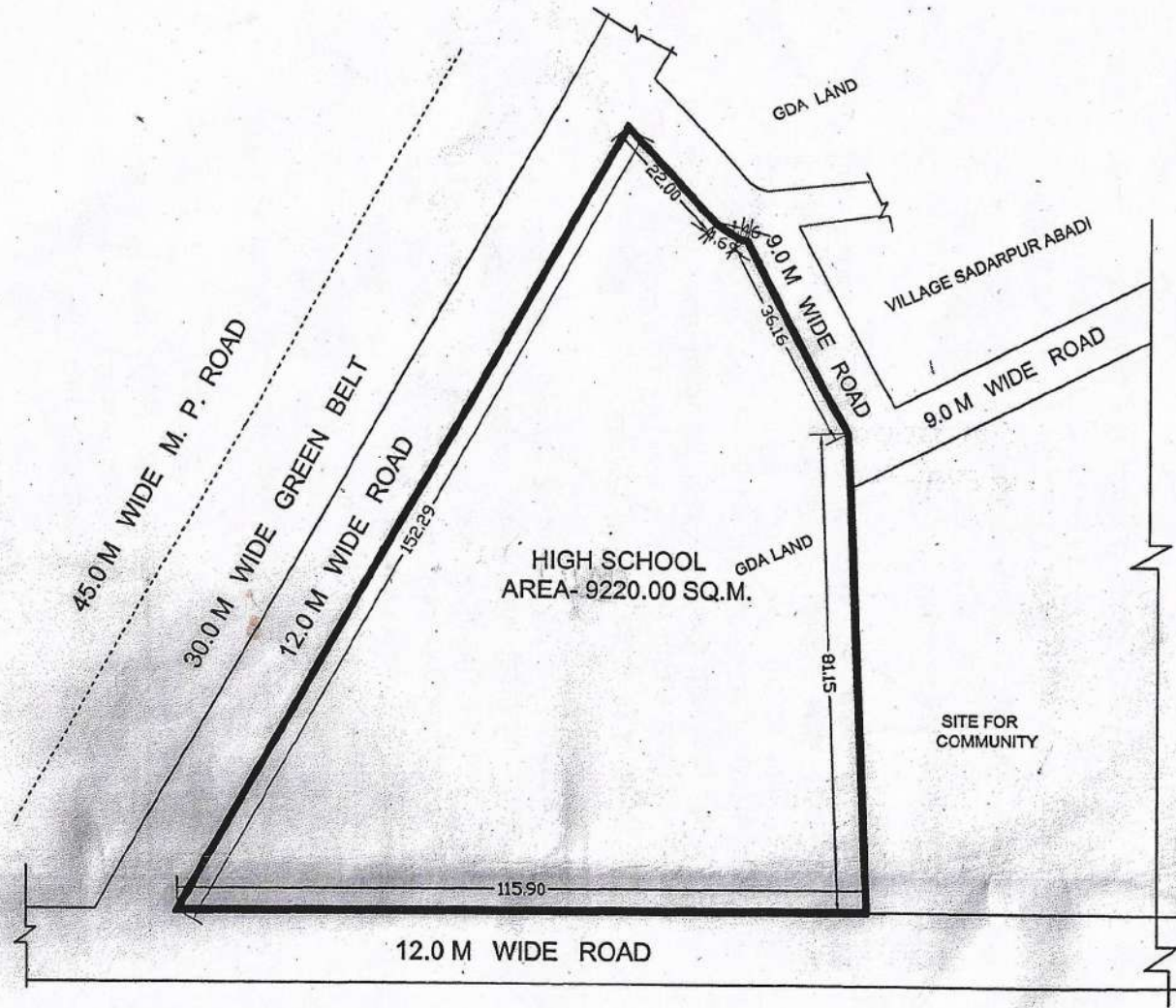

SWARNAYANTIPURAM YOJNA

Man AMIN J.E. A.E. E.E. OSD (LA) T.P. (R) T.P. (R) SECRETARY VICE CHAIRMAN

15/07/2018

PARK
MASTER PLAN GREEN
43320SQ. MT.

D

O.H.T.

O.H.T.

539 540

529 550

PARK
6584 SQ.MT

PH

551 584

18.00 METER WIDE ROAD

600

585

637

652

12.00x25.00
300.00 SQ. MT.

12.00 METER WIDE ROAD

682

12.00x25.00
300.00 SQ. MT.

688

653

12.00 METER WIDE ROAD

PRIMARY SCHOOL
2000 SQ.M

PRIMARY SCHOOL
2000 SQ.M

G.H.

18185 SQ.MT.

G.H.

19361 SQ.MT.

G.H.

10513 SQ.MT.

G.H.

14672 SQ.MT.

G.H.

10593 SQ.MT.

G.H.

13280 SQ.MT.

G.H.

11191 SQ.MT.

12.00 METER WIDE ROAD

12.00 METER WIDE ROAD

12.00 METER WIDE ROAD

U.G.R.

PARK
8561 SQM

PARK
6100 SQM

Madhusan Babudham
School Plot

100.00 METER WIDE ROAD

WIDE M.P.ROAD

PROP. SITE PLAN FOR HEALTHCARE HUB AT POCKET-E MADHUBAN BAPUDHAM YOJNA; GZB.
 AREA - 33484.50 SQ.M.

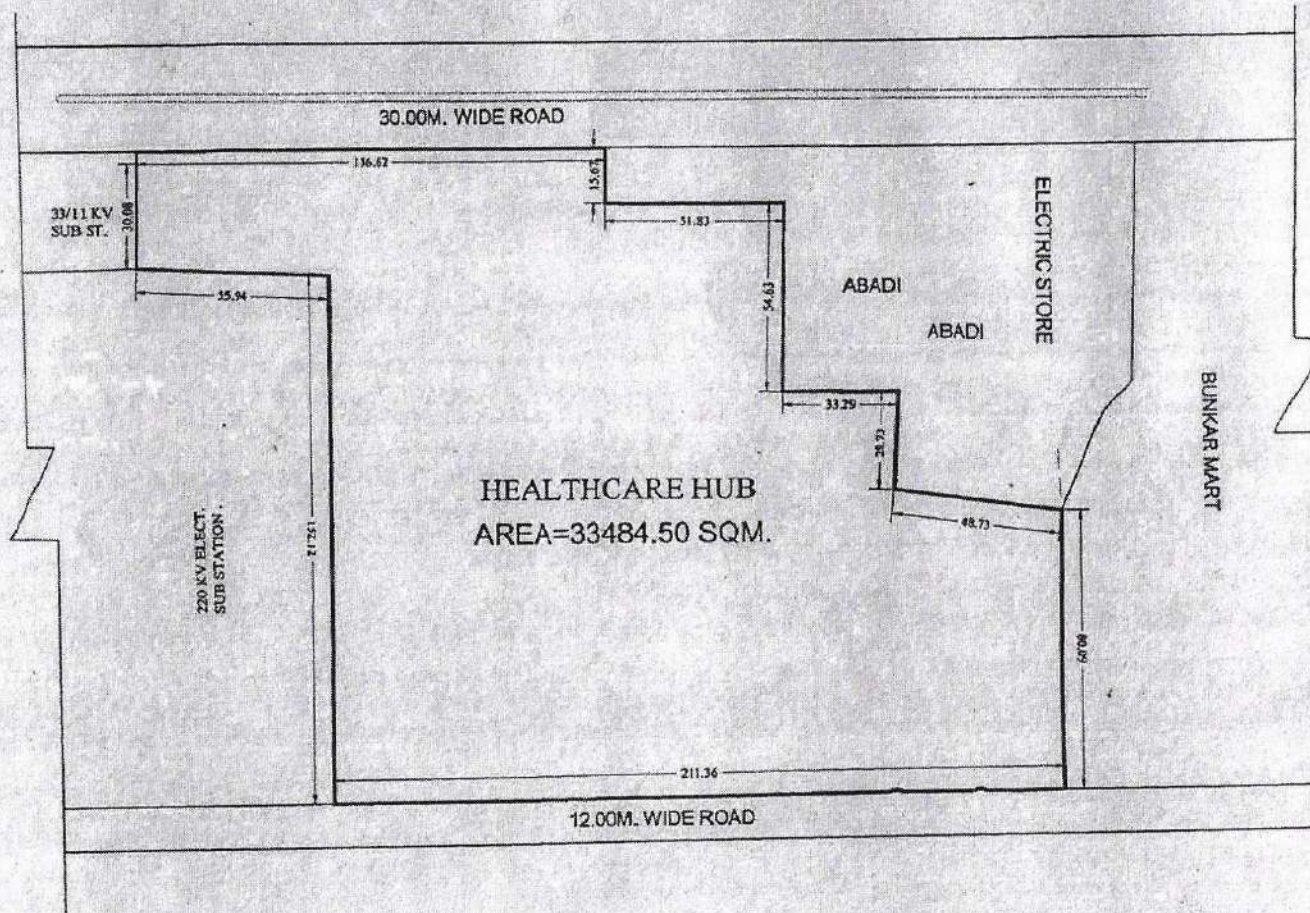

[Signature]
D/Man

[Signature]
AMIN

[Signature]
J.E.

[Signature]
A.E.

[Signature]
A.T.R.

[Signature]
OSD

[Signature]
E.E. T.P.

[Signature]
C.A.T.P.

[Signature]
SECRETARY

[Signature]
VICE CHAIRMAN

REVISED LAYOUT PLAN OF KOYAL ENCLAVE SCHEME, GHAZIABAD

AREA STATEMENT

TOTAL AREA OF SCHEME	= 417875 SQM
AREA UNDER BUILT UP	= 3745 SQM
AREA UNDER ROAD (WIDENING)	= 15471 SQM
NET SCHEME AREA	= 392659 SQM

AREA UNDER GROUP HOUSING:-

1. GH-1	= 9900 SQM
2. GH-1A	= 7000 SQM
3. GH-2	= 16200 SQM
4. GH-3	= 6000 SQM
5. GH-3A	= 5250 SQM
6. GH-3B	= 5750 SQM
7. GH-4	= 19500 SQM
8. GH-5	= 12000 SQM
9. GH-6	= 12000 SQM
10. GH-7	= 6700 SQM
11. GH-7A	= 6400 SQM
12. GH-7B	= 6700 SQM
13. GH-8	= 6400 SQM
14. GH-9	= 6800 SQM
15. GH-10	= 7100 SQM
16. GH-11	= 4700 SQM
17. GH-12	= 7210 SQM
18. GH-12A	= 2090 SQM
19. GH-13	= 21800 SQM

TOTAL AREA UNDER GROUP HOUSING

TOTAL AREA UNDER COMMERCIAL	= 16700 SQM
TOTAL AREA UNDER FACILITIES (HEALTH, SCHOOL & COMMUNITY FACILITIES)	= 38150 SQM
TOTAL AREA UNDER OPEN PARK/POND	= 58900 SQM
TOTAL AREA UNDER FILLING STATION	= 4550 SQM
AREA UNDER ROADS FOR FUTURE	= 31000 SQM
	= 73859 SQM



PRODUCED BY AN AUTODESK EDUCATIONAL PRODUCT

REVISED SITE PLAN OF PLOT NOS. 248 TO 254 & P/N SCHOOL AT KAUSHAMBI GZB.

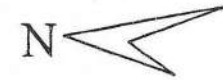
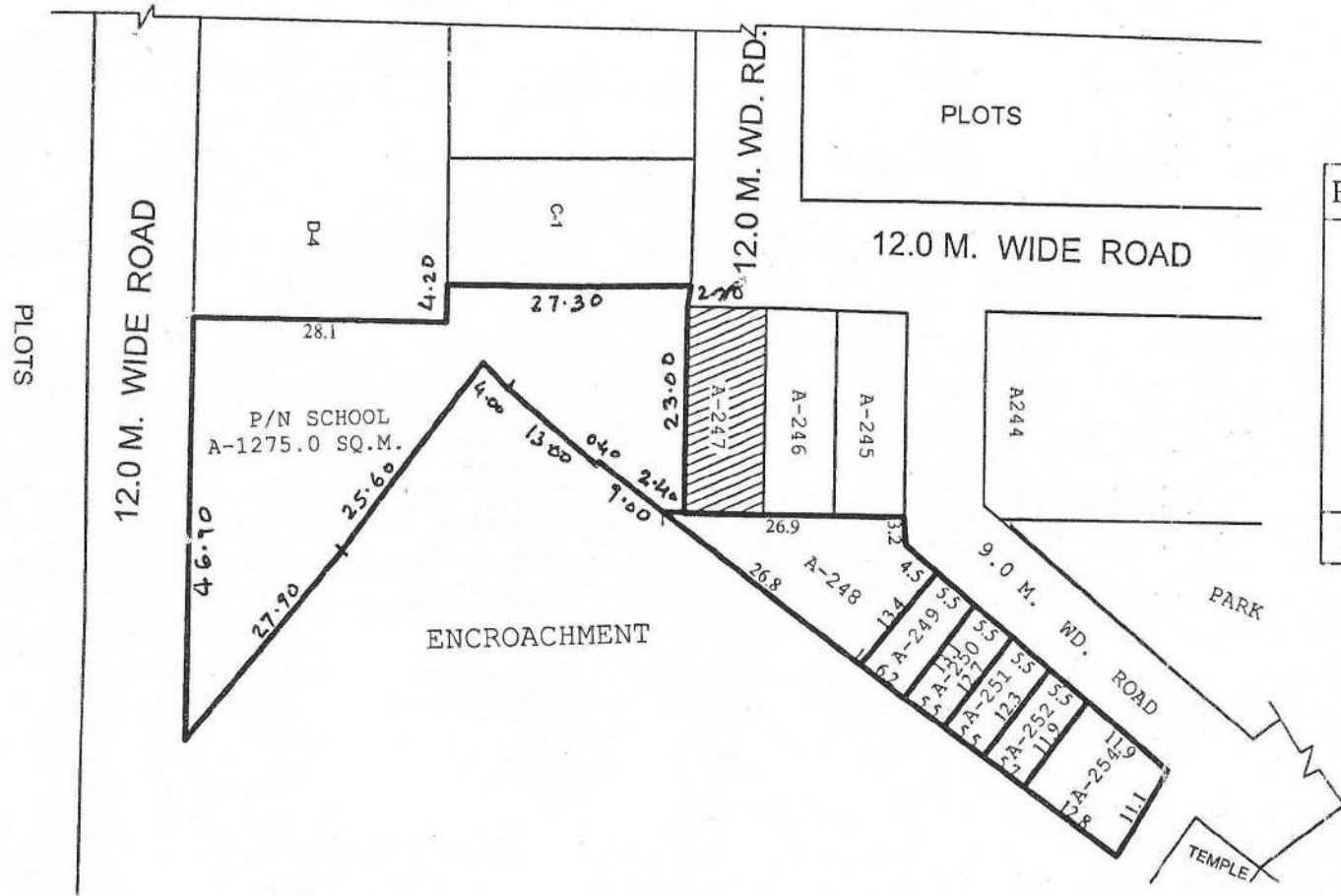

PLOT NO.	AREA (SQ.M.)
A-248	258.00 SQ.M.
A-249	77.05 SQ.M.
A-250	70.58 SQ.M.
A-251	69.28 SQ.M.
A-252	67.60 SQ.M.
A-254	141.10 SQ.M.
P/N SCH.	1275.0 SQ.M.
MISSING PLOT	A-253

4-6-15

Man

AMIN

J.E.

A.E.

E.E.

TEH-LA

T.P.

C.A.T.P.

SECRY.

V.C.

SITE PLAN OF PLOT P/NS
SCHEME IN POKET 'D' GHAZIABAD

TOTAL AREA
PART .A+B+C=5144.49 SQM

ALL DIMENSION IN METER
NOT TO SCALE

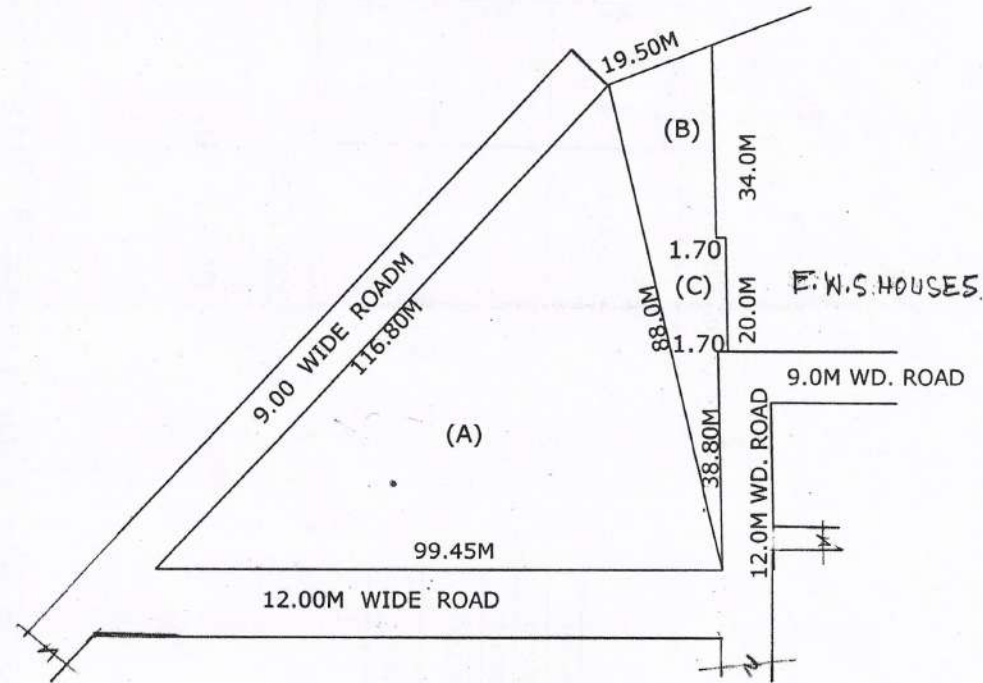
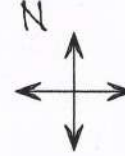

Handwritten signature
31/07/08

PREPARED BY

Handwritten signature
31/08/08

COMPARED BY

sd
(RAKESH TOMER) (V.NATH.)

MEASURED BY

A.E.

Handwritten signature
31/08/08

ATP.

T.P.

SITE PLAN OF NURSERY SCHOOL PLOT (NS-1 & NS-2)
AND CRESCH. PLOT AT E BLOCK BRIJVIHAR
SECTOR NO-VIII T.H.A GZB.

AREA CHART=

NS-1=1015.31 SQM ✓

NS-2=882.95 SQM

CRESCH

PLOT= 490.0 SQM

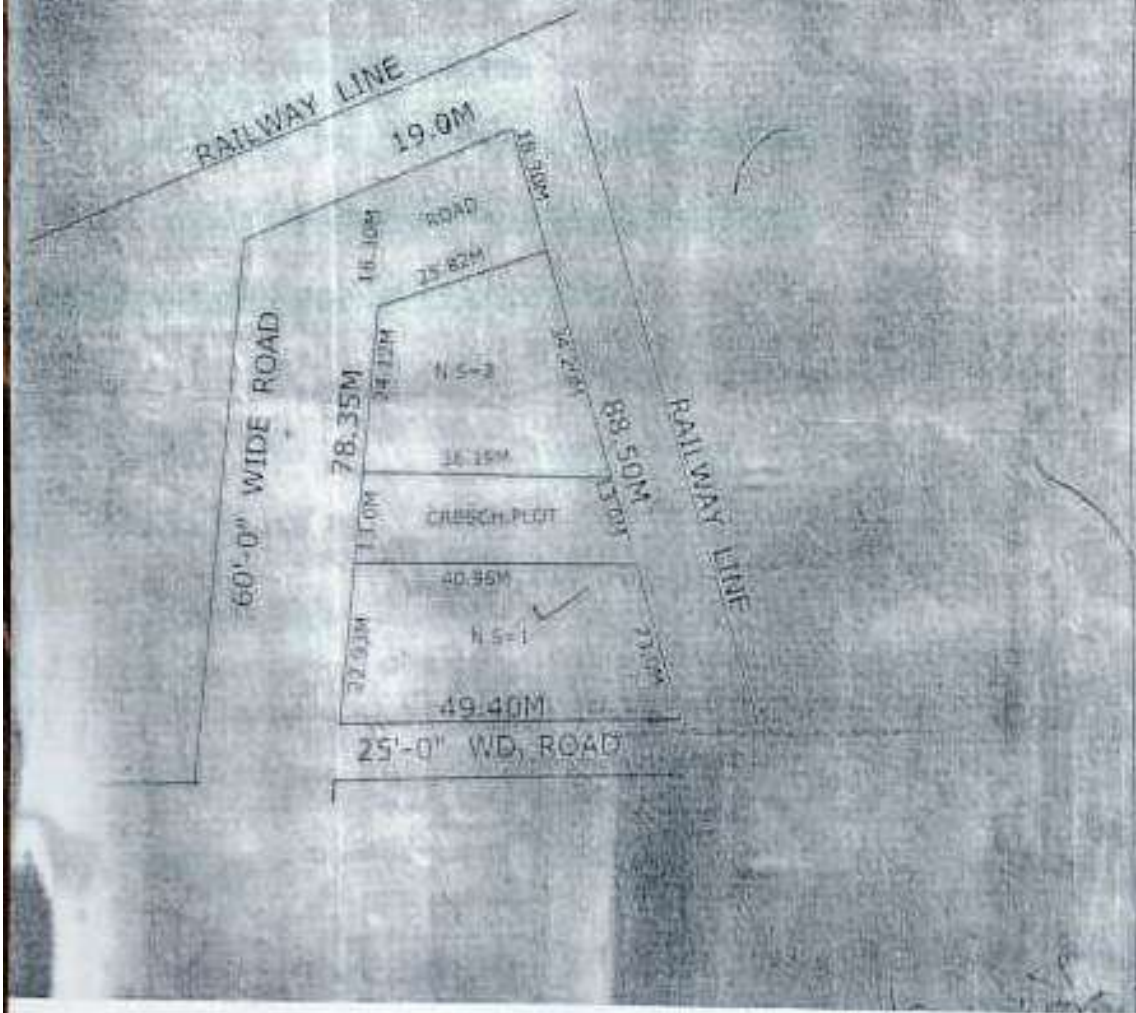
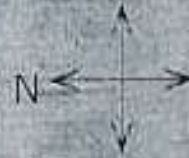

PROPOSED PART LAYOUT PLAN AT SECTOR III, BEHIND CHAAYA PUBLIC SCHOOL.VAISHALI

(POCKET - NP)

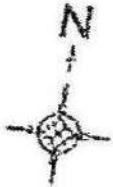

PLOTS SIZE = 16.50 X 8.50 M.
 AREA = 140.25 SQ M.
 NO. OF PLOTS = 18

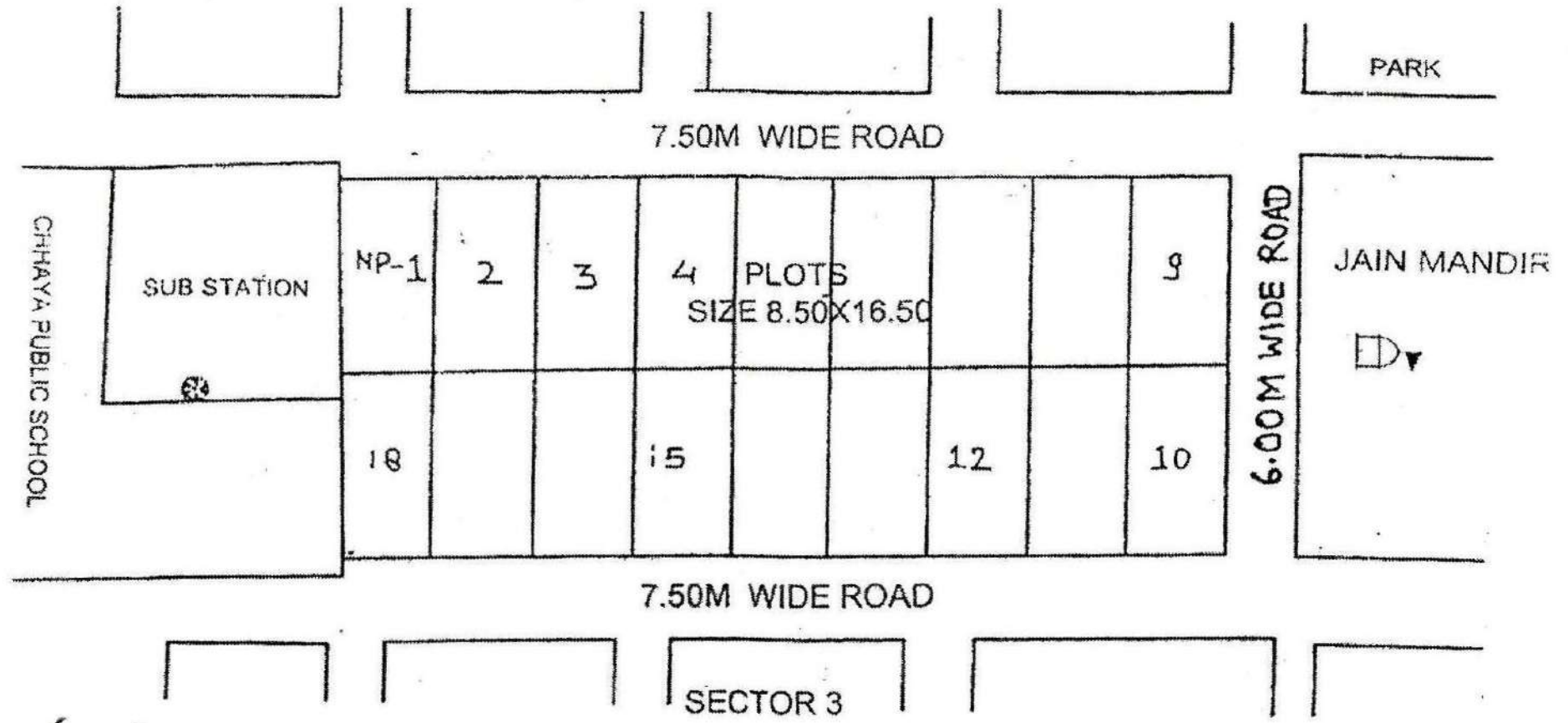

[Signature]
 D/IAN

[Signature]
 19/10/12
 TOWN PLANNER

[Signature]
 CATP

[Signature]
 SECY.

[Signature]

SITE PLAN OF KIOSKS PLOT NO..... IN C-BLOCK R.D.C. RAJ-NAGAR GHAZIABAD

TOTAL NOS. OF KIOSKS - 18

15.0 METRE WIDE ROAD

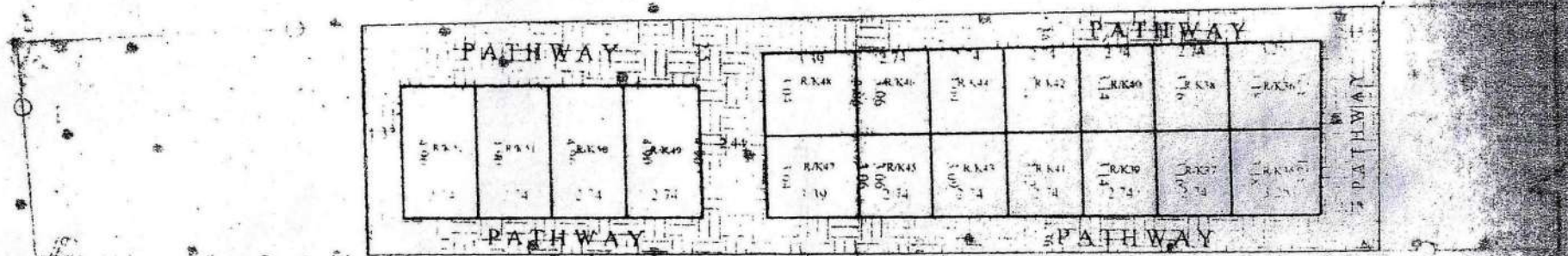

AREA-CHART

- R/K35 & RK36 = 10.38 sq.mt.
- R/K37 & RK38 = 8.68 sq.mt.
- R/K39 & RK40 = 8.63 sq.mt.
- R/K41 & RK42 = 8.57 sq.mt.
- R/K43 & RK44 = 8.50 sq.mt.
- R/K45 & RK46 = 8.43 sq.mt.
- R/K47 & RK48 = 10.34 sq.mt.
- R/K49 TORK52 = 13.42 sq.mt.

12.0 METRE WIDE ROAD

PREPARED BY

COMPARED BY

MEAS.&AREA CAL.(J.E.)

ASIT. ENGR

डा० हरेन्द्र कुमार मिश्र
संयुक्त सचिव
जी० डी० ए०

AT TULSI NIKETAN SCHEME THA IN GHAZIABAD

SCALE : 1 CM = 5 Mts.

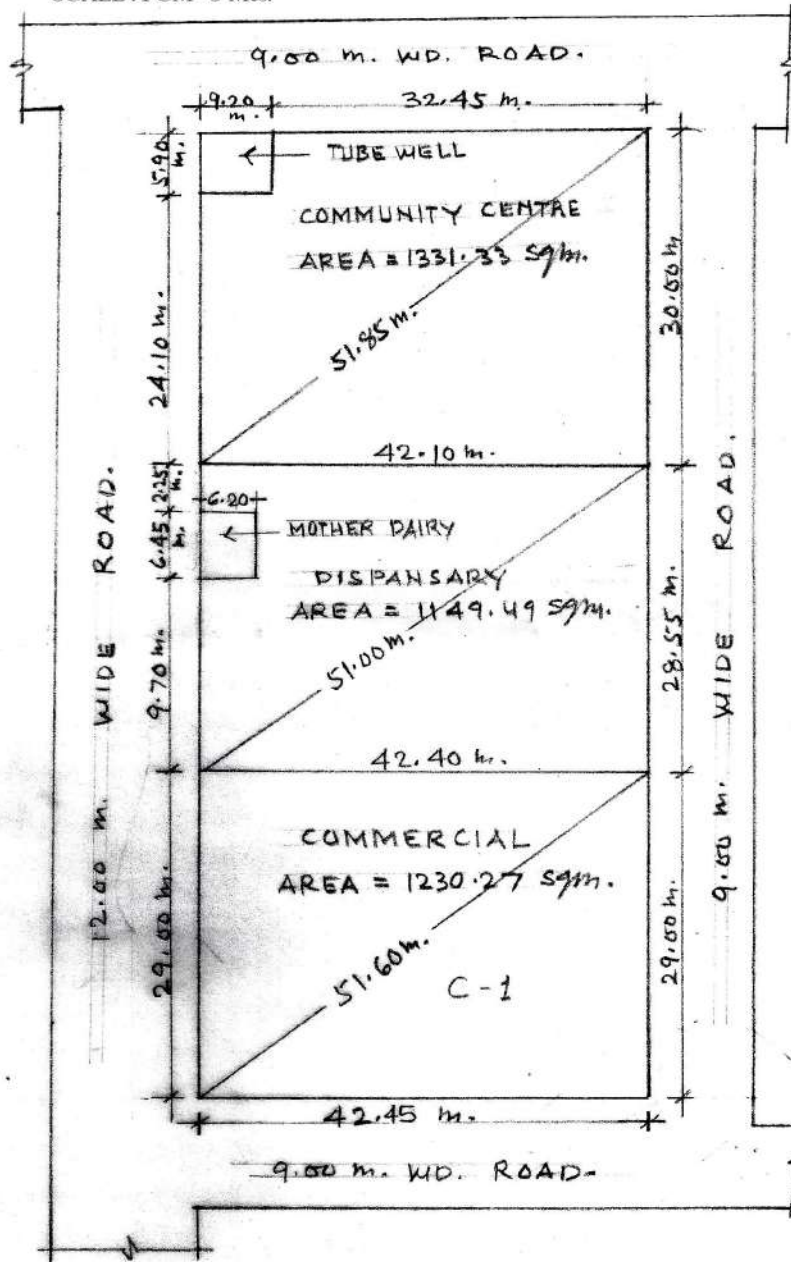

Prepared by: *[Signature]* 10/01/07
 Compared by: *[Signature]* 11/01/07
 Measured by: *[Signature]* 22/01/07
 Assst Engr. Town Planner: *[Signature]* 24/01/07