

# SITE PLAN OF PLOT NO. A-71/6, AT A-BLOCK GOVINDPURAM

PLOT AREA NO OF 71/6 = 208.90 SQ.MT.

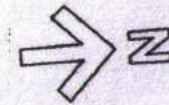

GDA's A-BLOCK PLOTS

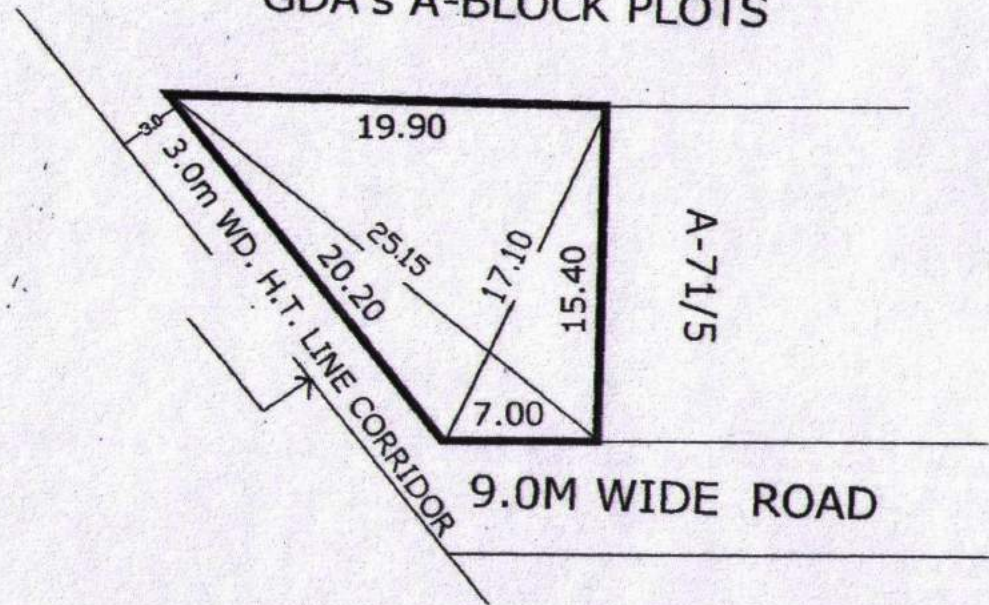

*Handwritten signature and date: 11/5/16*

PREPARED BY  
D,MAN

COMPARED BY.

J.E.

A.E.

E.E.

T.P.

SITE PLAN OF PLOT NO. AC-

AT AMBEDKAR ROAD, DISTT. CENTRE GZB

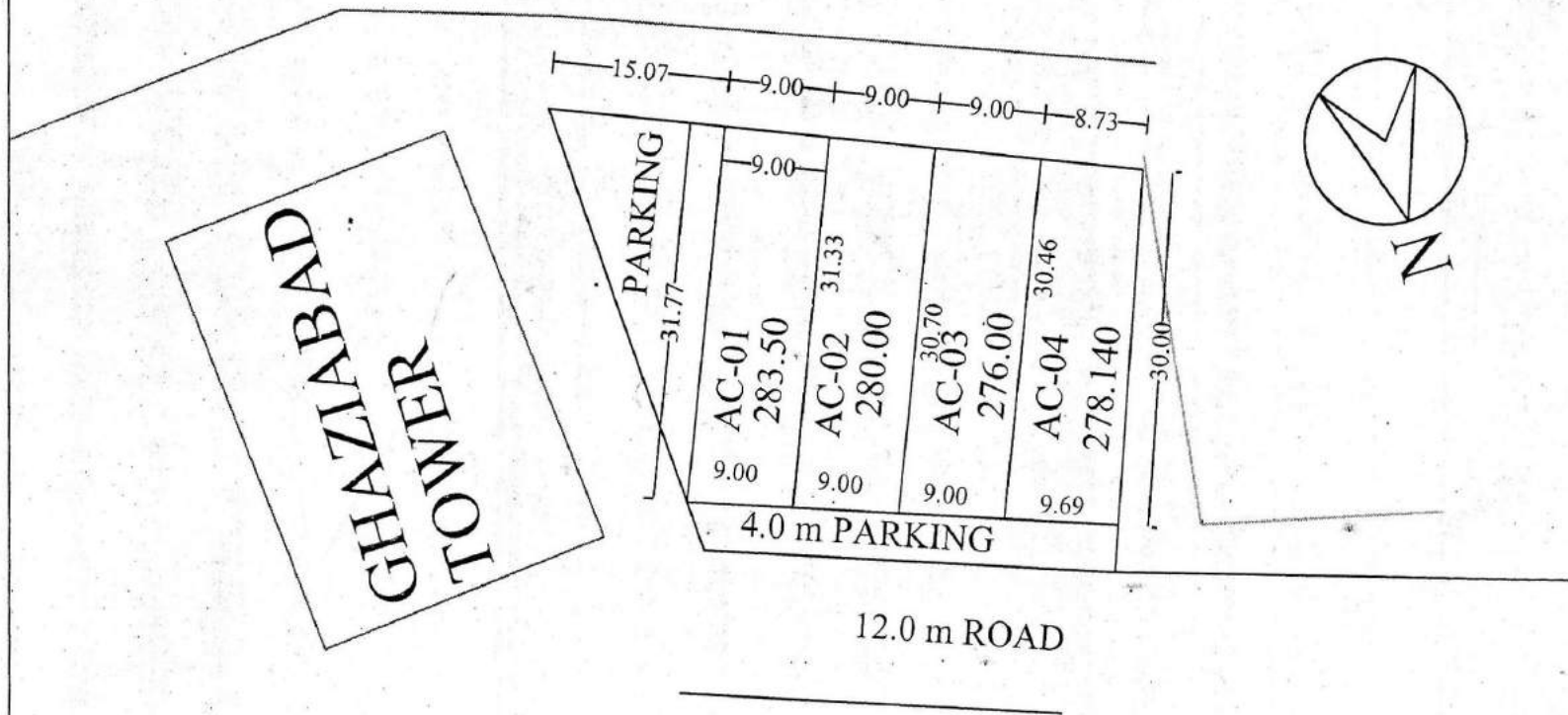

*[Signature]*  
31/03/10

PREPARED By.

COMPARED By.

*[Signature]*  
31/3/10

Measured By.

*[Signature]*  
31.03.10

Astt. Engineer

*[Signature]*  
07/4/10

Town Planner.

SITE PLAN OF PLOT NO. AC- 06 AT AMBEDKAR ROAD, DISTT. CENTRE GZB

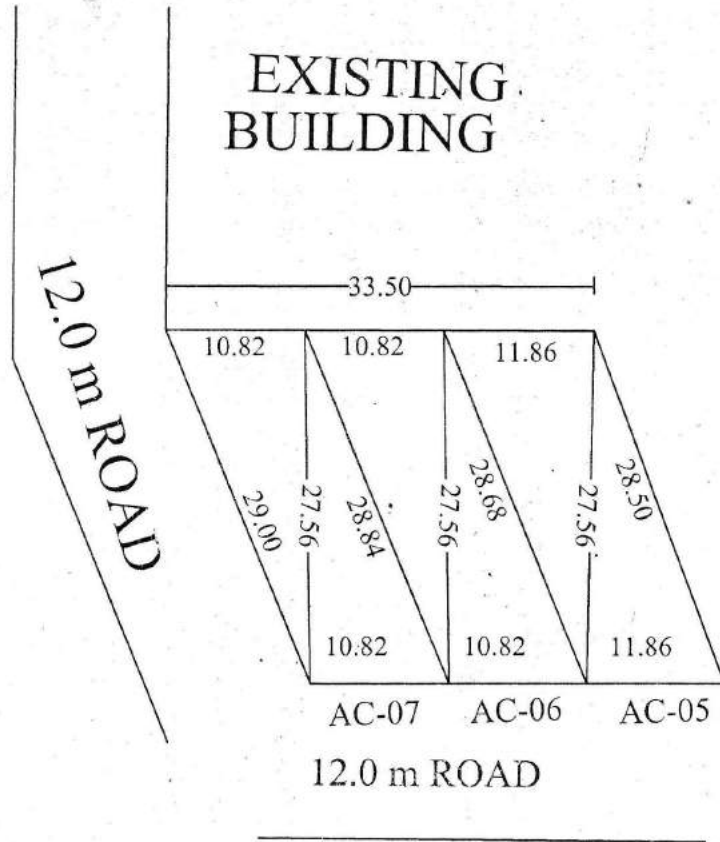

PLOT NO.	AREA
AC-05	311.03 SQ.M
AC-06	296.64 SQ.M
AC-07	296.97 SQ.M

*[Signature]*  
84/03/12.  
PREPARED By.

*[Signature]*  
27/3/12  
COMPARED By.

*[Signature]*  
20/3/12  
Measured By.

*[Signature]*  
26/03/12  
Asstt. Engineer

*[Signature]*  
27/3/12  
Town Planner.

SITE PLAN OF PLOT NO. AC-

AT AMBEDKAR ROAD, DISTT. CENTRE GZB

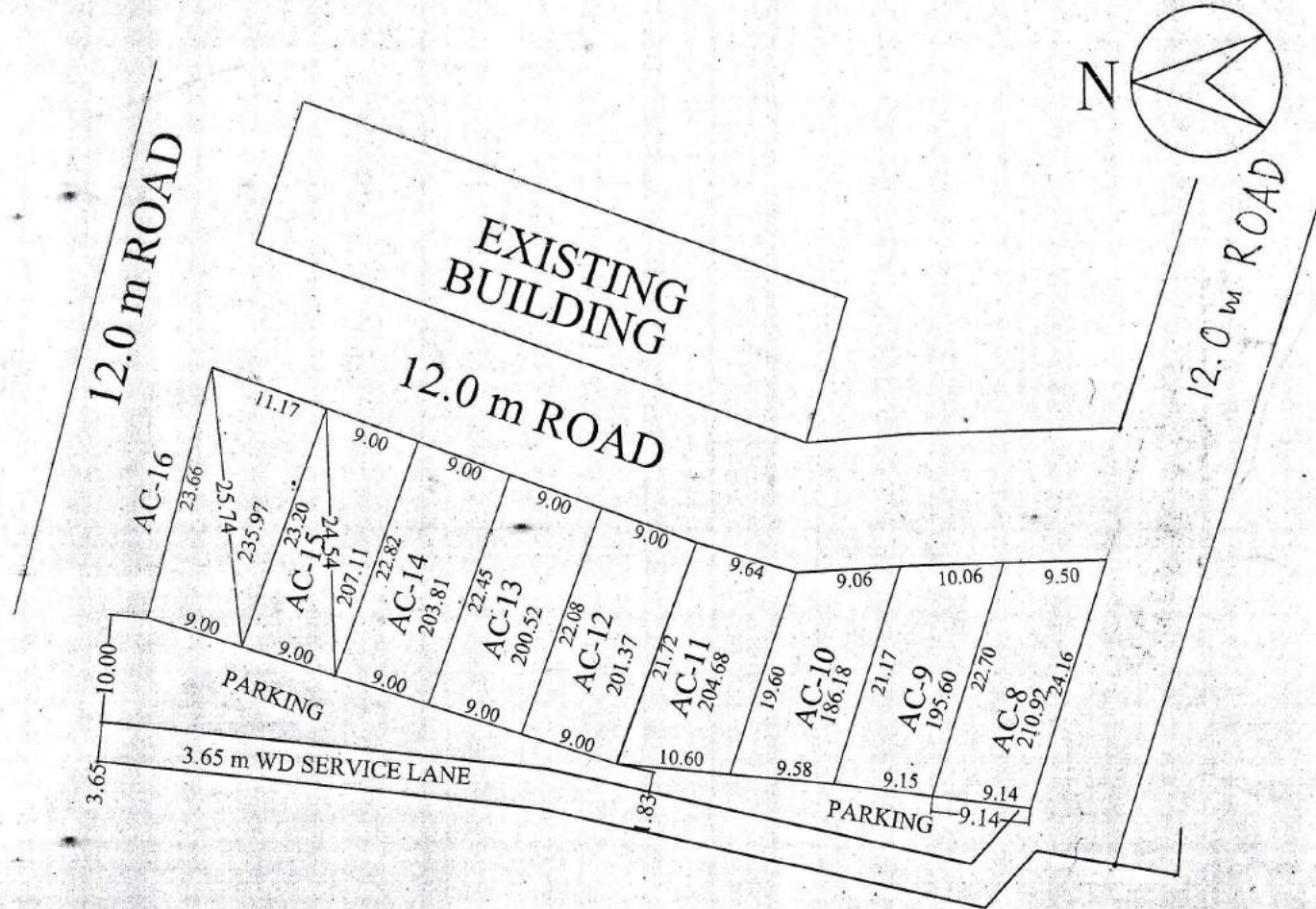

*[Signature]*  
29/12/08  
PREPARED By.

*[Signature]*  
29-12-08  
COMPARED By.

*[Signature]*  
Measured By.

*[Signature]*  
29.12.08  
Asstt. Engineer

*[Signature]*  
29/12/08  
A.T.P.

*[Signature]*  
29/12/08  
E.E.

*[Signature]*  
29/12/08  
Town Planner.

SITE PLAN FOR COMMERCIAL PLOT NO. AT AMBEDKAR ROAD, DISTT. CENTRE

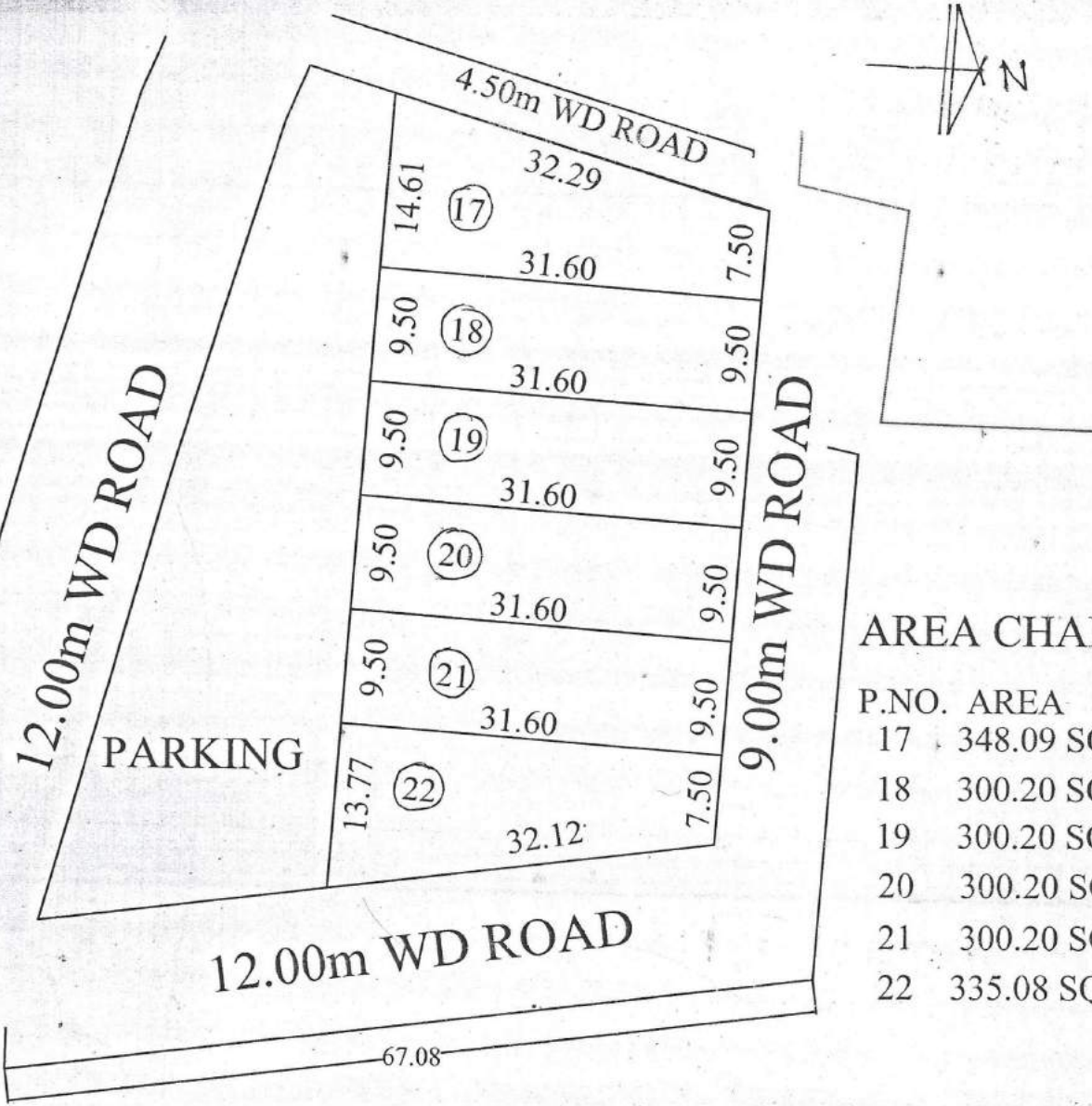

AREA CHART

P.NO.	AREA
17	348.09 SQM
18	300.20 SQM
19	300.20 SQM
20	300.20 SQM
21	300.20 SQM
22	335.08 SQM

PREPARED BY  
 [Signature]  
 30/08/08

COMPARED BY  
 [Signature]  
 30/8/08  
 sd. Zaksir Ali  
 dt 26/08/08  
 J.E.

A.E.  
 sd. sharma  
 dt 26/08/08  
 A.T.P.

T.P.  
 [Signature]  
 30/08/08

SITE PLAN OF POLICE CHOWKI PLOT, COMMUNITY CENTER PLOT & HIGH SCHOOL PLOT A  
POCKET-B MADHUBAN BAPUDHAM YOJNA , GDA, GZB.

HIGH SCHOOL PLOT - B/H.S.-1 = 1567.68 SQ.M.  
 COMM. CENTER PLOT - B/C.C.-1 = 2832.56 SQ.M.  
 POLICE CHOWKI PLOT - B/P.C.-1 = 3098.30 SQ.M.

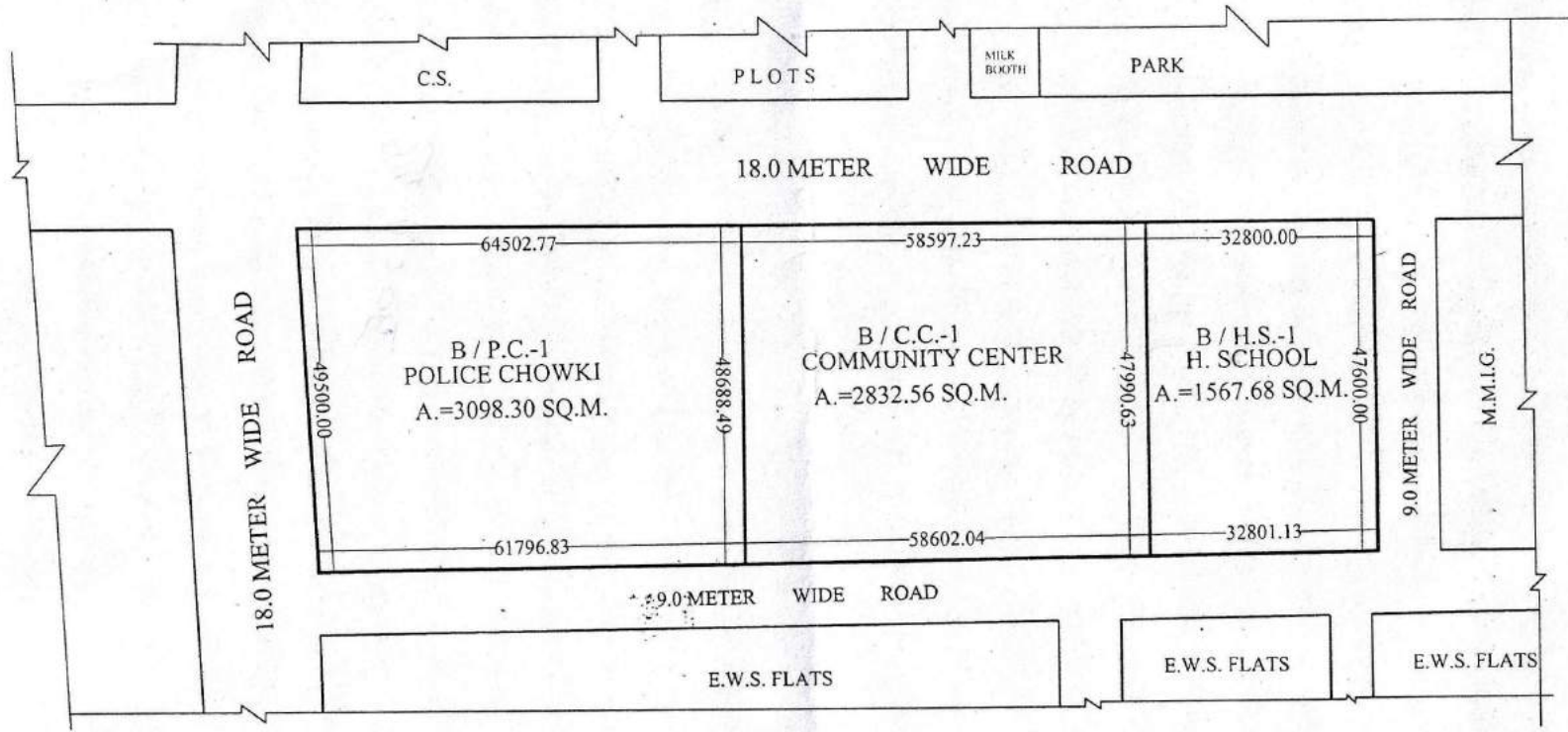

*Shrawi*  
11-02-21  
PREPARED BY.

*Sanved*  
25/02/21  
COMPARED BY.

*[Signature]*  
MEAS.&AREA CAL.(J.E.)

*[Signature]*  
A.E.

*[Signature]*  
E.E.

*[Signature]*  
TOWN PLANNER

# REVISED PART LAYOUT PLAN OF COMMERCIAL PLOT C-1/1 TO C-1/16 & GROUP HOUSING PLOT GH-4 AT, KOYAL ENCLAVE SCHEME, LONI, G.D.A. GHAZIABAD

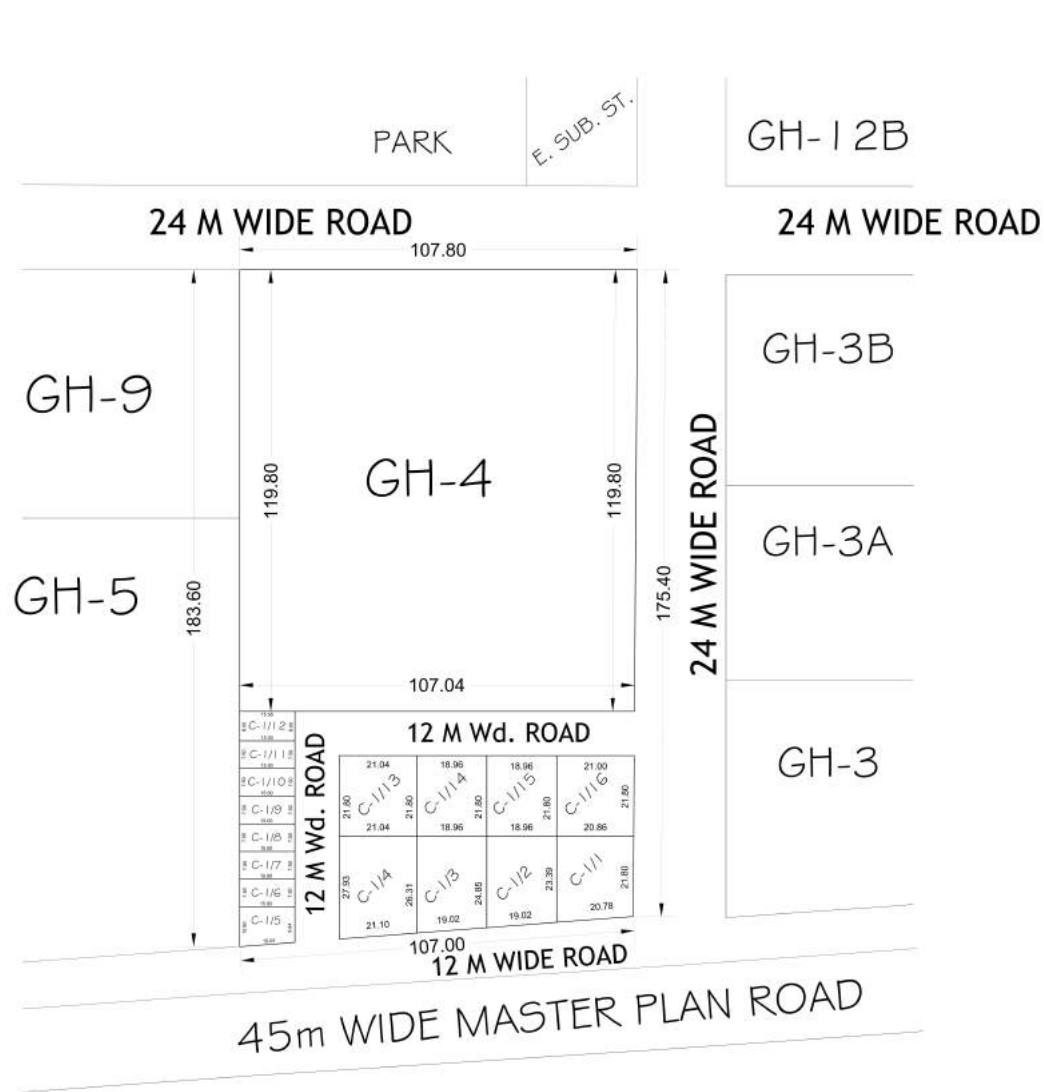

COMMERCIAL PLOTS  
GROUND COVERAGE - 50%  
F.A.R. - 1.75

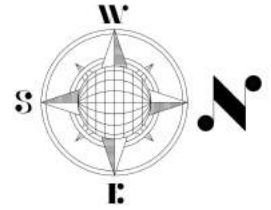





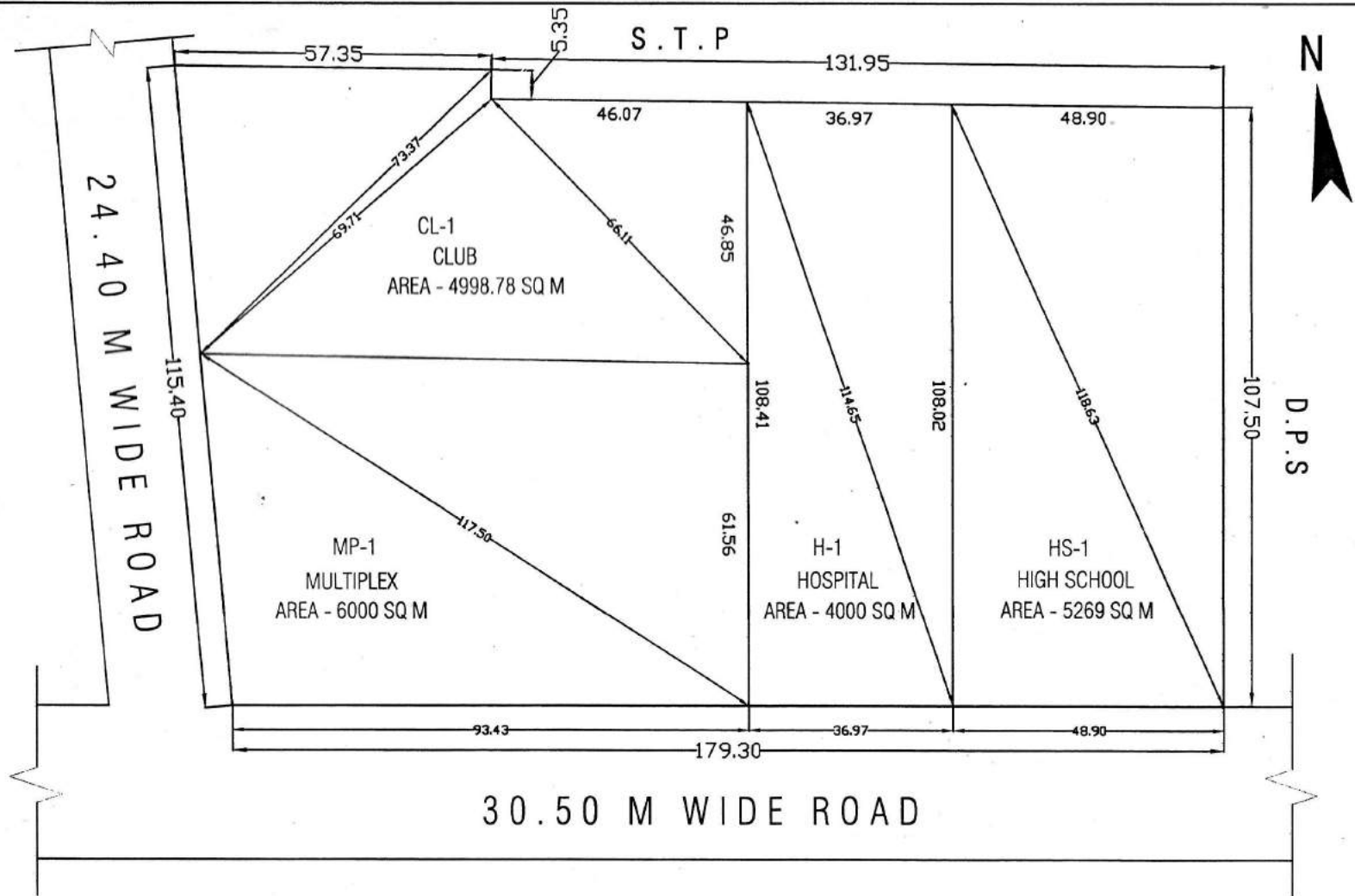

AREA SCHEDULE	
PLOT No.	AREA (IN Sqmt.)
C-1/1	469.78
C-1/2	457.36
C-1/3	485.00
C-1/4	570.61
C-1/5	153.40
C-1/6 to C-1/11	112.50
C-1/12	120.00
C-1/13	458.71
C-1/14 & C-1/15	413.32
C-1/16	456.29
<b>GH-04</b>	<b>12867.54</b>

COMMERCIAL SET BACK	
BELOW 200.00 Sqmt.	ABOVE 200.00 Sqmt.
FRONT - 3.00 Sqmt.	FRONT - 4.50 Sqmt.
REAR - 3.00 Sqmt.	REAR - 3.00 Sqmt.
	SIDE - 3.00 Sqmt.
	SIDE - 3.00 Sqmt.

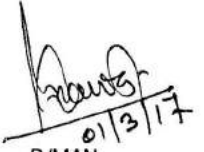
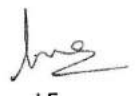
**REV. SITE PLAN OF MULTIPURPOSE COMMUNITY FACILITIES NEAR D.P.S., SK-IV, INDIRAPURAM**

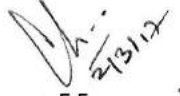
TOTAL AREA OF THE LAND - 20268.80 SQ.M



 01/3/17  
  
  
 2/13/17  
 03/12/17  
  
  



**PART LAYOUT PLAN OF SHOPS PLOT , HOTEL, COMMERCIAL & NURSING HOME PLOT ON COMMERCIAL (COM-2) PLOT & COMMERCIAL/RESIDENTIAL (C/G.H.-1) PLOT IN POCKET C , MADHUBAN BAPUDHAM YOJNA GHAZIABAD**

TOATAL AREA OF LAND	= 60938.57 SQ.M.	SHOPS PLOT - 10.00M. X 28.15M. - 281.50 SQ.M. - 10 ( C/S.P.-06 TO C/S.P.-15 )	
AREA UNDER SHOPS PLOT	= 21632.30 SQ.M.	SHOPS PLOT - 10.00M. X 20.00M. - 200.00 SQ.M. - 38 ( C/S.P.-50 TO C/S.P.-64 , C/S.P.-89 TO C/S.P.- 111 )	
AREA UNDER HOTEL	= 1788.72 SQ.M.	SHOPS PLOT - 09.00M. X 18.00M. - 162.00 SQ.M. - 39 ( C/S.P.-01 TO C/S.P.-05 , C/S.P.-16 TO C/S.P.- 49 )	
AREA UNDER NURSING HOME	= 1308.58 SQ.M.	SHOPS PLOT - 08.00M. X 12.50M. - 100.00 SQ.M. - 47 ( C/S.P.-65 TO C/S.P.-88 , C/S.P.- 112 TO C/S.P.-134 )	
AREA UNDER COMMERCIAL	= 1154.00 SQ.M.	TOTAL NOS. OF SHOPS PLOT	- 134
AREA UNDER MULTILEVEL P.	= 5468.95 SQ.M.		
AREA UNDER TOILET /D.W.	= 322.60 SQ.M.		
AREA UNDER GREEN/CENTRAL PLAZA	= 7877.60 SQ.M.		
AREA UNDER CAR PARKING	= 2824.32 SQ.M.		
AREA UNDER PAVED PATHWAY	= 18561.50 SQ.M.		
TOTAL NOS. OF CAR IN CAR PARKING	- 185		

SHOPS PLOT  
 F.A.R = 3 - G.F.L., F.F. & S.F. (AS PER CONTROL DRG.)  
 (BASEMENT AREA IS FREE FORM FAR.)  
 GROUND COVERAGE = 100 %

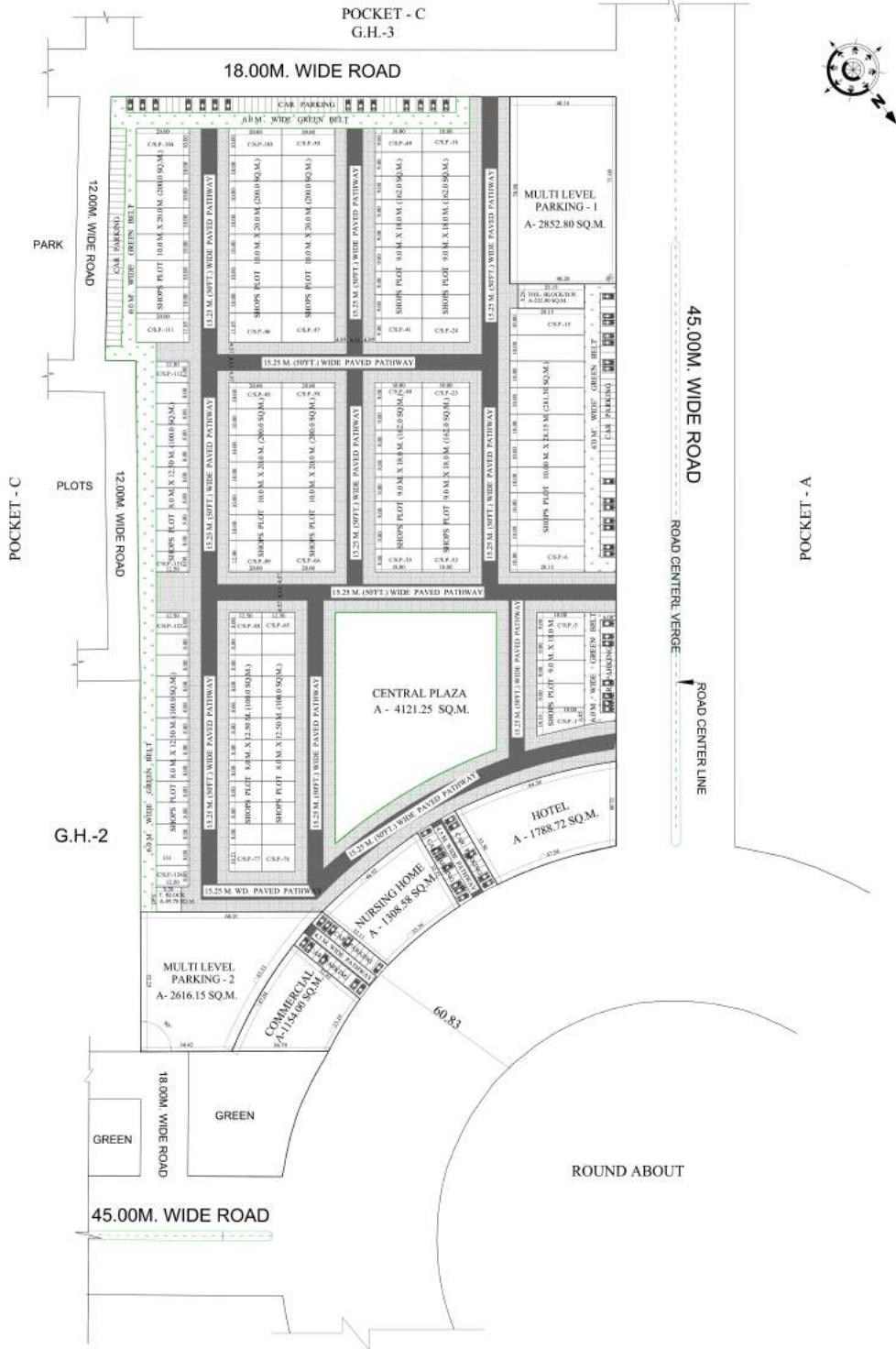

**SITE PLAN OF PLOT NO.CS-4 BLOCK-D IN SWARN J.PURAM  
SCHEME G.M.P GHAZIABAD**

TOTAL AREA OF PLOT NO- C S-4 =1622 SQM.

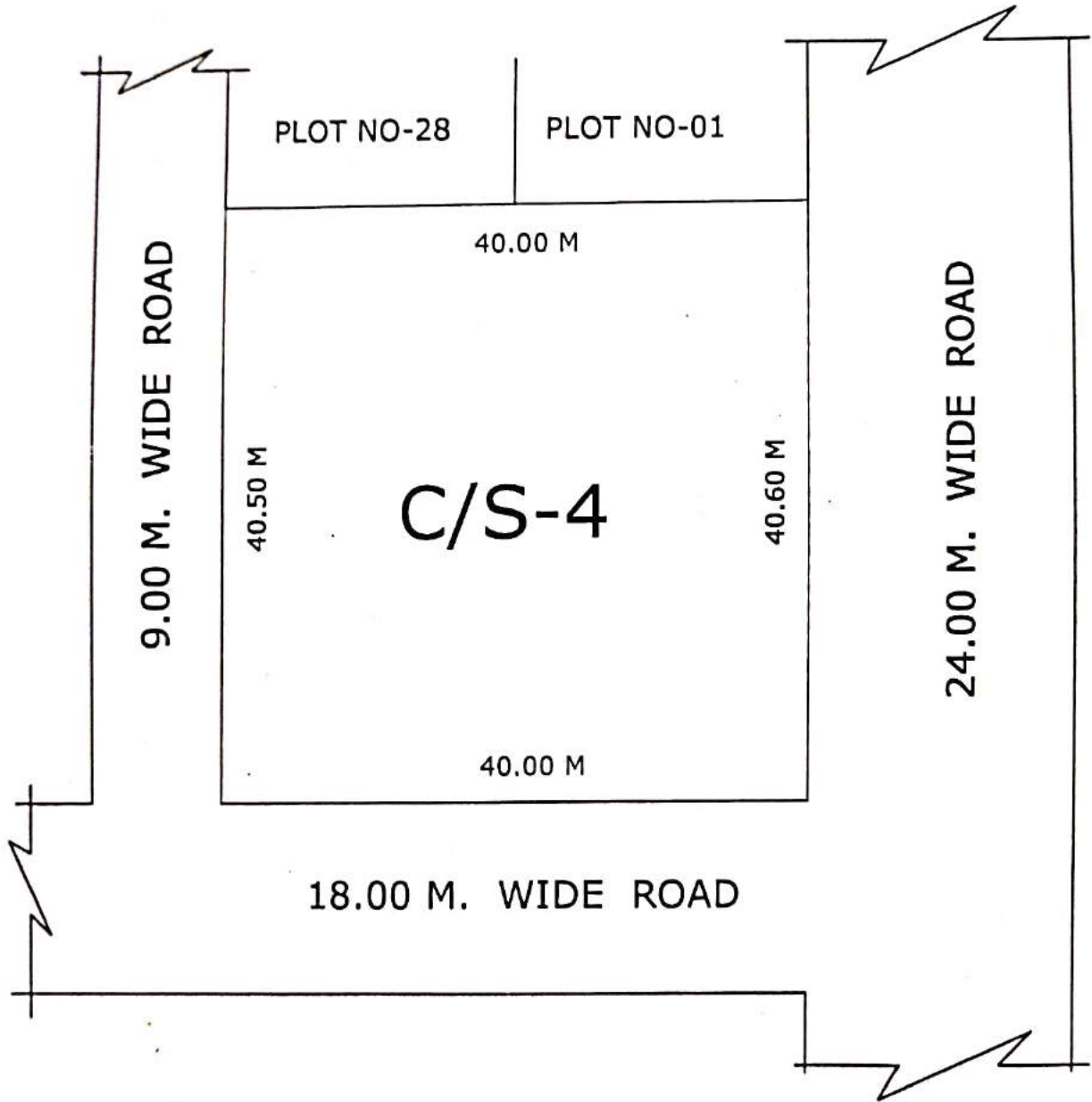

  
D/M

   
J.E. A.E.

  
E.E.-3

  
T.P. 01/2/22

  
C.A.T.P. 01/2/2022

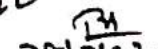
  
SECY 28/7/22

  
V.C.

# SITE PLAN OF RESIDENTIAL PLOT No. - K-1, GROUP HOUSING (GH) No. - 1, 1A & 10, PRIMARY / NURSURY (P/N) No. - 1 & FILLING STATION AT KOYAL ENCLAVE SCHEME, LONI, GHAZIABAD

## AREA SCHEDULE

RESIDENTIAL PLOT No.K-1	= 1265.00 Sqm.
FILLING STATION	= 2500.00 Sqm.
GROUP HOUSING (G.H.) No.-1	= 8565.00 Sqm.
GROUP HOUSING (G.H.) No.-1A	= 6958.00 Sqm.
GROUP HOUSING (G.H.) No.-10	= 7140.00 Sqm.
PRIMARY / NURSURY (P/N) No.-1	= 3726.00 Sqm.

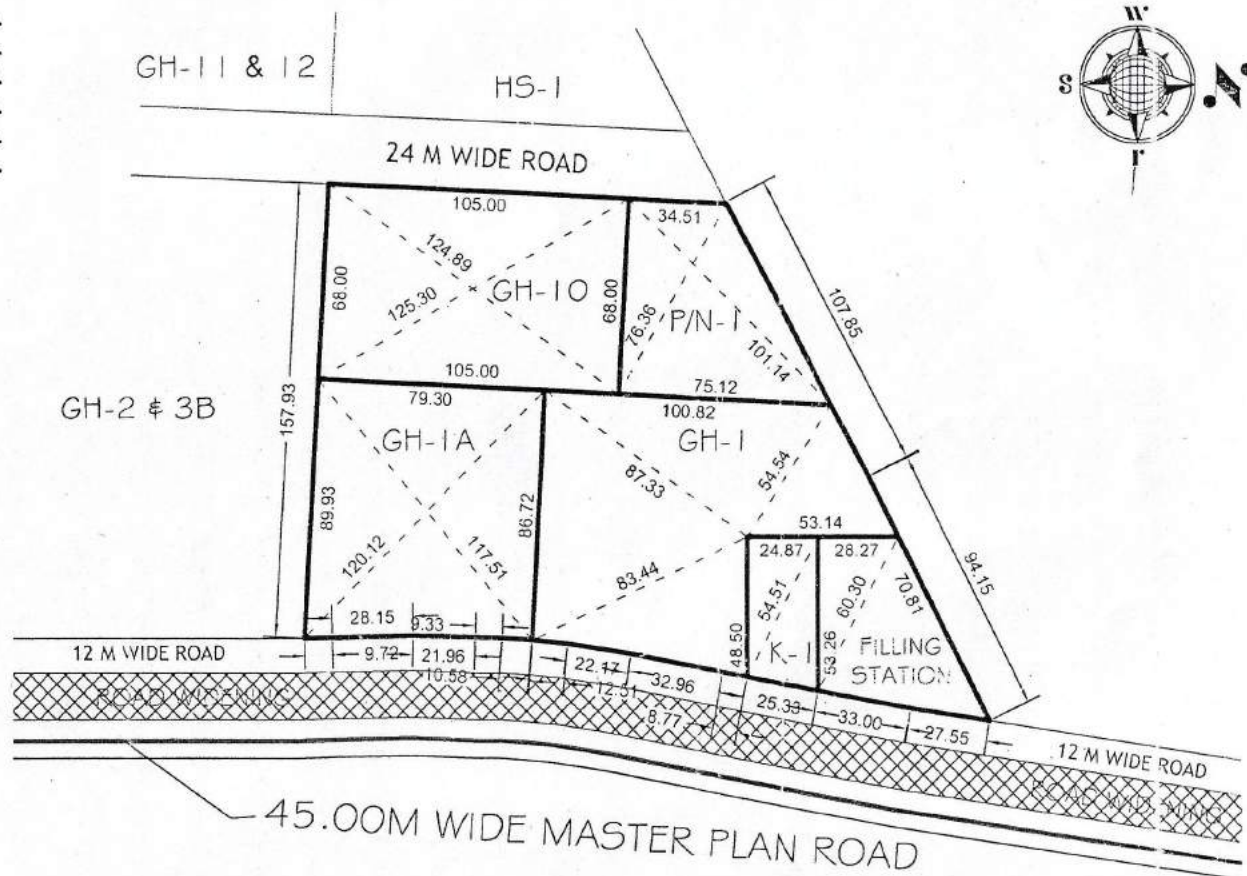

*[Signature]*  
6/10/16  
NITIN KUMAR  
D/Man

*[Signature]*  
6/10/16  
ANAND SWAMI  
AMIN

*[Signature]*  
R.K. KAUSHIK  
JUNIOR ENGINEER

*[Signature]*  
NARENDRA KUMAR  
ASSISTANT ENGINEER

*[Signature]*  
R.K. JAISWAL  
EXECUTIVE ENGINEER

*[Signature]*  
RAJKUMAR MITTAL  
TEHSILDAR (L.A.)

*[Signature]*  
23/10/16  
JYOTI PRASAD  
TOWN PLANNER

*[Signature]*  
6/10/16  
ISTIYAQ AHMED  
CA 79

*[Signature]*  
RAVINDRA GODSOLE  
SECRETARY

*[Signature]*  
VIJAY KUMAR GOYAL  
VICE CHAIRMAN



# REVISED PART LAYOUT PLAN OF COMMERCIAL PLOT C-1/1 TO C-1/16 & GROUP HOUSING PLOT GH-4 AT, KOYAL ENCLAVE SCHEME, LONI, G.D.A. GHAZIABAD

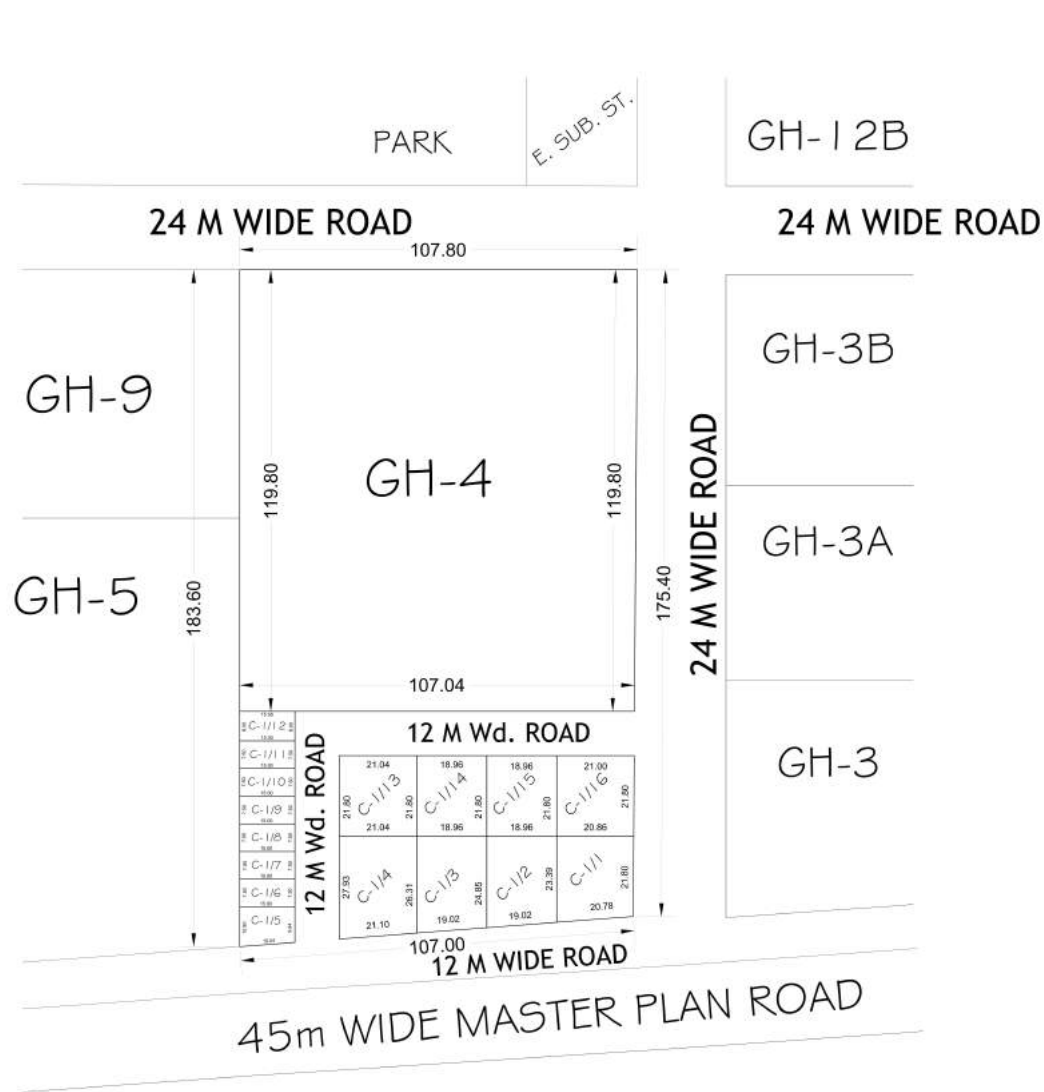

AREA SCHEDULE	
PLOT No.	AREA (IN Sqmt.)
C-1/1	469.78
C-1/2	457.36
C-1/3	485.00
C-1/4	570.61
C-1/5	153.40
C-1/6 to C-1/11	112.50
C-1/12	120.00
C-1/13	458.71
C-1/14 & C-1/15	413.32
C-1/16	456.29
<b>GH-04</b>	<b>12867.54</b>

COMMERCIAL SET BACK	
BELOW 200.00 Sqmt.	ABOVE 200.00 Sqmt.
FRONT - 3.00 Sqmt.	FRONT - 4.50 Sqmt.
REAR - 3.00 Sqmt.	REAR - 3.00 Sqmt.
	SIDE - 3.00 Sqmt.
	SIDE - 3.00 Sqmt.

# GHAZIABAD DEVELOPMENT AUTHORITY

## REVISED PART LAYOUT PLAN OF GROUP HOUSING PLOT No. - GH 5 & 6, AT KOYAL ENCLAVE SCHEME, LONI, GHAZIABAD

### AREA SCHEDULE

GROUP HOUSING PLOT GH - 5, 6 = 24143.46 Sqmt.

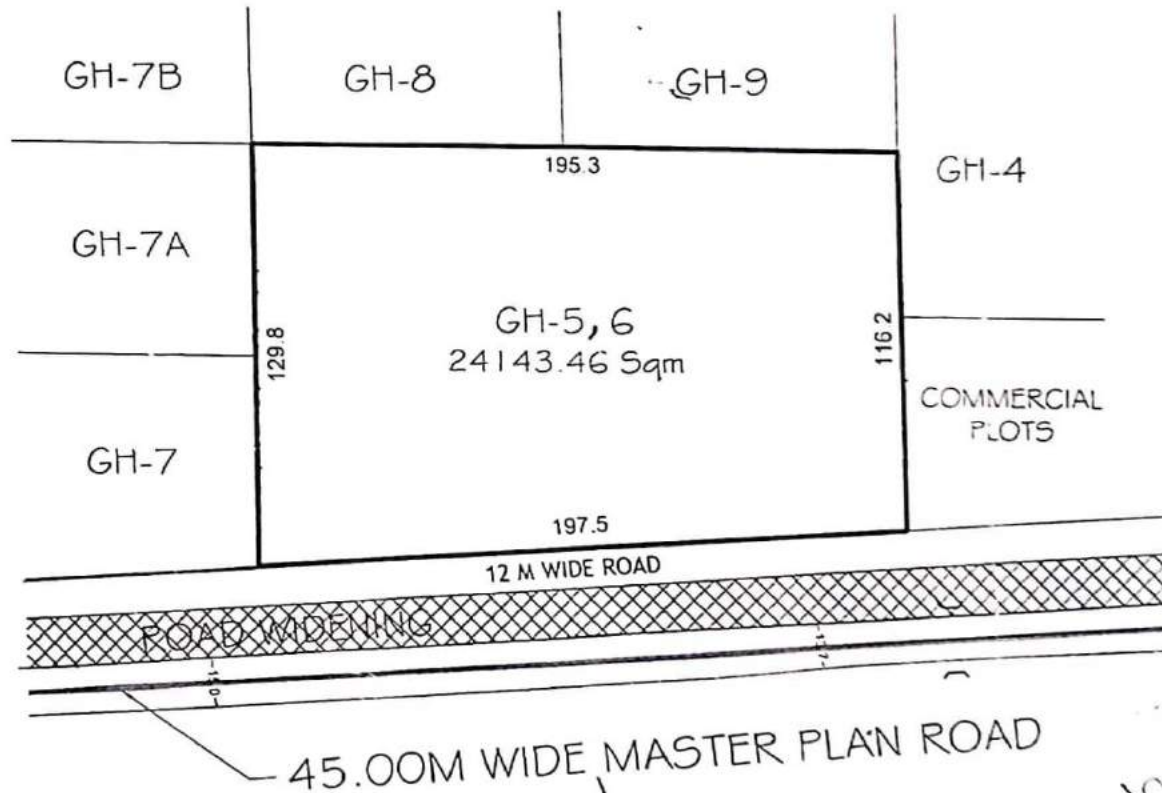

1/2022  
AMIN

JUNIOR ENGINEER

ASSISTANT ENGINEER

EXECUTIVE ENGINEER

TOWN PLANNER

TOWN PLANNER

C.A.T.P.

SECRETARY

VICE CHAIRMAN

REV. PART LAYOUT PLAN OF COMM. PLOTS & SHOPS ON C.P.-1 AT GYAN KHAND - III  
 INDIRAPURAM, G.D.A. GHAZIABAD:-

AL PLOT AREA : 3533.00 SQ.M.

GR. COV. = 60%  
 F.A.R. = 1.5

TYPE	AREA (APROX.)	NOS.
COMMERCIAL PLOT - 1	= 325.20 SQ.M.	= 01
COMMERCIAL PLOT - 2	= 314.45 SQ.M.	= 01
SHOPS - 6.70M. X 12.50M.	= 83.75 SQ.M.	= 06
SHOPS - 6.00M. X 09.50M.	= 57.00 SQ.M.	= 07
SHOPS - 5.00M. X 07.47M.	= 37.35 SQ.M.	= 05



AN      AMIN      J.E.      R.E.      E.E.      TEH.SA.      T.P.      G.A.T.P.      SECRETARY      VICE CHAIRMAN

# REVISED PART LAYOUT PLAN OF COMMERCIAL LAND IN INDRAPRASTH YOZNA, POCKET - H, LONI, GZB.

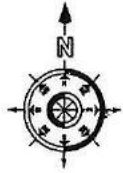

**AREA SCHEDULE (COMM. PLOTS)**

PLOT Nos.	AREA (IN Sqm.)
5	510.00
6 To 12	195.00
13 & 14	270.00
15 To 21	195.00
22	445.00
23	64.05
24 To 29	55.00
30 & 31	85.00
32 & 33	55.00
33A, 33B & 33C	55.00
34	65.20
35	360.00
36 To 41	195.00
42 & 43	270.00
44 To 49	195.00
50	292.00
51	314.00
52 To 66	195.00

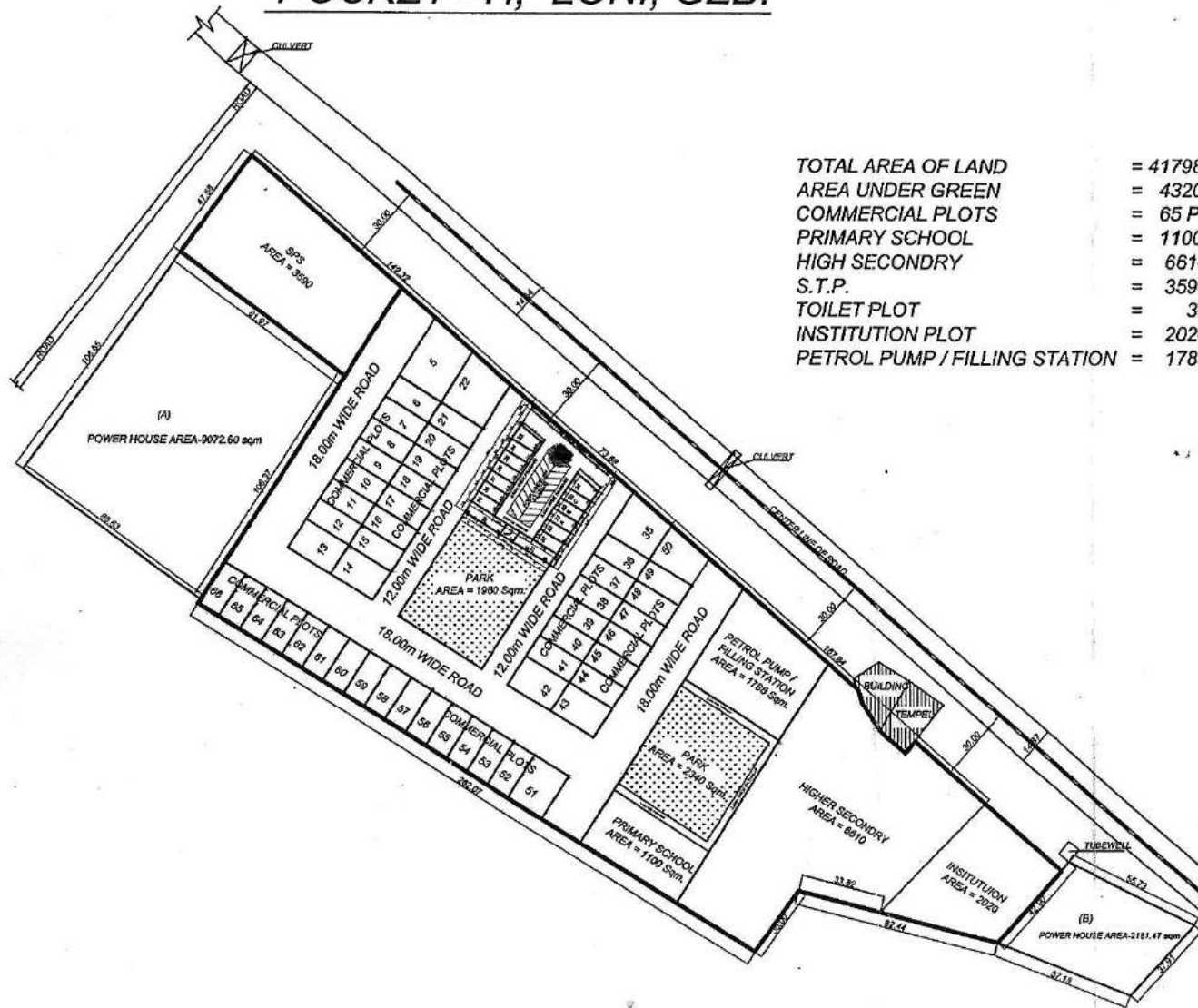

TOTAL AREA OF LAND	= 41798.00 Sqm.
AREA UNDER GREEN	= 4320.00 Sqm.
COMMERCIAL PLOTS	= 65 PLOTS
PRIMARY SCHOOL	= 1100.00 Sqm.
HIGH SECONDRY	= 6610.00 Sqm.
S.T.P.	= 3590.00 Sqm.
TOILET PLOT	= 30.00 Sqm.
INSTITUTION PLOT	= 2020.00 Sqm.
PETROL PUMP / FILLING STATION	= 1788.00 Sqm.

D/Man    Jun. Engr.    Astd. Engr.    Ex. Engr.    T.P.(R)    T.P.(K)    C.A.T.P.    SECRETARY    V.C.





SITE PLAN OF PLOT P/NS  
SCHEME IN POKET 'D' GHAZIABAD

TOTAL AREA  
PART A+B+C=5144.49 SQM

ALL DIMENSION IN METER  
NOT TO SCALE

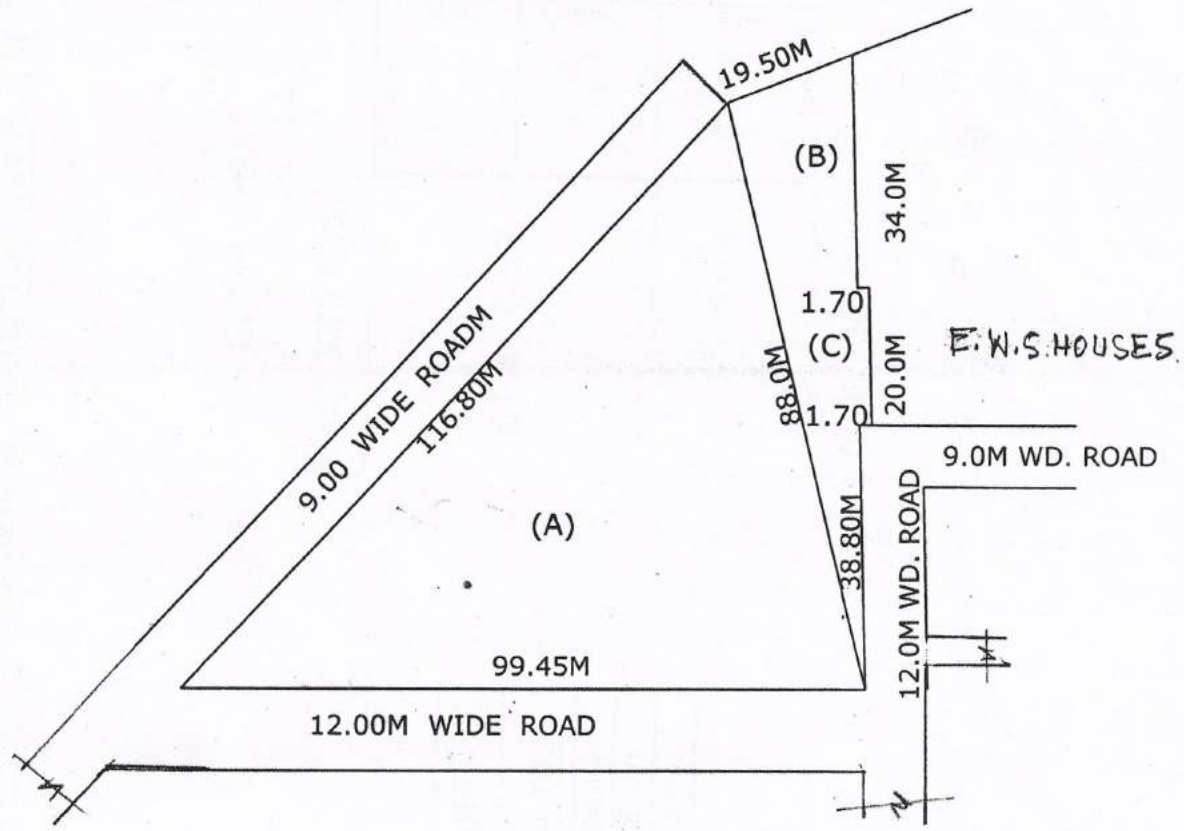
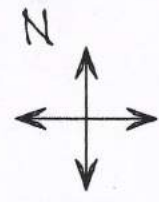

*Handwritten signature*  
31/07/08

PREPARED BY

*Handwritten signature*  
31/08/08

COMPARED BY

sd  
(RAKESH TOMER) (V.NATH)

MEASURED BY A.E.

*Handwritten signature*  
31/08/08  
ATP.

*Handwritten signature*  
31/08/08  
T.P.

SITE PLAN OF PLOT FOR BANK, ART GALLERY, HOTEL & FILLING STATION AT KARPOORI PURAM SCHEME.

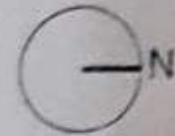

- AREA OF ART GALLERY = 540 SQM
- AREA OF BANK = 580.00 SQM
- AREA OF HOTEL = 1007.00 SQM
- AREA OF FILLING STATION = 533.00 SQM

PREPARED BY. *[Signature]* AMIN    MEASURED BY. *[Signature]* J.E.    A.E.    E.E. *[Signature]*    TEH.(L.A.)    T.P. *[Signature]*    C.A.T.P.    SECY. *[Signature]*

46

# SITE PLAN OF PLOT FOR OLD AGE HOME AT KARPOORI PURAM

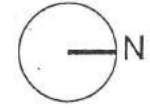

AREA OF PLOT = 2233.05 SQM

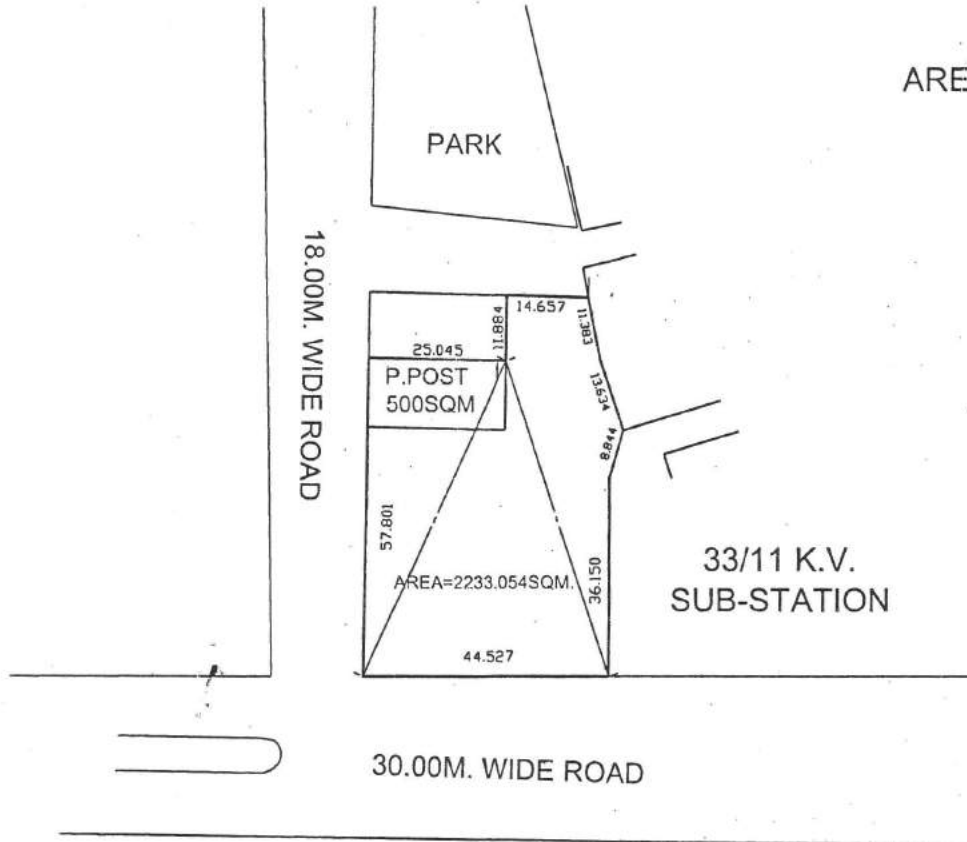

 PREPARED BY. AMIN  
 MEASURED BY. J.E.  
 J.E.  
 E.E.  
 T.P.  
 C.A.T.P.  
 SECY.  
 V.C.

REVISED SITE PLAN OF PLOT NOS. 248 TO 254 & P/N SCHOOL AT KAUSHAMBI GZB.

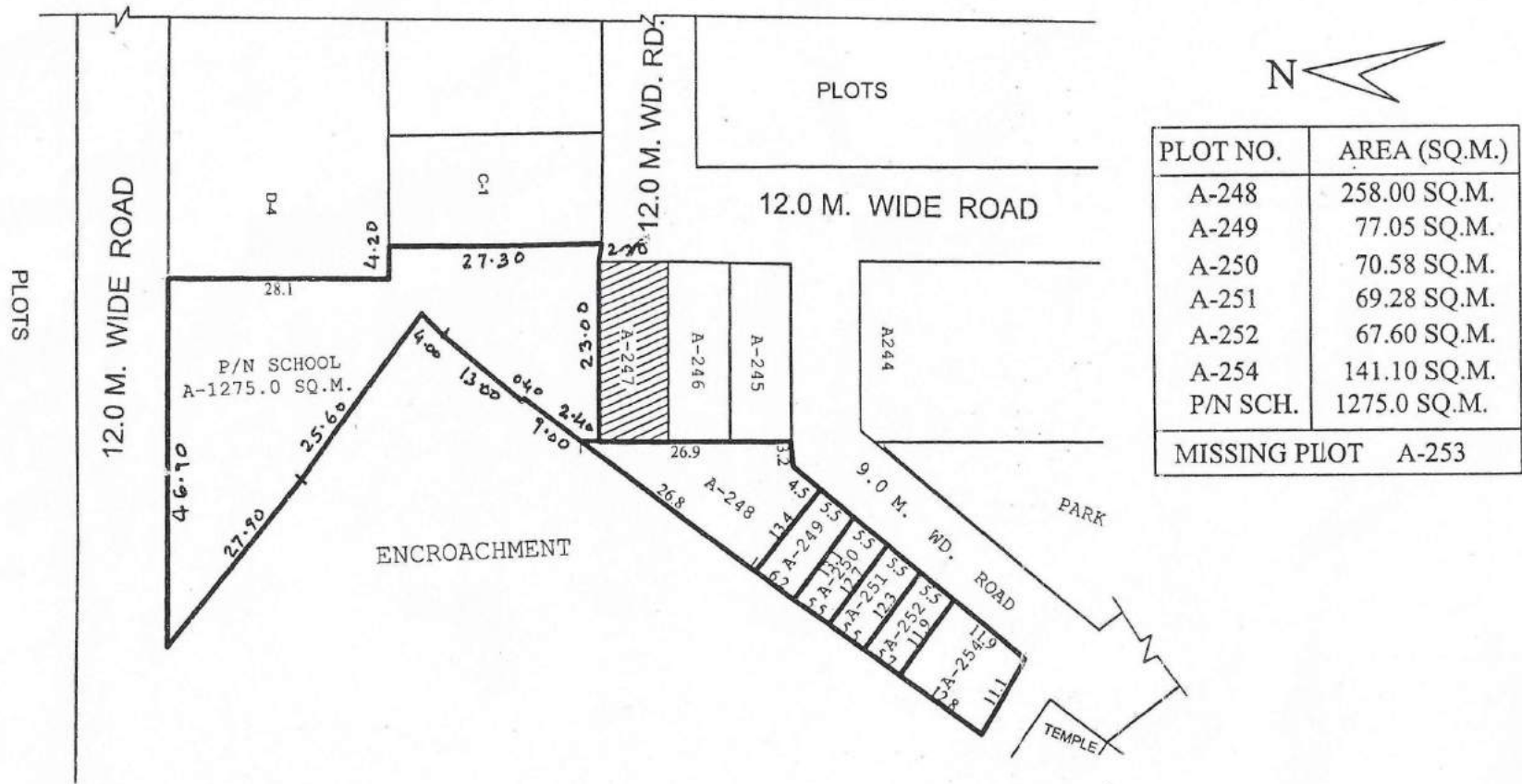

4-6-15  
 /Man AMIN J.E. A.E. E.E. TEH-LA T.P. C.A.T.P. SECRY. V.C.

# SITE PLAN OF GROUP HOUSING (GH) No. - 4, 5, 6, 8 & 9 AT KOYAL ENCLAVE SCHEME, LONI, GHAZIABAD

## AREA SCHEDULE

GROUP HOUSING (G.H.) No.-4	= 19316.24 Sqm.
GROUP HOUSING (G.H.) No.-5	= 12018.37 Sqm.
GROUP HOUSING (G.H.) No.-6	= 12088.82 Sqm.
GROUP HOUSING (G.H.) No.-8	= 6460.00 Sqm.
GROUP HOUSING (G.H.) No.-9	= 6820.40 Sqm.

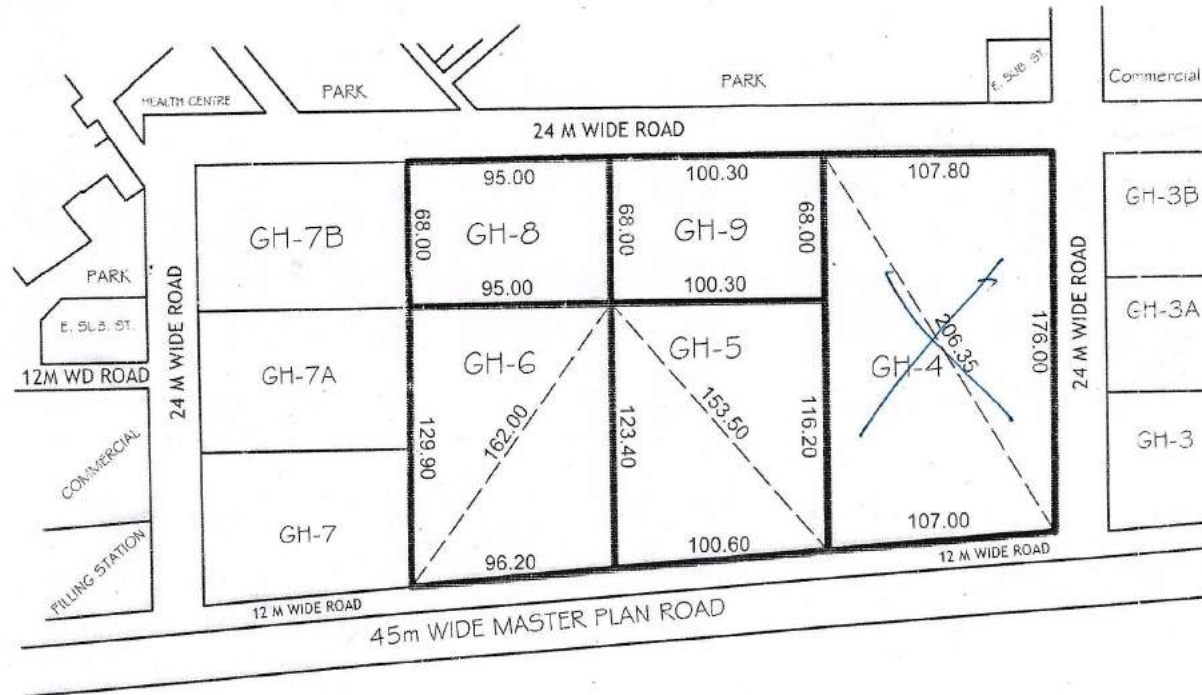
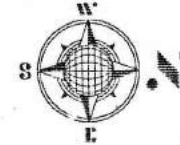

PRODUCED BY AN AUTODESK EDUCATIONAL PRODUCT

*[Signature]*  
23/05/15  
PREPARED BY

COMPARED BY

*[Signature]*  
26/5/15  
R.K. KAUSHIK  
AREA CAL. & MEASURED BY

*[Signature]*  
KAPTAN SINGH  
EXECUTIVE ENGINEER

*[Signature]*  
28/5/15  
R.K. JAISWAL  
EXECUTIVE ENGINEER

*[Signature]*  
28/5/15  
TOWN PLANNER

# SITE PLAN OF RESIDENTIAL PLOT No. - K-1, GROUP HOUSING (GH) No. - 1, 1A & 10, PRIMARY / NURSURY (P/N) No. - 1 & FILLING STATION AT KOYAL ENCLAVE SCHEME, LONI, GHAZIABAD

## AREA SCHEDULE

RESIDENTIAL PLOT No.K-1	= 1265.00 Sqm.
FILLING STATION	= 2500.00 Sqm.
GROUP HOUSING (G.H.) No.-1	= 8565.00 Sqm.
GROUP HOUSING (G.H.) No.-1A	= 6958.00 Sqm.
GROUP HOUSING (G.H.) No.-10	= 7140.00 Sqm.
PRIMARY / NURSURY (P/N) No.-1	= 3726.00 Sqm.

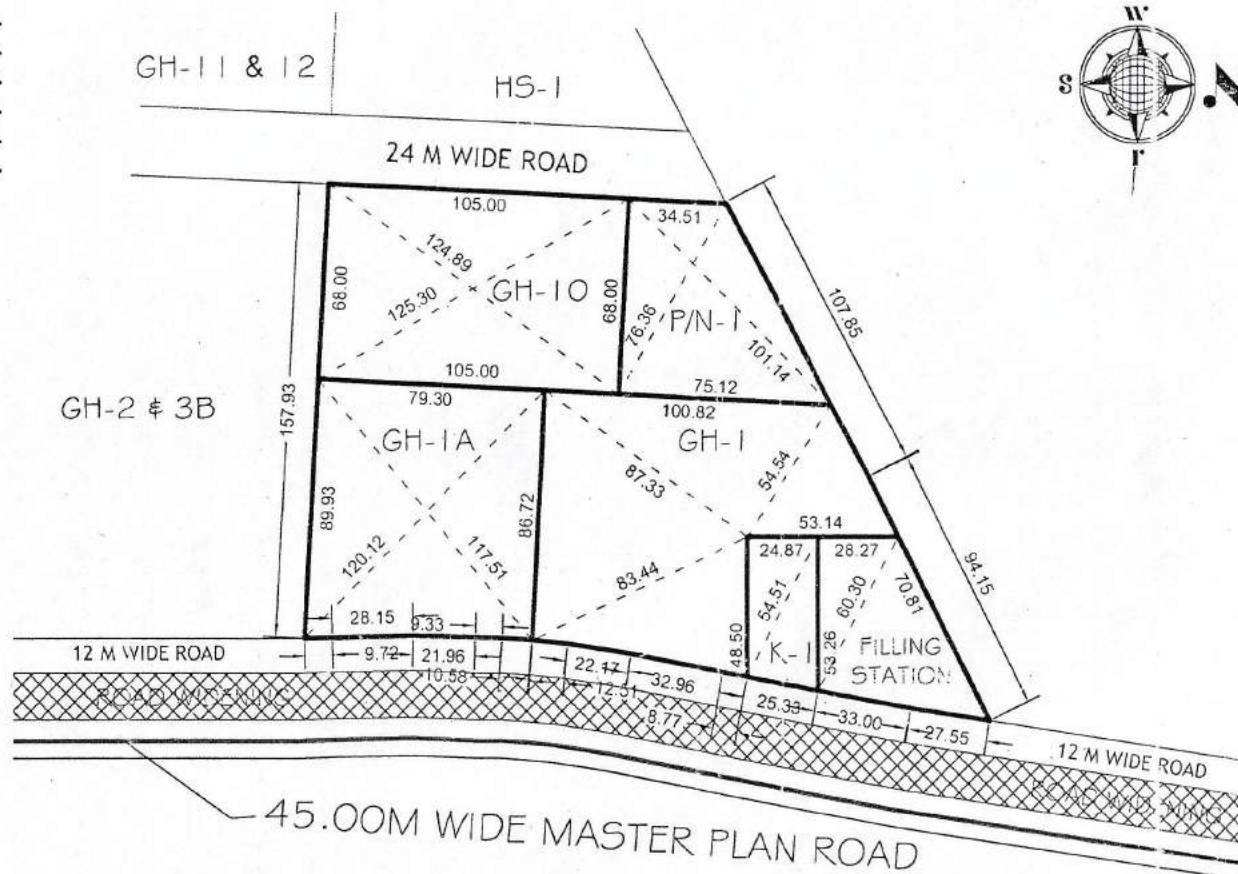

*[Signature]*  
6/10/16  
NITIN KUMAR  
D/Man

*[Signature]*  
6/10/16  
ANAND SWAMI  
AMIN

*[Signature]*  
R.K KAUSHIK  
JUNIOR ENGINEER

*[Signature]*  
NARENDRA KUMAR  
ASSISTANT ENGINEER

*[Signature]*  
R.K. JAISWAL  
EXECUTIVE ENGINEER

*[Signature]*  
RAJKUMAR MITTAL  
TEHSILDAR (L.A.)

*[Signature]*  
23/10/16  
JYOTI PRASAD  
TOWN PLANNER

*[Signature]*  
23/10/16  
ISTIYAD AHMED  
CA 79

*[Signature]*  
RAVINDRA GODSOLE  
SECRETARY

*[Signature]*  
VIJAY KUMAR GOYAL  
VICE CHAIRMAN

# SITE PLAN OF GROUP HOUSING (GH) No. - 3,3A & 3B AT KOYAL ENCLAVE SCHEME, LONI, GHAZIABAD

### AREA SCHEDULE

GROUP HOUSING (G.H.) No.-3	= 5994.08 Sqm.
GROUP HOUSING (G.H.) No.-3A	= 5268.84 Sqm.
GROUP HOUSING (G.H.) No.-3B	= 5766.84 Sqm.

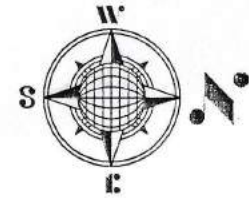
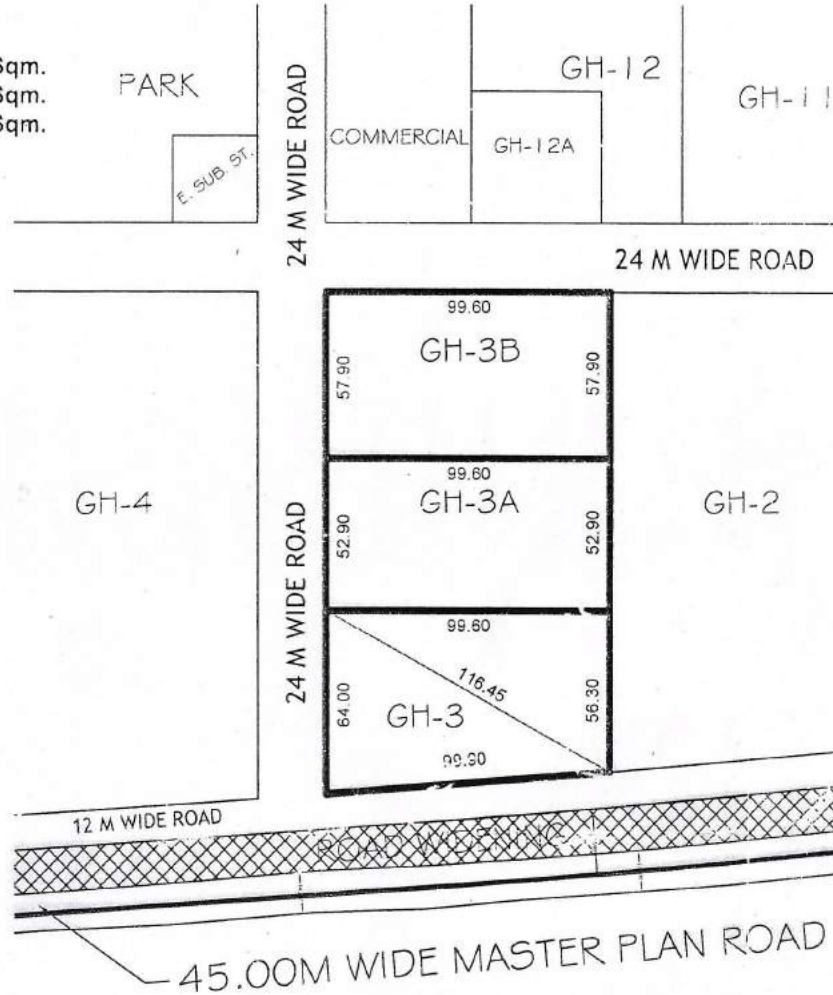

PRODUCED BY AN AUTODESK EDUCATIONAL PRODUCT

PRODUCED BY AN AUTODESK EDUCATIONAL PRODUCT

*[Signature]*  
24/2/15  
NITIN KUMAR  
D/MAN

*[Signature]*  
24/2/2015  
R.A. KAUSHIK  
JUNIOR ENGINEER

*[Signature]*  
KAPTAN SINGH  
EXECUTIVE ENGINEER

*[Signature]*  
24/2/15  
R.K. JAISWAL  
EXECUTIVE ENGINEER

*[Signature]*  
25/2/15  
JYOTI PRASAD  
TOWN PLANNER



# SITE PLAN OF COMMERCIAL PLOT, GROUP HOUSING (GH) No. - 11 & 12, 12A, PRIMARY / NURSURY (P/N) No. - 2, HIGHER SECONDRY (H.S.) -1, COMMUNITY AT KOYAL ENCLAVE SCHEME, LONI, GHAZIABAD

## AREA SCHEDULE

COMMERCIAL PLOT	= 6417.02 Sqm.
GROUP HOUSING (G.H.) No.-12A	= 2090.00 Sqm.
GROUP HOUSING (G.H.) No.-11 & 12	= 11915.26 Sqm.
COMMUNITY	= 4772.00 Sqm.
PRIMARY / NURSURY (P/N) No.-2	= 5011.00 Sqm.
HIGHER SECONDRY (H/S) No.-1	= 5547.00 Sqm.













D/Man  
 JUNIOR ENGINEER  
 ASSISTANT ENGINEER  
 EXECUTIVE ENGINEER  
 RAJESHVAR MITTAL  
 TEHSILDAR (L.A.)  
 23/6/16  
 TOWN PLANNER  
 15/10/16  
 SECRETARY  
 VICE CHAIRMAN

# REVISED SITE PLAN OF HS-2 AT KOYAL ENCLAVE SCHEME, LONI, GHAZIABAD

## AREA SCHEDULE

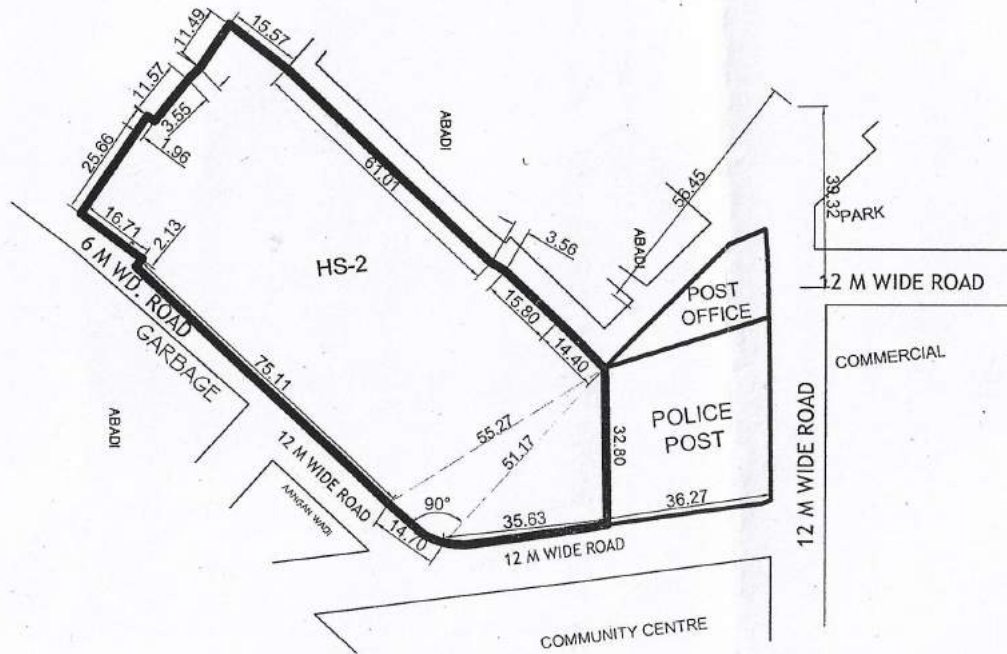
HIGHER SECONDRY-2 (H/S-2) = 6395.00 Sqmt.  
 GROUND COVERAGE = 30 %  
 PERMISSIBLE F.A.R. = 1.00



[Signature]      [Signature] 27/11/2020      [Signature] 27.11.20      [Signature]      [Signature]      [Signature]      [Signature]      [Signature]      [Signature]

IAN      JUN. ENGR.      ASTT. ENGR.      S. ENGR.      T. P. (R)      T. P. (K)      [Signature]      SECRETARY      VICE CHAIRMAN

# SITE PLAN OF RESIDENTIAL PLOT No. - K-1, GROUP HOUSING (GH) No. - 1, 1A & 10, PRIMARY / NURSURY (P/N) No. - 1 & FILLING STATION AT KOYAL ENCLAVE SCHEME, LONI, GHAZIABAD

## AREA SCHEDULE

RESIDENTIAL PLOT No.K-1	= 1265.00 Sqm.
FILLING STATION	= 2500.00 Sqm.
GROUP HOUSING (G.H.) No.-1	= 8565.00 Sqm.
GROUP HOUSING (G.H.) No.-1A	= 6958.00 Sqm.
GROUP HOUSING (G.H.) No.-10	= 7140.00 Sqm.
PRIMARY / NURSURY (P/N) No.-1	= 3726.00 Sqm.

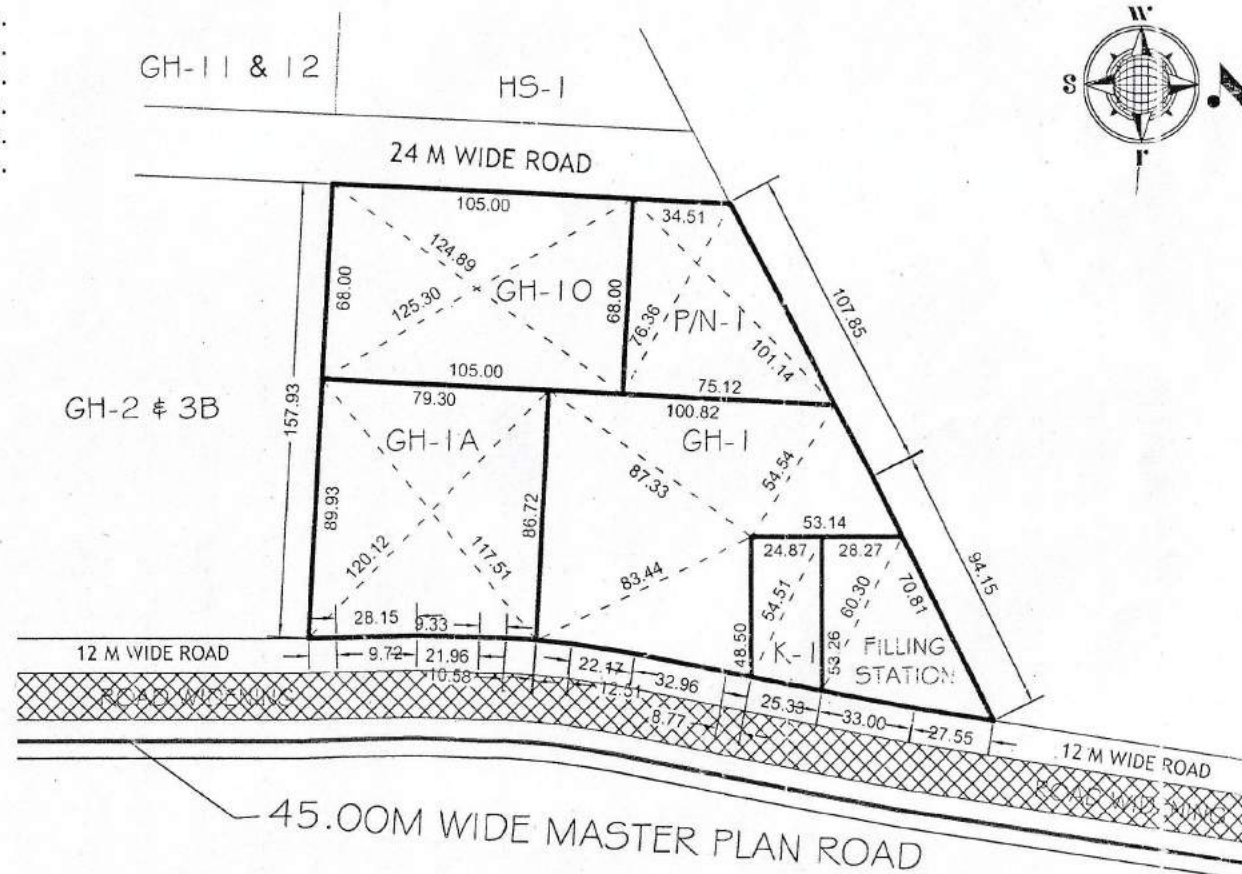

*[Signature]*  
6/10/16  
NITIN KUMAR  
D/Man

*[Signature]*  
6/10/16  
ANAND SWAMI  
AMIN

*[Signature]*  
R.K KAUSHIK  
JUNIOR ENGINEER

*[Signature]*  
NARENDRA KUMAR  
ASSISTANT ENGINEER

*[Signature]*  
R.K. JAISWAL  
EXECUTIVE ENGINEER

*[Signature]*  
RAJKUMAR MITTAL  
TEHSILDAR (L.A.)

*[Signature]*  
23/10/16  
JYOTI PRASAD  
TOWN PLANNER

*[Signature]*  
6/10/16  
ISTIYAD AHMED  
CA 79

*[Signature]*  
RAVINDRA GODSOLE  
SECRETARY

*[Signature]*  
VIJAY KUMAR GOYAL  
VICE CHAIRMAN

# **REVISED PART LAYOUT PLAN OF GROUP HOUSING PLOT OF GH-12B, GH-12C & GH-12D AT KOYAL ENCLAVE SCHEME, LONI, G.D.A. GHAZIABAD.**

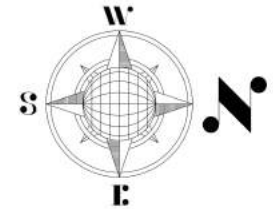
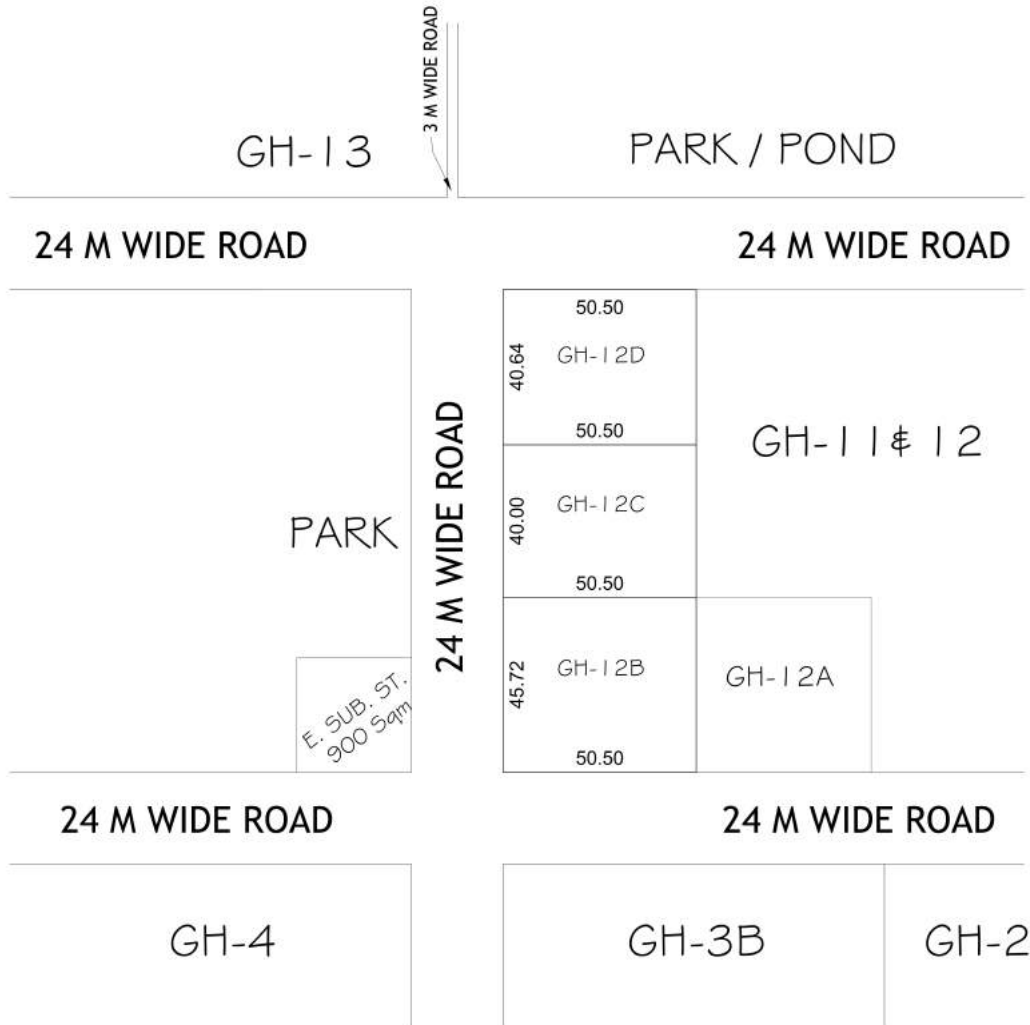

<b>AREA SCHEDULE</b>	
<b>PLOT No.</b>	<b>AREA (In Sqmt.)</b>
<b>GH-12B</b>	<b>2308.86</b>
<b>GH-12C</b>	<b>2020.00</b>
<b>GH-12D</b>	<b>2052.32</b>

GROUND COVERAGE	- 40%
F.A.R.	- 1.50



MASTER PLAN GREEN  
1471580 MT

B

POLICE CHALK

community centre

primary school

PARK

WATER WORKS  
A 1000 S.M.

6271 22053

Madhusom Babudham  
Primary School

19.00 METER WIDE ROAD

19.00 METER WIDE ROAD

8.00 METER WIDE ROAD

8.00 METER WIDE ROAD

13.00 METER WIDE ROAD

7.00 METER WIDE ROAD

7.00 METER WIDE ROAD

7.00 METER WIDE ROAD

8.00 METER WIDE ROAD

18.00 METER WIDE ROAD

18.00 METER WIDE ROAD

9.00M. WIDE ROAD

154 153

128 125

7.50 M. WIDE ROAD

83

110

7.50 M. WIDE ROAD

168 141

140 111

31

82

30

1

18

15

98

97

18.00 METER WIDE ROAD

12.00 METER WIDE ROAD

43.00 METER WIDE M.P. ROAD

RAILWAY LINE

SITE PLAN OF PRIMARY SCHOOL PLOT NO. D/P.S.-1 AT POCKET 'D' MADHUBAN BAPUDHAM YOJNA; GZ  
AF A OF PRI. SCHOOL D/P.S.-1= 1375.00 SQ.M.

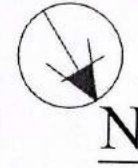
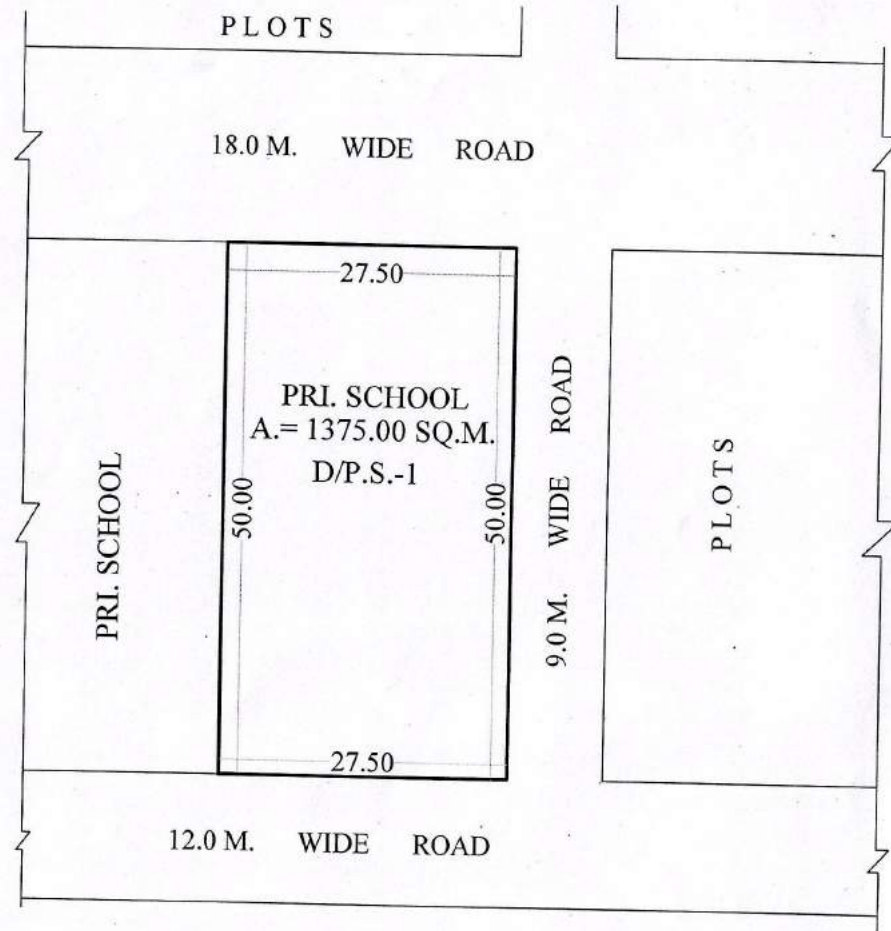

Sd. 06-01-21  
PREPARED BY

Sd. 06-01-21  
COMPARED BY

Sd. 13-01-21  
(MEAS. & AREA CAL.) J.E.

Sd. 13-01-21  
A.E.

Sd. 13-01-21  
E.E.

Sd. 22-01-21  
T.P.

REVISED SITE PLAN FOR HEALTHCARE HUB AND MUSICAL FOUNTAIN & MULTI MEDIWA SHOW AT POCKET-E MADHUBAN BAPUDHAM YOJNA; GZB.

HEALTH CARE HUB AREA - 30484.50 SQ.M.

MUSICAL FOUNTAIN AND MULTIMEDIA SHOW AREA - 3000.00 SQ.M.

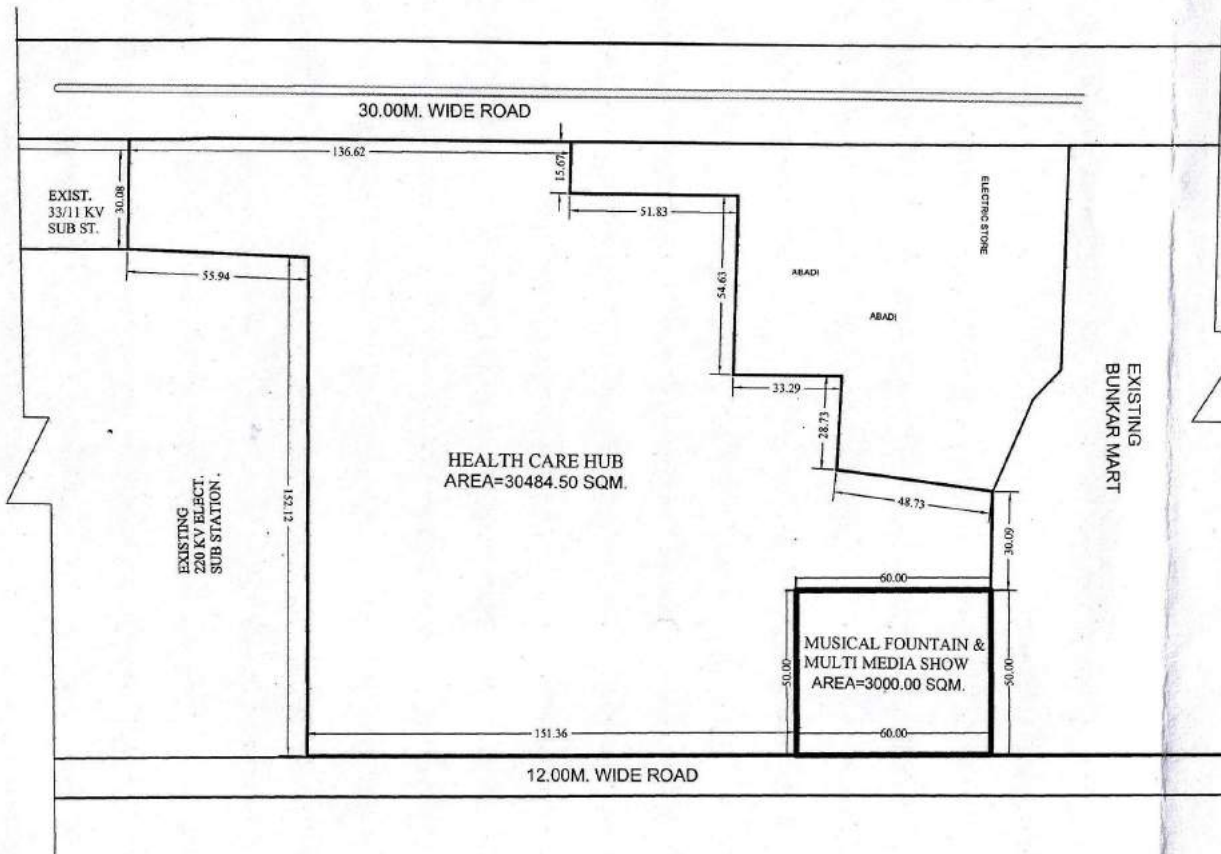

Sd. 16-11-19  
D/Man

Sd. 19-11-19  
AMIN

Sd. 19-11-19  
J.E.

Sd. 19-11-19  
A.E.

Sd. 19-11-19  
E.E.

Sd. 19-11-19  
TEH.(LA)

Sd. 27-11-19  
T.P.(R)

Sd. 28-11-19  
T.P.(K)

Sd. 28-11-19  
C.A.T.P.

Sd. 02-12-19  
SECRETARY

Sd. 02-12-19  
VICE CHAIRMAN

PROPOSED SITE PLAN FOR HIGH SCHOOL PLOT AT POCKET-E (PART) MADHUBAN BAPUDHAM YOJNA; GZB.

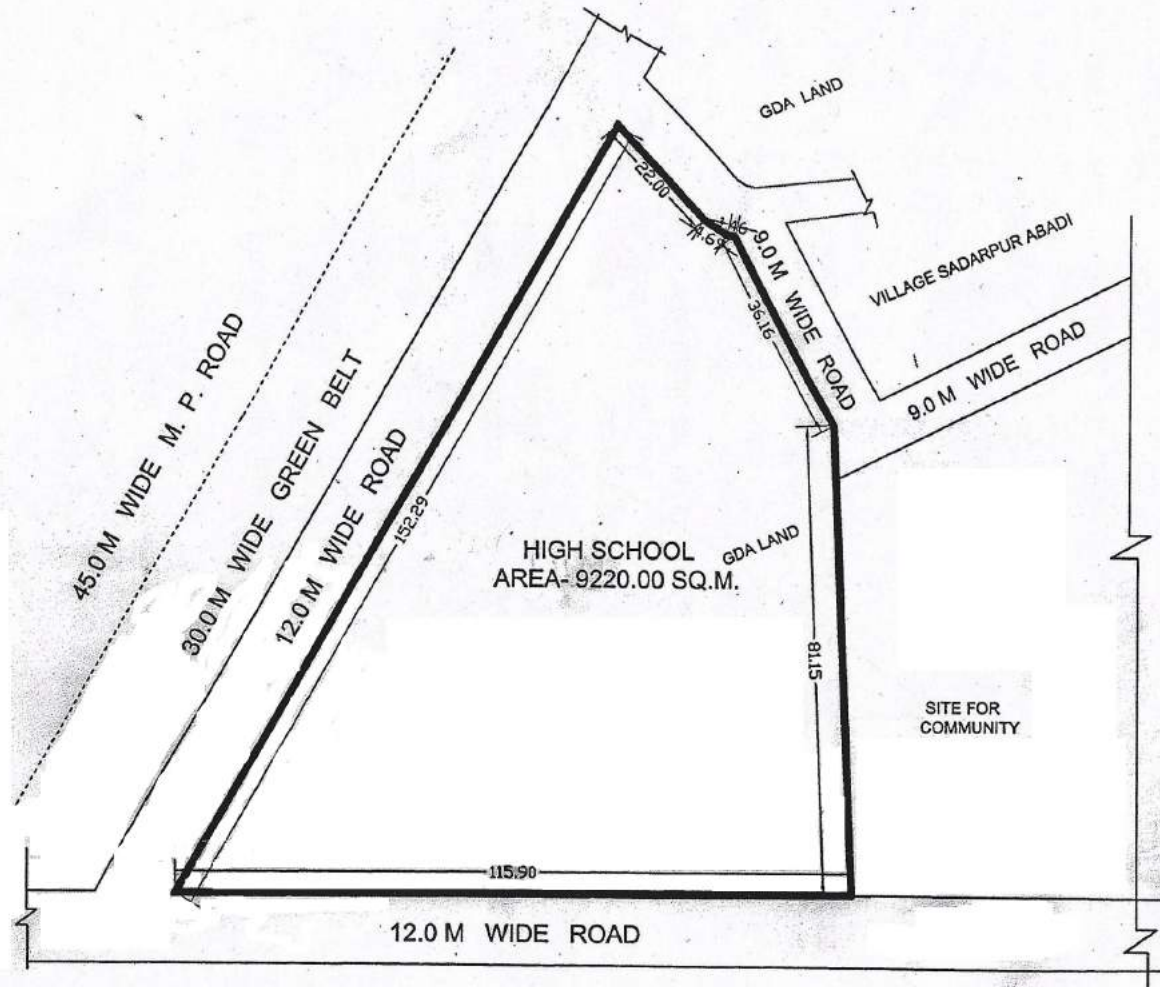

SWARNJYANTIPURAM YOJNA

Man AMIN J.E. A.E. E.E. OSD (LA) T.P. (R) T.P. (R) SECRETARY VICE CHAIRMAN

15/07/2016



PROPOSED SITE FOR NURSING HOSTEL PLOT NO. E/N.HS.-1 IN POCKET-E, AT MADHUBAN BAPUDHAM YOJNA,G.D.A. GZB.

AREA OF NURSING HOSTEL PLOT NO. E/N.H.-1 = 10408.597 SQ.M.

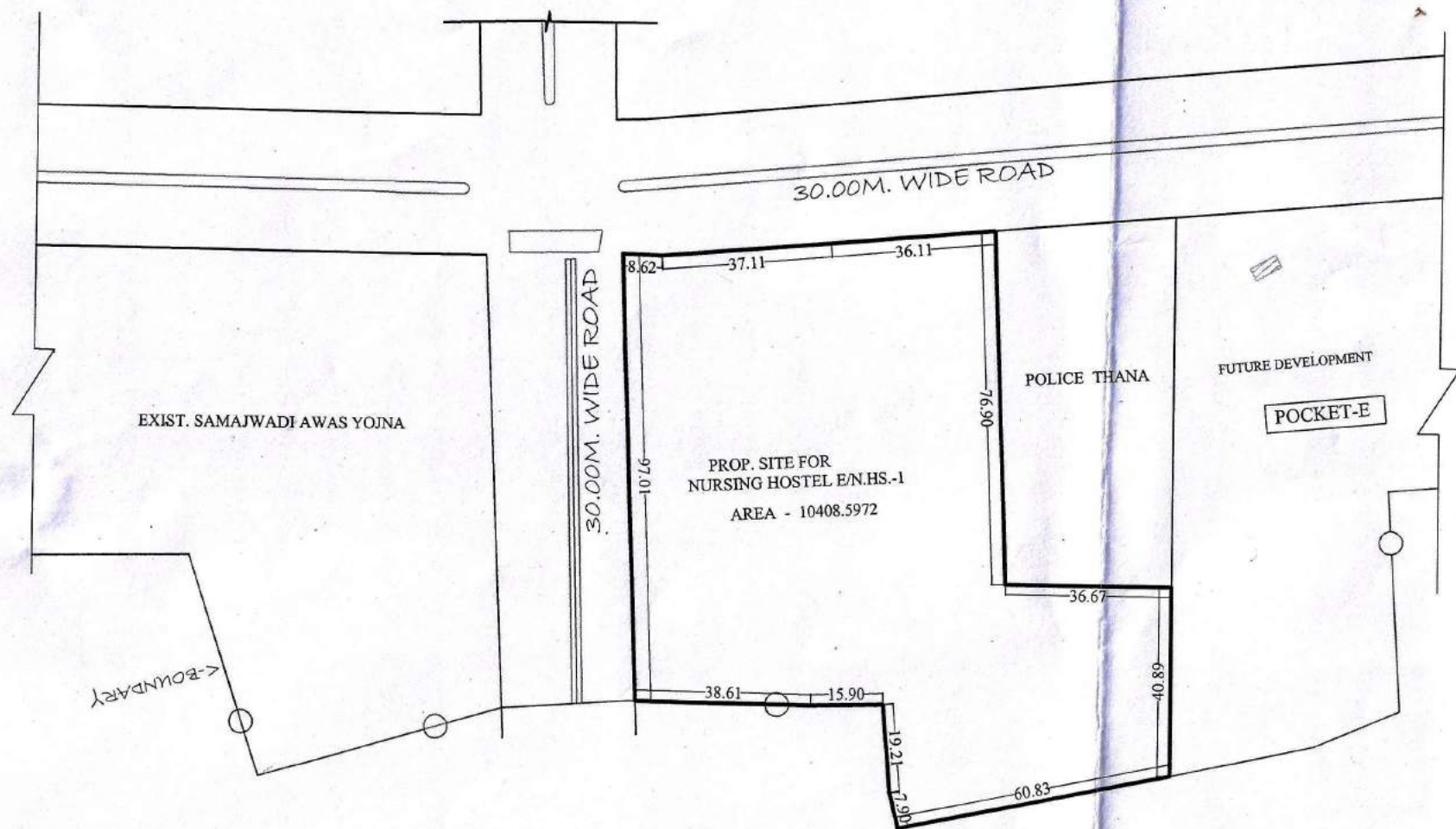





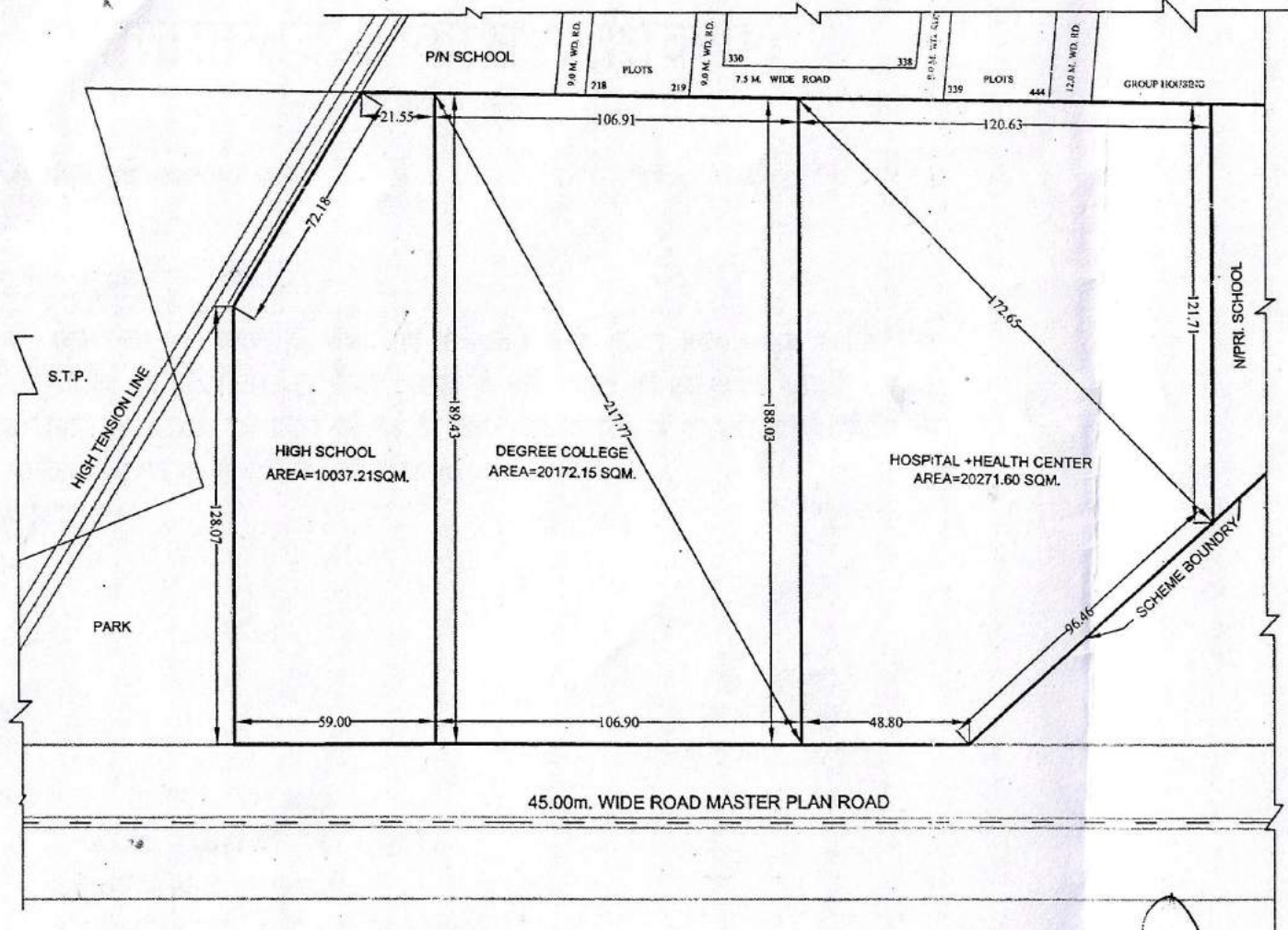

Sd 07-08-20 D/MAN	Sd 07-08-20 AMIN	Sd 07-08-20 J.E.	Sd 07-08-20 A.E.	Sd 07-08-20 O.S.D.-L.A.	Sd 10-08-20 E.E.	Sd 10-08-20 T.P.(R)	Sd 10-08-20 T.P.(K)	Sd 10-08-20 C.A.T.P.	Sd 10-08-20 SECERATRY	Sd 10-08-20 VICE CHAIRMAN
----------------------	---------------------	---------------------	---------------------	----------------------------	---------------------	------------------------	------------------------	-------------------------	--------------------------	------------------------------

LAN FOR HIGH SCHOOL , DEGREE COLLEGE & HOSPITAL+HEALTH CENTER PLOT AT POCKET- F MADHUBAN BAPUDHAM YOJNA;GDA, GZB

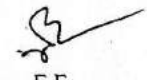
- HIGH SCHOOL PLOT = 10037.21 SQ.M.
- DEGREE COLLEGE PLOT = 20172.15 SQ.M.
- HOSPITAL+HEALTH CENTER PLOT = 20271.60 SQ.M.

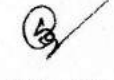

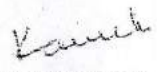
 AMIN    
  J.E.    
  A.E.    
  E.E.    
  OSD (LA)    
  T.P. (R)    
  T.P. (K)    
  C.A.T.P.    
  SECRETARY    
  VICE CHAIR

H.C. / C.C.

Match (8)

SITE PLAN OF HALL NO.-8B, BLOCK-B FIRST FLOOR, NAVYUG MARKET, GZB.

TOTAL AREA = 6.04 X 14.37 = 86.79 SQ.MT.

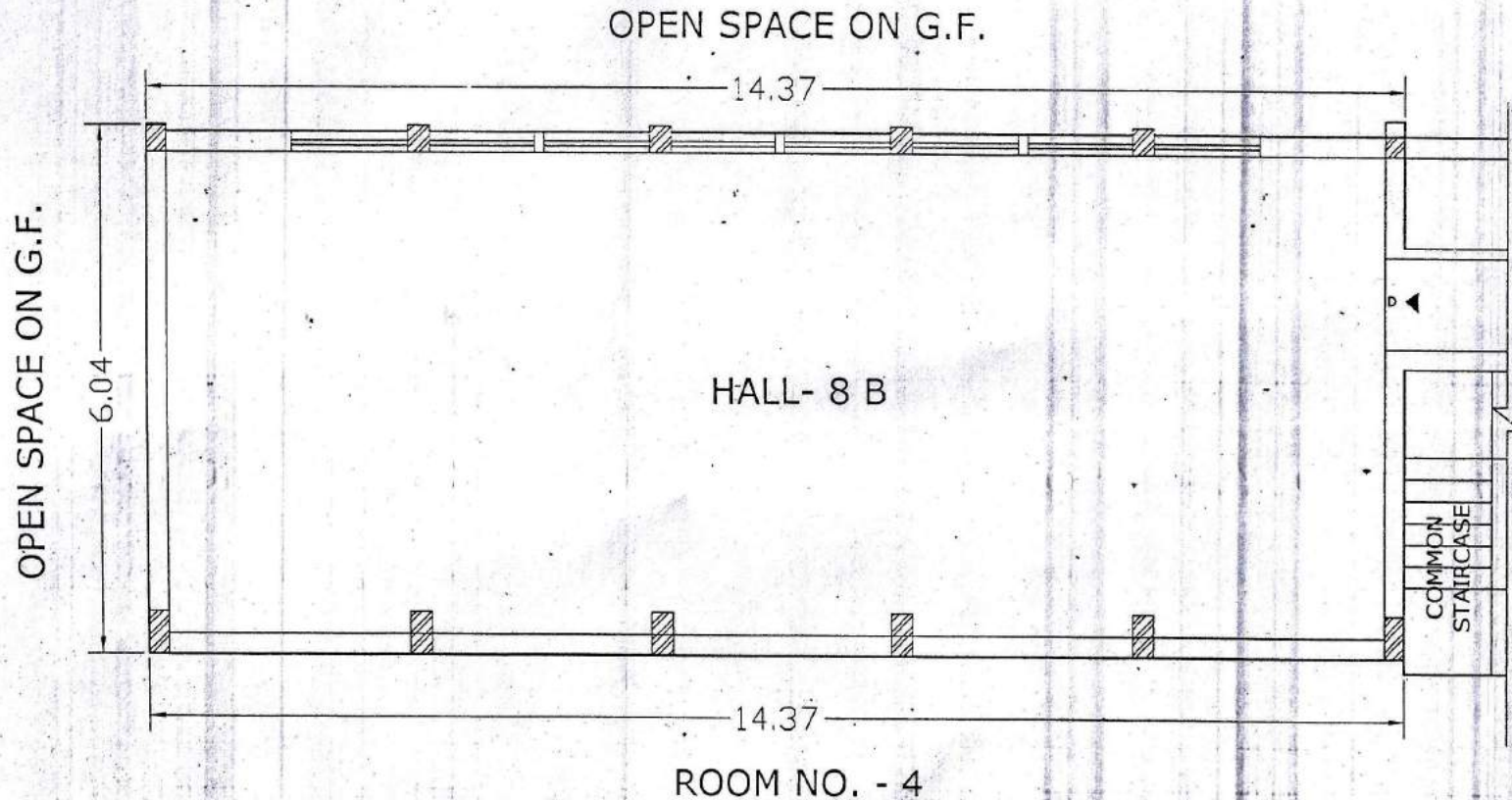

D/MAN 7/5/19  
A F  
A T D  
E F  
T D  
C A T D  
SECY  
Kankar





# PROPOSED PART LAYOUT PLAN AT SECTOR VI VAISHALI

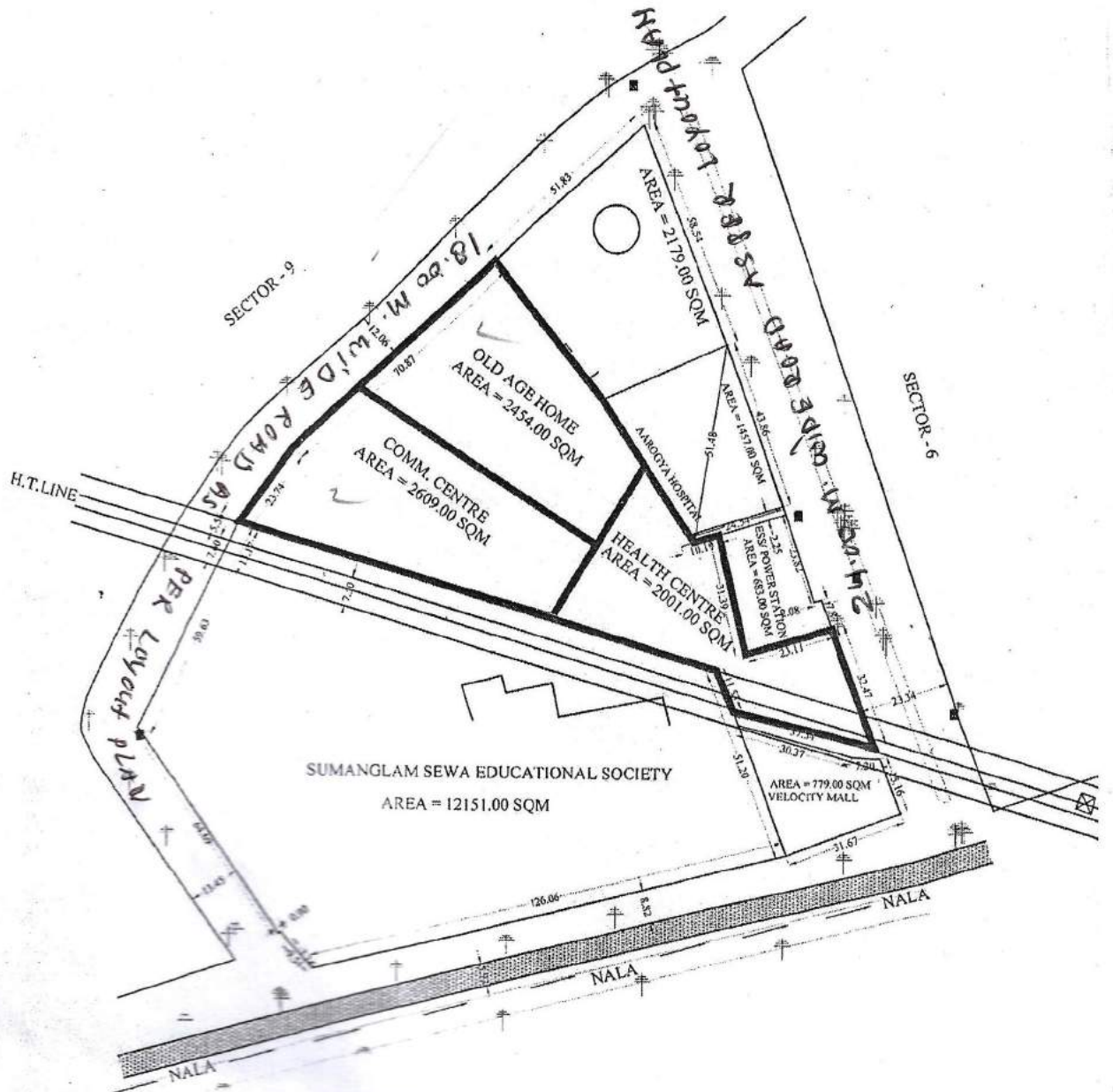

D/MAN

J.E.

AE

E.E.

T.P.

C.A.T.P.

S

# SITE PLAN OF BANK PLOT NO. B/BK-1 & B/BK-2 AT B-BLOCK SECTOR - XI GMP PRATAP VIHAR GZB..

AREA OF PLOT NO. B/BK-1 - 274.505 SQ.M.  
AREA OF PLOT NO. B/BK-2 - 274.505 SQ.M.



**USEAGE :**

BASEMENT - PARKING  
GROUND FL.- COMM/ ~~OFF~~  
FIRST FL. - BANK  
SECOND FL. - COMM. / OFF.

GR. COV. - 40%  
FA.R. - 1.20

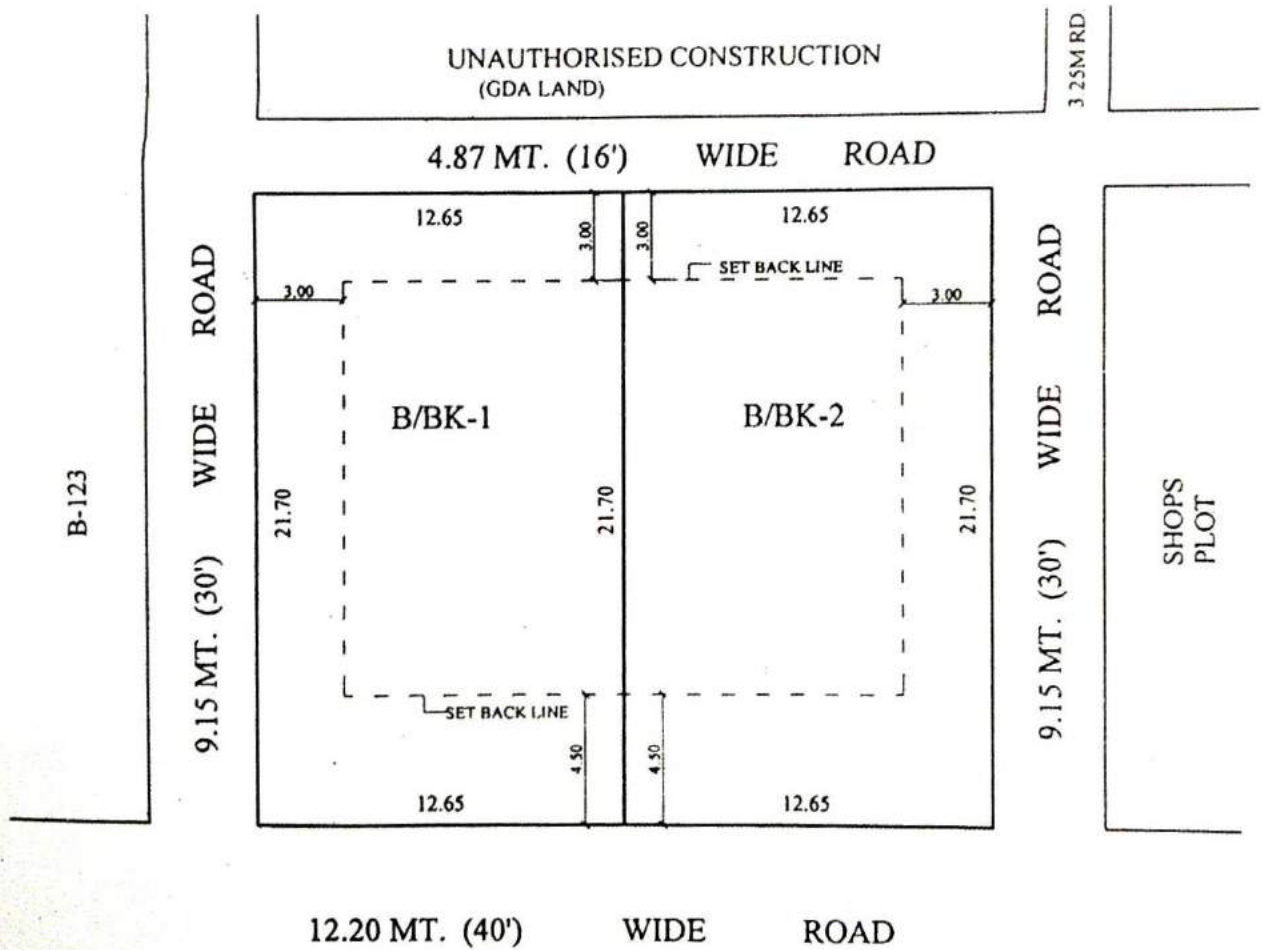

04/09/13  
MAN  
J.E. SA...  
A.E.

E/19762

A.E.

E.E.

T.P.

C.A.T.P.

SECY.

REVISED PART LAYOUT PLAN OF SCHOOL PLOT & COMMERCIAL AT P.M.A.Y. PRATAP VIHAR SECTOR XI, G. M. P. GHAZIABAD.

AREA OF PRIMARY SCHOOL PLOT - 1007.25 SQ.M.  
AREA OF COMMERCIAL PLOT - 1241.75 SQ.M.

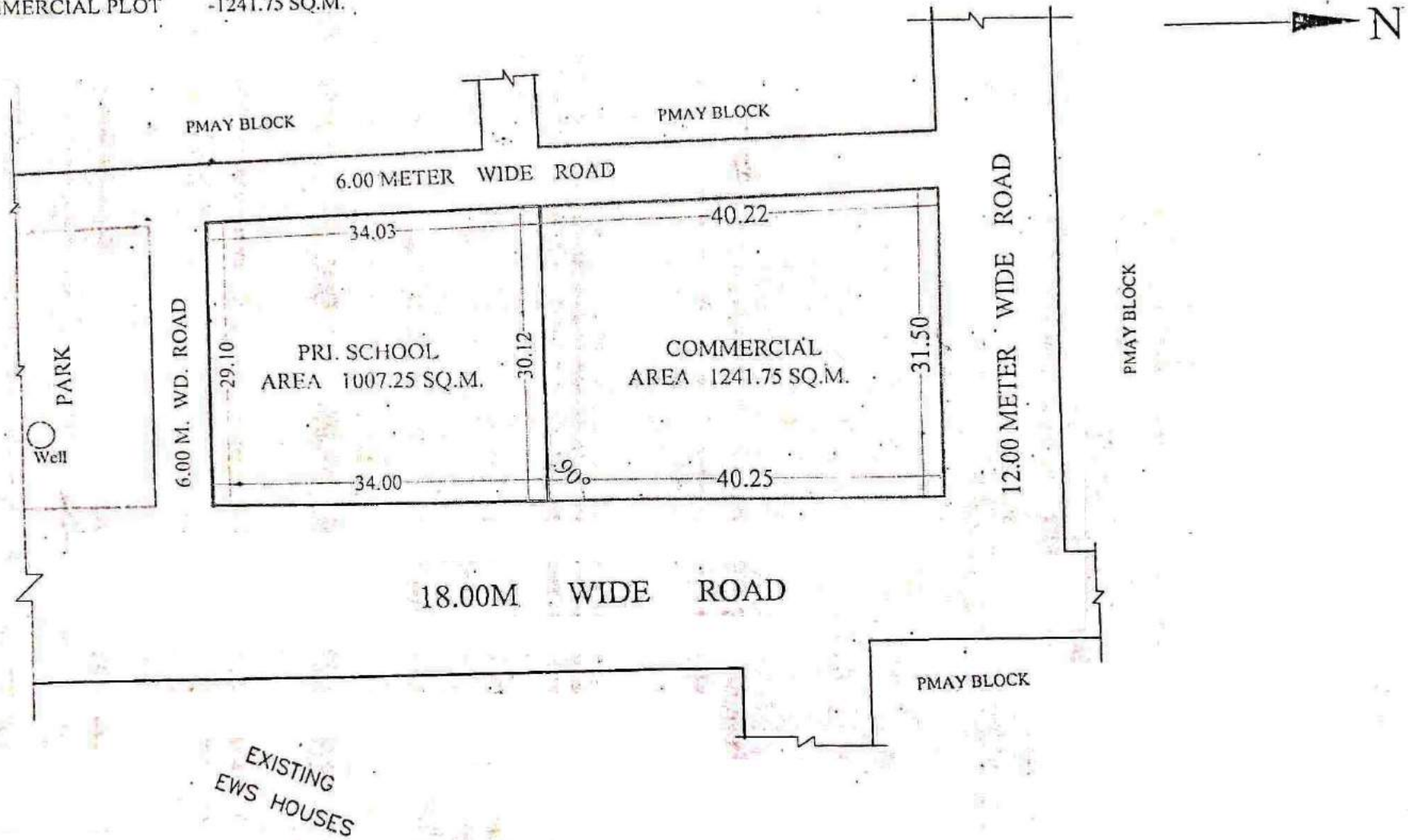

*[Handwritten signature]*

*[Handwritten signature]*  
27.12.21

*[Handwritten signature]*  
27.12.21

*[Handwritten signature]*  
FM

*[Handwritten signature]*  
TP

*[Handwritten signature]*

*[Handwritten signature]*  
SECRETARY

*[Handwritten signature]*  
VICE CHAIRMAN



प्लान - 410/मिमी: 31/5/2021

दिनांक 20/11/2021

### WISED PART LAYOUT PLAN OF G.H.-1 AT PRATAP VIHAR SECTOR XI, G. M. P. GHAZIABAD.

AREA OF PLOT NO. G.H.-1 = 2871.80 SQ.M.  
AREA OF PLOT NO. G.H.-1/1 = 6217.80 SQ.M.  
AREA OF COMMERCIAL PLOT NO.-2 = 639.40 SQ.M.

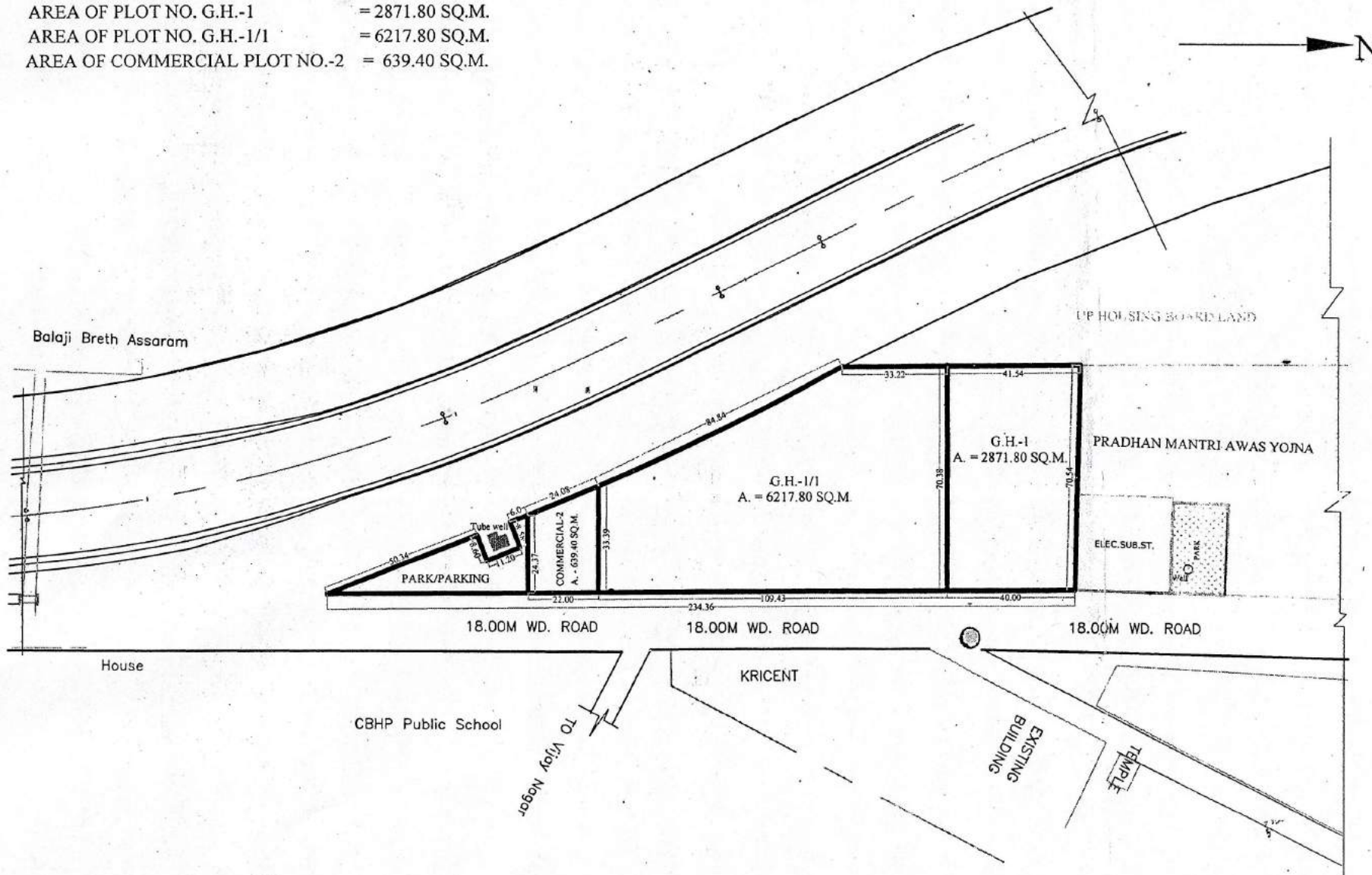

Handwritten signatures and initials at the bottom of the page, including 'P.M.S.', '12/11/21', 'Ab', 'M.L.', 'D', and 'TR'.

# SITE PLAN FOR KIOSK IN "D" BLOCK PATEL NAGAR, SECTOR - 7 G.M.P. GHAZIABAD

Scale - 1:500

AREA OF KIOSK LAND = 116.84 Sqm.



*[Handwritten Signature]*  
22.4.08

Prepared By.

*[Handwritten Signature]*  
22.4.08

Compared By.

*[Handwritten Signature]*  
22.4.08

Measured By.

*[Handwritten Signature]*  
22.4.08

Astt. Engineer

*[Handwritten Signature]*  
23/4/08

A.T.P.

*[Handwritten Signature]*  
Town Planner.

REV. PART LAYOUT PLAN OF COMMERCIAL PLOTS (VEHICLE FREE) AT NYAY KHAND-1 INDIRAPURAM GZB.

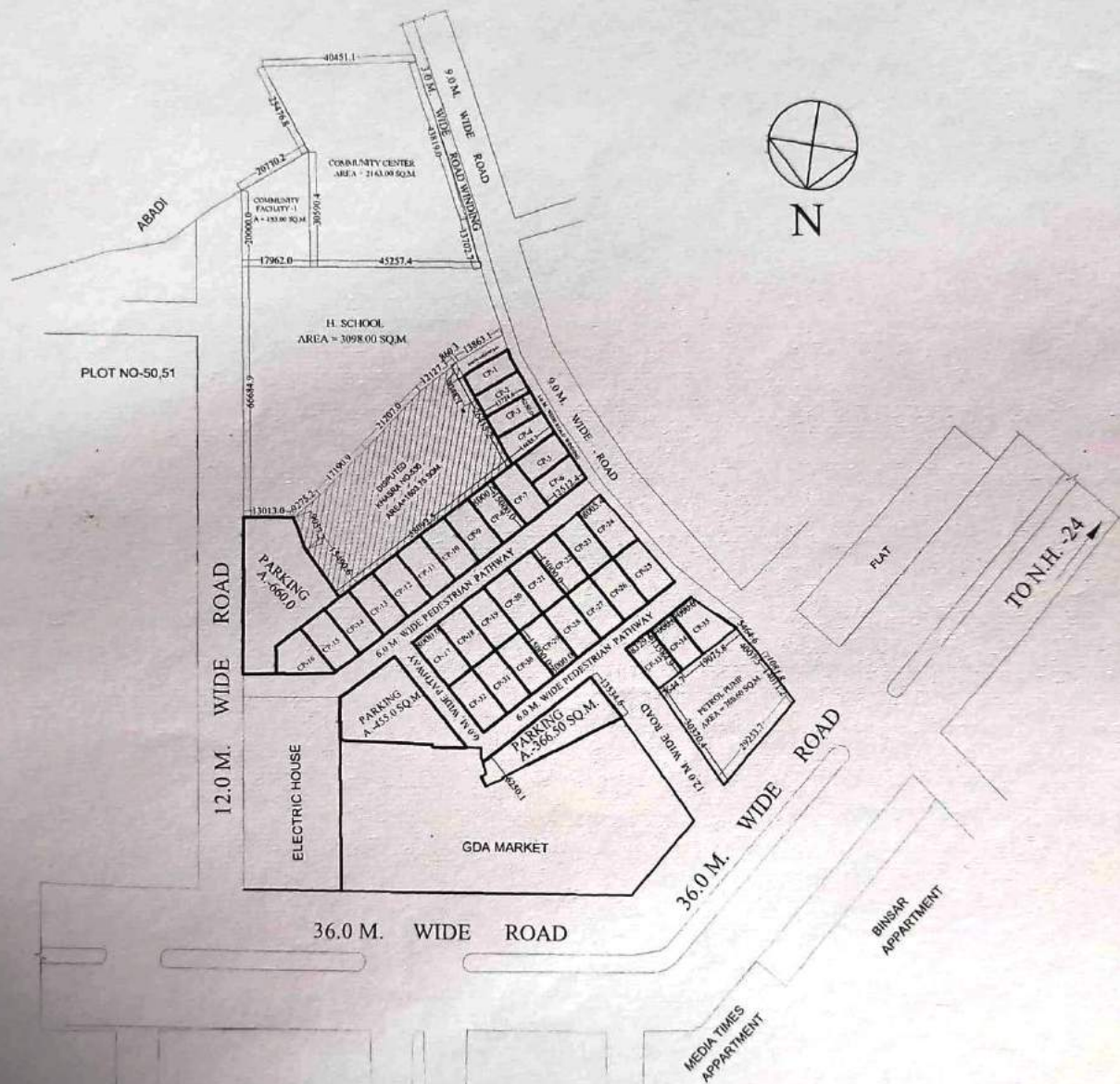

AREA-CHART

CP-1	= 87.02 Sqmt.
CP-2	= 88.07 Sqmt.
CP-3	= 88.71 Sqmt.
CP-4	= 101.05 Sqmt.
CP-5	= 94.87 Sqmt.
CP-6	= 99.13 Sqmt.
CP-7 to CP-15	= 120.00 Sqmt.
CP-16	= 116.24 Sqmt.
CP-17 to CP-32	= 120.00 Sqmt.
CP-33	= 113.10 Sqmt.
CP-34	= 95.06 Sqmt.
CP-35	= 125.30 Sqmt.
PARKING	= 1481.50 Sqmt.
PETROL PUMP	= 760.60 Sq.mt.

# LAYOUT PLAN OF PRATAP VIHAR SECTOR XI & XII G.M.P. GHAZIABAD.

SECTOR IX

150' MASTER PLAN ROAD

SCHOOL PLOT  
AREA - 2411.78.00 SQ.M.

G.H.-1  
AREA - 10568.00 SQ.M.

PROPOSED MASTER PLAN ROAD 250'-0" WIDE

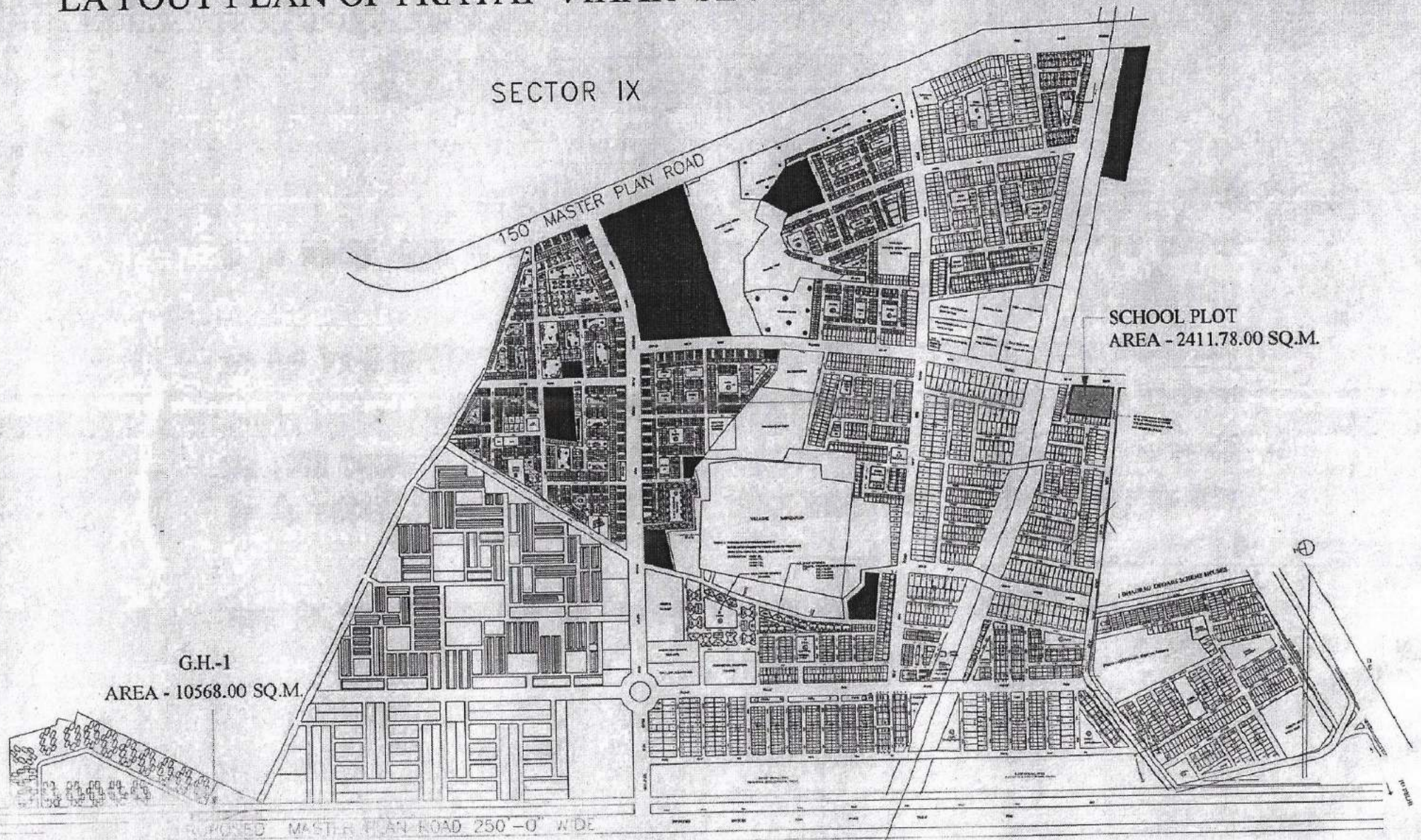

# REVISED SITE PLAN OF CONVENIENT SHOP PLOTS SK-IV/C.S.-1 TO C.S.-5 & VENDING ZONE AT SHAKTI KHAND - IV INDIRAPURAM GHAZIABAD.

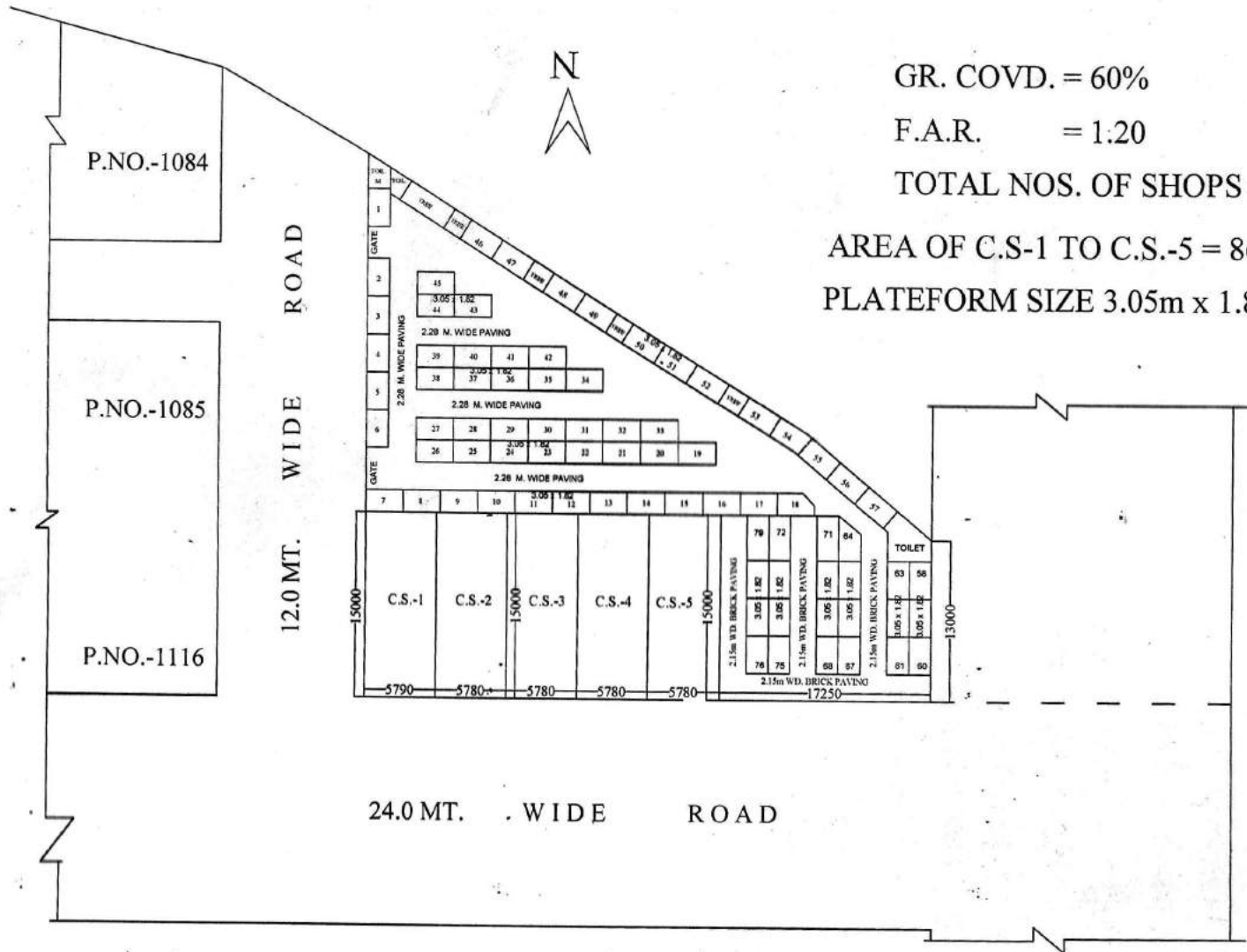

GR. COVD. = 60%

F.A.R. = 1:20

TOTAL NOS. OF SHOPS = 05

AREA OF C.S.-1 TO C.S.-5 = 86.70 SQ.M.

PLATFORM SIZE 3.05m x 1.82m

D.MAN

J.E.

A.E.

A.T.P.

E.E.

T.P.

C.A.T.P.

SECRY

V.C.

SITE PLAN FOR COMMERCIAL (MIXED LANDUSE) PLOT AT CS-5  
SWARNJAYANTIPURAM SCHEME .

AREA OF THE LAND = 5014.46 SQM

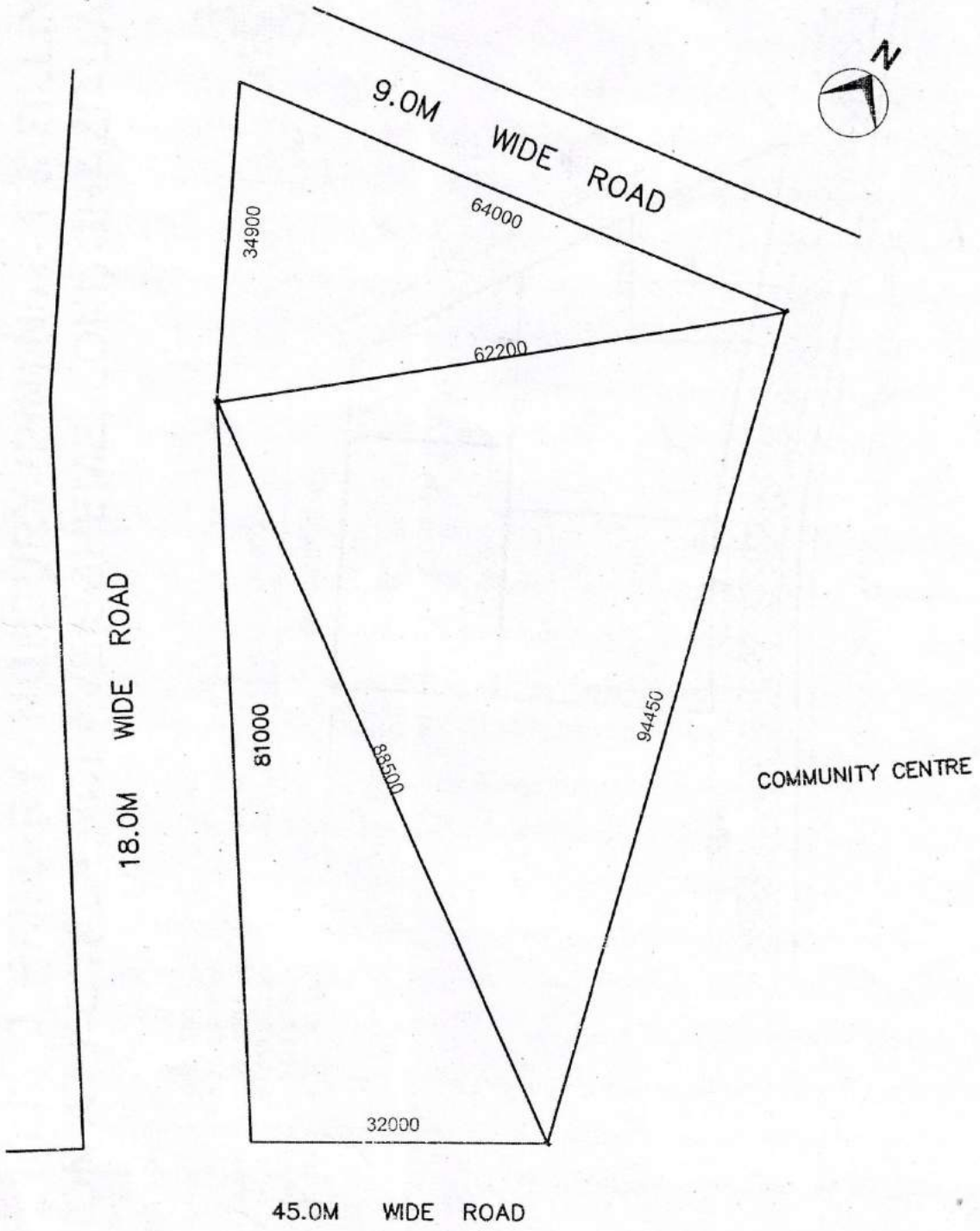

*[Signature]*  
D/MAN

*[Signature]*  
J.E. 18/10/13  
A.E. 19/11/13

*[Signature]*  
E.E. 18/10/13  
T.P. 23/10/13  
C.A.T.P. 18/10/13

*[Signature]*  
SECY.

*[Signature]*  
V.C.

18/10/13  
D/MAN

PART LAYOUT PLAN OF TULSI NIKETAN RESIDENTIAL SCHEME THA  
 GHAZIABAD.

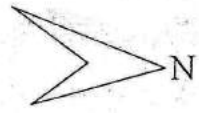
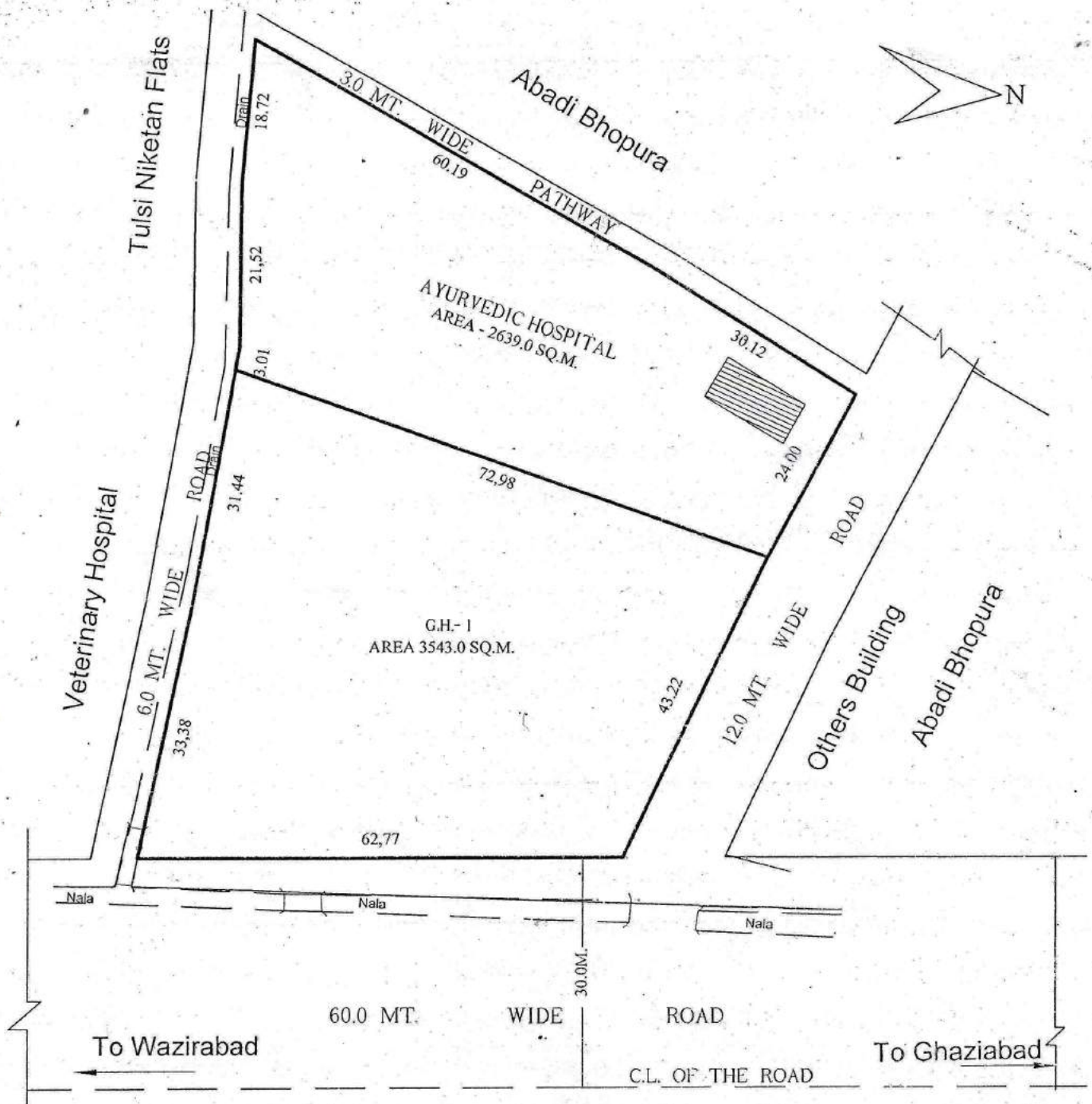

*[Signature]*  
 30/5/15  
 D/MAN

*[Signature]*  
 AMIN

*[Signature]*  
 J.E.

*[Signature]*  
 A.E.

*[Signature]*  
 E.E.

*[Signature]*  
 TEH-LA.

*[Signature]*  
 T.P.

*[Signature]*  
 30/5/15  
 E.A.T.P.

*[Signature]*  
 30/5/15  
 SECY.

*[Signature]*  
 V.C.

AT TULSI NIKETAN SCHEME THA IN GHAZIABAD

SCALE : 1 CM = 5 Mts.

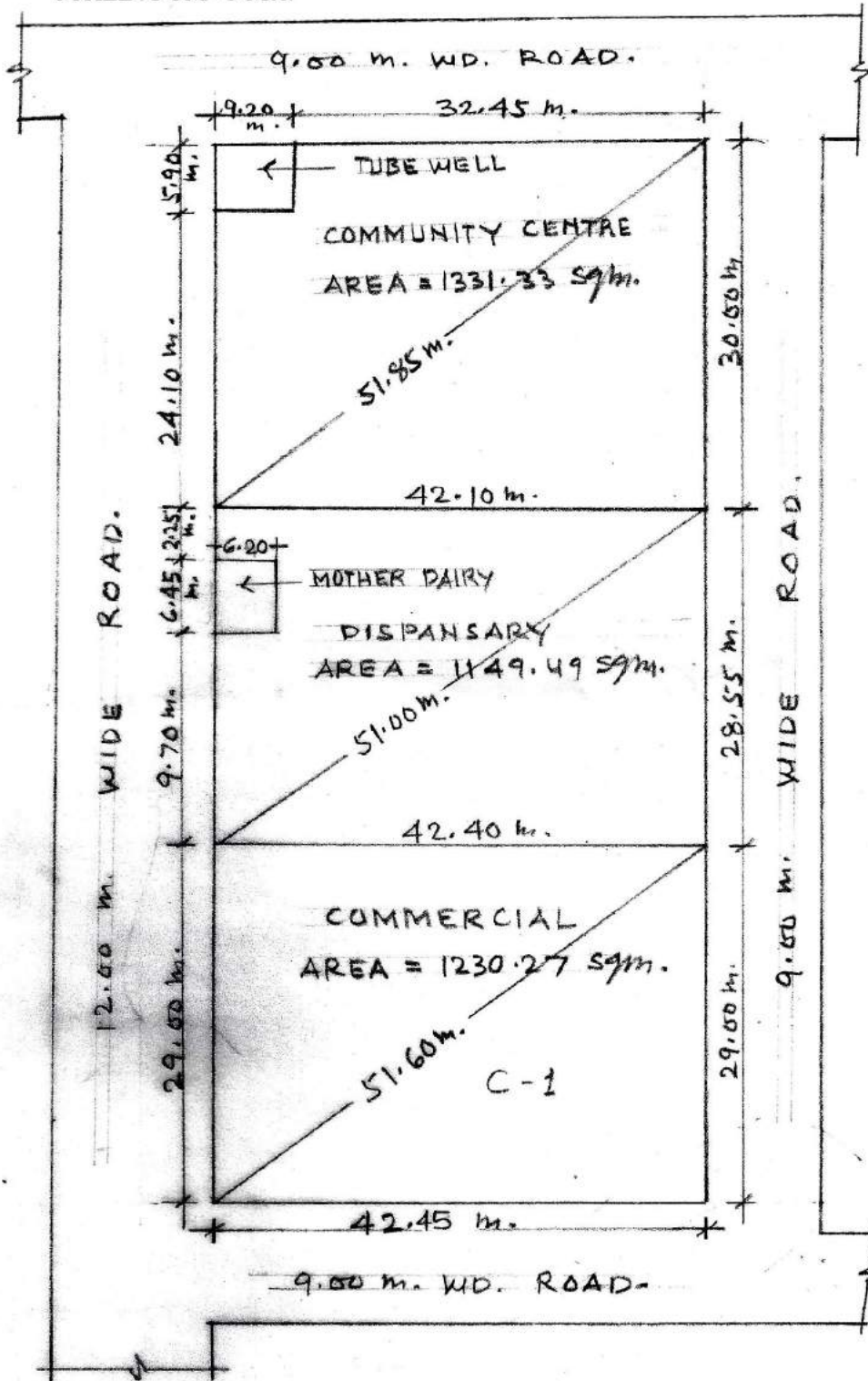

*Ahmed*  
10/01/07

*Salim*  
11/01/07

*Amr*  
22/01/07

*Raw*  
22/01/07

*X/19200*  
21/01/07

PREPARED BY COMPARED BY MEASURED BY ASST ENGR. TOWN PLANNER



REVISED PART LAYOUT PLAN OF SCHEME NO.-10 DELHI - U.P. BORDER ON KIJASRA NO.-3, 4 & 10 AT  
CHIKAMBAR PUR ON G.T. ROAD GHAZIABAD

DETAIL OF SHOP PLOTS IN POCKET - A

S.NO	TYPE	SIZE	AREA	PLOT NO.	NOS.
1	I	2.5M X 5.5M	13.75 SQ.M. (148.00 SQ.FT.)	S-26 TO 49, S-60 TO 61 S-87A, 88 TO 124,	79
2	II	2.4M X 5.3M	12.72 SQ.M. (136.91 SQ.FT.)	S-18, 19, 20, 20A, B, C, D, E, 21	09
3	III	2.4M X 4.85M	11.64 SQ.M. (125.23 SQ.FT.)	S-9, TO 17	09
4	IV	2.4M X 4.5M	10.80 SQ.M. (116.25 SQ.FT.)	S-1 TO 7, 7A, 8, 22 TO -25	09
5	V	2.5M X 4.0M	10.00 SQ.M. (107.64 SQ.FT.)	S-50 TO S-59, S-68 TO 87	39
<b>TOTAL SHOPS PLOTS</b>					<b>127</b>
1	COMM.		324.90 SQ.M.	C-1	01
2	COMM.		142.00 SQ.M.	C-2	01
3	COMM.		258.87 SQ.M.	C-3	01

DETAIL OF SHOP PLOTS IN POCKET - B

S.NO.	TYPE	SIZE	AREA	PLOT NO.	NOS.
1	I		55.0 SQ.M. (592.02 SQ.FT. approx.)	S-93 TO 99	07
2	II	3.0M X 6.0M	18.00 SQ.M. (193.75 SQ.FT.)	S-80 TO 92	13
3	III	2.5M X 5.5M	13.75 SQ.M. (148.00 SQ.FT.)	S-50 TO 79	30
4	IV	2.25M X 4.5M	10.125 SQ.M. (108.98 SQ.FT.)	S-01 TO 49	49
	V	2.5M X 4.0M	10.00 SQ.M. (107.64 SQ.FT.)	S-100 TO 123	24
<b>TOTAL SHOPS PLOTS</b>					<b>123</b>
5	COMMERCIAL		132.69 SQ.M. (1428.27 SQ.FT.)	C-1	01
6	COMMERCIAL		135.96 SQ.M. (1463.47 SQ.FT.)	C-2	01

नोट- पार्ट ले-आउट प्लान में दर्शित अनाविकृत निर्माण (रोडेड पोरशन) से ग्रस्त भूमि पर प्रस्तावित नियोजन स्थल से नियमानुसार अनाविकृत निर्माण करने के उपरान्त ही प्रभावी होगा।

D/MAN

AMIN

J.E.

A.E.

E.E-ZONE-8.

TEHSILDAR-L.A.

T.P.

C.A.T.P.

SEC./V.C.

V.C.

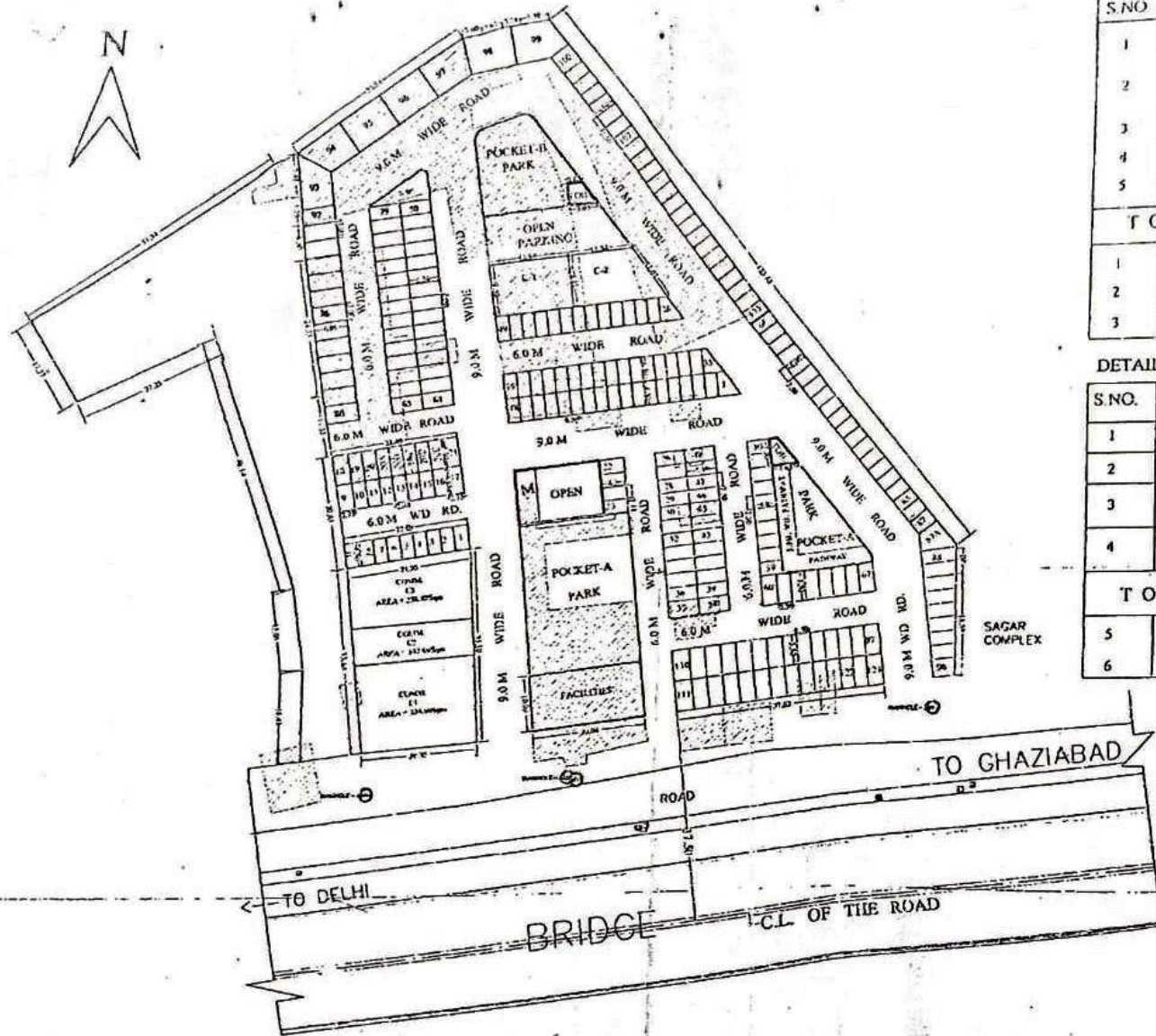

PROPOSED PART LAYOUT PLAN AT SECTOR III, BEHIND CHAAYA PUBLIC SCHOOL.VAISHALI  
 (POCKET - NP)

PLOTS SIZE = 16.50 X 8.50 M.  
 AREA = 140.25 SQ M.  
 NO. OF PLOTS = 18

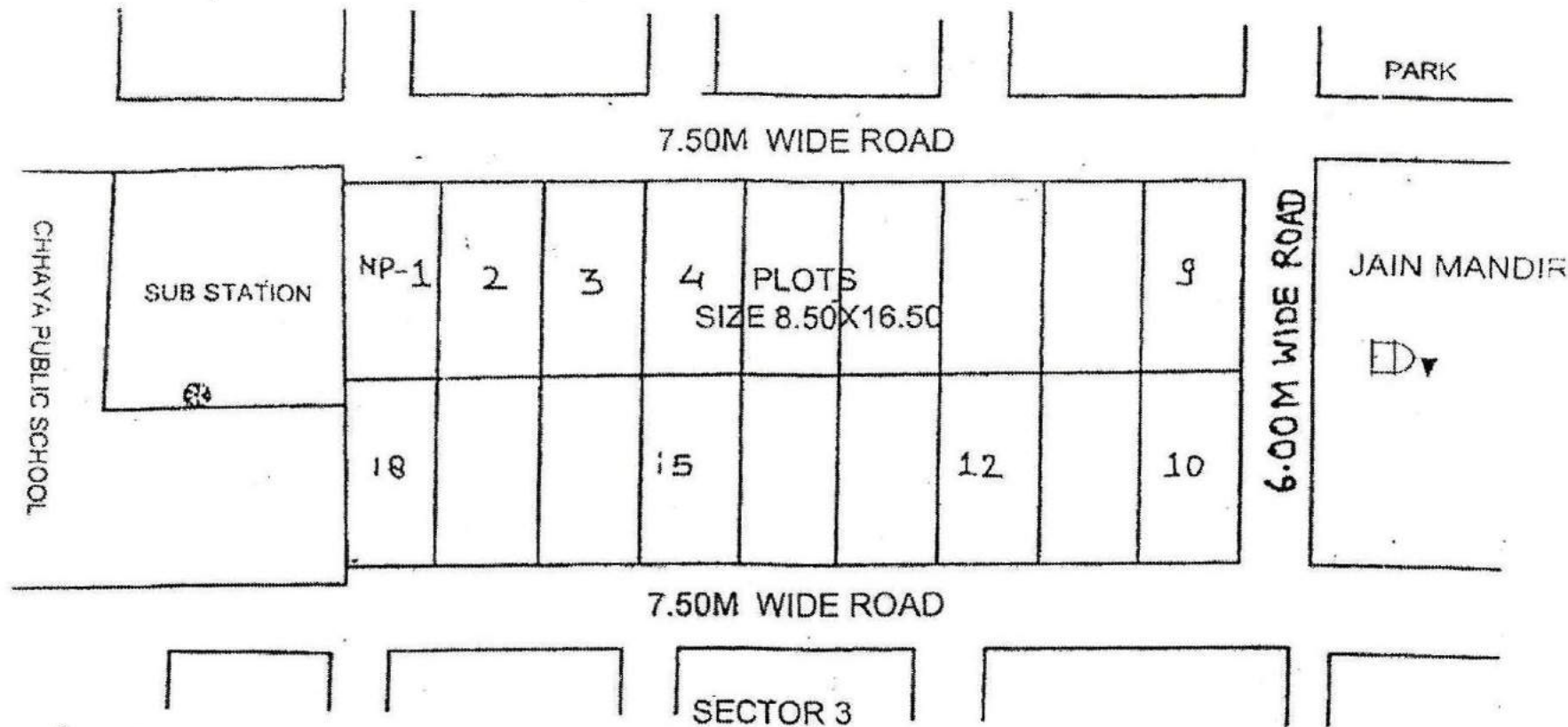

*[Signature]*  
 D/ MAN

*[Signature]*  
 TOWN PLANNER

*[Signature]*  
 CATP

*[Signature]*  
 SECY.

*[Signature]*

# SITE PLAN OF PRIMARY SCHOOL AT SECTOR II, VAISHALI GHAZIABAD

AREA = 2568.829 SQ M.

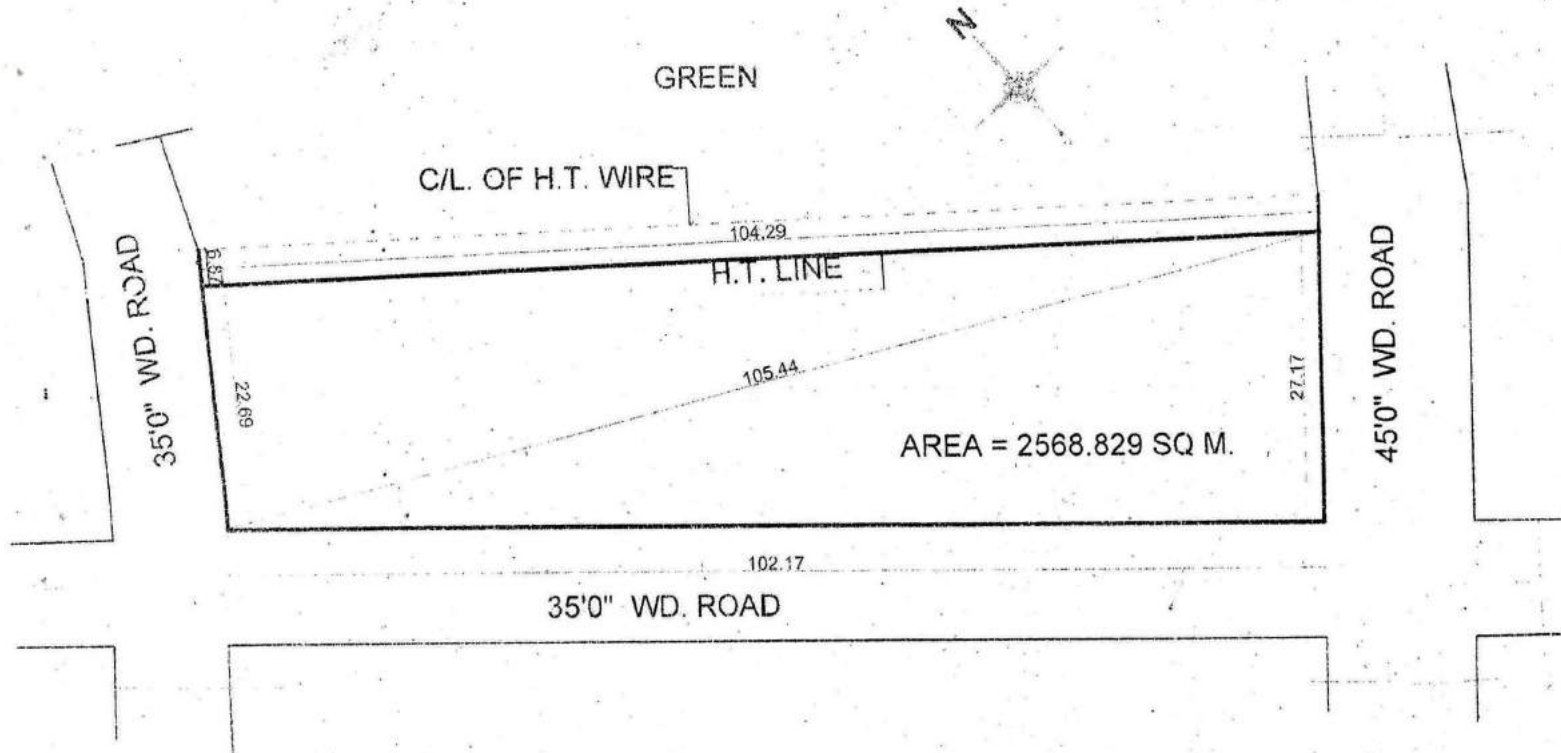

*[Signature]*  
30/11/13  
PREPARED BY

*[Signature]*  
04/12/13  
COMPARED BY

*[Signature]*  
28/11/13  
MEASURED BY  
J.E

*[Signature]*  
ASTT. ENGR

*[Signature]*  
04/12/13  
T.P

**SITE PLAN OF HIGH SCHOOL PLOT CONVERT IN TO G.H / RESI.PLOT/POST OFFICE AT SECTER -3  
VAISHALI GHAZIABAD**

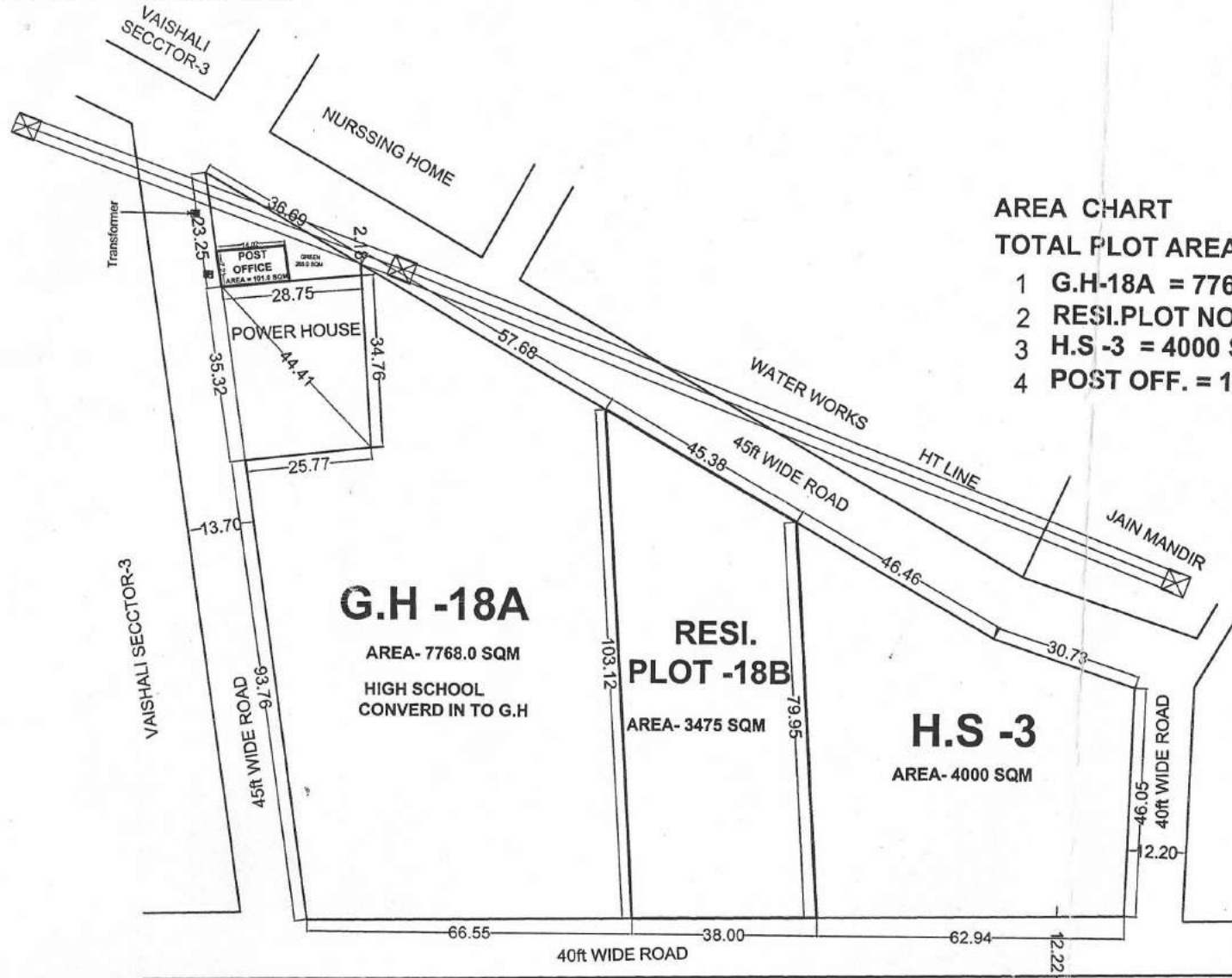

**AREA CHART**

**TOTAL PLOT AREA-15241 SQM**

- 1 G.H-18A = 7768.0 SQM
- 2 RESI.PLOT NO-18B = 3475 SQM
- 3 H.S -3 = 4000 SQM
- 4 POST OFF. = 101.0 SQM

**G.H -18A**

AREA- 7768.0 SQM  
HIGH SCHOOL  
CONVERD IN TO G.H

**RESI.  
PLOT -18B**

AREA- 3475 SQM

**H.S -3**

AREA- 4000 SQM

*[Signature]*  
21/10/16  
D/M.

*[Signature]*  
T.P.

*[Signature]*  
C.A.T.P

*[Signature]*  
21/10/16  
SECY.

*[Signature]*  
V.C

# REVISED SITE PLAN FOR COMMUNITY CENTER & NURSING HOME AT SECTER-3 VAISHALI, GHAZIABAD

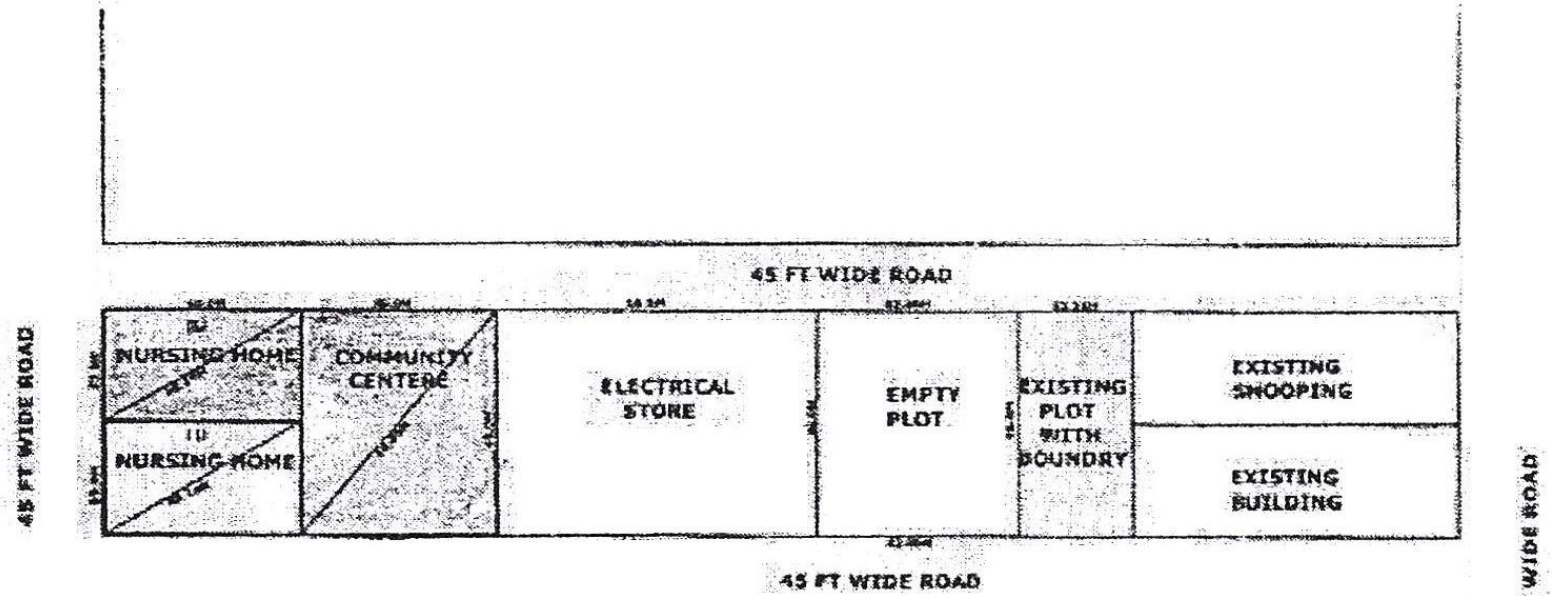

NURSING HOME NO- 1	AREA	40.0M X 23.0M	=	920 S.Q.M
NURSING HOME NO- 2	AREA	40.0M X 23.0M	=	920 S.Q.M
COMMUNITY CENTER	AREA	40.00M X 46.0M	=	1840 S.Q.M



*[Signature]*  
D/M

*[Signature]*  
AMIN

*[Signature]*  
J.E

*[Signature]*  
A.E

E.E-6

*[Signature]*  
TEH. (LA)

*[Signature]*  
T.D

*[Signature]*  
C.A.T.P

*[Signature]*  
SECRETARY

*[Signature]*

# PROPOSED PART LAYOUT PLAN AT SECTOR VI VAISHALI :

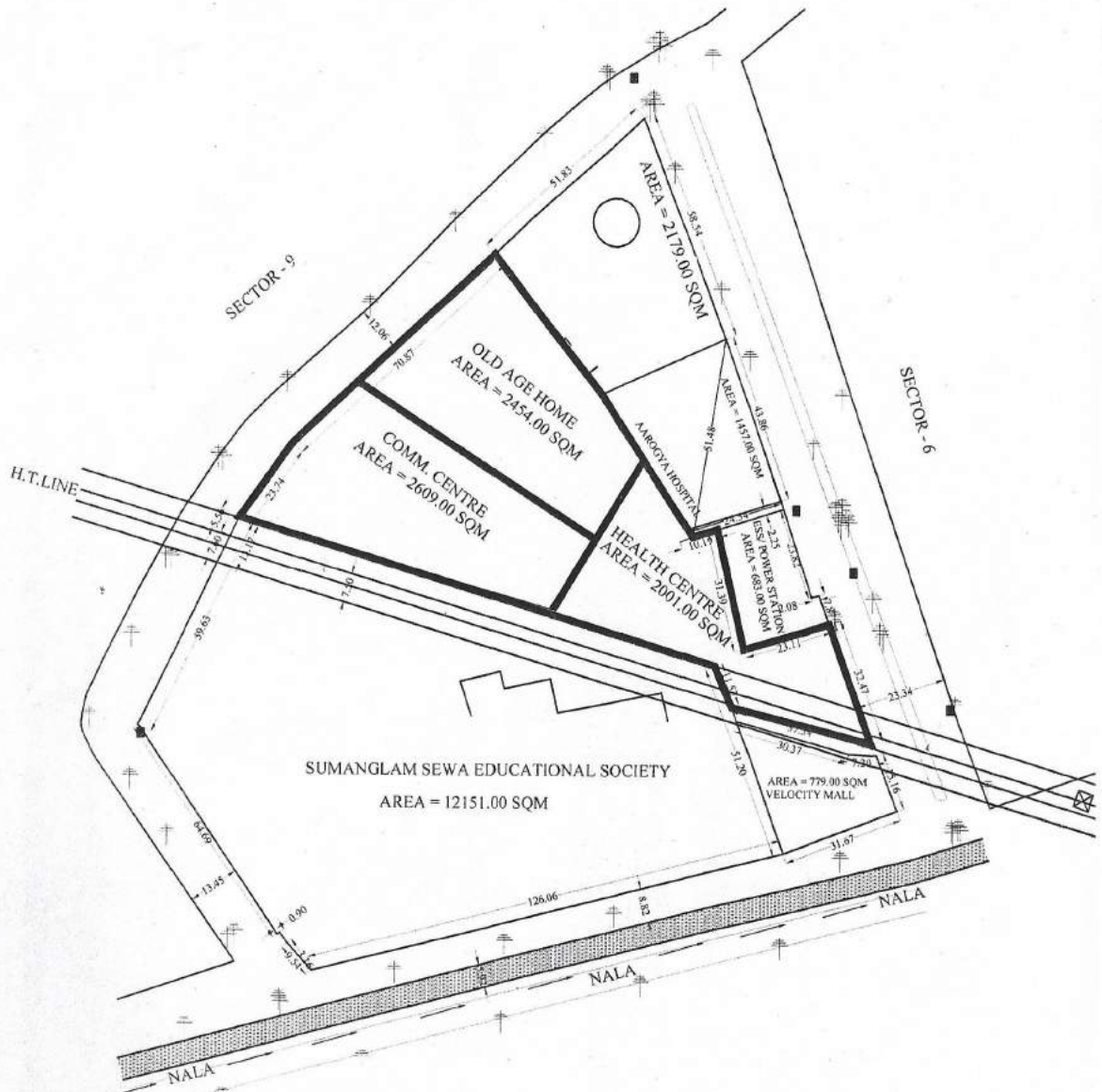

 D/MAN  
 J.E.  
 A.E.  
 E.E.  
 T.P.  
 C.A.T.P.  
 S.