

REVISED LAYOUT PLAN OF INDUSTRIAL POCKET MADHUBAN-BAPUDHAM SCHEME AT NH-58 GZB.

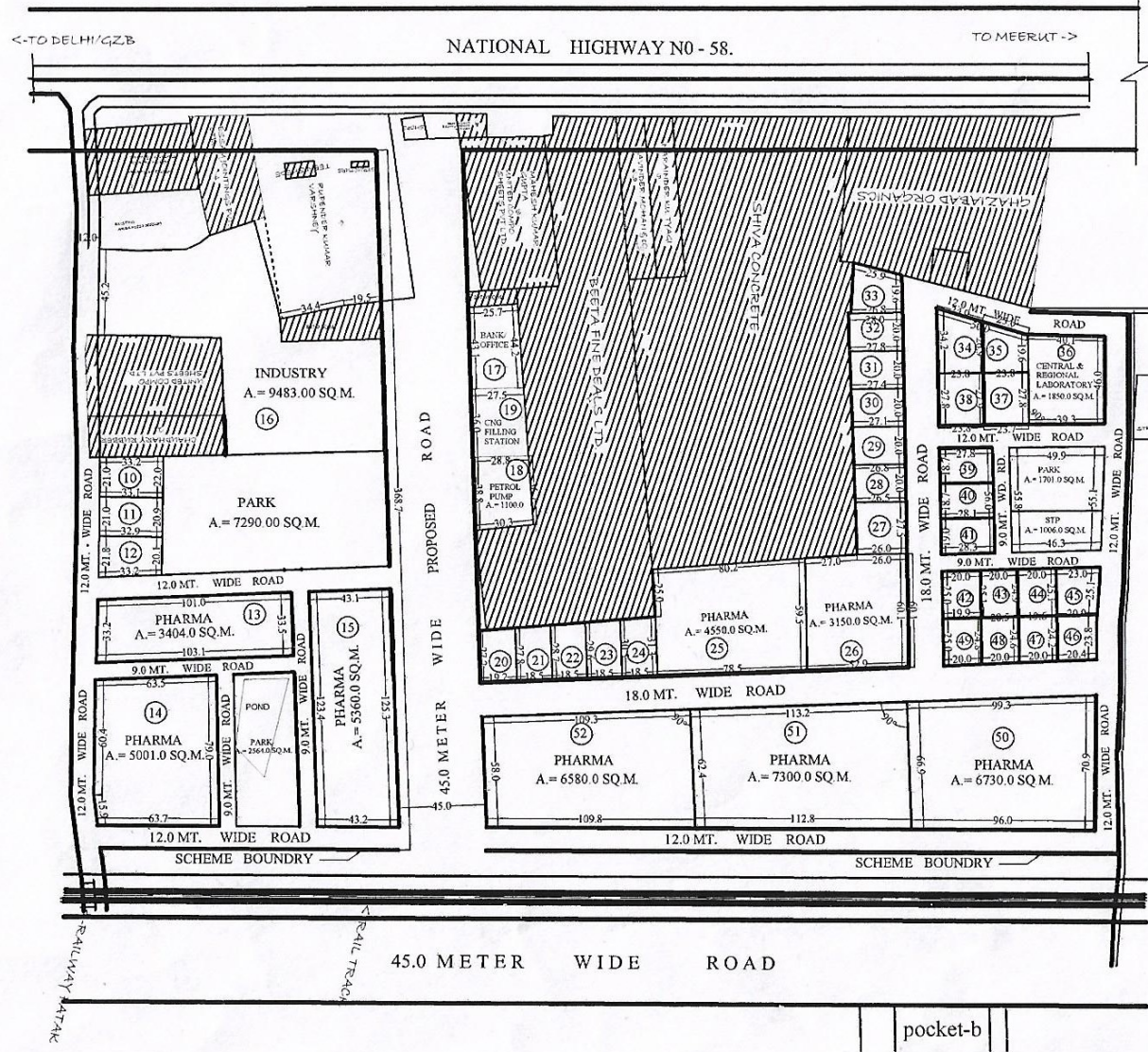

AREA DETAIL
 AREA OF SCHEME = 114476.0 SQ.M.
 (EXCLUDING 45.0 MT. WIDE PROPOSED ROAD)
 AREA UNDER PLOT = 73925.0 SQ.M.
 AREA UNDER S.T.P. = 1006.0 SQ.M.
 AREA UNDER PARK = 11555.0 SQ.M.
 AREA UNDER ROAD = 27990.0 SQ.M.

| PLOT NO. | USE | AREA (APPROX) Sq.M. |
|----------|-----------------|---------------------|
| 10 to 12 | INDUSTRIAL | 692.00 (EACH) |
| 13 | PHARMA | 3404.00 |
| 14 | PHARMA | 5001.00 |
| 15 | PHARMA | 5360.00 |
| 16 | INDUSTRY | 9483.00 |
| 17 | BANK/OFF. | 1158.00 |
| 19 | C.N.G. FILL ST. | 1012.00 |
| 18 | PETROL PUMP | 1100.00 |
| 20 to 24 | INDUSTRIAL | 540.00 (EACH) |
| 25 | PHARMA | 4550.00 |
| 26 | PHARMA | 3150.00 |
| 27 | INDUSTRIAL | 525.00 |
| 28 | INDUSTRIAL | 533.00 |
| 29 | INDUSTRIAL | 539.00 |
| 30 | INDUSTRIAL | 545.00 |
| 31 | INDUSTRIAL | 552.00 |
| 32 | INDUSTRIAL | 558.00 |
| 33 | INDUSTRIAL | 527.00 |
| 34 | INDUSTRIAL | 743.90 |
| 35 | INDUSTRIAL | 567.70 |
| 36 | CENT REG. LAB. | 1850.00 |
| 37 | INDUSTRIAL | 661.41 |
| 38 | INDUSTRIAL | 662.83 |
| 39 | INDUSTRIAL | 519.86 |
| 40 | INDUSTRIAL | 525.47 |
| 41 | INDUSTRIAL | 535.80 |
| 42 | INDUSTRIAL | 498.78 |
| 43 | INDUSTRIAL | 500.00 |
| 44 | INDUSTRIAL | 500.00 |
| 45 | INDUSTRIAL | 550.94 |
| 46 | INDUSTRIAL | 495.60 |
| 47 | INDUSTRIAL | 483.12 |
| 48 | INDUSTRIAL | 506.35 |
| 49 | INDUSTRIAL | 496.75 |
| 50 | PHARMA | 6730.00 |
| 51 | PHARMA | 7300.00 |
| 52 | PHARMA | 6580.00 |