

SITE PLAN OF PLOT NO- 71/ AT A - BLOCK GOVINDPURAM GZ

PLOT AREA NO OF 71/8 TO 71/10 = 127.00 SQ.MT.

PLOT AREA NO OF 71/6 = 290.35 SQ.MT.

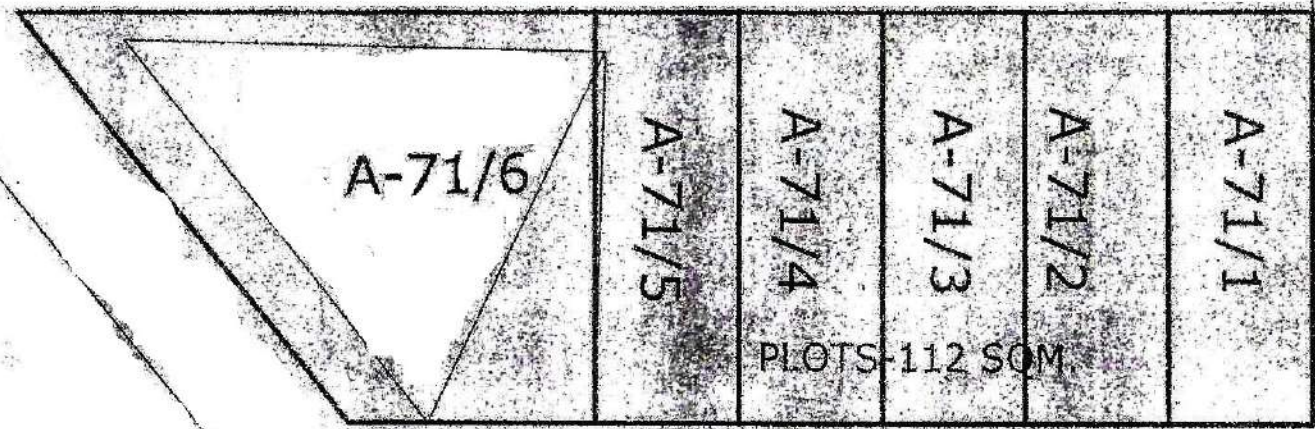

9.0M WIDE ROAD

9.0M WIDE ROAD

PREPARED BY

COMPARED BY

J.E.

A.T.

E.E.

T.P.

PROPOSED SITE PLAN OF PLOT NO. - 45/3 TO 45/10, BLOCK-C, BRIJ VIHAR SECTOR-8, T.H.A., GHAZIABAD

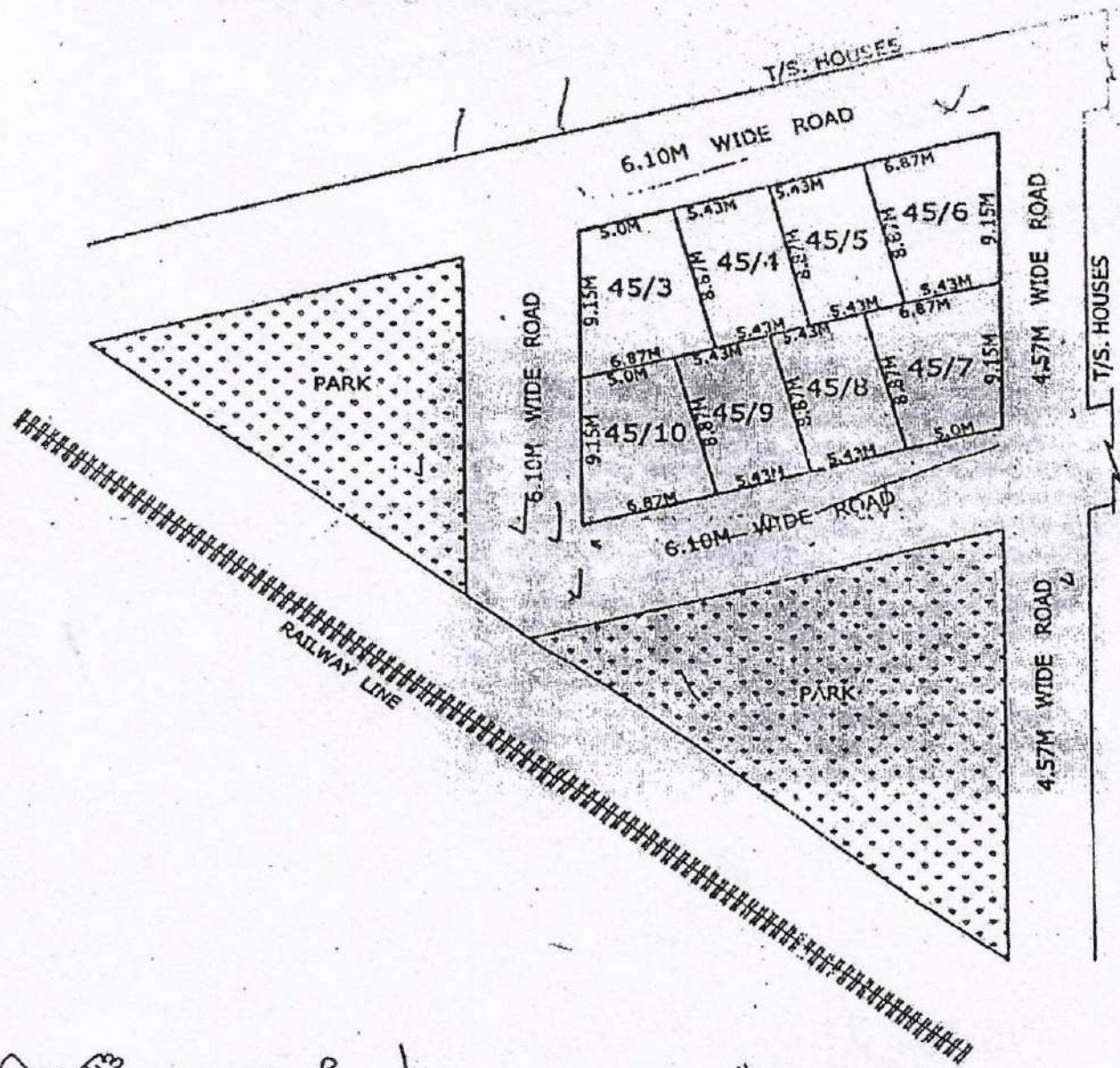

AREA CHART

- P.NO. 45/3=55.85 SQM.
- P.NO. 45/4=48.19 SQM.
- P.NO. 45/5=48.19 SQM.
- P.NO. 45/6=55.85 SQM.
- P.NO. 45/7=56.20 SQM.
- P.NO. 45/8=48.19 SQM.
- P.NO. 45/9=48.19 SQM.
- P.NO. 45/10=55.55 SQM.

[Signature]
12/03/13
D/MAN

[Signature]
J.E

[Signature]
A.E

[Signature]
E.E

[Signature]
27/3/13
TOWN PLANNER

[Signature]
27/3/13
C.A.T.P

CEGV

[Signature]

SITE PLAN OF PLOT NO. CP- AT C-BLOCK GOVINDPURAM.

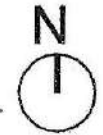
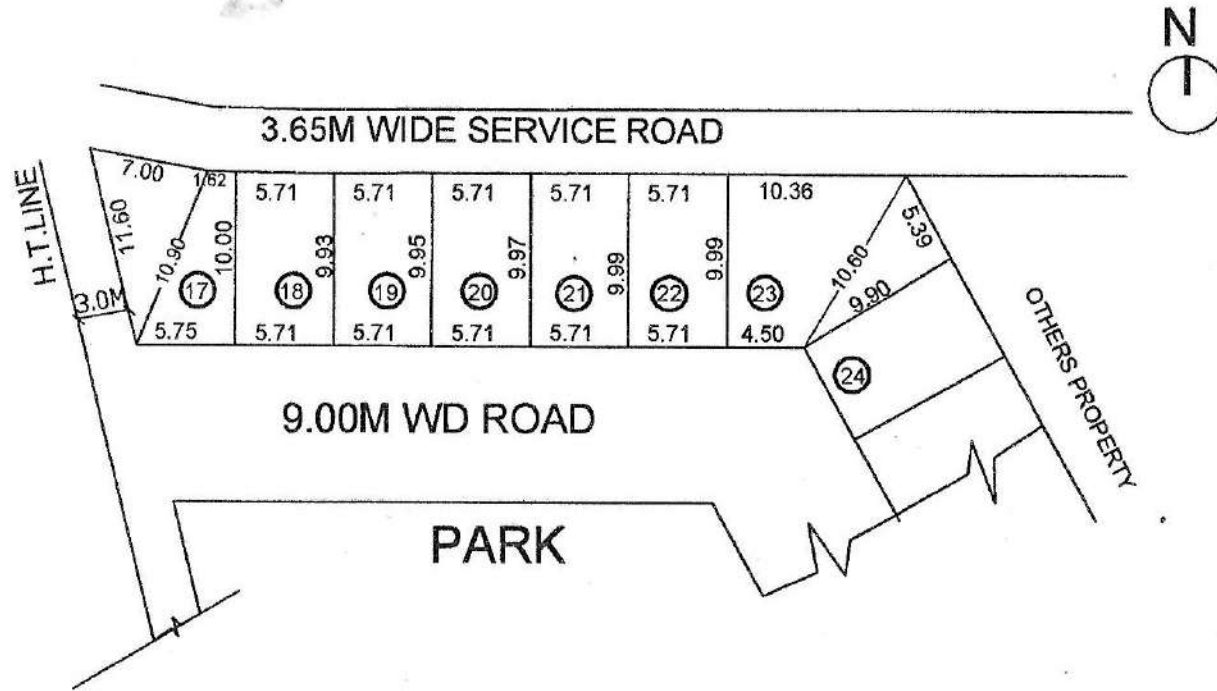

| AREA CHART | |
|------------|------------|
| PLOT NO. | AREA |
| 17 | 74.10 SQM |
| 18 | 56.91 SQM |
| 19 | 56.76 SQM |
| 20 | 56.91 SQM |
| 21 | 57.00 SQM |
| 22 | 57.15 SQM |
| 23 | 101.02 SQM |

[Signature]
19-11-15
PREPARED BY.

[Signature]
11/12/15
COMPARED BY.

[Signature]
9/12/15
J.E.

[Signature]
9/12/15
A.E.

[Signature]
EX.EN

[Signature]
T.P

PART LAYOUT PLAN OF SHOPS PLOT , HOTEL, COMMERCIAL & NURSING HOME PLOT ON COMMERCIAL (COM-2) PLOT & COMMERCIAL/RESIDENTIAL (C/G.H.-1) PLOT IN POCKET C , MADHUBAN BAPUDHAM YOJNA GHAZIABAD

| | | | | |
|----------------------------------|------------------|--------------------------------|----------------|---|
| TOATAL AREA OF LAND | = 60938.57 SQ.M. | SHOPS PLOT - 10.00M. X 28.15M. | - 281.50 SQ.M. | - 10 (C/S.P.-06 TO C/S.P.-15) |
| AREA UNDER SHOPS PLOT | = 21632.30 SQ.M. | SHOPS PLOT - 10.00M. X 20.00M. | - 200.00 SQ.M. | - 38 (C/S.P.-50 TO C/S.P.-64 ,C/S.P.-89 TO C/S.P.- 111) |
| AREA UNDER HOTEL | = 1788.72 SQ.M. | SHOPS PLOT - 09.00M. X 18.00M. | - 162.00 SQ.M. | - 39 (C/S.P.-01 TO C/S.P.-05 ,C/S.P.-16 TO C/S.P.- 49) |
| AREA UNDER NURSING HOME | = 1308.58 SQ.M. | SHOPS PLOT - 08.00M. X 12.50M. | - 100.00 SQ.M. | - 47 (C/S.P.-65 TO C/S.P.-88 ,C/S.P.- 112 TO C/S.P.-134) |
| AREA UNDER COMMERCIAL | = 1154.00 SQ.M. | TOTAL NOS. OF SHOPS PLOT | - 134 | |
| AREA UNDER MULTILEVEL P. | = 5468.95 SQ.M. | | | |
| AREA UNDER TOILET /D.W. | = 322.60 SQ.M. | | | |
| AREA UNDER GREEN/CENTRAL PLAZA | = 7877.60 SQ.M. | | | |
| AREA UNDER CAR PARKING | = 2824.32 SQ.M. | | | |
| AREA UNDER PAVED PATHWAY | = 18561.50 SQ.M. | | | |
| TOTAL NOS. OF CAR IN CAR PARKING | - 185 | | | |

SHOPS PLOT
 F.A.R = 3 - G.F.L.,F.F. & S.F. (AS PER CONTROL DRG.)
 (BASEMENT AREA IS FREE FORM FAR.)
 GROUND COVERAGE = 100 %



REVISED PART LAYOUT PLAN OF FILLING STATIONS (FS-1 & FS-2) COMMERCIAL PLOT AT KOYAL ENCLAVE SCHEME, LONI, GHAZIABAD

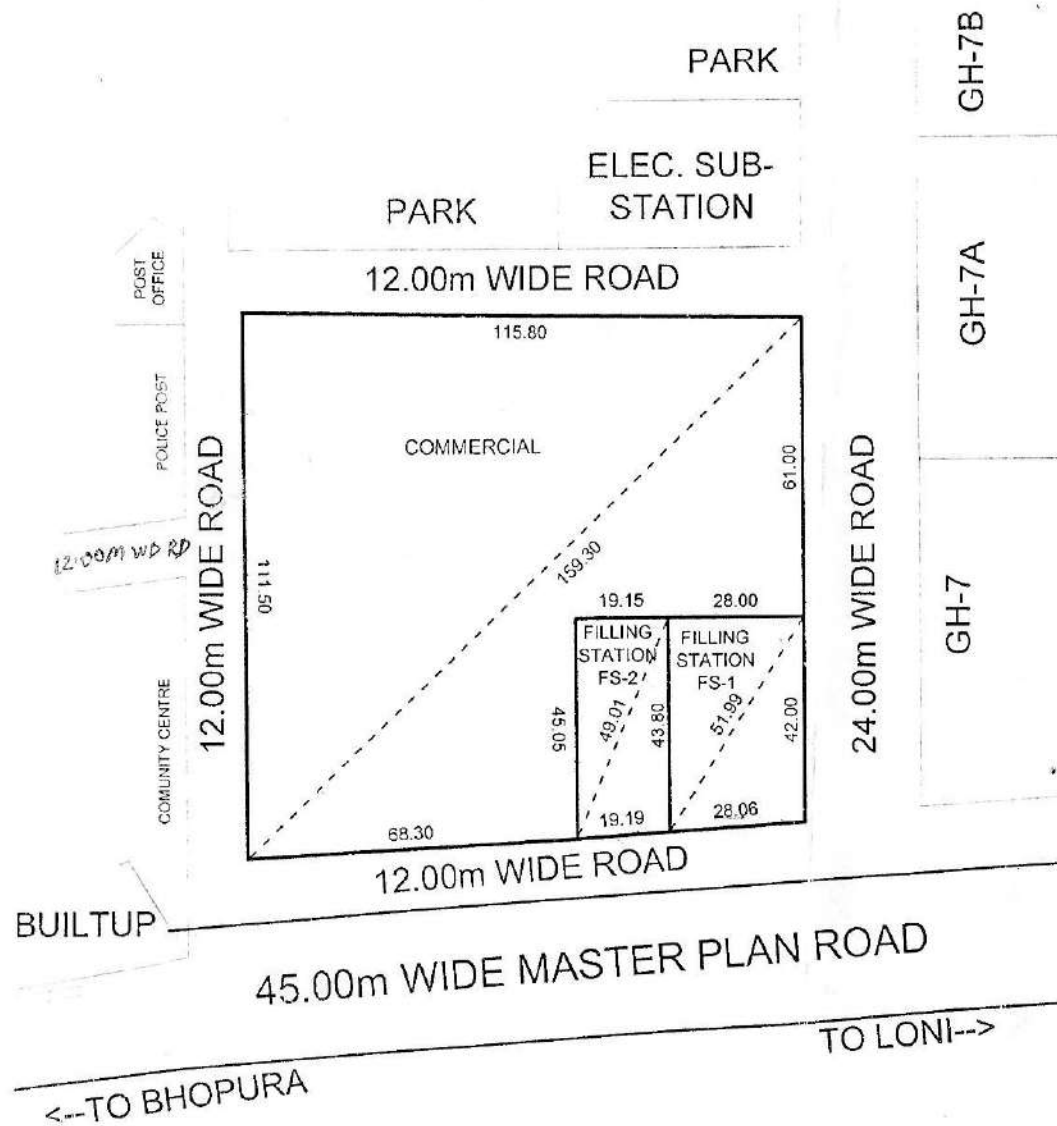

AREA SCHEDULE

| | |
|------------------------|------------------|
| FILLING STATION (FS-1) | = 1201.86 Sqmt. |
| FILLING STATION (FS-2) | = 850.90 Sqmt. |
| COMMERCIAL | = 10343.29 Sqmt. |

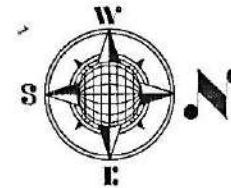

GH-7B

GH-7A

GH-7

D/Man

AMIN

J.E.

A.E.

Ex. E.

OSD. (L.A.)

T. P. (R)

T. P. (K)

C.A.T.P.

SECRETARY

VICE CHAIRMAN

REVISED PART LAYOUT PLAN OF COMMERCIAL LAND IN INDRAPRASTH YOZNA, POCKET - H, LONI, GZB.

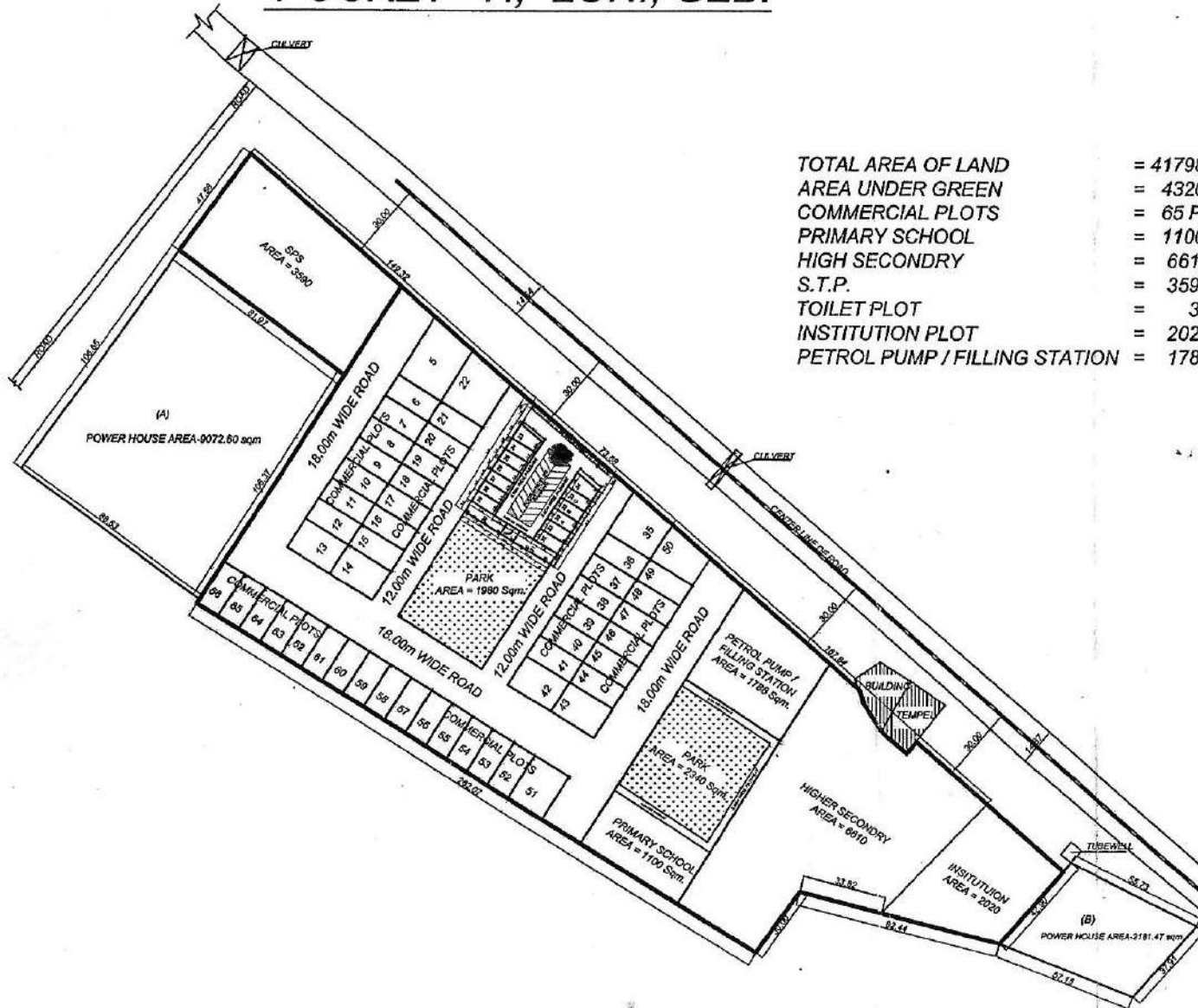
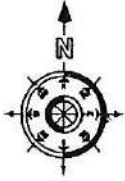

| | |
|-------------------------------|-----------------|
| TOTAL AREA OF LAND | = 41798.00 Sqm. |
| AREA UNDER GREEN | = 4320.00 Sqm. |
| COMMERCIAL PLOTS | = 65 PLOTS |
| PRIMARY SCHOOL | = 1100.00 Sqm. |
| HIGH SECONDRY | = 6610.00 Sqm. |
| S.T.P. | = 3590.00 Sqm. |
| TOILET PLOT | = 30.00 Sqm. |
| INSTITUTION PLOT | = 2020.00 Sqm. |
| PETROL PUMP / FILLING STATION | = 1788.00 Sqm. |

AREA SCHEDULE (COMM. PLOTS)

| PLOT Nos. | AREA (IN Sqm.) |
|----------------|----------------|
| 5 | 510.00 |
| 6 To 12 | 195.00 |
| 13 & 14 | 270.00 |
| 15 To 21 | 195.00 |
| 22 | 445.00 |
| 23 | 64.05 |
| 24 To 29 | 55.00 |
| 30 & 31 | 85.00 |
| 32 & 33 | 55.00 |
| 33A, 33B & 33C | 55.00 |
| 34 | 65.20 |
| 35 | 380.00 |
| 36 To 41 | 195.00 |
| 42 & 43 | 270.00 |
| 44 To 49 | 195.00 |
| 50 | 292.00 |
| 51 | 314.00 |
| 52 To 66 | 195.00 |

SITE PLAN OF PLOT NO-NP-

IN 1 BLOCK GOVINDPURAM GMP, GZD

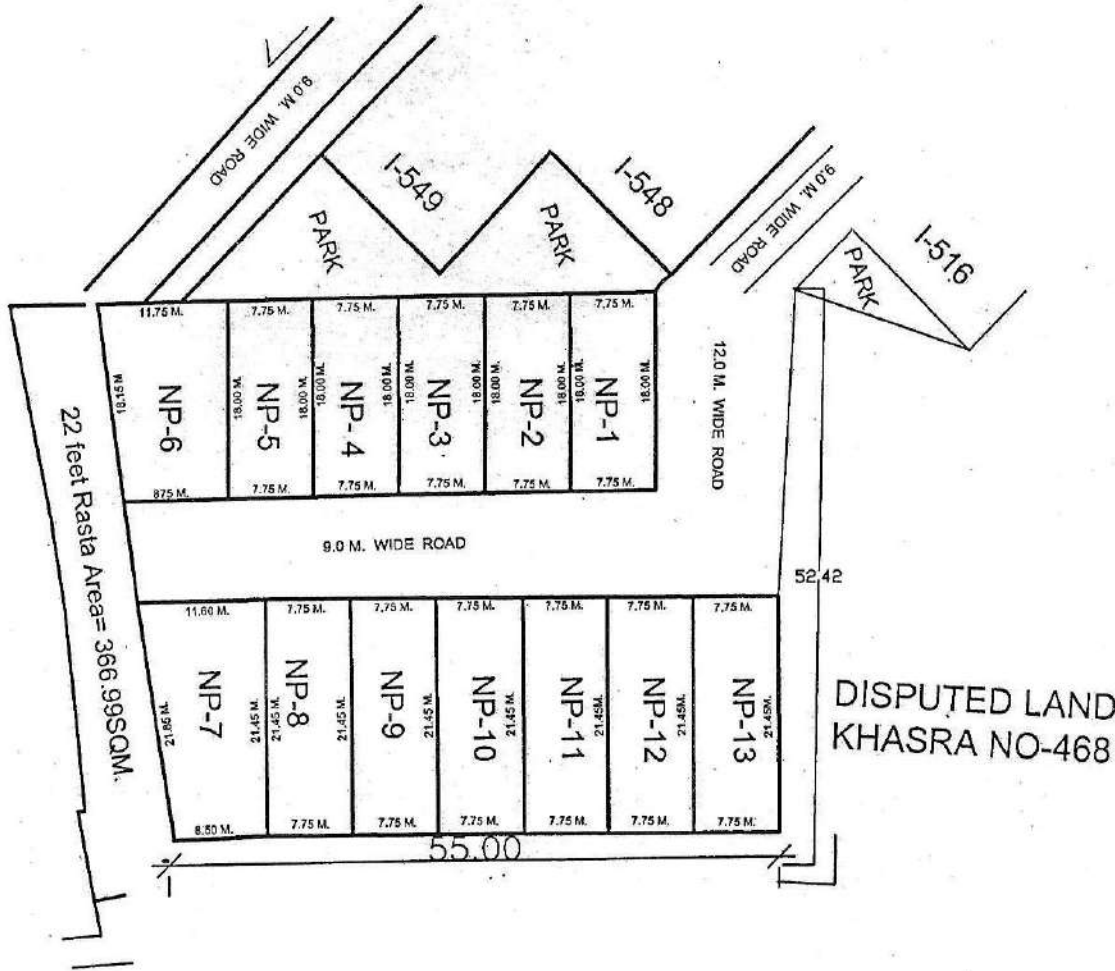

| PLOT NO- | AREA |
|----------|-------------|
| NP- 1 | 139.50SQM. |
| NP- 2 | 139.50SQM. |
| NP- 3 | 139.50SQM. |
| NP- 4 | 139.50SQM. |
| NP- 5 | 139.50SQM. |
| NP- 6 | 184.50 SQM. |
| NP- 7 | 215.57 SQM. |
| NP- 8 | 166.23 SQM. |
| NP- 9 | 166.23 SQM. |
| NP- 10 | 166.23 SQM. |
| NP- 11 | 166.23 SQM. |
| NP- 12 | 166.23 SQM. |
| NP- 13 | 166.23 SQM. |

PREPARED BY

COMPARED BY

J.E

A.E

EE-3

T.P

REV. PART LAYOUT PLAN OF COMMERCIAL PLOTS (VEHICLE FREE) AT NYAY KHAND-1 INDIRAPURAM GZB.

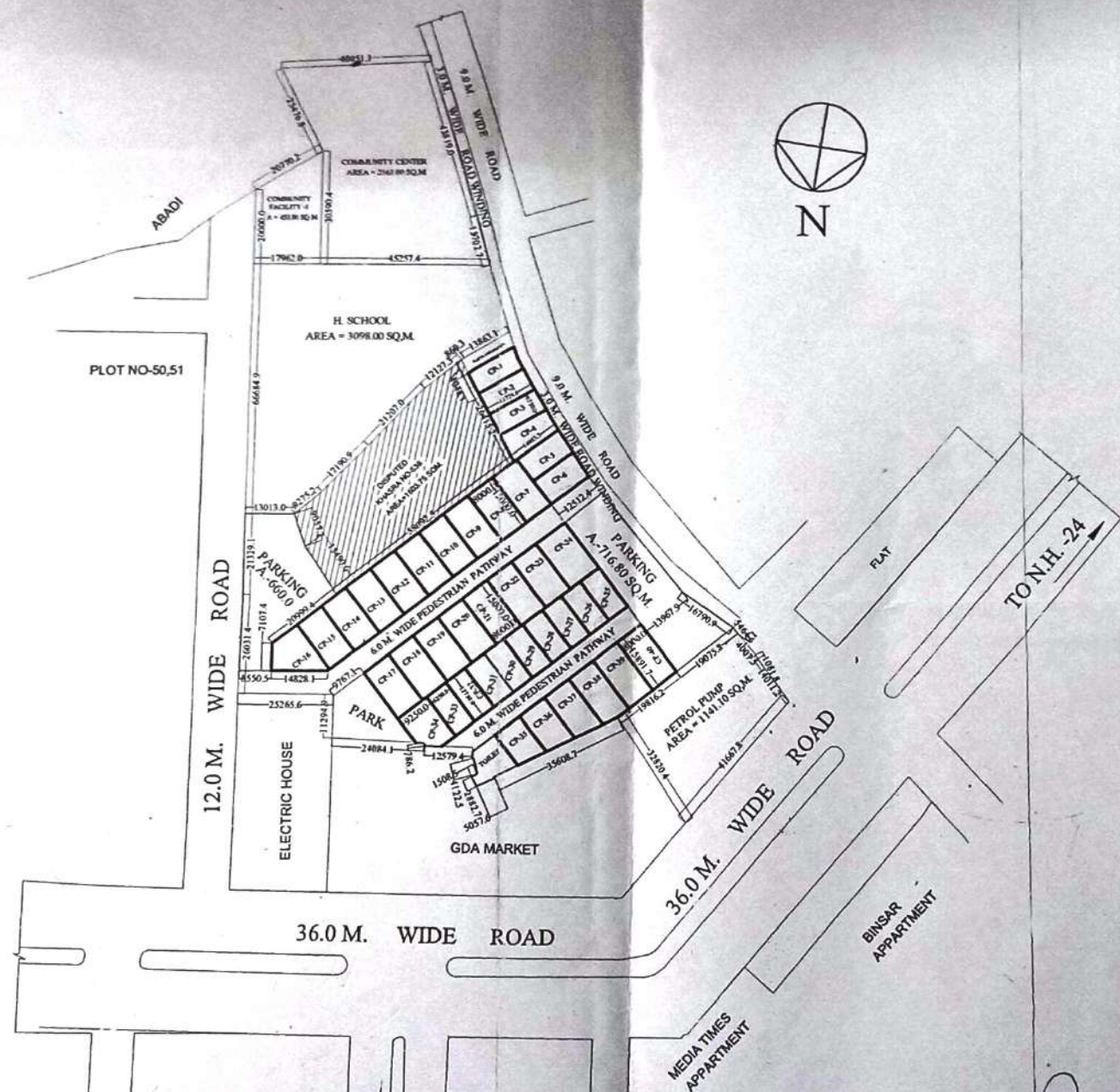

AREA-CHART







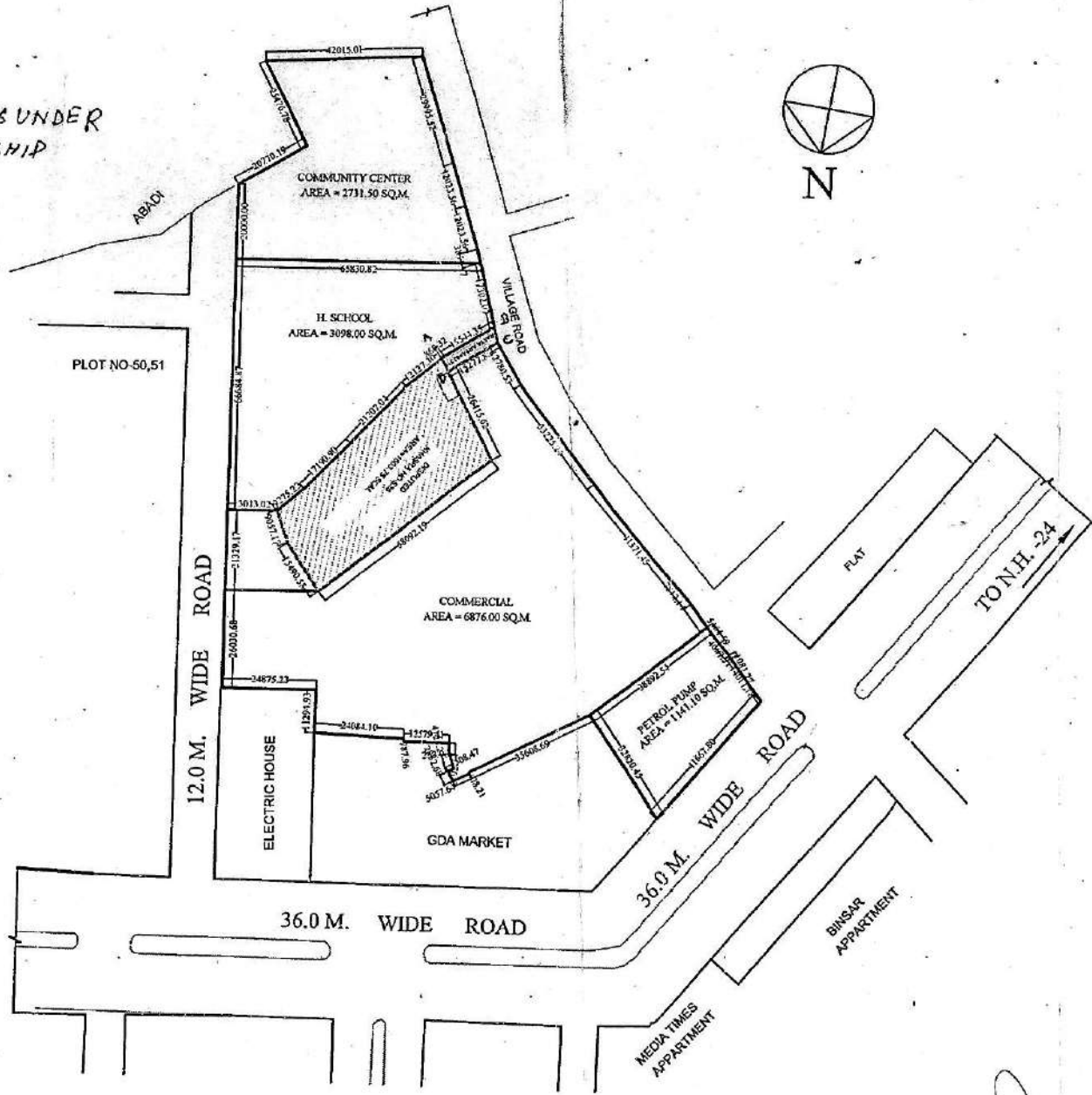

| | |
|----------------|-----------------|
| CP-1 | = 87.02 Sqmt. |
| CP-2 | = 88.07 Sqmt. |
| CP-3 | = 88.71 Sqmt. |
| CP-4 | = 101.05 Sqmt. |
| CP-5 | = 94.87 Sqmt. |
| CP-6 | = 99.13 Sqmt. |
| CP-7 to CP-15 | = 120.00 Sqmt. |
| CP-16 | = 116.24 Sqmt. |
| CP-17 to CP-23 | = 120.00 Sqmt. |
| CP-24 | = 142.25 Sqmt. |
| CP-25 to CP-33 | = 79.68 Sqmt. |
| CP-34 | = 107.11 Sqmt. |
| CP-35 | = 85.84 Sqmt. |
| CP-36 | = 99.21 Sqmt. |
| CP-37 | = 112.59 Sqmt. |
| CP-38 | = 124.48 Sqmt. |
| CP-39 | = 126.61 Sqmt. |
| CP-40 | = 126.69 Sqmt. |
| PARKING | = 1376.80 Sqmt. |

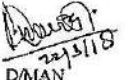
D/MAN J.E. A.E. E.E. T.P.(R) T.P.(G) SECRETARY VICE CHAIRMAN

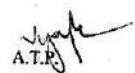
REVISED PART LAYOUT PLAN OF C.CENTER, H. SCHOOL, COMM. & PETROL PUMP AT NYAY KHAND-1 INDIRAPURAM GHAZIABAD.

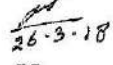
NOTE - A, B, C, D AREA IS UNDER G.D.A. OWNERSHIP

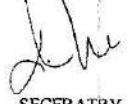

 DMAN
 AMIN
 A.T.P.
 A.E.
 S.E.
 E.E. 26-3-18
 TEH.-I.A.
 T.P.
 C.A.T.P.
 SECERATRY
 VICE CHAIRMAN

REVISED LAYOUT PLAN OF INDUSTRIAL POCKET MADHUBAN-BAPUDHAM SCHEME AT NH-58 GZB.

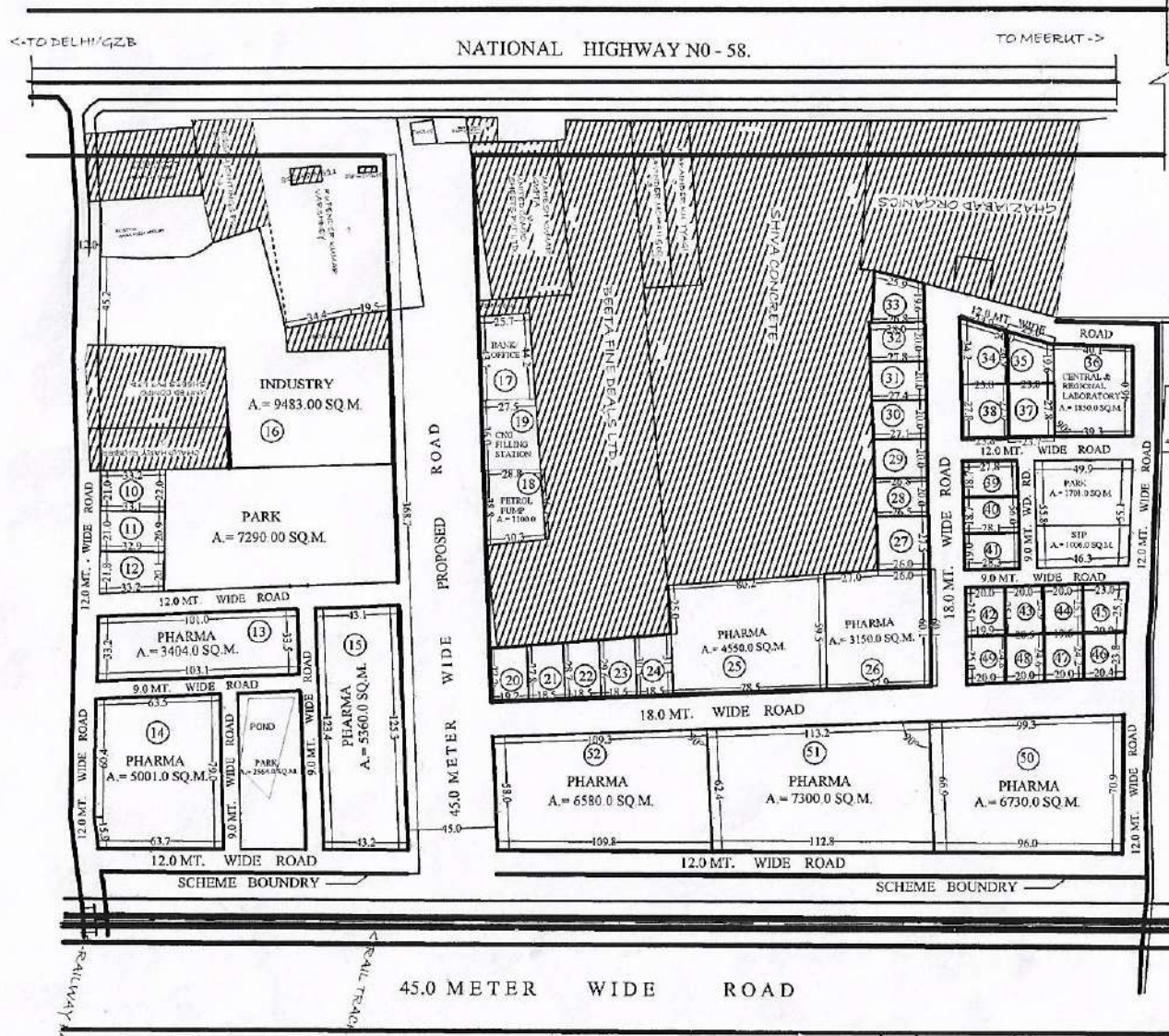

AREA DETAIL
 AREA OF SCHEME = 114476.0 SQ.M.
 (EXCLUDING 45.0 MT. WIDE PROPOSED ROAD)
 AREA UNDER PLOT = 73925.0 SQ.M.
 AREA UNDER S.T.P. = 1006.0 SQ.M.
 AREA UNDER PARK = 11555.0 SQ.M.
 AREA UNDER ROAD = 27990.0 SQ.M.

| PLOT NO. | USE | AREA (APROX) Sq.M. |
|----------|-----------------|--------------------|
| 10 to 12 | INDUSTRIAL | 692.00 (EACH) |
| 13 | PHARMA | 3404.00 |
| 14 | PHARMA | 5001.00 |
| 15 | PHARMA | 5360.00 |
| 16 | INDUSTRY | 9483.00 |
| 17 | BANK/OFF. | 1158.00 |
| 19 | C.N.G. FILL ST. | 1012.00 |
| 18 | PETROL PUMP | 1100.00 |
| 20 to 24 | INDUSTRIAL | 540.00 (EACH) |
| 25 | PHARMA | 4550.00 |
| 26 | PHARMA | 3150.00 |
| 27 | INDUSTRIAL | 525.00 |
| 28 | INDUSTRIAL | 533.00 |
| 29 | INDUSTRIAL | 539.00 |
| 30 | INDUSTRIAL | 545.00 |
| 31 | INDUSTRIAL | 552.00 |
| 32 | INDUSTRIAL | 558.00 |
| 33 | INDUSTRIAL | 527.00 |
| 34 | INDUSTRIAL | 743.90 |
| 35 | INDUSTRIAL | 567.70 |
| 36 | CENT REG. LAB. | 1850.00 |
| 37 | INDUSTRIAL | 661.41 |
| 38 | INDUSTRIAL | 662.83 |
| 39 | INDUSTRIAL | 519.86 |
| 40 | INDUSTRIAL | 525.47 |
| 41 | INDUSTRIAL | 535.80 |
| 42 | INDUSTRIAL | 498.78 |
| 43 | INDUSTRIAL | 500.00 |
| 44 | INDUSTRIAL | 500.00 |
| 45 | INDUSTRIAL | 550.94 |
| 46 | INDUSTRIAL | 495.60 |
| 47 | INDUSTRIAL | 483.12 |
| 48 | INDUSTRIAL | 506.35 |
| 49 | INDUSTRIAL | 496.75 |
| 50 | PHARMA | 6730.00 |
| 51 | PHARMA | 7300.00 |
| 52 | PHARMA | 6580.00 |

pocket-b

SITE PLAN OF PLOT FOR BANK, ART GALLERY, HOTEL & FILLING STATION AT KARPOORI PURAM SCHEME.



- AREA OF ART GALLERY = 540 SQM
- AREA OF BANK = 580.00 SQM
- AREA OF HOTEL = 1007.00 SQM
- AREA OF FILLING STATION = 533.00 SQM

PREPARED BY. *[Signature]* AMIN MEASURED BY. *[Signature]* J.E. A.E. E.E. *[Signature]* T.E.H.(L.A.) T.P. *[Signature]* C.A.T.P. SECY. *[Signature]*







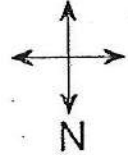
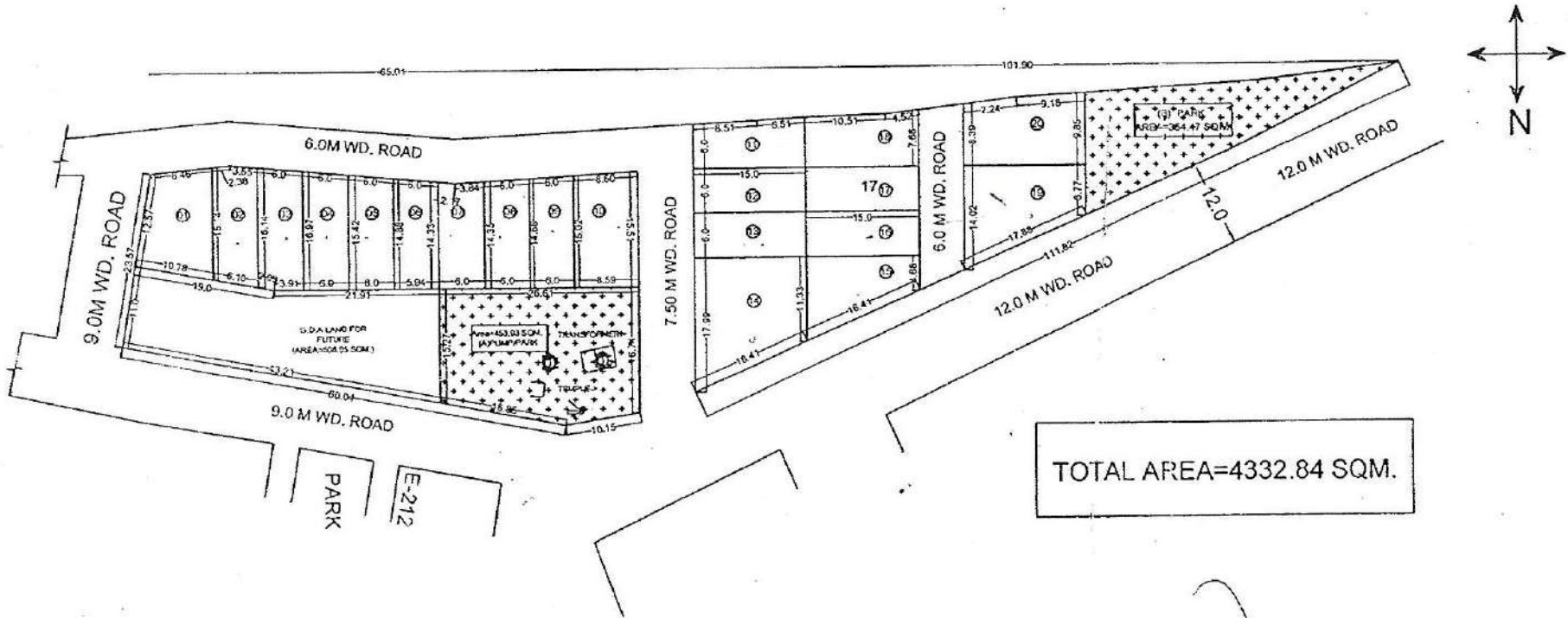

PART . A

| S.NO. | PLOT NO. | AREA |
|-------|----------|-------------|
| (01) | E-01 | 131.51 SQM. |
| (02) | E-02 | 94.62 SQM. |
| (03) | E-03 | 97.09 SQM. |
| (04) | E-04 | 94.20 SQM. |
| (05) | E-05 | 90.91 SQM. |
| (06) | E-06 | 87.62 SQM. |
| (07) | E-07 | 84.81 SQM. |
| (08) | E-08 | 87.09 SQM. |
| (09) | E-09 | 89.12 SQM. |
| (10) | E-10 | 131.09 SQM. |
| (11) | E-11 | 95.94 SQM. |
| (12) | E-12 | 90.00 SQM. |

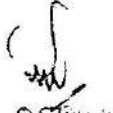
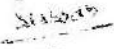
PART . A

| S.NO. | PLOT NO. | AREA |
|-------|----------|-------------|
| ((13) | E-13 | 90.00 SQM. |
| (14) | E-14 | 219.77 SQM. |
| (15) | E-15 | 120.03 SQM. |
| (16) | E-16 | 90.00 SQM. |
| (17) | E-17 | 90.00 SQM. |
| (18) | E-18 | 106.28 SQM. |
| (19) | E-19 | 169.91 SQM. |
| (20) | E-20 | 151.00 SQM. |
| PARK | | |
| (01) | A | 453.03 SQM. |
| (02) | B | 354.47 SQM. |

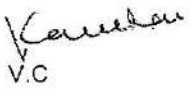

 D/MAN
  AMIN
  O.S.D. (L.A.S.)
  J.E.
  A.E.
  E.E.
  T.P.(R)
  T.P.(K)
  SECY.
  V.C.

PART LAY OUT PLAN FOR NANDGRAM BLOCK - E. GHAZIABAD

91

PART . B

PART . B

| S.NO. | PLOT NO. | AREA | S.NO. | PLOT NO. | AREA |
|-------|----------|-------------|-------|----------|-------------|
| (21) | E-21 | 187.55 SQM. | (34) | E-34 | 97.74 SQM. |
| (22) | E-22 | 90.61 SQM. | (35) | E-35 | 91.76 SQM. |
| (23) | E-23 | 91.87 SQM. | (36) | E-36 | 84.67 SQM. |
| (24) | E-24 | 113.28 SQM. | (37) | E-37 | 79.48 SQM. |
| (25) | E-25 | 99.15 SQM. | (38) | E-38 | 80.54 SQM. |
| (26) | E-26 | 90.05 SQM. | (39) | E-39 | 87.71 SQM. |
| (27) | E-27 | 90.05 SQM. | (40) | E-40 | 98.74 SQM. |
| (28) | E-28 | 133.27 SQM. | (41) | E-41 | 116.59 SQM. |
| (29) | E-29 | 142.53 SQM. | (42) | E-42 | 108.00 SQM. |
| (30) | E-30 | 88.94 SQM. | (43) | E-43 | 153.78 SQM. |
| (31) | E-31 | 93.50 SQM. | (44) | E-44 | 86.74 SQM. |
| (32) | E-32 | 103.93 SQM. | (45) | E-45 | 86.00 SQM. |
| (32) | E-32 | 103.93 SQM. | (46) | E-46 | 85.07 SQM. |
| (33) | E-33 | 98.31 SQM. | | | |
| | | | | PARK | |
| | | | (01) | A | 313.05 SQM. |

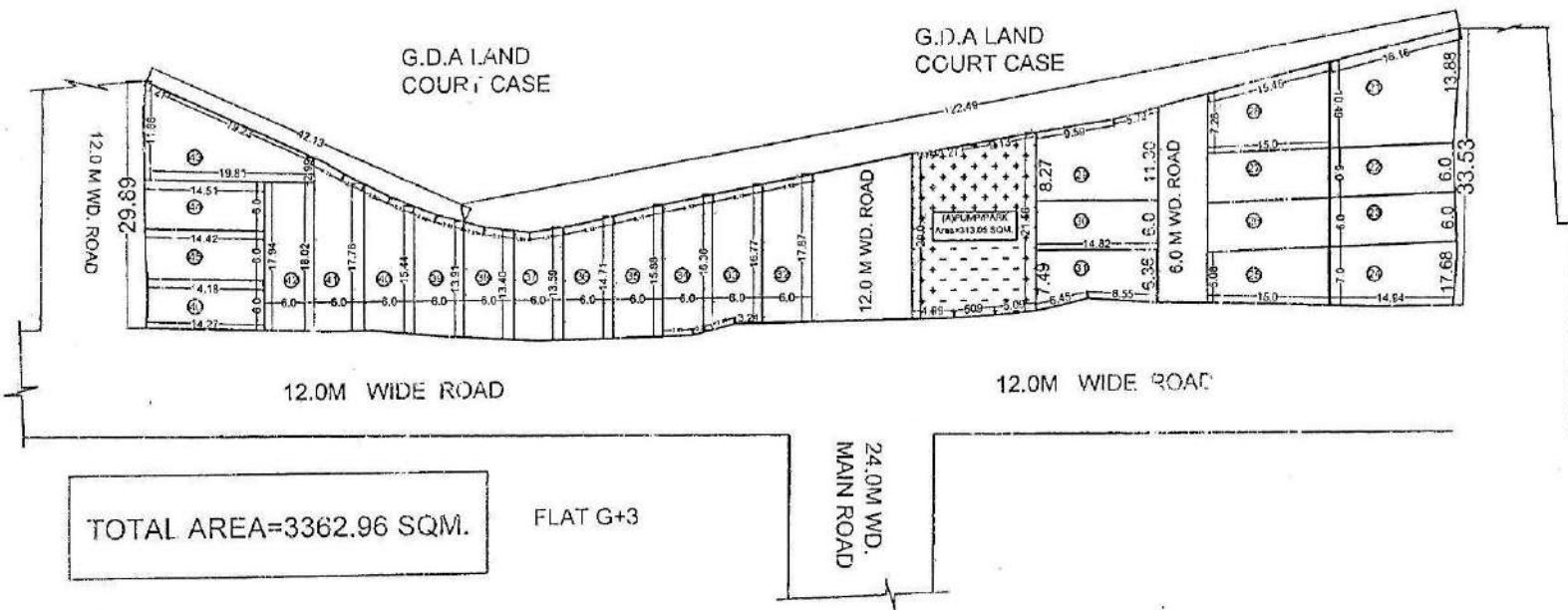

TOTAL AREA=3362.96 SQM.

FLAT G+3

 D/MAN
  AMIN
  OSD(LA)
  J.E
  A.E
  E.E
  T.P(R)
  T.P(K)
 C.A.T.P
 SECY.
 V.C

SITE PLAN FOR KIOSK IN "D" BLOCK PATEL NAGAR, SECTOR - 7 G.M.P. GHAZIABAD

Scale -1:500

AREA OF KIOSK LAND = 116.84 Sqm.

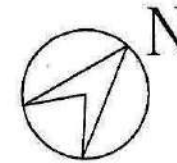
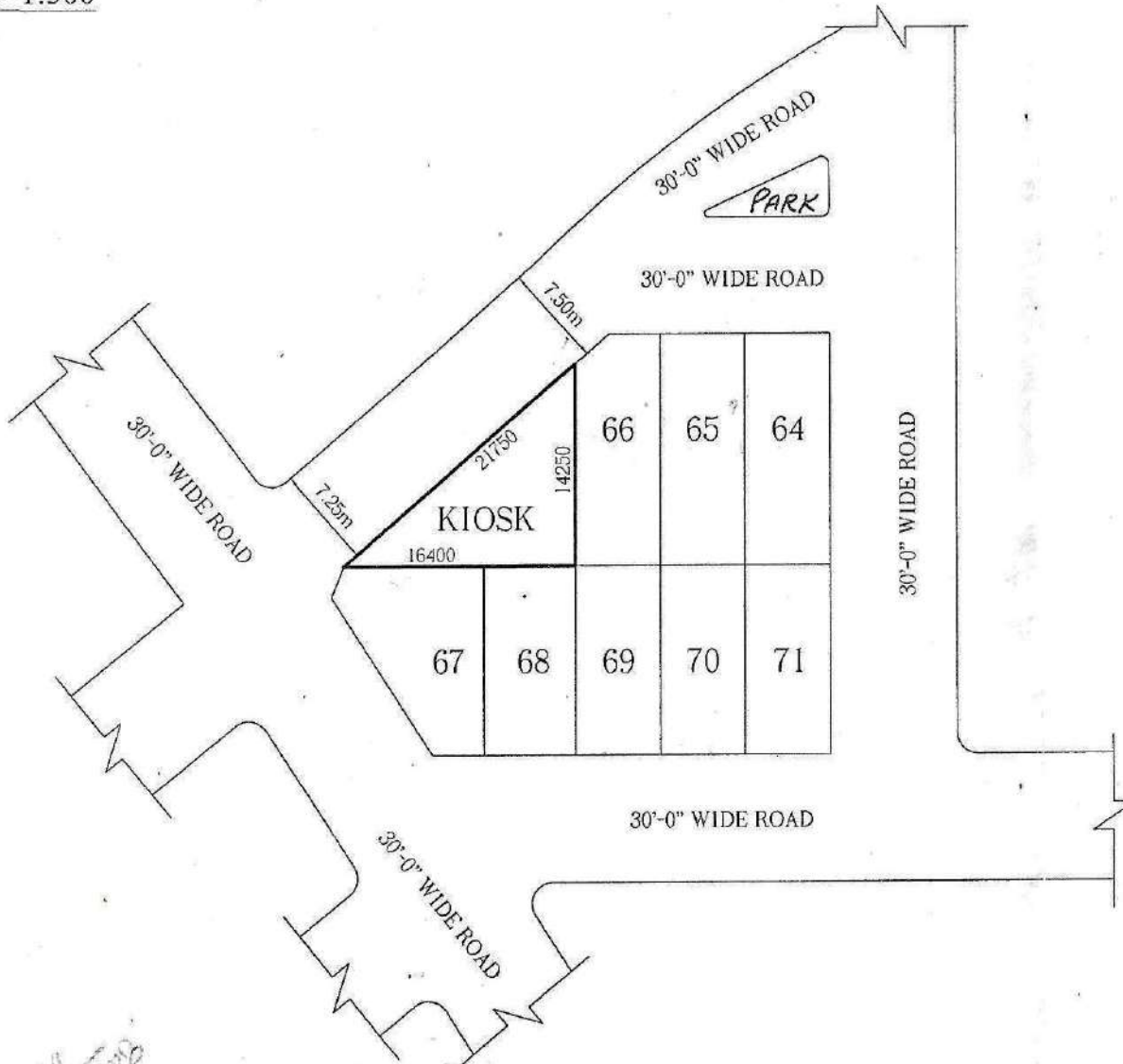

[Signature]
22.4.08

Prepared By.

[Signature]
22.4.08

Compared By.

[Signature]
22.4.08
Measured By.

[Signature]
22.4.08
Asth. Engineer





[Signature]
23/4/08
A.T.P.

[Signature]
Town Planner.

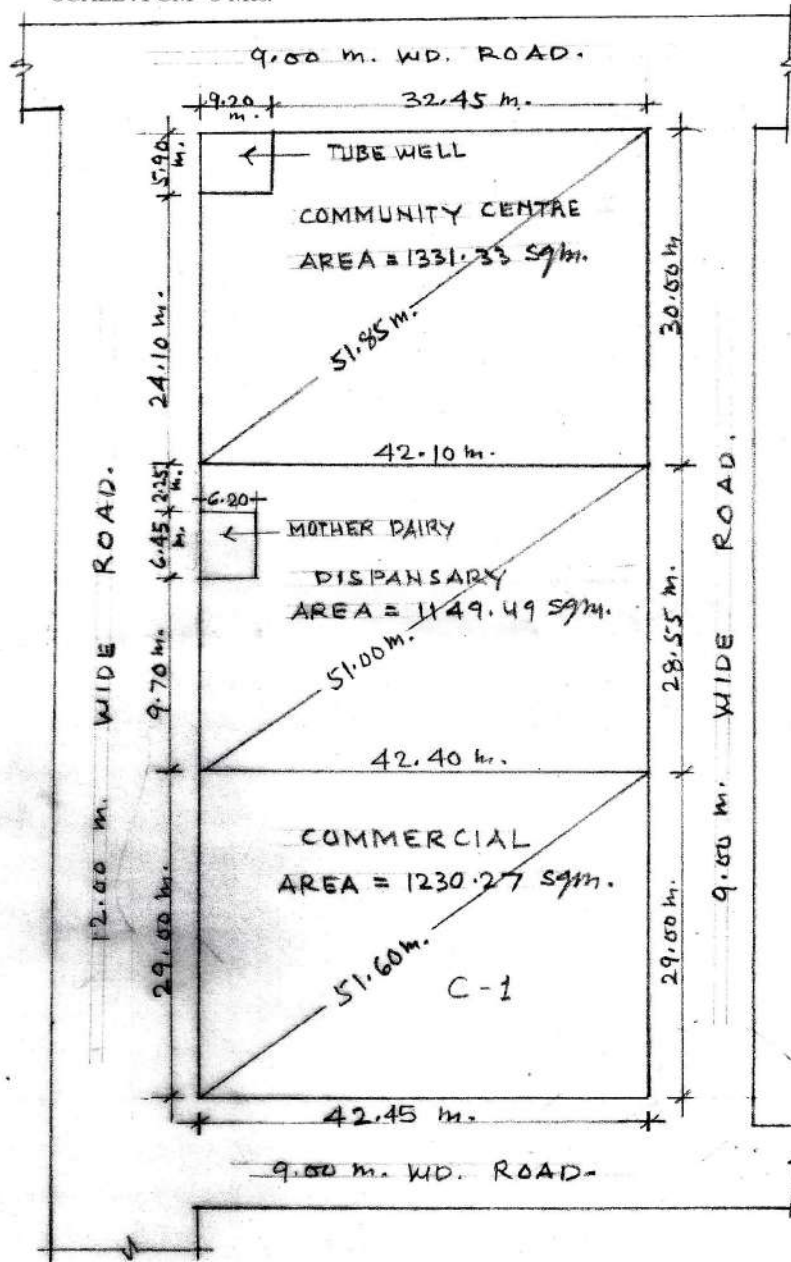
AT TULSI NIKETAN SCHEME THA IN GHAZIABAD

SCALE : 1 CM = 5 Mts.

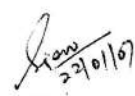

 10/01/07
 11/01/07
 22/01/07
 22/01/07
 24/01/07
 PREPARED BY COMPARED BY MEASURED BY ASST ENGR. TOWN PLANNER

PROPOSED PART LAYOUT PLAN AT SECTOR III, BEHIND CHAAYA PUBLIC SCHOOL.VAISHALI

(POCKET - NP)

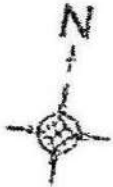

PLOTS SIZE = 16.50 X 8.50 M.
 AREA = 140.25 SQ M.
 NO. OF PLOTS = 18

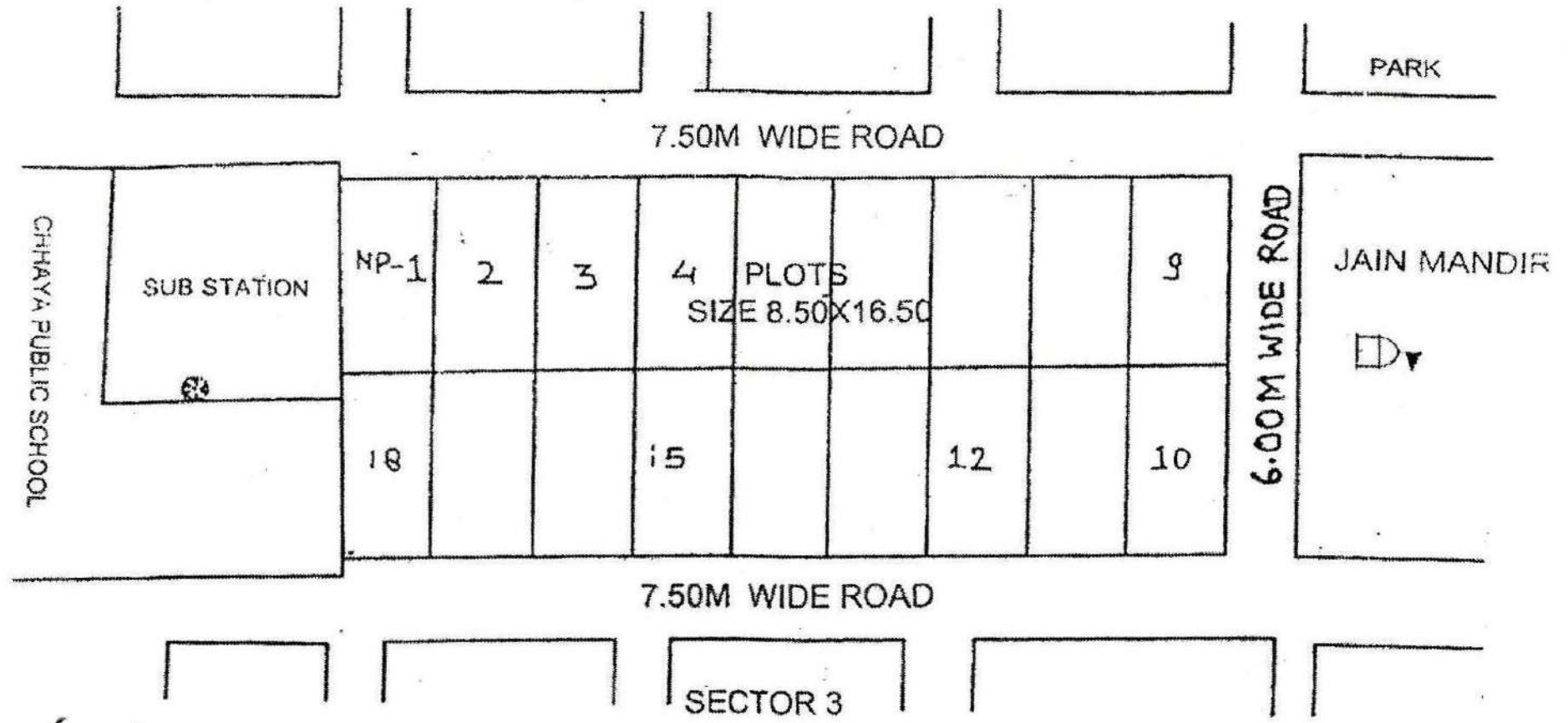

[Signature]
 D/IAN

[Signature]
 19/10/12
 TOWN PLANNER

[Signature]
 CATP

[Signature]
 SECY.

[Signature]